

1942
 CARMEN DRIVE - WL SHADYBROOK TO S.L. HILLSIDE
 30' CONC. - INT. CB

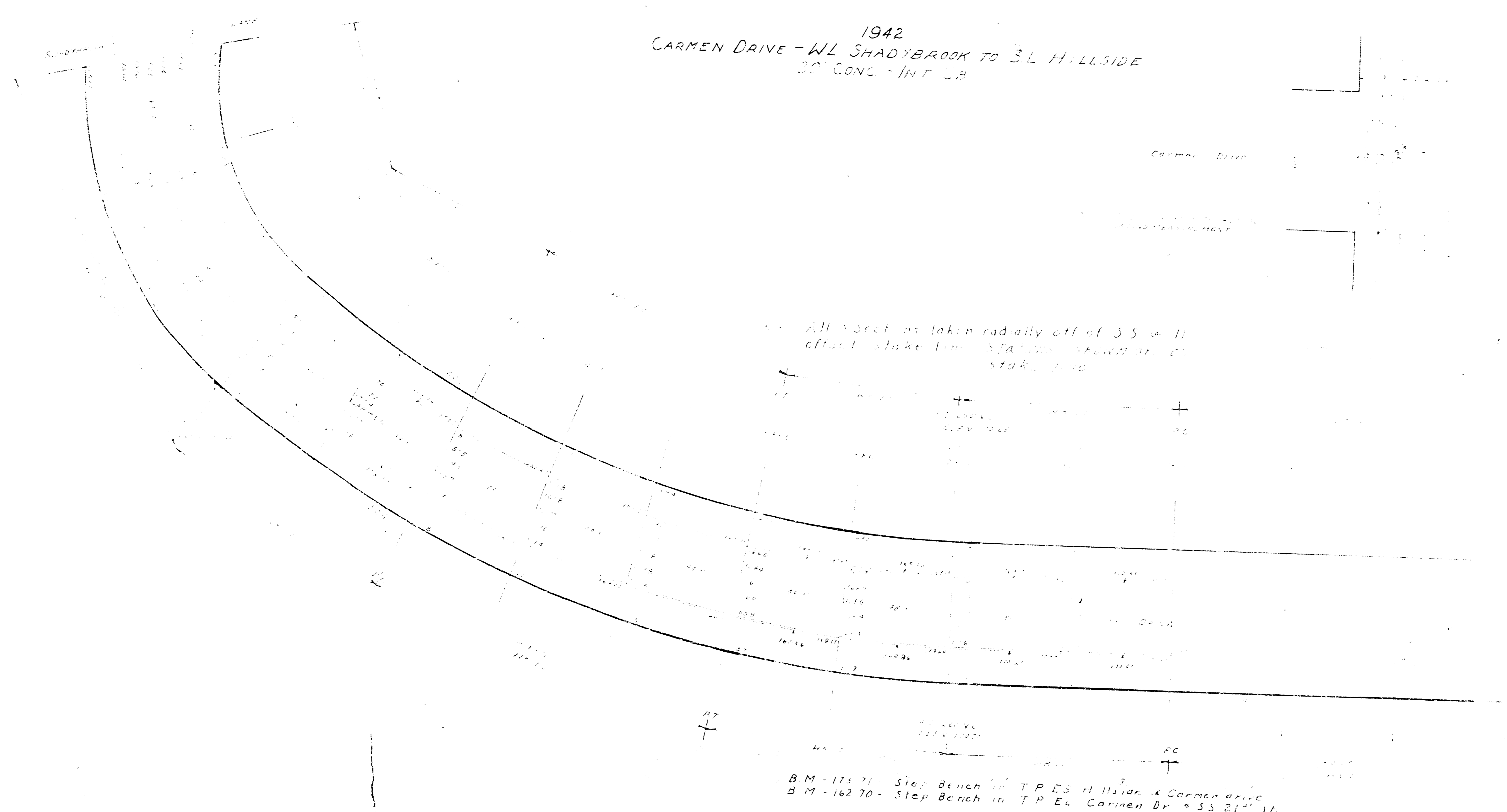

All Sect. as taken radially off of S.S. w/ 11' offset stake line. STATIONS shown at 20' stake line.

B.M. - 173.71 - Step Bench in T.P. ES. Hillside & Carmen drive.
 B.M. - 162.70 - Step Bench in T.P. EL. Carmen Dr. & S.S. 214' ST.