

CEDAR LAKES VILLAGE 1ST ADDN.

LONGFORD LANE SL Lot 28, Blk 5, Cedar Lakes
 Village 1st Addn.—SL Harry 45' Asph. Conc. Pavt.
 LOCKMOOR CIRCLE and ARTHUR CIRCLE in
 Cedar Lakes Village 1st Addn. 35' Asph. Conc. Pavt.
 R. W LINN CITY ENGINEER
 City of Wichita, Kansas
 Project No. DAKC573051

- GENERAL NOTES**
1. CONTRACTOR TO CLEAR RIGHT-OF-WAY, GRADE PARKINGS, AND CONSTRUCT COMPACTED FILL IN SIDEWALK AREAS. SIDEWALK TO BE CONSTRUCTED BY OTHERS.
 2. TYPE OF SUBGRADE TREATMENT SHALL BE AS DETERMINED BY FIELD ENGINEER. SUBGRADE TREATMENT MAY CONSIST OF LIME TREATMENT OR CEMENT TREATMENT.
 3. ROLL CURB SHALL BE DEPRESSED THROUGH DRIVEWAYS CONSTRUCTED IN CONJUNCTION WITH THIS PROJECT.
 4. THIS PROJECT SHALL BE COORDINATED WITH SANITARY SEWER PROJECTS AND INCIDENTAL DRAINAGE PROJECT TO BE CONSTRUCTED WITHIN THE STREET RIGHT-OF-WAY.

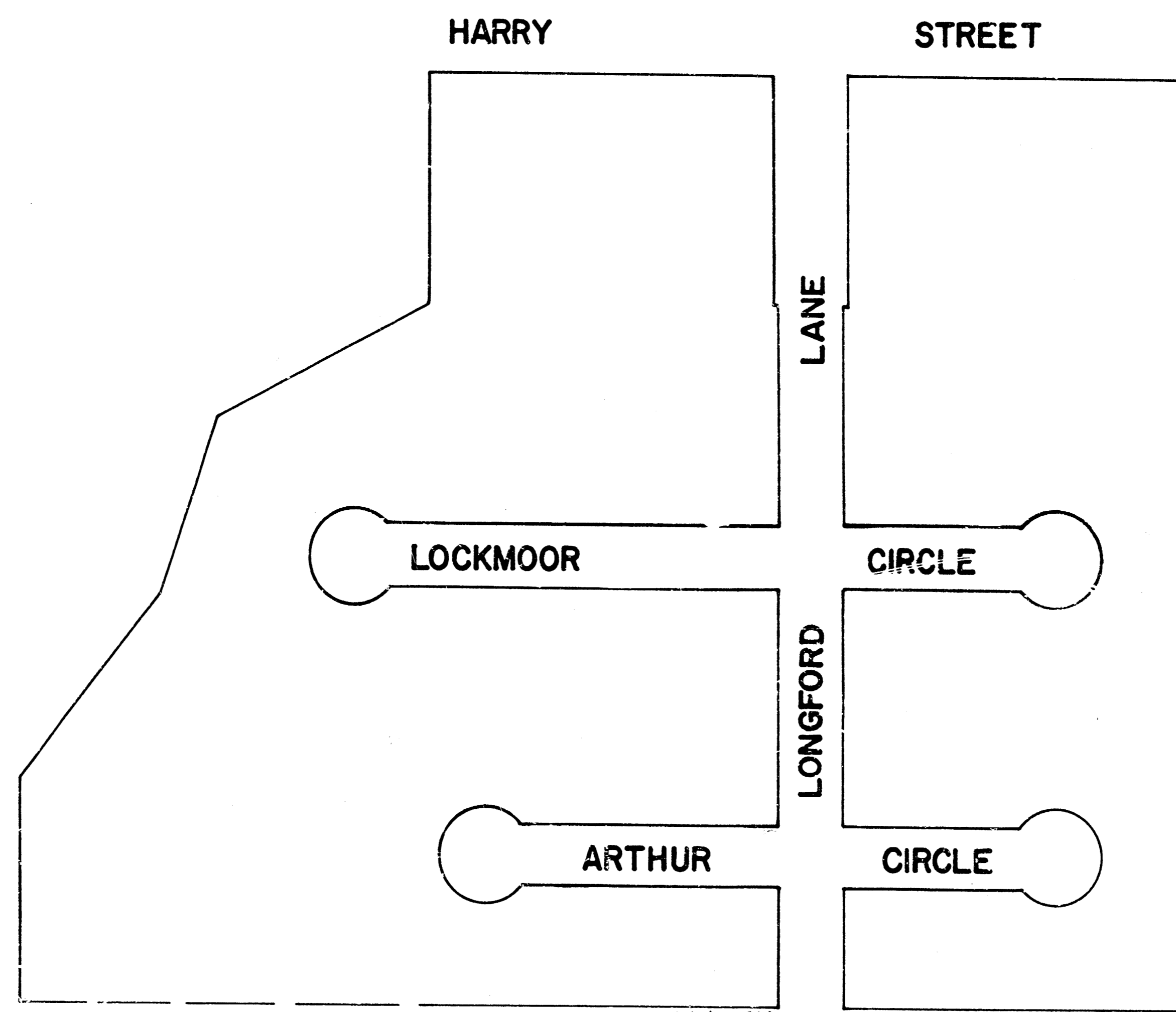

SL Lot 28-Blk 5
 Cedar Lakes Village
 1st Addition

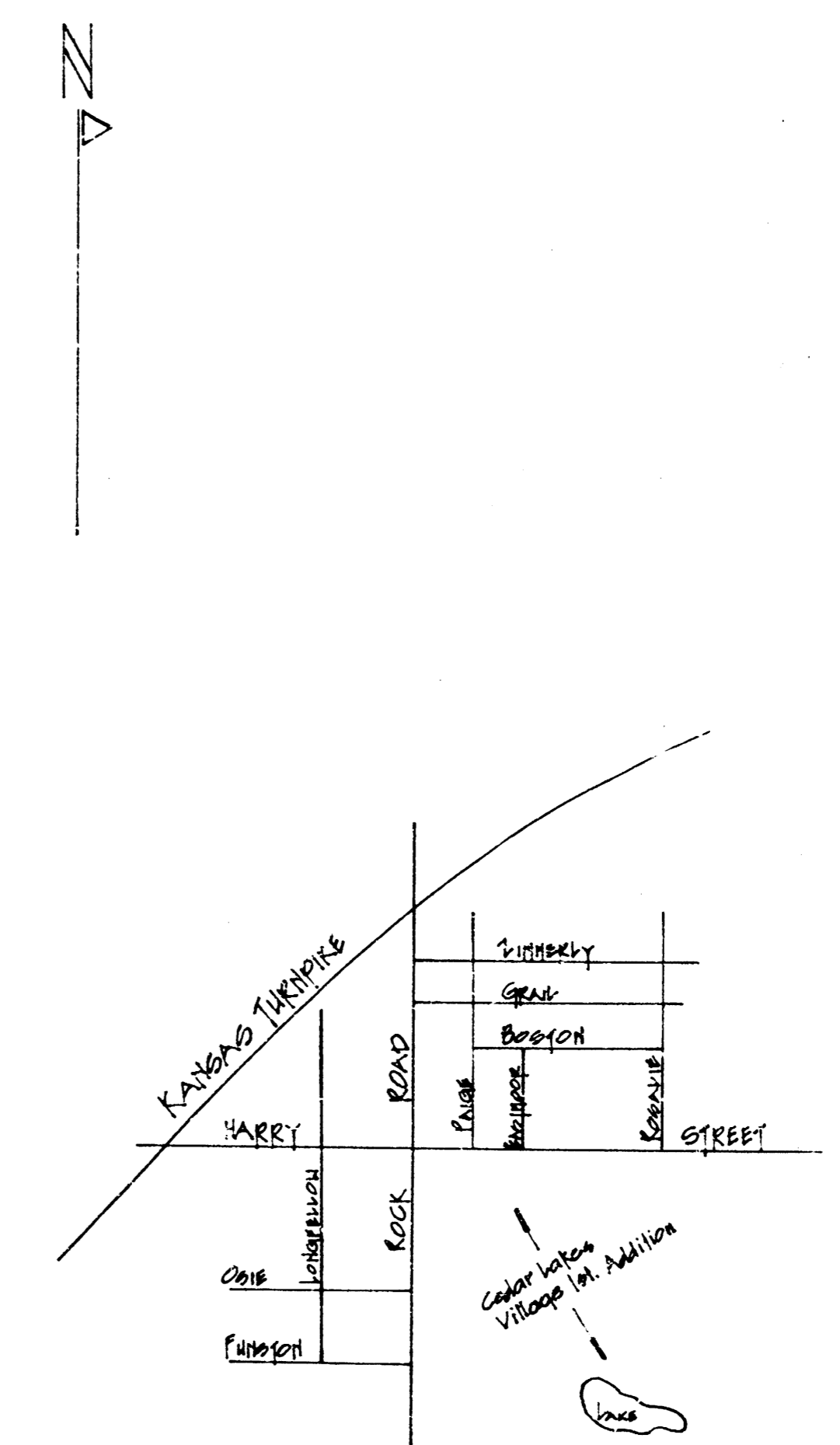

"LOCATION MAP"

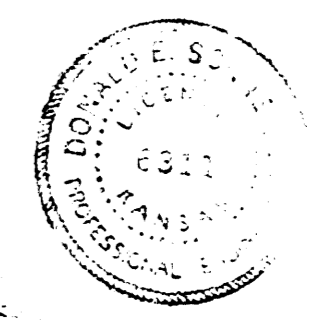

LOCKMOOR CIRCLE
 E.L. Longford Lane to and including Cul-de-sac
 W.L.

ARTHUR CIRCLE
 W.L. Longford Lane to and including Cul-De-Sac
 E.L.

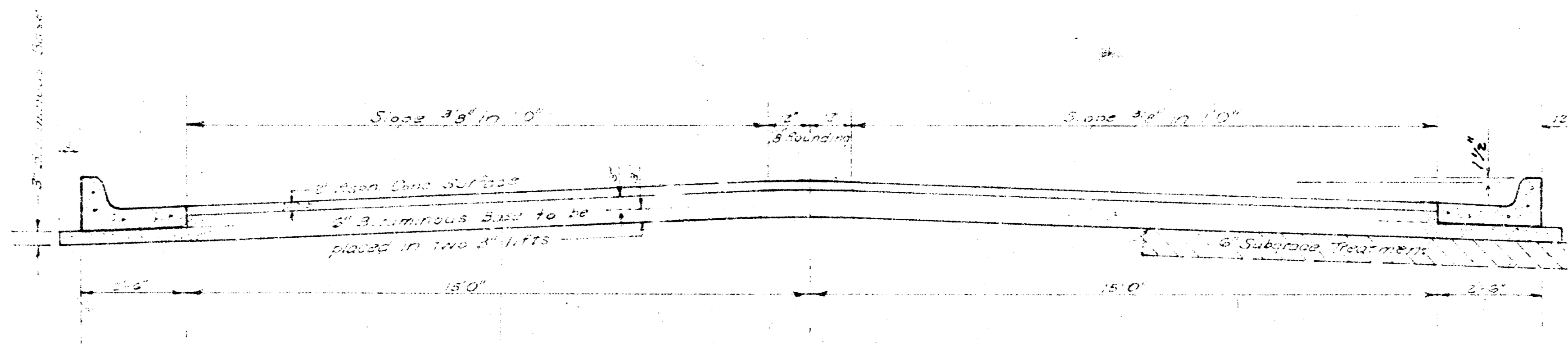

TYPICAL SECTION

35' ASPHALTIC CONCRETE PAVEMENT WITH BITUMINOUS BASE

A TACK COAT OF EMULSIFIED ASPHALT (SS-1H) SHALL BE APPLIED AT AN APPROXIMATE RATE 0.05 GALLONS PER SQ YD BETWEEN LIFTS OF ASPHALTIC MATERIALS WHEN ORDERED BY THE ENGINEER. TACK COAT WILL NOT BE PAID FOR DIRECTLY AND SHALL BE CONSIDERED AS SUBSIDIARY TO PRICE BID FOR ASPHALTIC PAVEMENT. BITUMINOUS BASE AND ASPHALTIC CONCRETE WEARING SURFACE SHALL BE PLACED WITH A LAYDOWN MACHINE HAVING AUTOMATIC ELECTRONIC CONTROLS FOR CROWN AND GRADE. CONSTRUCTION JOINTS IN EACH LIFT SHALL BE STAGGERED A MINIMUM DISTANCE OF 1' WITH JOINTS IN PRECEDING LIFTS AND PLACED SUCH THAT A JOINT WILL BE CONSTRUCTED ON THE CENTERLINE IN THE TOP LIFT.

The P.C. Payment between the curb and gutter and the subgrade shall be paid as 3" Bituminous Base. The Bituminous Base under the curb and gutter shall be paid as 3" Bituminous Base.

COMBINED CURB & GUTTER

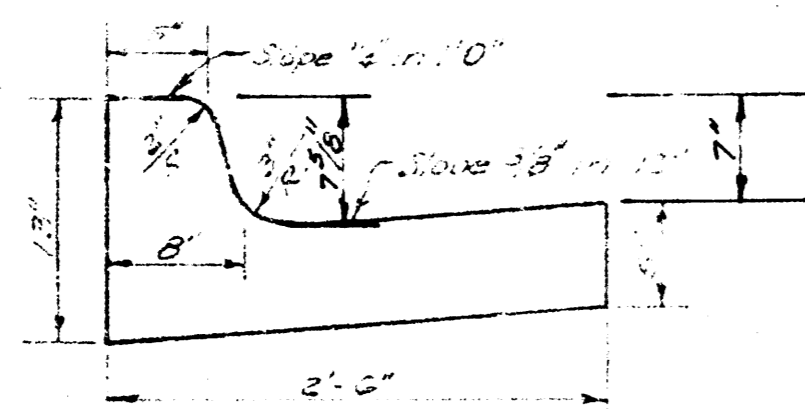

ROLL TYPE CURB & GUTTER

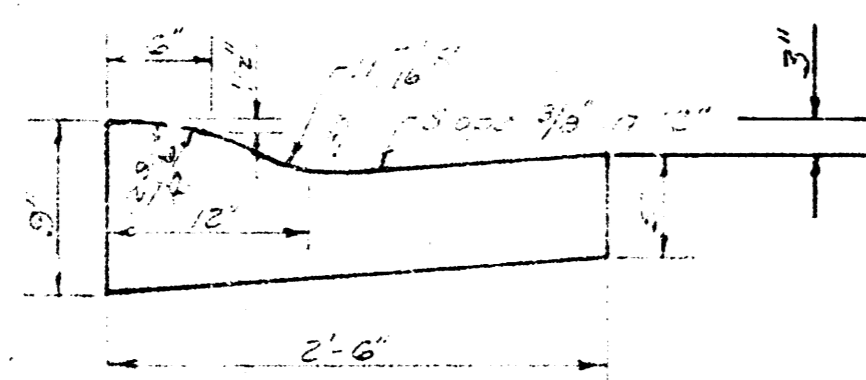

CITY OF WICHITA KANSAS

DEPARTMENT of PUBLIC WORKS - Engineering
 Division

R. W. LYNN CITY ENGINEER

DATE Sept. 1973 Proj No. DAKC410061

8/18

LONGFORD LANE
S.L. LOT 28, BLK. 5, CEDAR LAKES VILLAGE
FIRST ADDITION TO S.L. HARRY STREET.

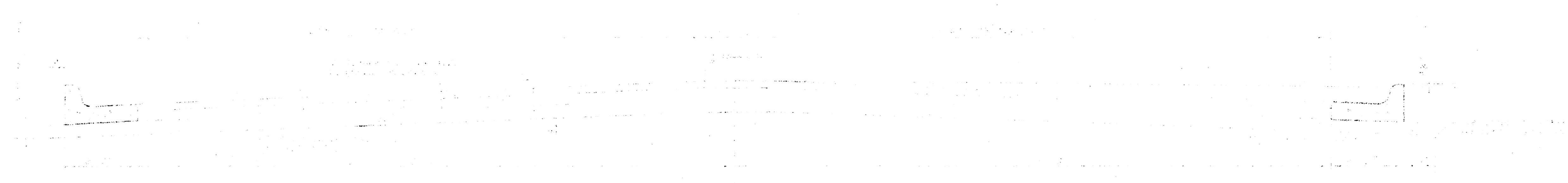

TYPICAL SECTION

4" ASPHALTIC CONCRETE PAVEMENT WITH BITUMINOUS BASE

ALL WORK SHALL BE DONE IN ACCORDANCE WITH THE SPECIFICATIONS AND STANDARDS OF THE MISSOURI DEPARTMENT OF HIGHWAYS AND TRANSPORTATION. THE CONTRACTOR SHALL BE RESPONSIBLE FOR OBTAINING ALL NECESSARY PERMITS AND APPROVALS FROM THE APPROPRIATE AGENCIES. THE CONTRACTOR SHALL MAINTAIN ACCESS TO ALL ADJACENT PROPERTIES AND UTILITIES AT ALL TIMES. THE CONTRACTOR SHALL BE RESPONSIBLE FOR PROTECTING ALL UTILITIES AND STRUCTURES TO REMAIN. THE CONTRACTOR SHALL MAINTAIN ADEQUATE DRAINAGE AND EROSION CONTROL MEASURES THROUGHOUT THE PROJECT. THE CONTRACTOR SHALL BE RESPONSIBLE FOR THE PROTECTION AND RESTORATION OF ALL NATURAL RESOURCES AND HISTORIC STRUCTURES. THE CONTRACTOR SHALL MAINTAIN ADEQUATE SAFETY MEASURES THROUGHOUT THE PROJECT. THE CONTRACTOR SHALL BE RESPONSIBLE FOR THE PROTECTION AND RESTORATION OF ALL NATURAL RESOURCES AND HISTORIC STRUCTURES. THE CONTRACTOR SHALL MAINTAIN ADEQUATE SAFETY MEASURES THROUGHOUT THE PROJECT.

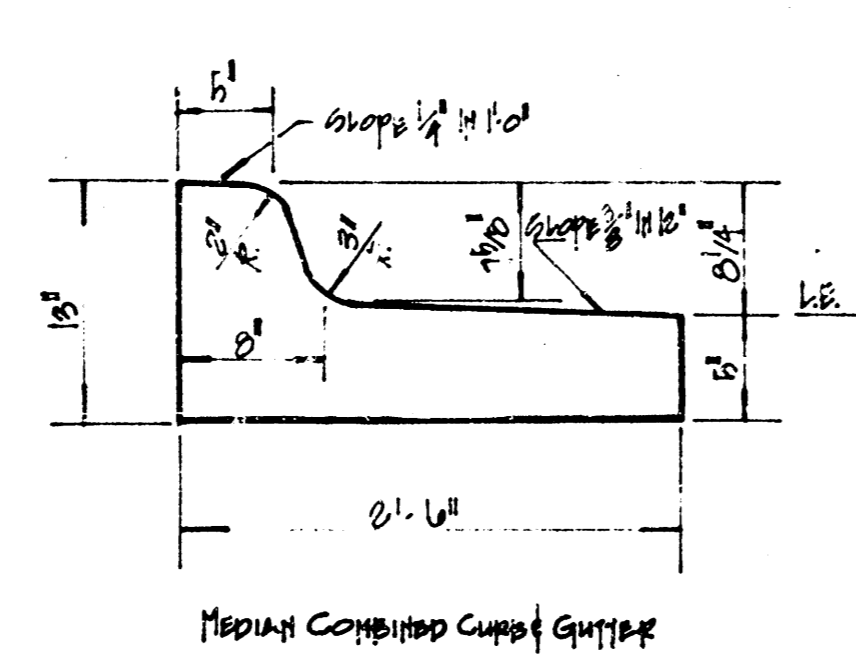
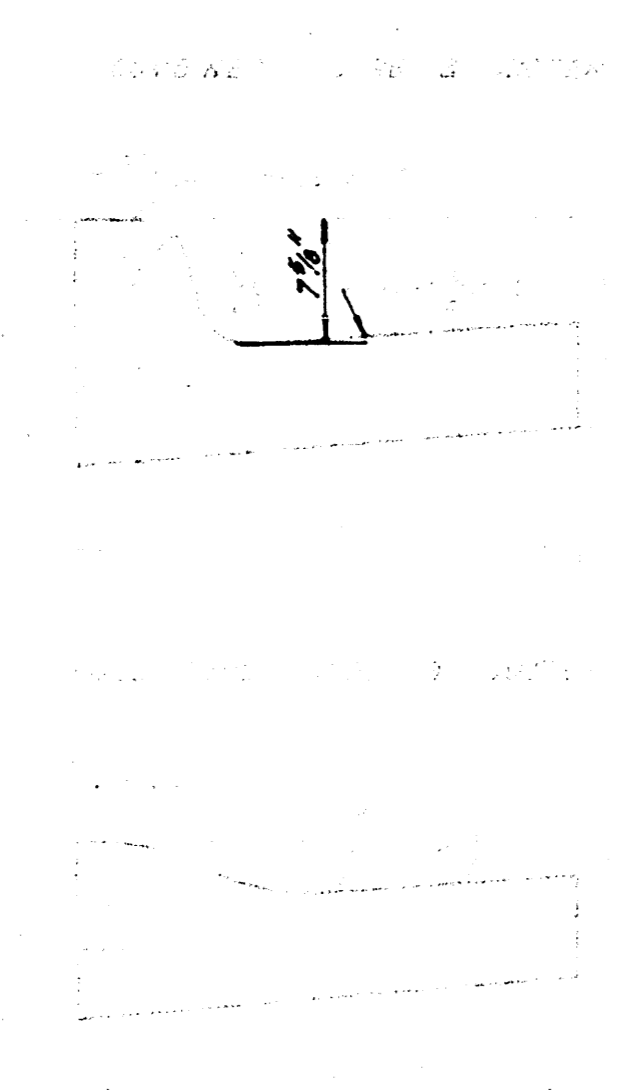

CITY OF WISHTA, MISSOURI
 DEPARTMENT OF PUBLIC WORKS
 ENGINEER
 DATE: 10/15/2018
 DRAWN BY: DANCYBORN

Survey: 8000, 81, 102, 103
 Plan: 10000
 Date: 10/10/00
 City: Lincoln
 County: Lincoln

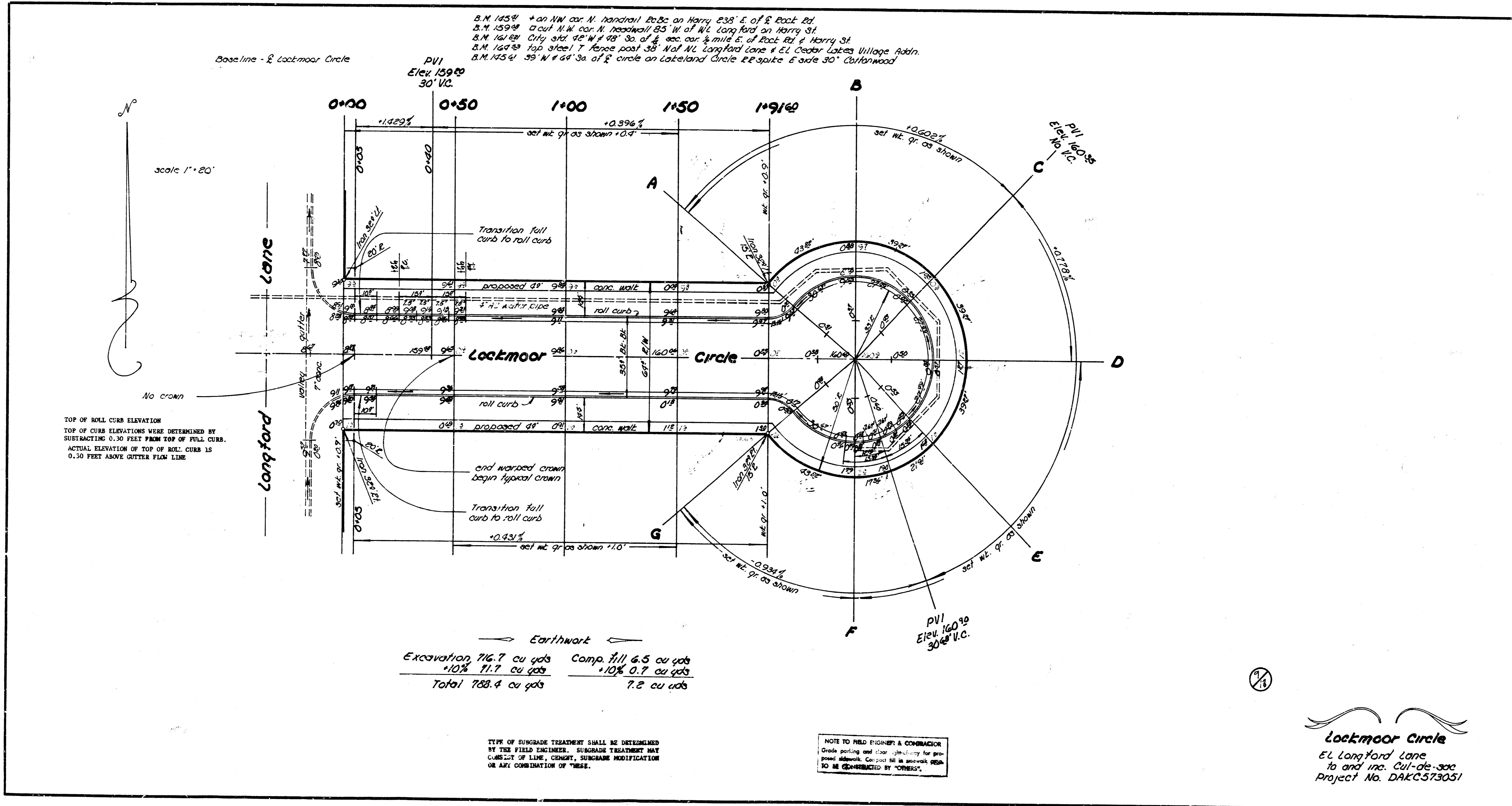

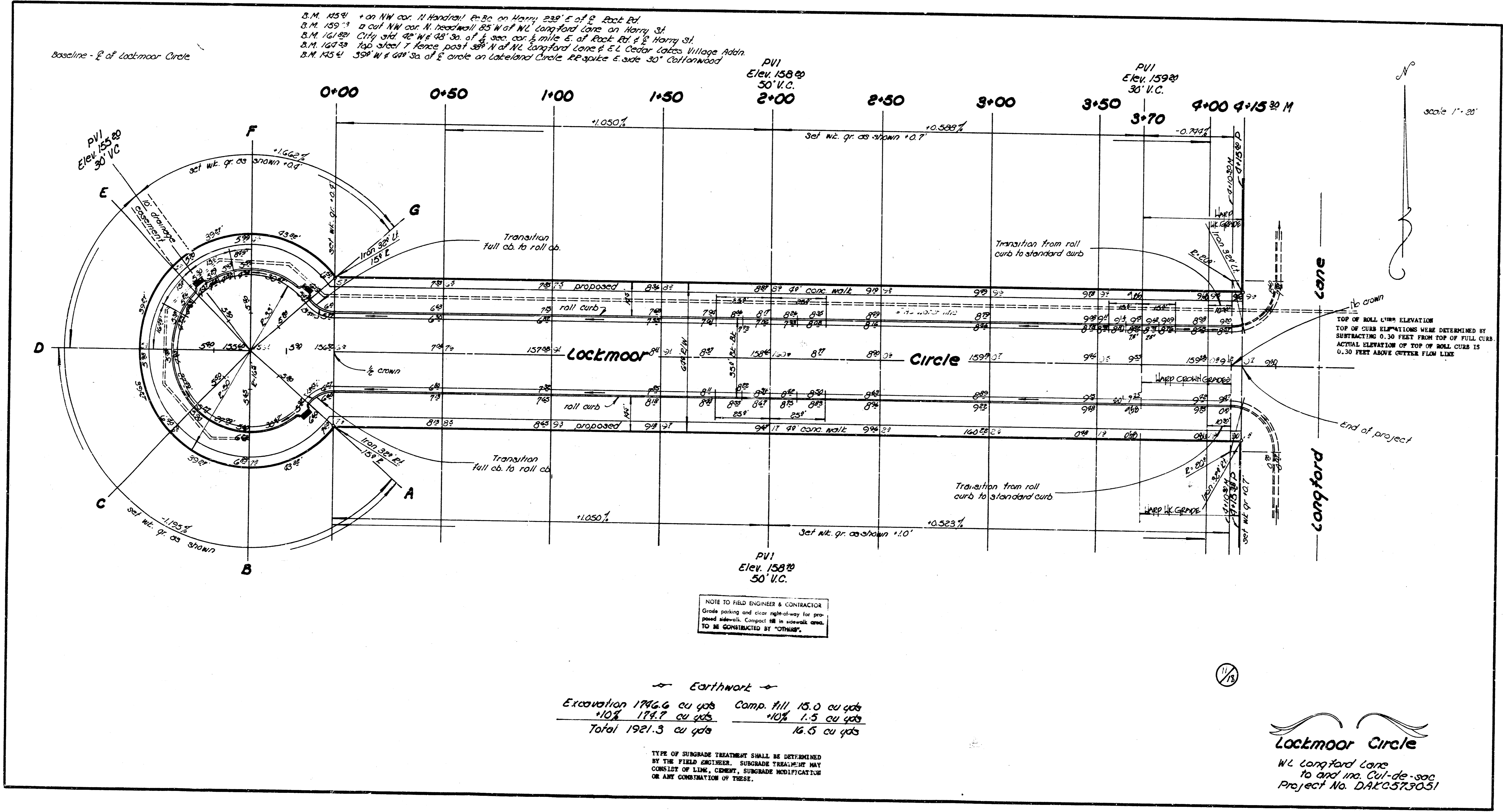

Survey Maps of 1876
 and 1877
 and 1878
 and 1879
 and 1880
 and 1881
 and 1882
 and 1883
 and 1884
 and 1885
 and 1886
 and 1887
 and 1888
 and 1889
 and 1890
 and 1891
 and 1892
 and 1893
 and 1894
 and 1895
 and 1896
 and 1897
 and 1898
 and 1899
 and 1900

TOP OF ROLL CURB ELEVATION
 TOP OF CURB ELEVATIONS WERE DETERMINED BY
 SUBTRACTING 0.30 FEET FROM TOP OF FULL CURB
 ACTUAL ELEVATION OF TOP OF ROLL CURB IS
 0.30 FEET ABOVE OUTER FLOW LINE

11/13

Baseline - E Arthur Circle

S.M. 1458 20' NW cor. N. handrail 20.0' on Harry 230' E of E Rock Rd.
 S.M. 1599 a cut NW cor. N. handrail 65' N of N Longford Lane on Harry St.
 S.M. 16182 City std. 92' W & 98' S. of 1/2 sec. cor. 1/2 mile E of Rock Rd. & Harry St. E.
 S.M. 16433 top steel T fence post 38' N of N Longford Lane & E Cedar Lakes Village Adm.
 S.M. 1454 39' W and 64' S. of E circle on Lakeland Circle R.R. spike

Survey by
 Arthur Circle
 E.L. Longford Lane
 Project No. DARC573051

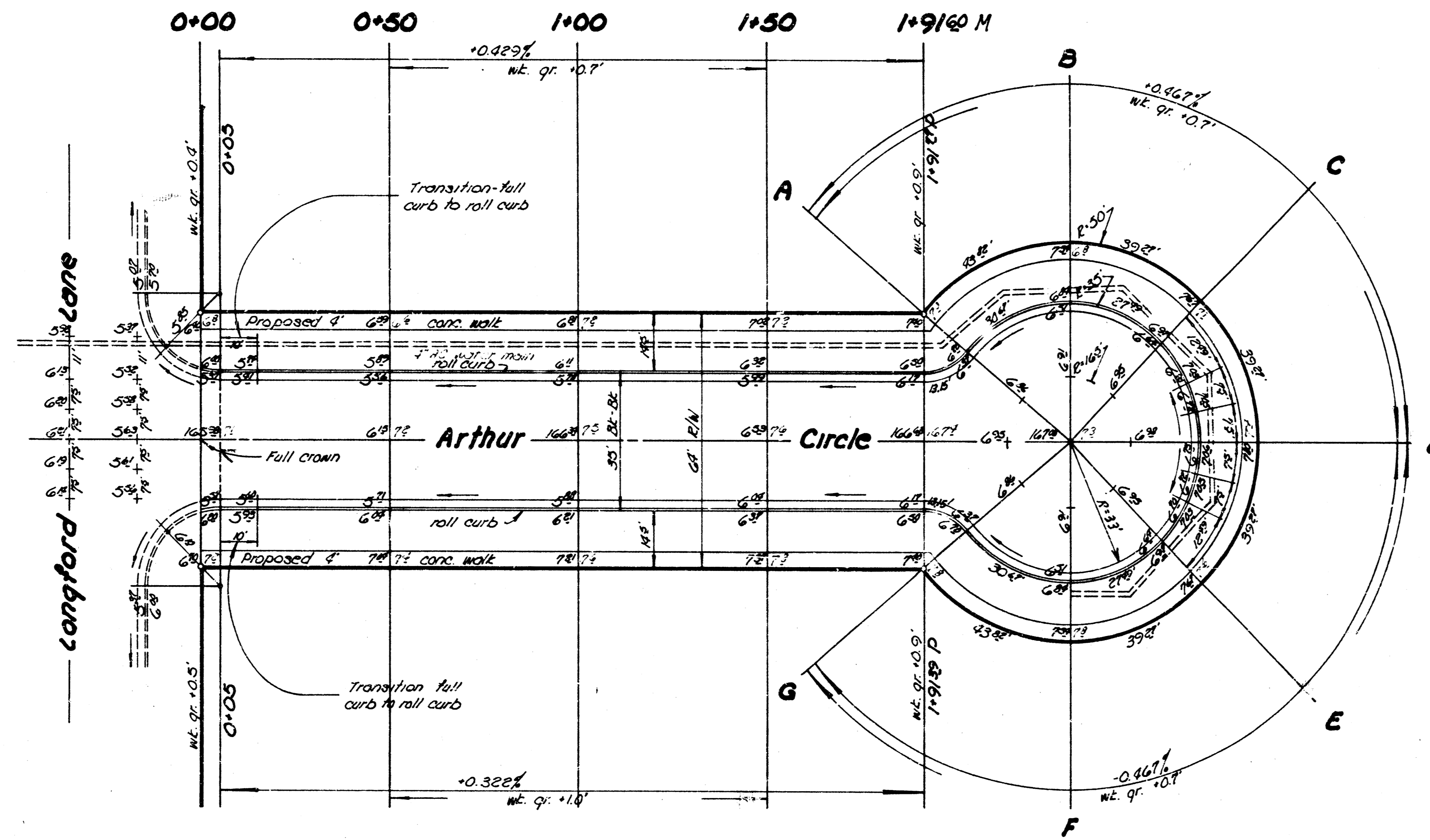

TOP OF ROLL CURB ELEVATION
 TOP OF CURB ELEVATIONS WERE DETERMINED BY
 SUBTRACTING 0.30 FEET FROM TOP OF FULL CURB.
 ACTUAL ELEVATION OF TOP OF ROLL CURB IS
 0.30 FEET ABOVE OUTER PLAW LINE

PVI
 Elev. 167.19
 30' VC

NOTE TO FIELD ENGINEER & CONTRACTOR
 Grade posting and other details for proposed sidewalk. Contractor to be constructed by "OTHERS".

→ Earthwork →

Excavation 875.3 cu yds	Comp. fill 2.0 cu yds
+10% 87.5 cu yds	+10% 0.2 cu yds
<u>Total 962.8 cu yds</u>	<u>2.2 cu yds</u>

TYPE OF SURGRADE TREATMENT SHALL BE DETERMINED BY THE FIELD ENGINEER. SURGRADE TREATMENT MAY CONSIST OF ASPHALT, CEMENT, SURGRADE MODIFICATION OR ANY COMBINATION OF THESE.

Arthur Circle
 E.L. Longford Lane
 10 & 1/2 sec. Cul-de-sac
 Project No. DARC573051

4/13

B.M. 145' on NW cor. N. handrail R.R. Co. Harry St. E. of Rock Road
 B.M. 159' on NW cor. N. handrail 65' N of W. Longford Lane on Harry Street
 B.M. 161' City St. 42' N of 48' 30" of 1/2 mile cor. 1/2 mile E. of Rock & Harry Street
 B.M. 164' Top steel T fence post 35' N of N. Longford Lane & S. Cedar Lakes Village Addn
 B.M. 155' 39' W of 30' of 1/2 circle on Lakeview Circle R.R. spike E. side 30' Cottonwood.

Survey: 1933 21-147%
 Plan: 1000
 Checked:

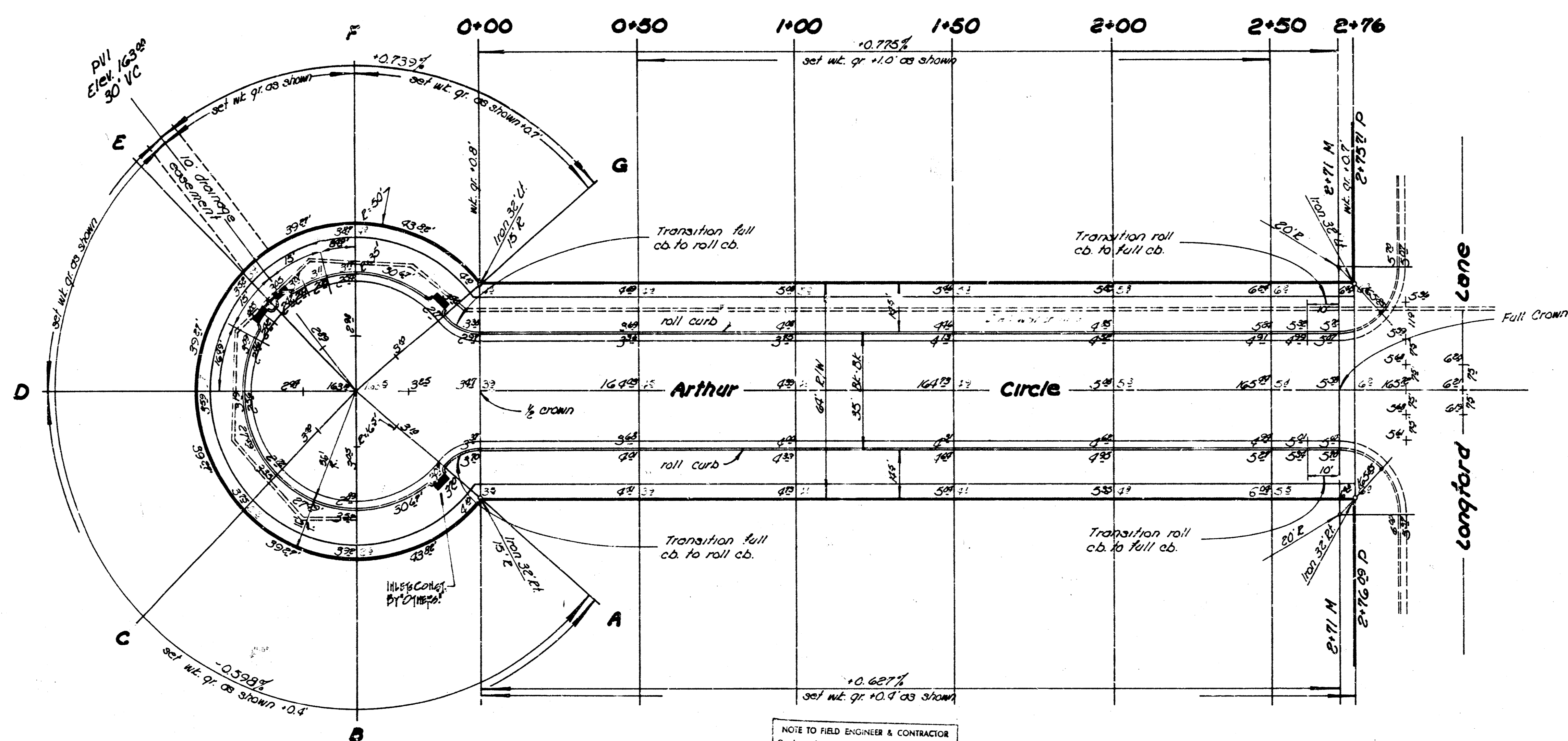

Scale 1" = 20'

TOP OF ROLL CURB ELEVATION
 TOP OF CURB ELEVATIONS WERE DETERMINED BY
 SUBTRACTING 0.30 FEET FROM TOP OF FULL CURB.
 ACTUAL ELEVATION OF TOP OF ROLL CURB IS
 0.30 FEET ABOVE TYPICAL PLAN LINE

NOTE TO FIELD ENGINEER & CONTRACTOR
 Grade parking and clear right-of-way for proposed sidewalk. Contract fill to sidewalk area to be constructed by "OTHER".

Earthwork

Excavation	711.6 cu yds	Comp. Fill	24.9 cu yds
+10%	78.2 cu yds	+10%	2.5 cu yds
Total	815.8 cu yds		27.4 cu yds

TYPE OF SURGRADE TREATMENT SHALL BE DETERMINED BY THE FIELD ENGINEER. SURGRADE TREATMENT MAY CONSIST OF LIME, CEMENT, SURGRADE MODIFICATION OR ANY COMBINATION OF THESE.

Arthur Circle
 W. Longford Lane
 to 1/2 inc. Cul-de-sac
 Project No. DAC573031