

CATHERINE AVENUE
 EL Kay to WL Gordon
 Sheet 2 of 4.

B.M. 108.60 NW cor. conc. porch Ho # 1803 Gordon on N side of house.
 B.M. 107.55 E. NE. cor. conc. porch Ho # 1955 Catherine, on N side of house.
 B.M. 108.34 SW cor. conc. porch Ho # 1812 Catherine.
 B.M. 109.20 SW cor. conc. porch Ho # 1802 Catherine.
 Chaining from 5 to 4 on S & W property lines.

NOTICE TO CONTRACTOR:
 All entrance pipes are to be disposed of in accordance
 with instructions of City Dirt Checker.

Transition Totals-

Station 0+00
 Station 0+50
 Station 1+00
 Station 1+50
 Station 2+00
 Station 2+50
 Station 3+00
 Station 3+50
 Station 4+00
 Station 4+50
 Station 5+00

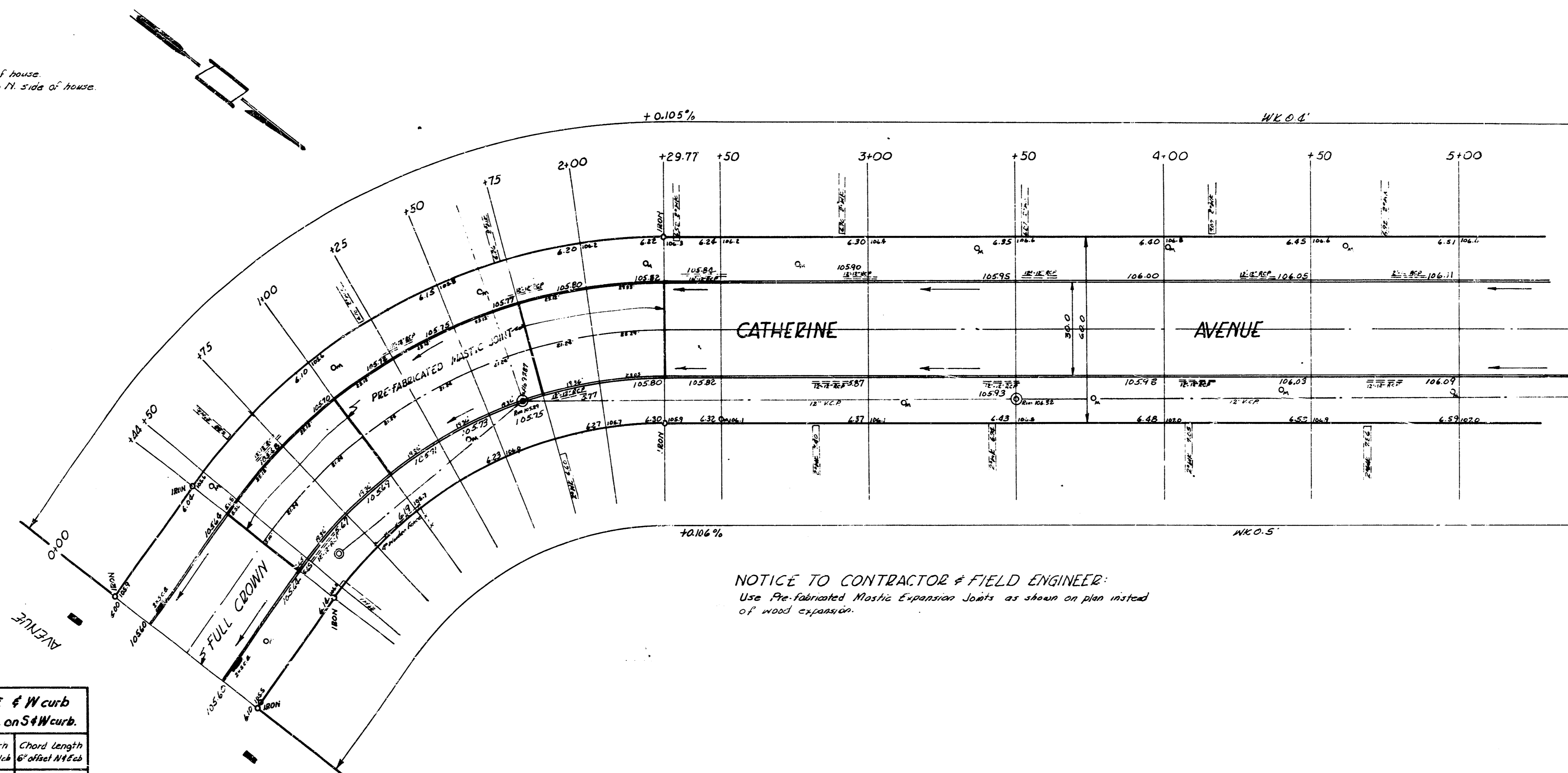

NOTICE TO CONTRACTOR & FIELD ENGINEER:
 Use Pre-fabricated Mastic Expansion Joints as shown on plan instead
 of wood expansion.

CURVE DATA: Sta. 0+44 to 2+29.77 - 6° offset E & W curb
R = 190.51 Δ = 53° 21' Defl = 9.0225 min. / ff arc. Sta. on S & W curb.

Station	Arc Length 6° offset	Deflection Angle	Total Deflection	Chord length 6° offset Sta. to Sta.	Chord length 6° offset 1/2 Sta.
0+44					
0+50	5.78	0° 21' 48"	0° 51' 48"	5.78	4.47
0+75	23.87	3° 35' 28"	4° 27' 04"	23.86	18.60
1+00	"	5° 35' 28"	8° 02' 26"	23.86	18.60
1+25	"	"	11° 37' 48"	23.86	18.60
1+50	"	"	15° 13' 10"	23.86	18.60
1+75	"	3° 35' 28"	18° 48' 38"	23.86	18.60
2+00	23.87	3° 35' 28"	22° 24' 50"	23.86	18.60
2+29.77	28.43	4° 16' 30"	26° 40' 23"	28.40	22.16

Sheet 1 of 4.

CATHERINE AVENUE
 EL Kay to WL Gordon
 30' Conc & Cb.
 CITY OF WICHITA, KANSAS
 B.E. SMITH CITY ENGINEER
 APRIL 1957 PROJ. NO. C16-199

