

# CASADO AVENUE

EAST LINE ST. PAUL AVE. TO WEST LINE RICHMOND AVENUE  
CITY OF WICHITA, KANSAS

R. W. BRUGGEMAN DIRECTOR OF ENGINEERING / CITY ENGINEER

DATE: \_\_\_\_\_

PROJ. NO. 472 76 245 81167 000 000 001

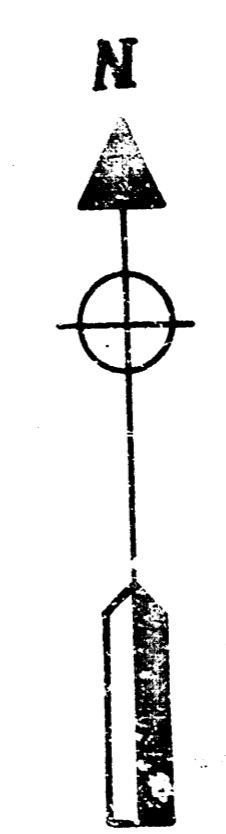
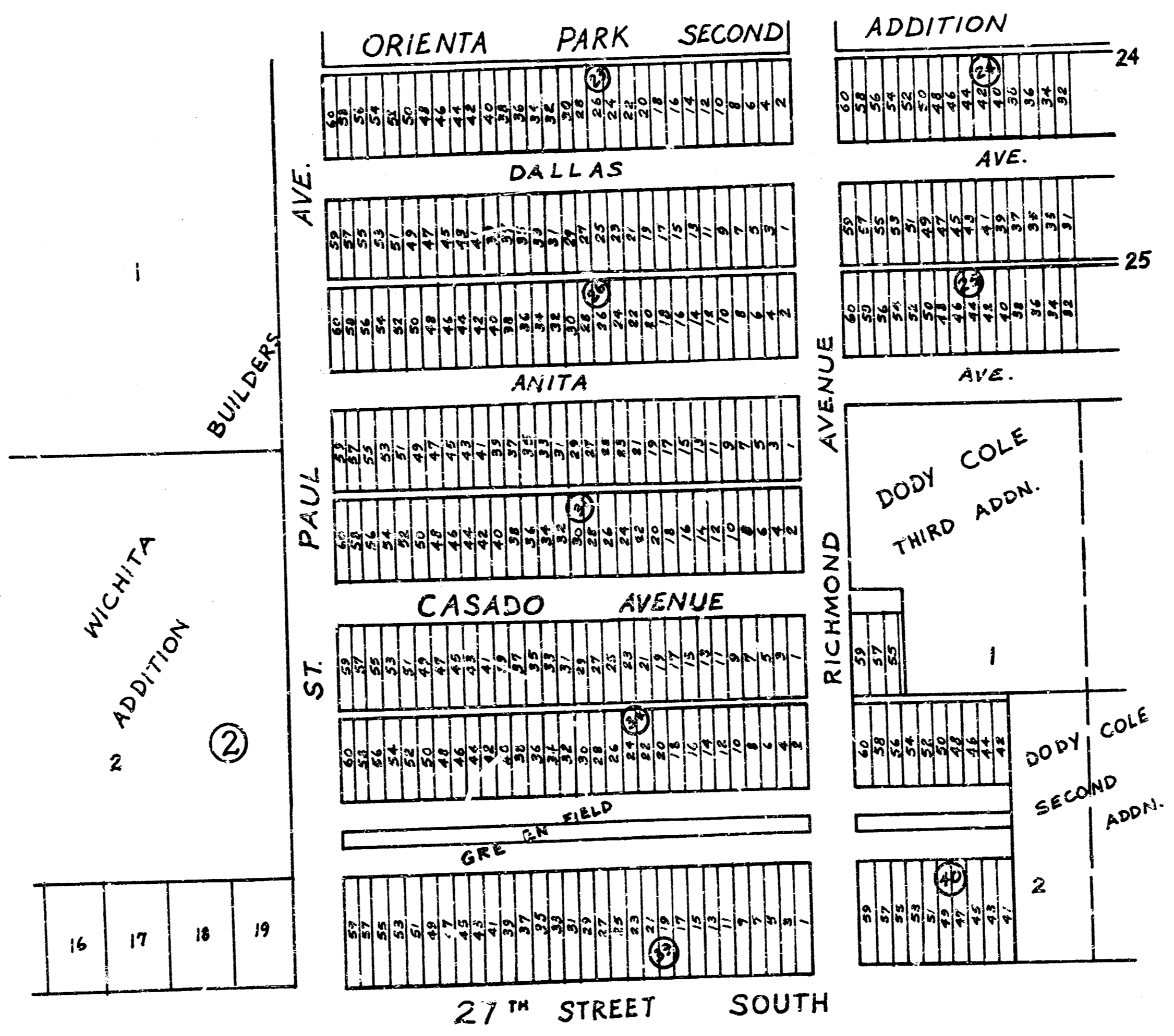

SCALE 1" = 150'

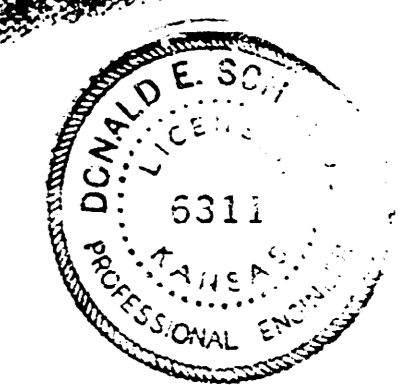

LOCATION MAP

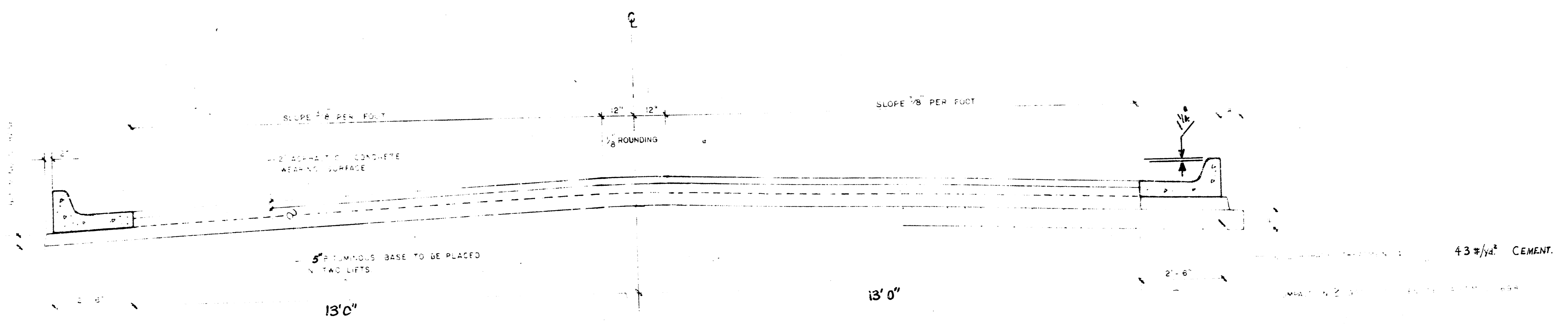

## TYPICAL SECTION

### ASPHALTIC CONCRETE PAVEMENT WITH BITUMINOUS BASE

A TACK COAT OF EMULSIFIED ASPH (SS-1H or CSS-1H) SHALL BE APPLIED AT AN APPROXIMATE RATE 0.05 GALLONS PER SQ YD BETWEEN LIFTS OF ASPHALTIC MATERIALS WHEN ORDERED BY THE ENGINEER. TACK COAT WILL NOT BE PAID DIRECTLY AND SHALL BE CONSIDERED AS SUBSIDIARY TO PRICE BID FOR ASPHALTIC PAVEMENT. BITUMINOUS BASE AND ASPHALTIC CONCRETE WEARING SURFACE SHALL BE PLACED WITH A LAYDOWN MACHINE HAVING AUTOMATIC CONTROL FOR CROWN AND GRADE. CONSTRUCTION JOINTS IN EACH LIFT SHALL BE STAGGERED A MINIMUM DISTANCE OF 1' WITH JOINTS IN PRECEDING LIFTS AND PLACED SUCH THAT A JOINT WILL BE CONSTRUCTED ON THE CENTERLINE IN THE TOP LIFT.

THE A.C. PAVEMENT BETWEEN THE COMBINED CURB AND GUTTER SHALL BE PAID AS 50 YDS 7" A.C. PAVEMENT  $2\frac{1}{2}$ " BITUMINOUS BASE. THE BITUMINOUS BASE UNDER THE COMBINED CURB AND GUTTER SHALL BE PAID AS 50 YDS  $2\frac{1}{2}$ " BITUMINOUS BASE.

COMBINED CURB & GUTTER

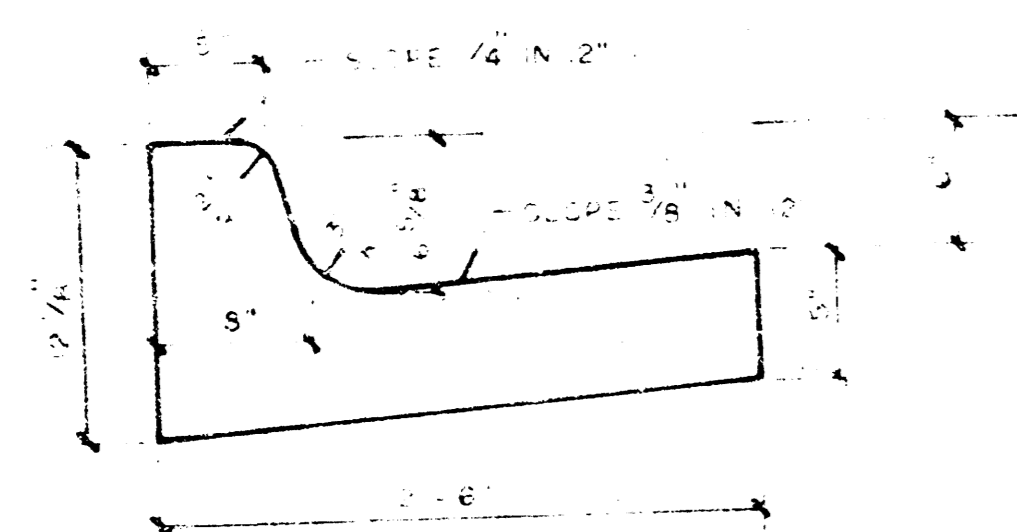

ROLL TYPE CURB & GUTTER

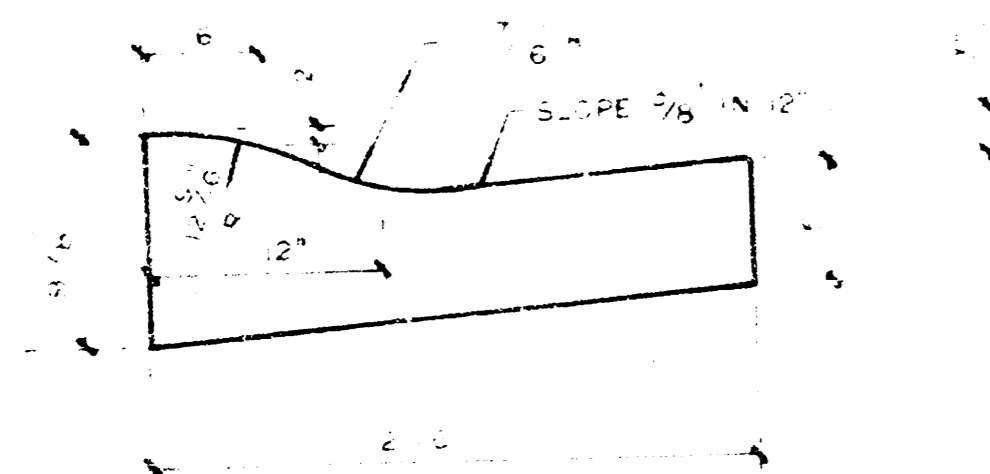

### DETAIL OF TRANSVERSE CONSTRUCTION JOINTS

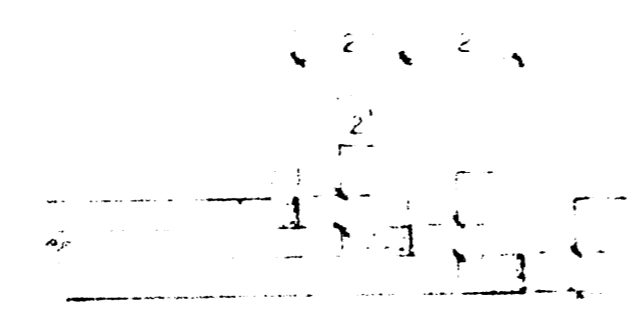

TRANSVERSE CONSTRUCTION JOINTS SHALL BE CONSTRUCTED IN FLEXIBLE PAVEMENTS AT LOCATIONS WHERE PAVEMENT TEMPORARILY ENDS TO FACILITATE FUTURE PAVEMENT CONSTRUCTION AS SHOWN BY DETAIL. THE COST OF CONSTRUCTING THE TRANSVERSE CONSTRUCTION JOINT SHALL NOT BE MEASURED OR PAID FOR DIRECTLY BUT SHALL BE INCLUDED IN THE BID PRICE FOR SQUARE YARDS OF A.C. PAVEMENT.

CITY OF WICHITA, KANSAS

BM 99.62 City Standard Disc, Meridian and 27<sup>th</sup> street South, 42.5' N. and 44' E. of C. of both.  
BM 101.72 Rail Road Spike West Face Street Light Pole Southeast Corner of Casado Ave & St. Paul.  
Base Line is Center Line of CASADO AVENUE.

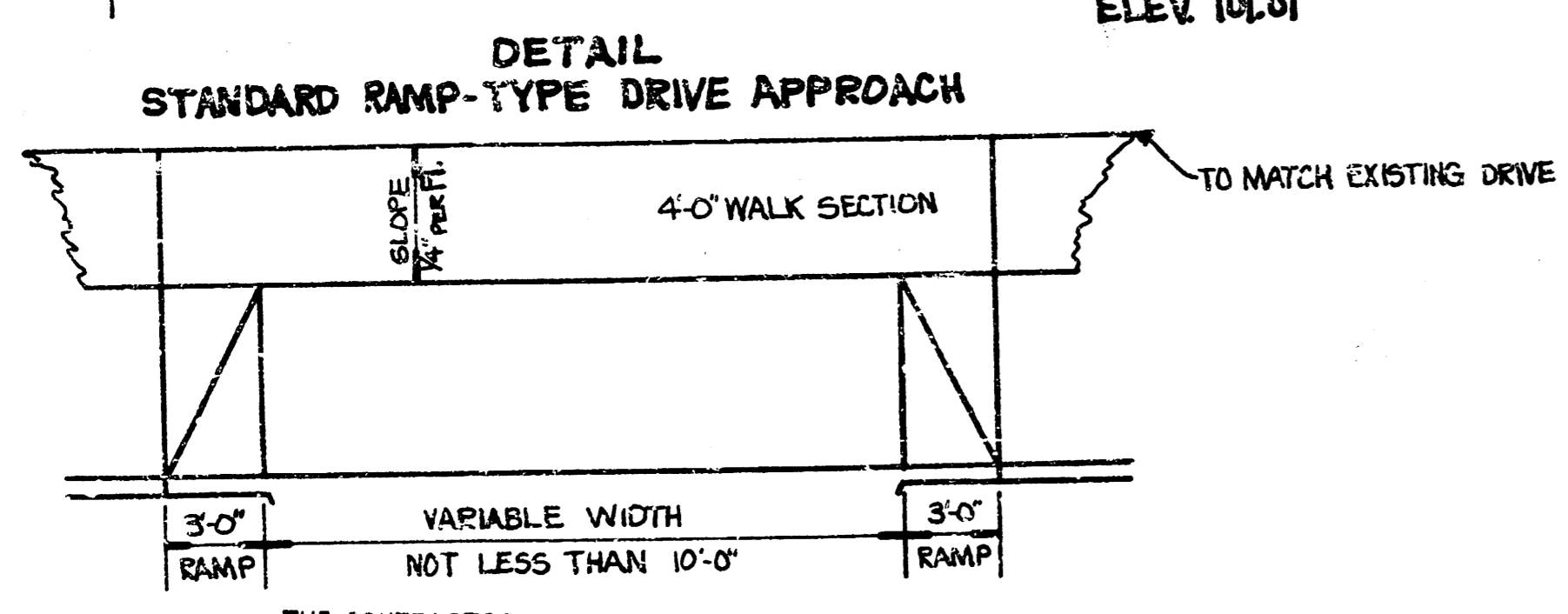
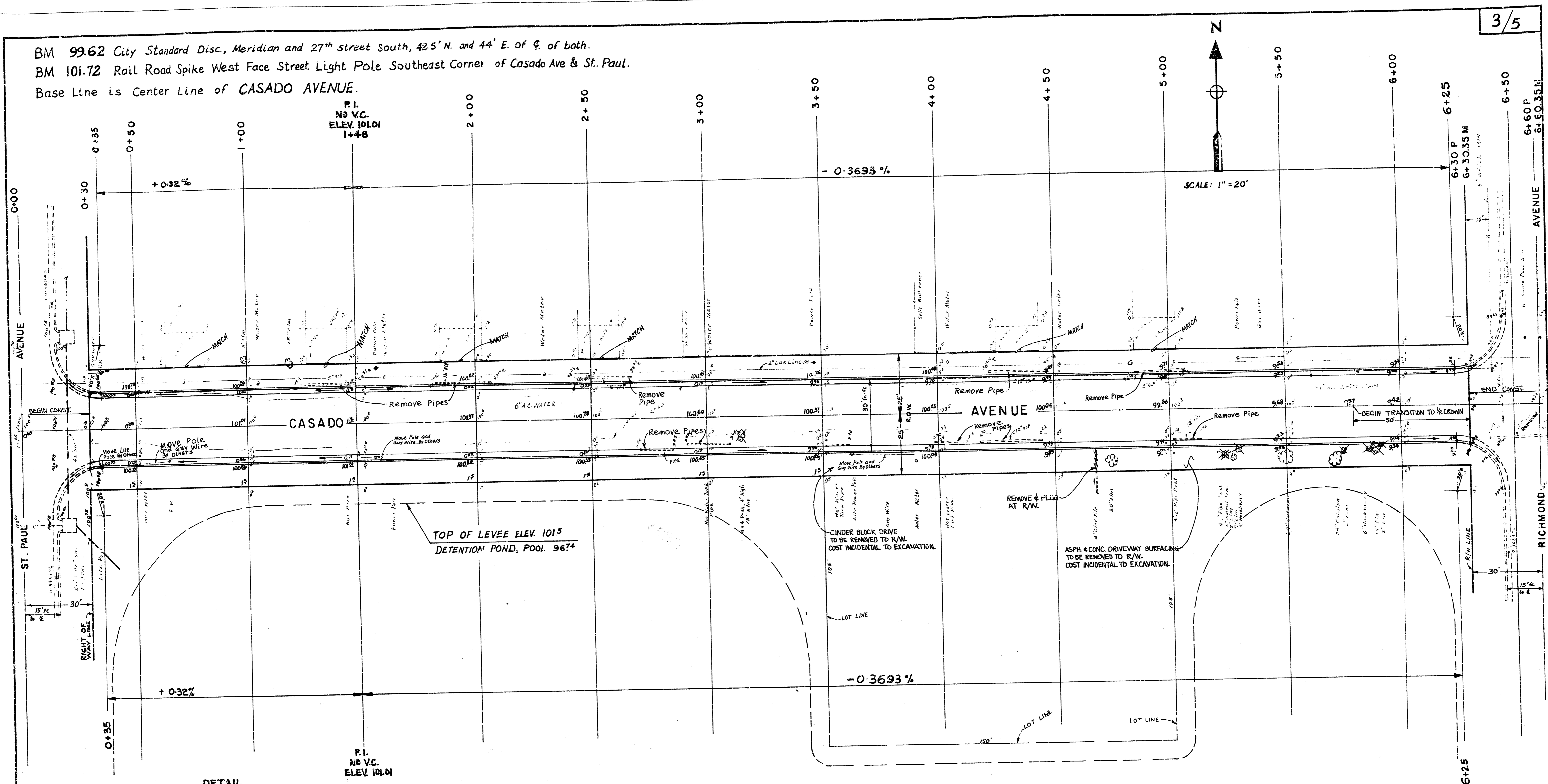

NOTE:—Construct Roll Type Curb on this Project.  
—Pavement shall be 7" Asphaltic Concrete with 5" Bituminous Base and 2" Wearing Surface.  
—Trees to be Removed are Marked thus . Except that any tree marked for removal, which in the opinion of the Engineer can be saved shall be spared.  
—NO MORE THAN 12-20 FOOT DRIVES TO BE CONSTRUCTED ON THIS PROJECT.  
—HOT WATER TANKS (STA. 3400 RT. & 3456 RT.) BEING USED AS CULVERTS ARE TO BE REMOVED AS "L.I.N. FT. PIPE REMOVED".  
—COST OF HEADWALL REMOVAL & CONCRETE REMOVAL ASSOCIATED WITH CULVERT REMOVAL SHALL BE CONSIDERED INCIDENTAL TO "CULVERT PIPE REMOVED".  
—CURB SHALL BE DEPRESSED THRU DRIVES CONSTRUCTED AS A PART OF THIS CONTRACT.

EARTHWORK  
EXCAVATION  
4.76.13 C.Y.  
+10% 47.61  
TOTAL 523.74 C.Y.

Manipulation = 2225 s.y.

PROJECT DESCRIPTION	
CASADO AVENUE, from East Line of St. Paul to West Line of Richmond Avenue.	
PROJECT NUMBER	
472 76 245 81167 000 000 001	
BOOK NO. DCD 39	A-PROVED BY
DRAWN BY Y.D.D.	DATE JUL 1982
CITY OF WICHITA	
DEPARTMENT OF ENGINEERING	
DIRECTOR OF ENG./CITY ENGINEER R. W. BRUGGEMAN	SCALE 1" = 20'

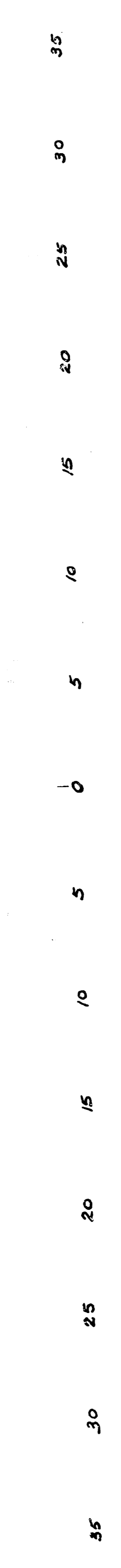
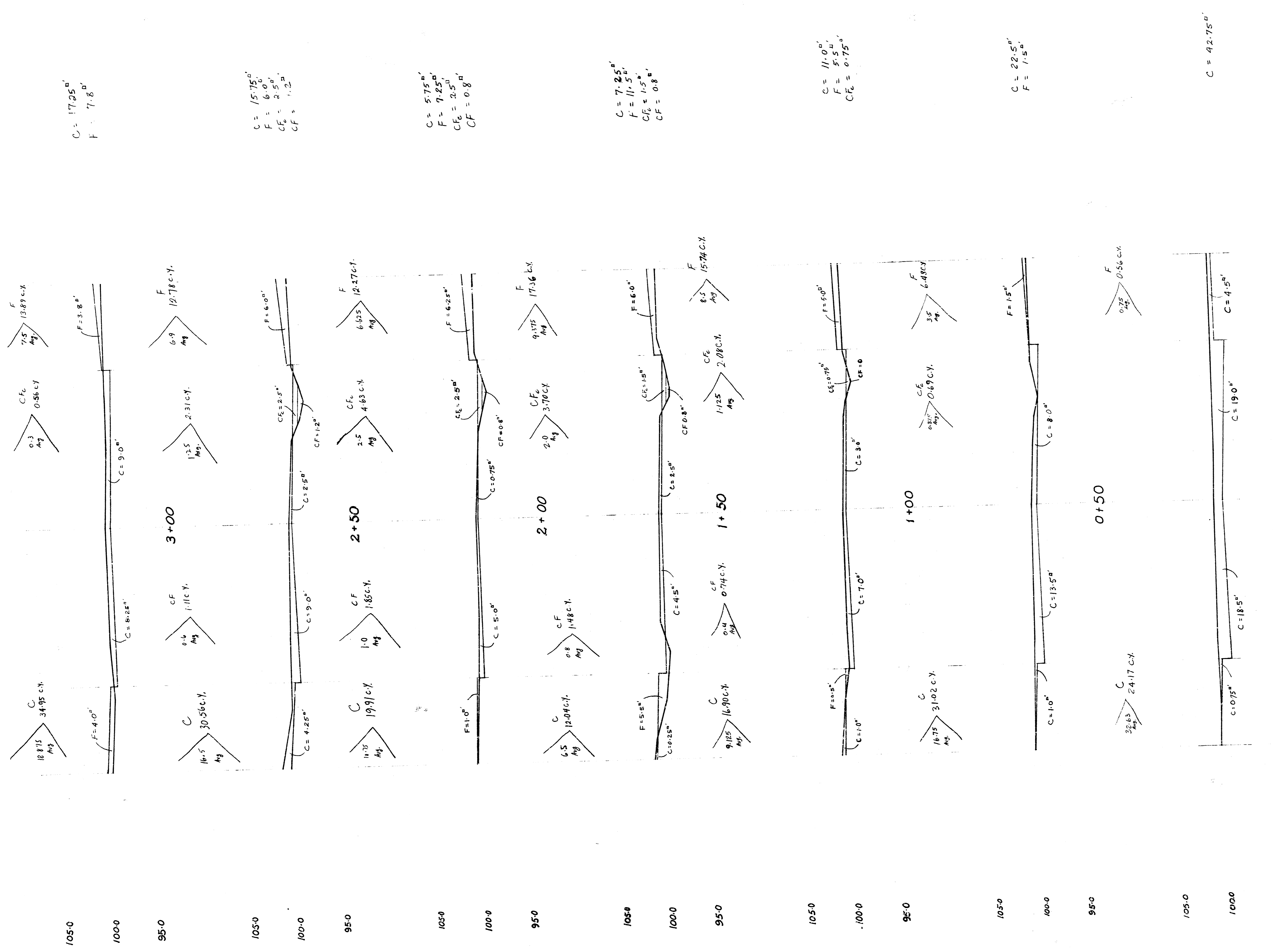

EARLY WORK THIS SHEET		COMMITTED FILL
EXCAV. C.	LOOSE FILL, F	CF
169.55 c.y.	79.08 c.y.	1397 c.y.
TOTALS		511 c.y.
476.13 c.y.	108.33 c.y.	5.18 c.y.

CASADO AVENUE  
 E.L. ST. PAUL TO W.L. RICHMOND AVE.  
 PROJ. No. 472 76 245 81167 000 000 001

4/5

1050

1000

950

1050

1000

950

1050

1000

950

1050

1000

950

1050

1000

950

1050

1000

950

1050

1000

950

C = 51.0'

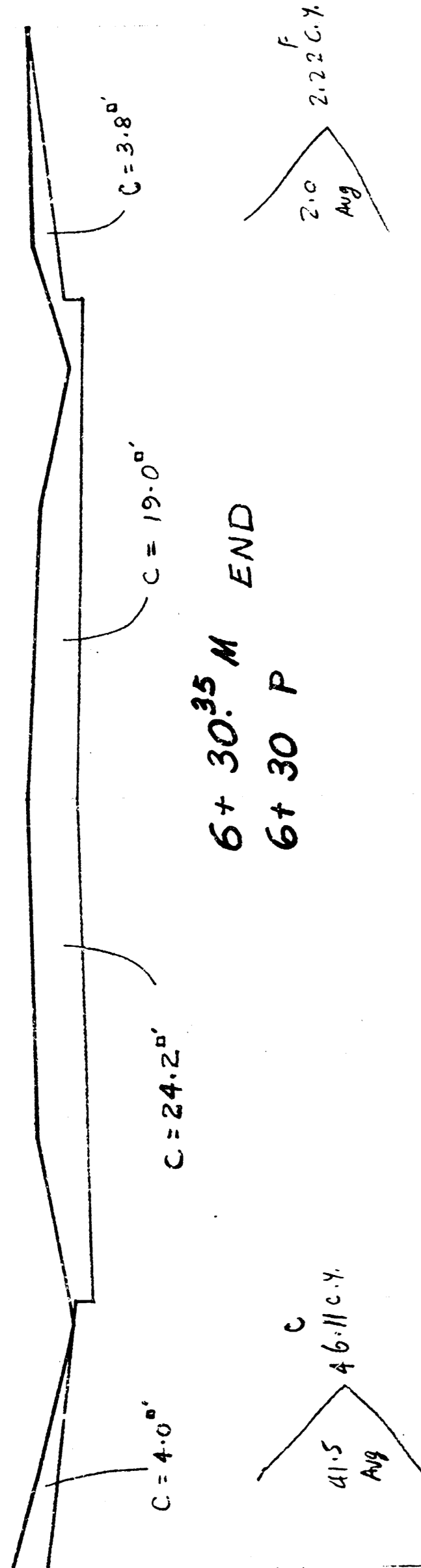

C = 32.0'  
F = 4.0'

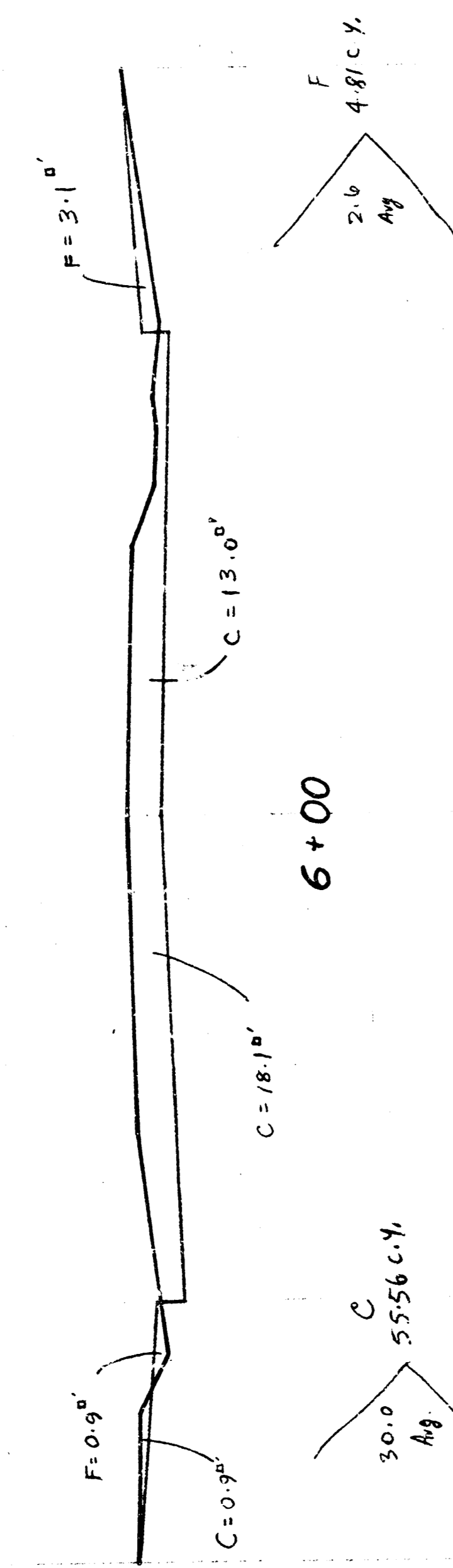

C = 28.0'  
F = 1.2'

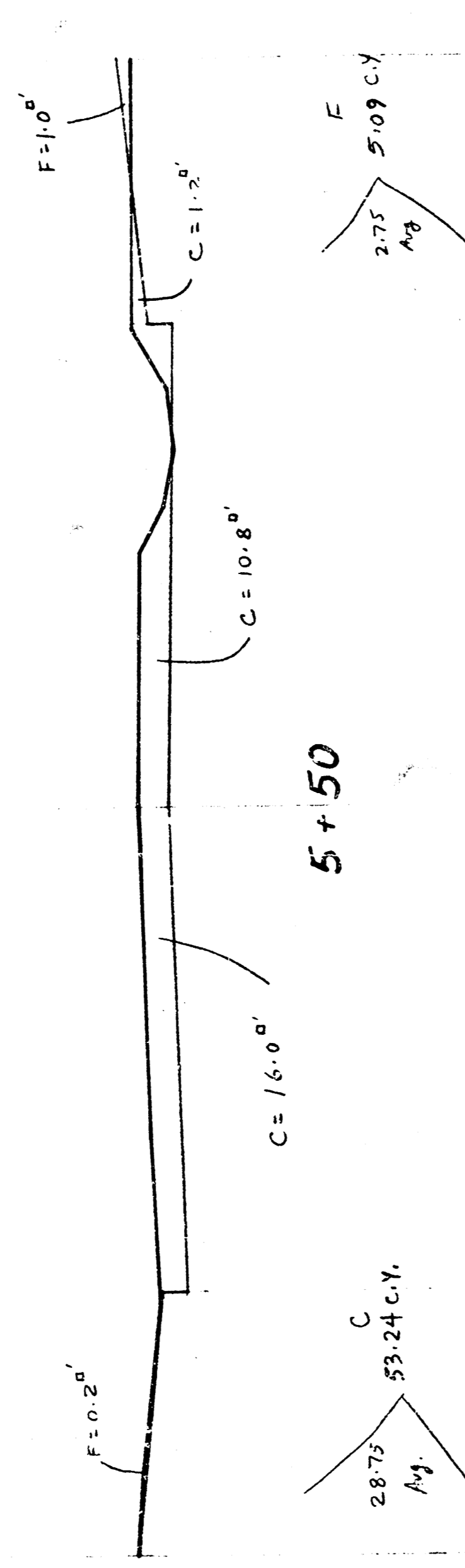

C = 29.5'  
F = 4.3'

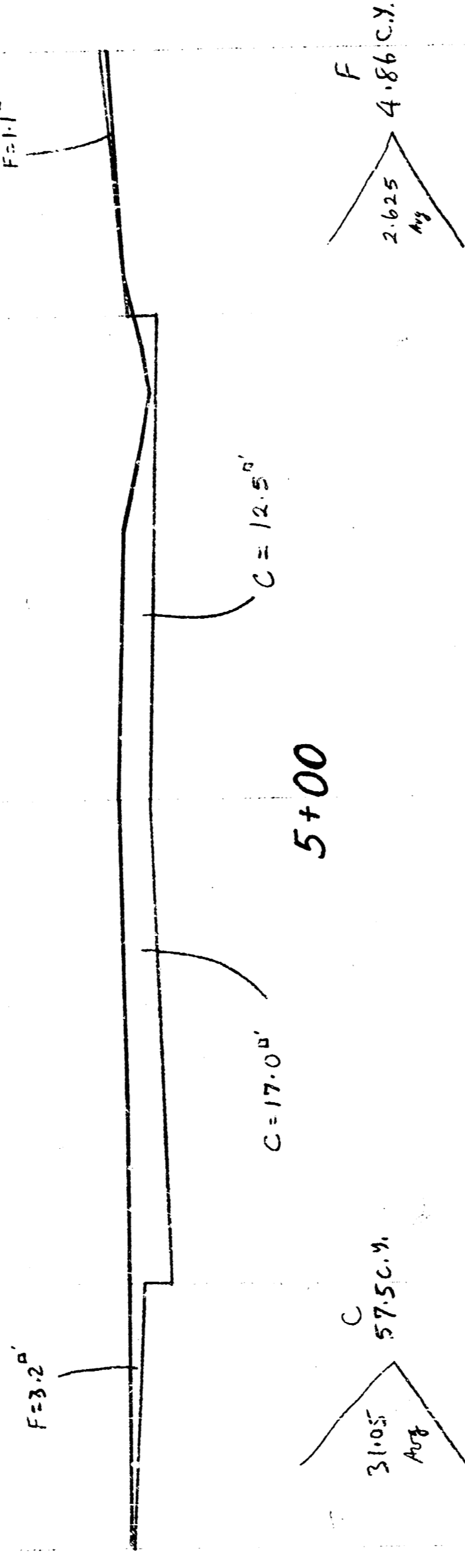

C = 32.6'  
F = 0.95'

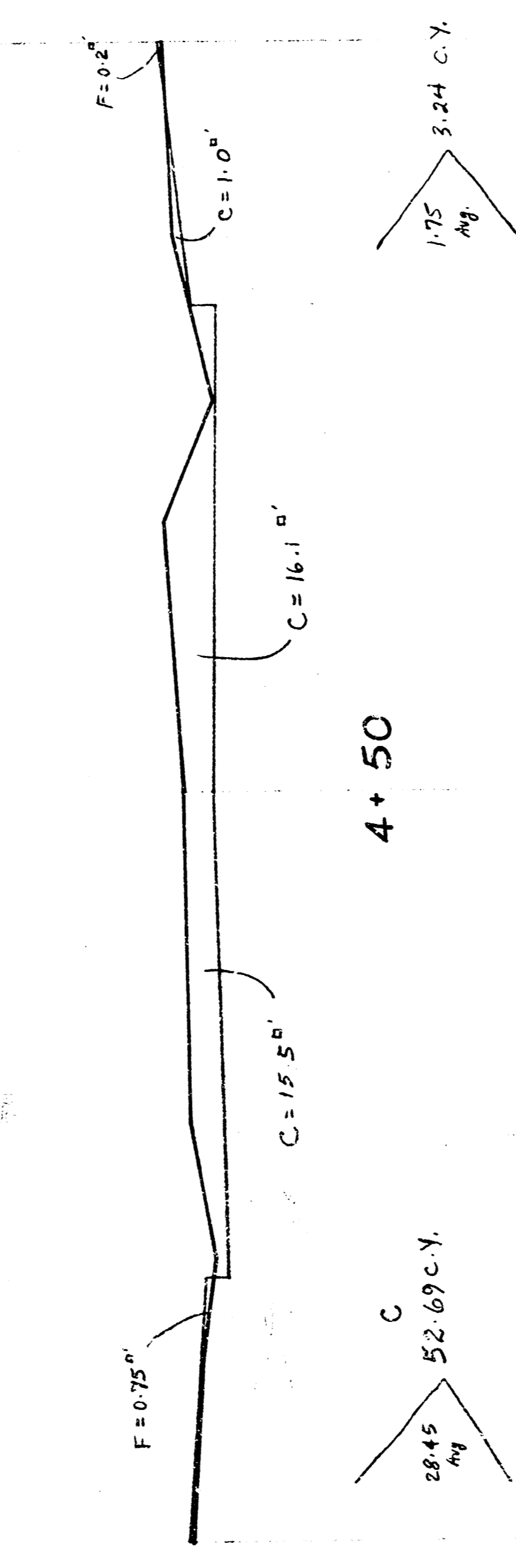

C = 24.3'  
F = 2.53'

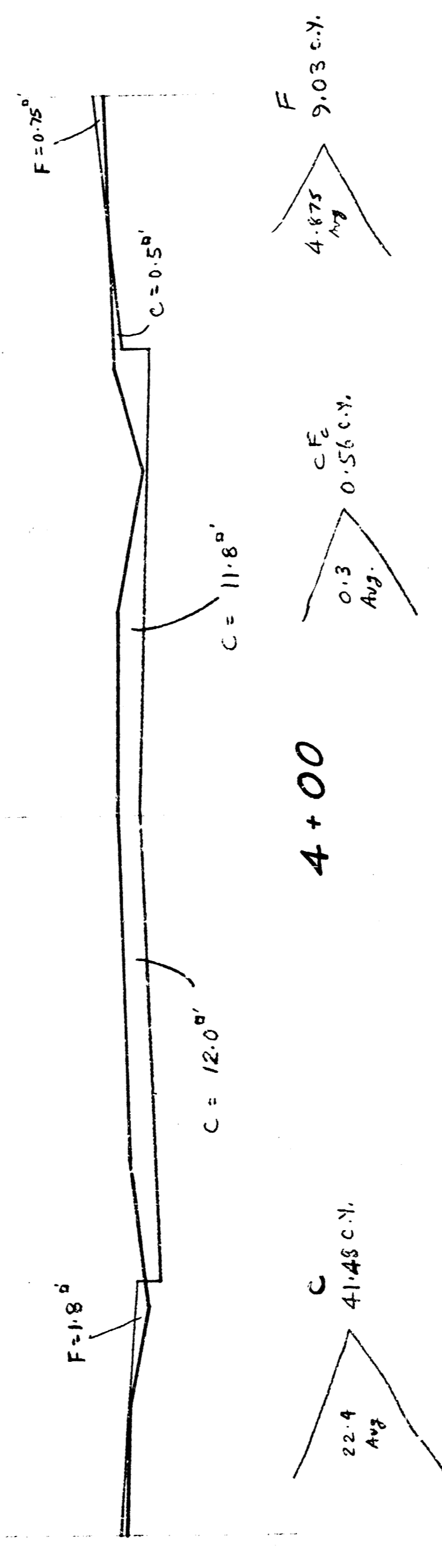

C = 30.5'  
F = 7.2'  
CE = 0.6'

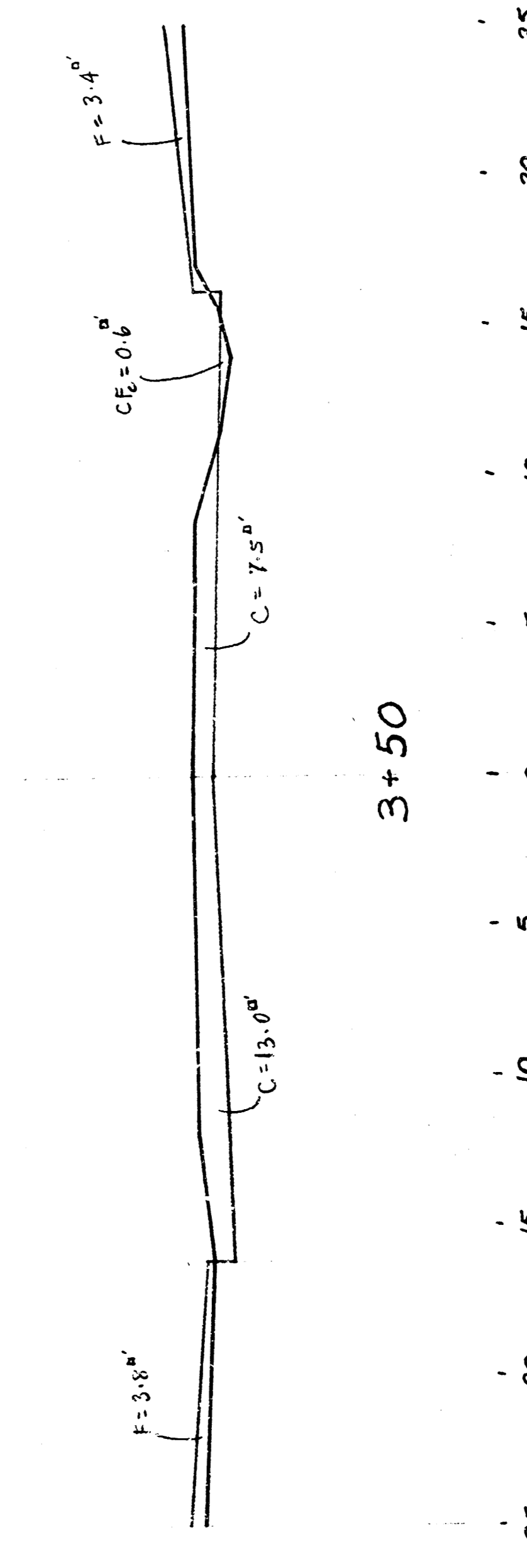

35 30 25 20 15 10 5 0 5 10 15 20 25 30 35

3+50

EARTHWORK TILLS SHEET I

EXCAV. C 306.58 C.Y. LOOSE FILL, F 29.25 C.Y. (COMPACTED FILL, F CALCULATED, C.Y. 0.56 C.Y.)

CASADO AVENUE  
E.L. ST. PAUL TO W.L. RICHMOND AVE.  
PROJ. No. 472 76 245 81167 000 000 001

5/5

FILMED FROM THE BEST