

BM=99.667 Standard NE cor. Meridian & 27th St. Sa.
 BM=100.76 Double site ES Tel. Pole, NE cor. Meridian & Casado
 BM=98.97 "B" in Ritchie, S. & Anna & EL Everett

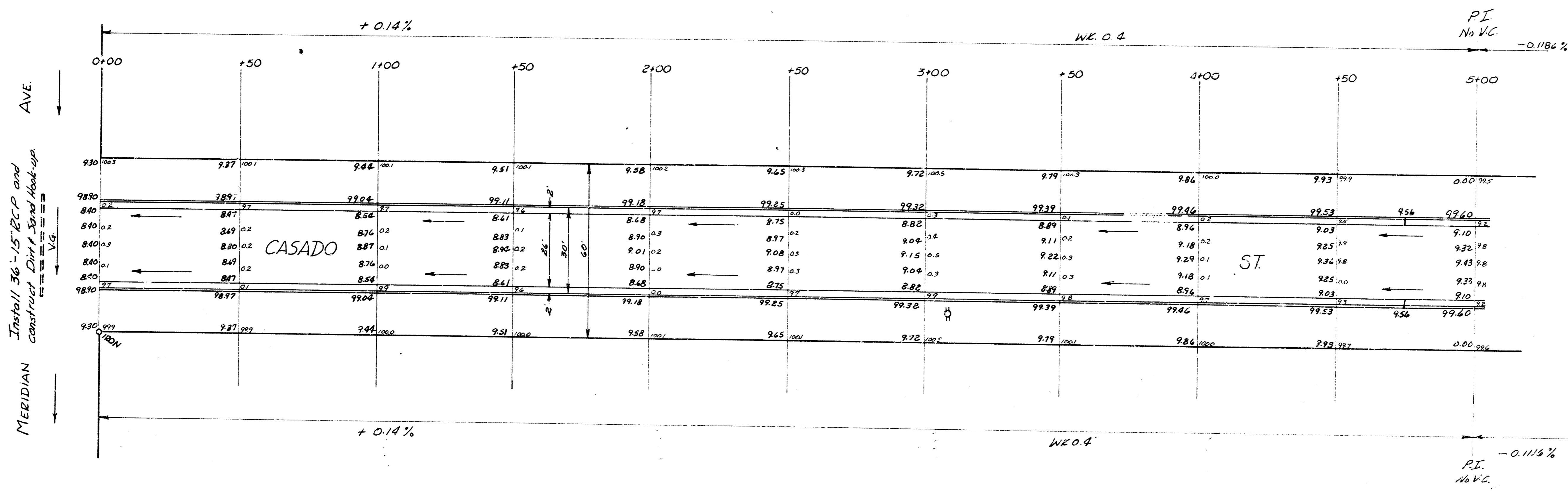
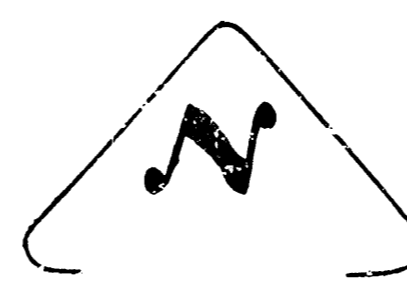

City Mills & Citrus
 Green

Sheet 1 of 2

CASADO ST
 EL Meridian WL Everett
 26-2-30 AC
 CITY OF WICHITA, KANSAS
 B. E. SMITH CITY ENGINEER
 JULY 1936 PROJ NO C14-238



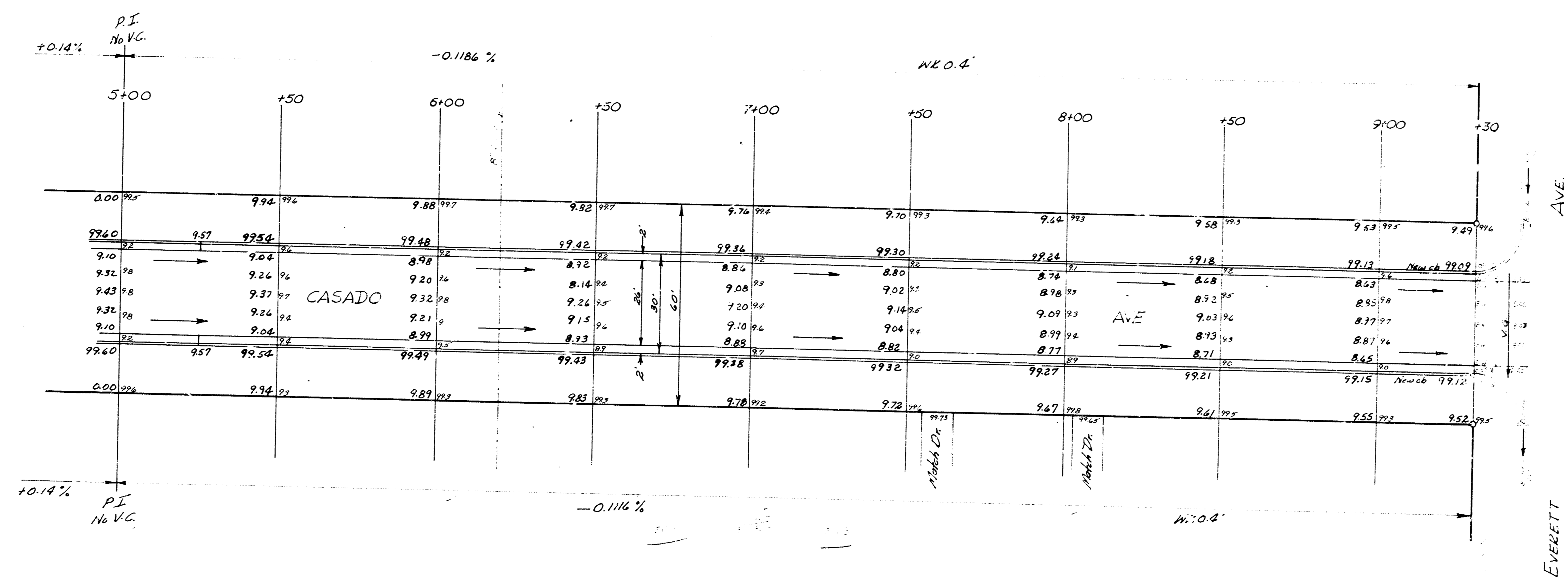
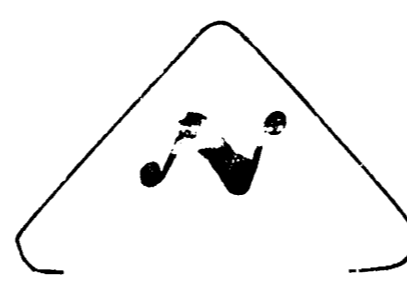

CASADO AVE 014-238
Sheet 2 of 11