

34'-11.35" on E. side Roseberry St. Paving
 " 14.74' on entrance walk, Nos. 3763 Cessna
 " 14.61' NW cor. porch - Nos. 4131 Cessna.

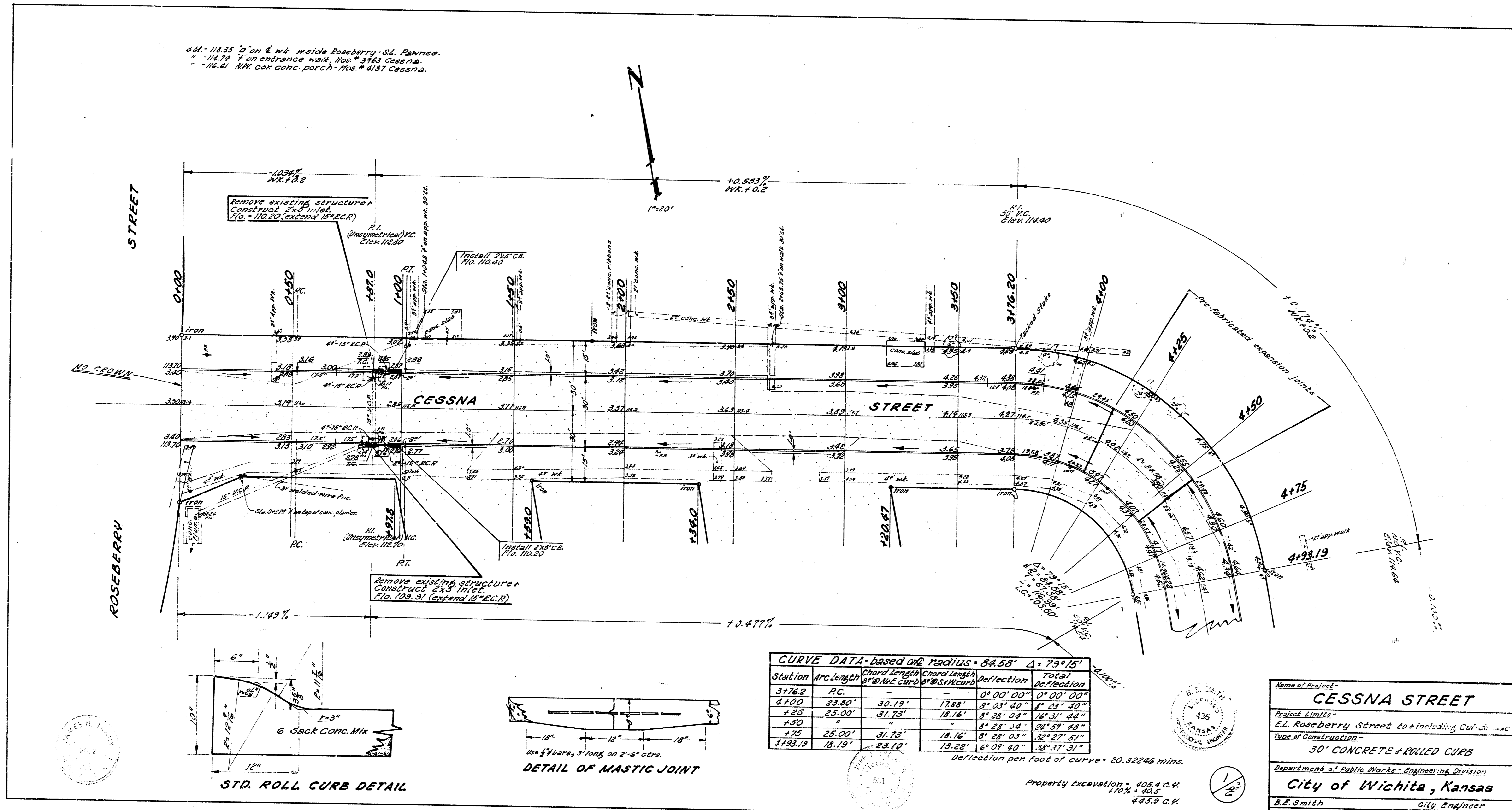

Survey
 Plan
 Check

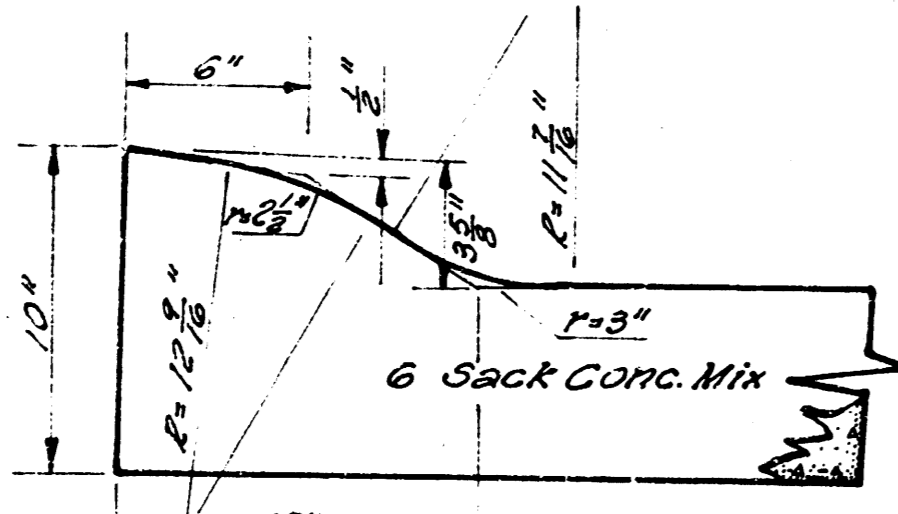

STD. ROLL CURB DETAIL

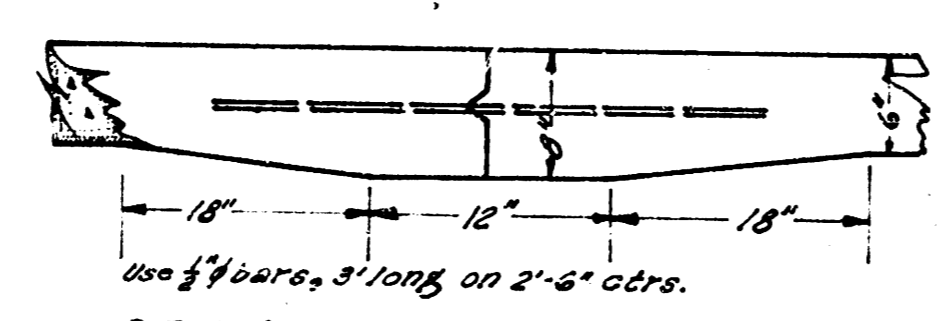

DETAIL OF MASTIC JOINT

CURVE DATA - based on radius = 84.58' Δ = 79°15'

| Station | Arc Length | Chord Length | Chord Length at 1/2" Curbs | Deflection | Total Deflection |
|---------|------------|--------------|----------------------------|------------|------------------|
| 3+76.2 | P.C. | - | - | 0° 00' 00" | 0° 00' 00" |
| 4+00 | 23.80' | 30.19' | 17.88' | 8° 03' 40" | 8° 03' 40" |
| 4.25 | 23.00' | 31.75' | 18.16' | 8° 28' 06" | 16° 31' 46" |
| 4.50 | " | " | " | 8° 51' 18" | 25° 23' 04" |
| 4.75 | 25.00' | 31.75' | 18.16' | 8° 28' 06" | 33° 51' 10" |
| 4+99.19 | 18.19' | 23.10' | 13.22' | 6° 01' 40" | 39° 52' 50" |

Deflection per foot of curve = 20.32246 mins.

Property Excavation = 405.4 C.Y.
 110% = 445.9 C.Y.
 445.9 C.Y.

Name of Project - **CESSNA STREET**

Project Limits - **E. Roseberry Street to including Cur. Jct. 11820**

Type of Construction - **30' CONCRETE & ROLLED CURB**

Department of Public Works - Engineering Division

City of Wichita, Kansas

B.F. Smith City Engineer

Date - MARCH 1962 Proj. No. C19-836

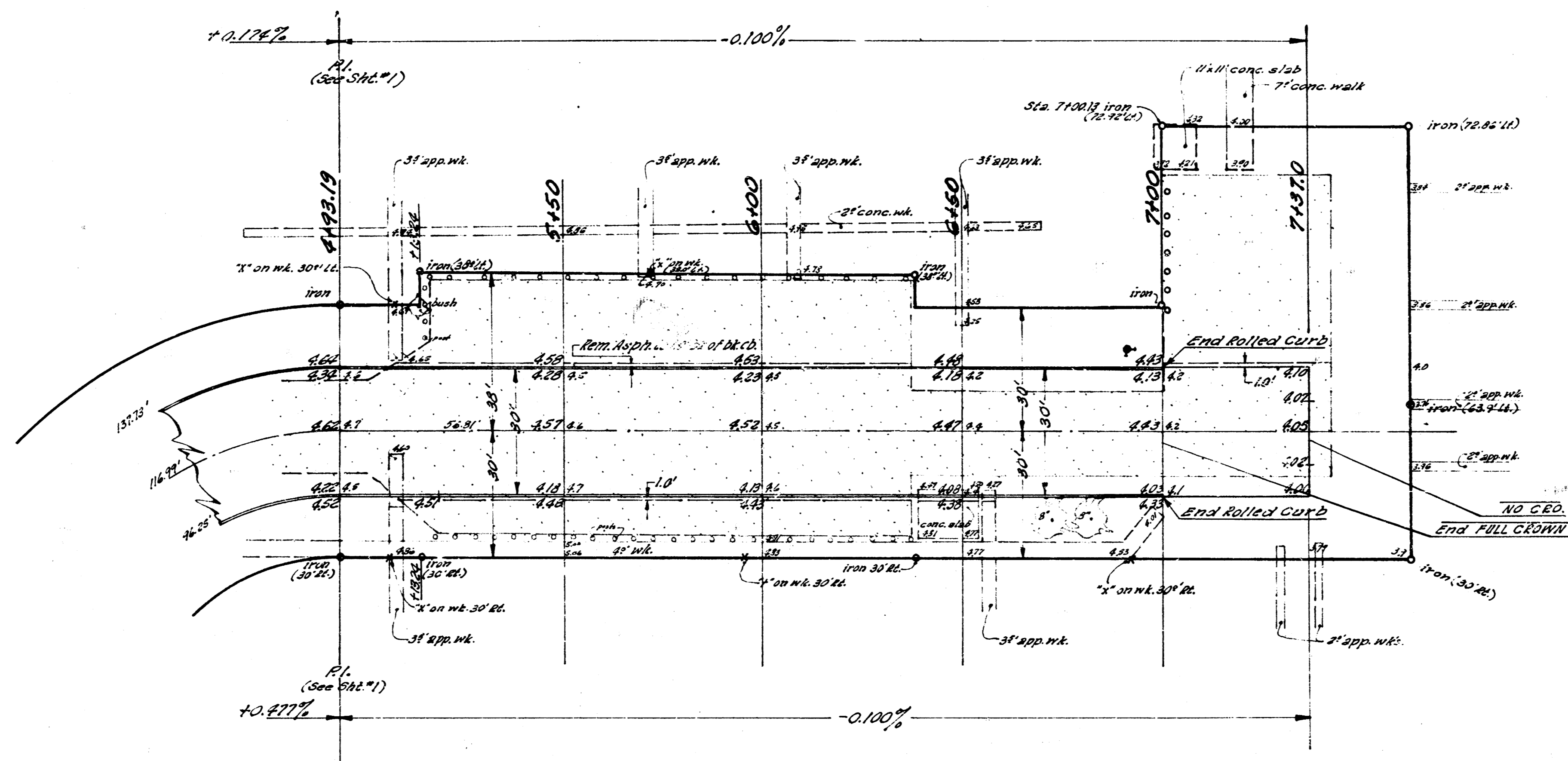
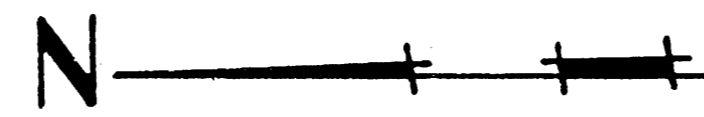

NOTE - Remove asphalt surf separately from earth excavation and dispose of it in the area of Planview according to Dept. of Street Maintenance. Asphalt surf to be paid for by the owner of land from which it is not to be deducted from the total quantity of C.R. excavation.

CESSNA STREET
C/19-296

