

CHARLES AVE.

FROM NORTH LINE 29TH STREET NORTH TO SOUTH LINE 31ST STREET NORTH
PROJECT NO. 472 - 76 - 245 - 81471 - 000 - 000 - 001

IMPROVEMENT DISTRICT MAP
SCALE 1" = 150'

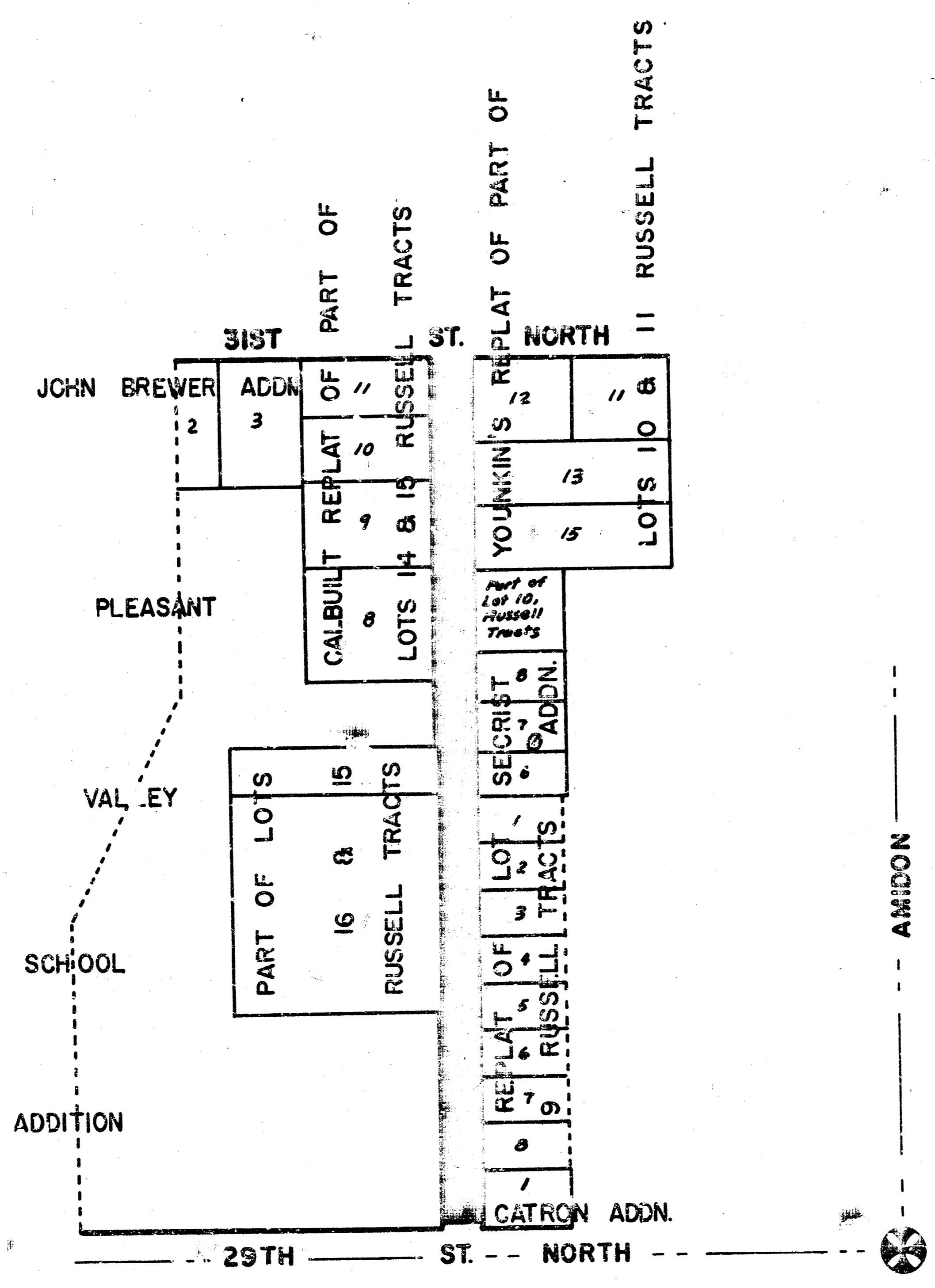

CITY OF WICHITA	M.E. LINDEBAK	CITY ENGINEER
LANDCO ENGINEERING		CONSULTANT ENGINEER
BOOK ESI	DRAWN BY RH	DATE 6/85

TYPICAL 31' PAVEMENT DETAILS

CHARLES AVE. - N.L. 29th to S.L. 31st

2/7

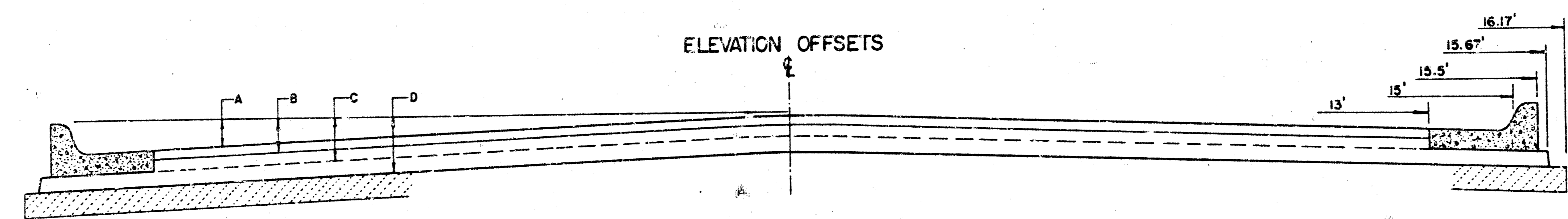
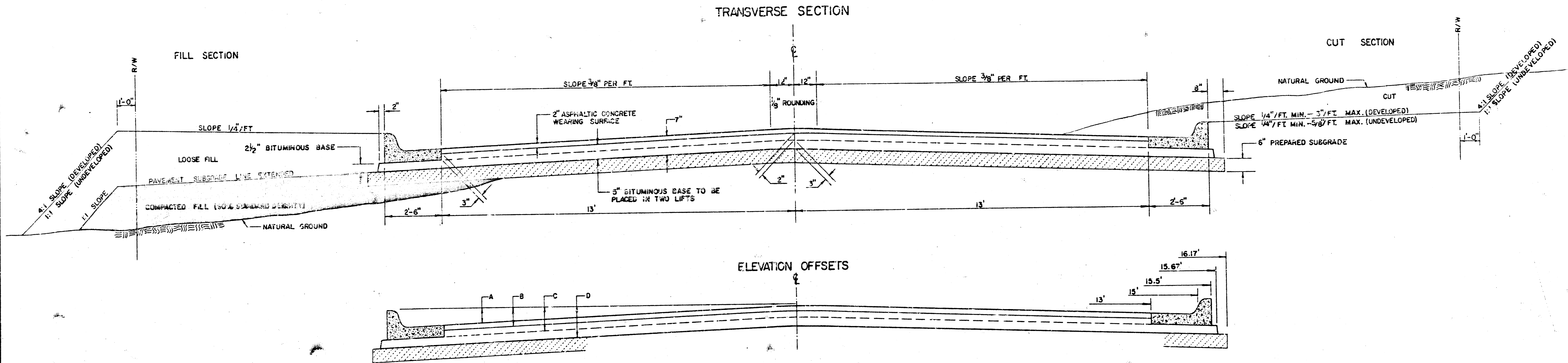

	DISTANCE FROM CENTERLINE (LT. & RT.)												
	0'	2'	4'	6'	7.5'	10'	12'	13'	15'	15.5'	15.67'	16.17'	
A: TOP OF CURBS TO TOP OF SURFACE LIFT	0.10	0.14	0.21	0.27	0.32	0.39	0.46	0.49	—	—	—	—	
B: TOP OF CURBS TO TOP OF UPPER BASE LIFT	0.27	0.31	0.38	0.44	0.49	0.56	0.63	0.66	—	—	—	—	
C: TOP OF CURBS TO TOP OF LOWER BASE LIFT	0.44	0.49	0.57	0.64	0.70	0.79	0.87	0.90	0.98	1.00	1.00	—	
D: TOP OF CURBS TO TOP OF SUBGRADE	0.69	0.73	0.80	0.87	0.93	1.01	1.08	1.12	1.19	1.21	1.21	1.23	

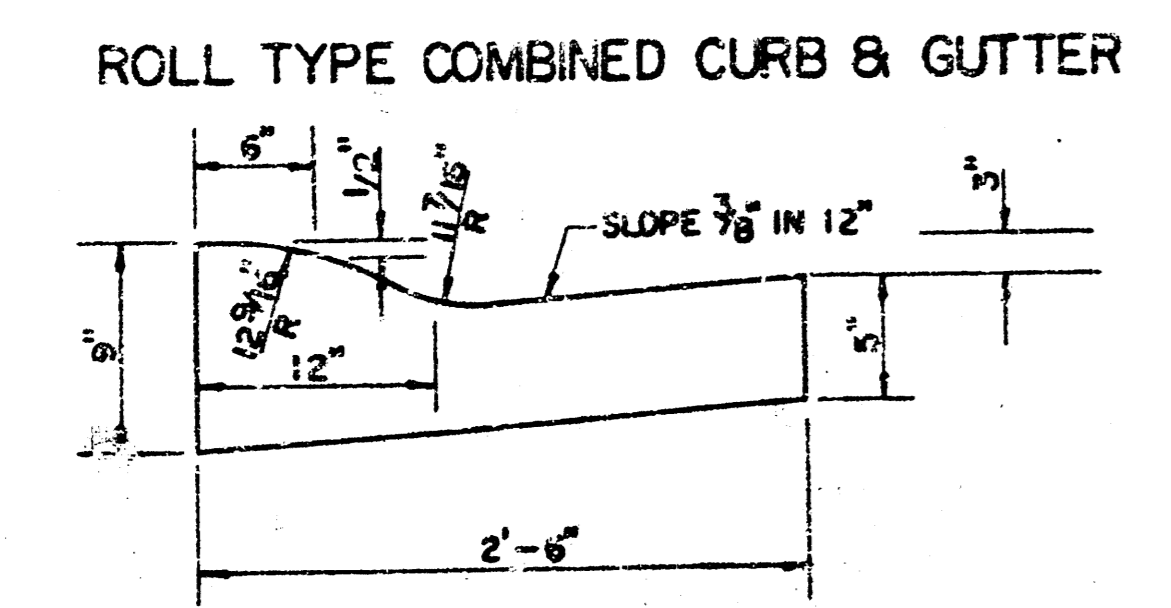
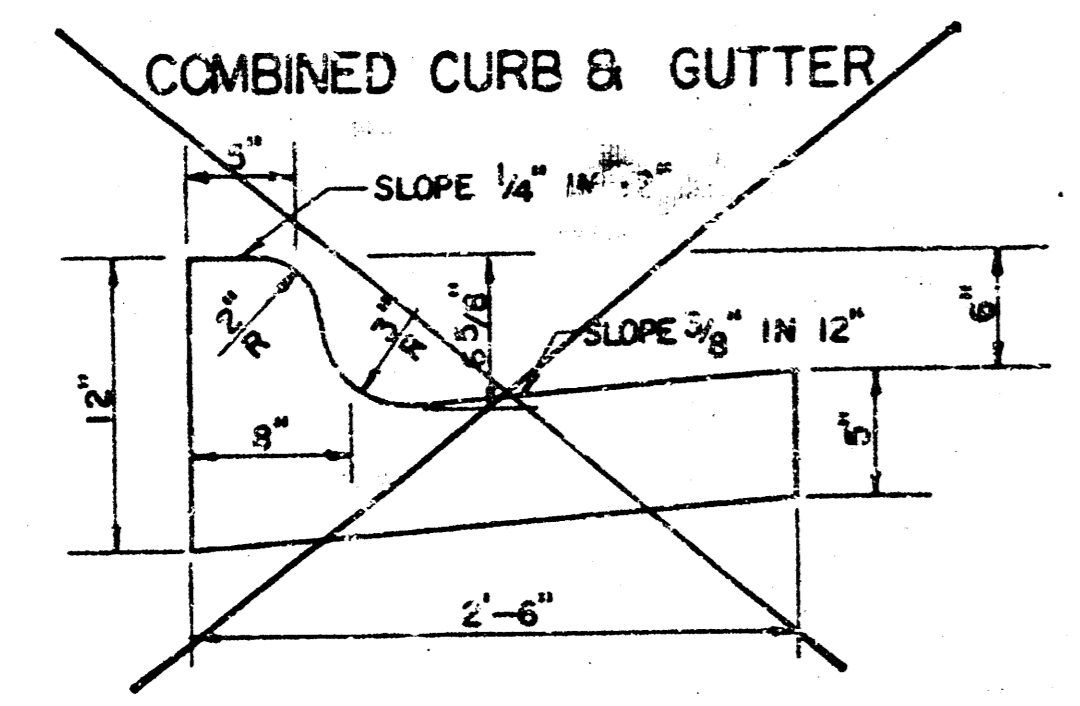

TRANSVERSE CONSTRUCTION JOINTS

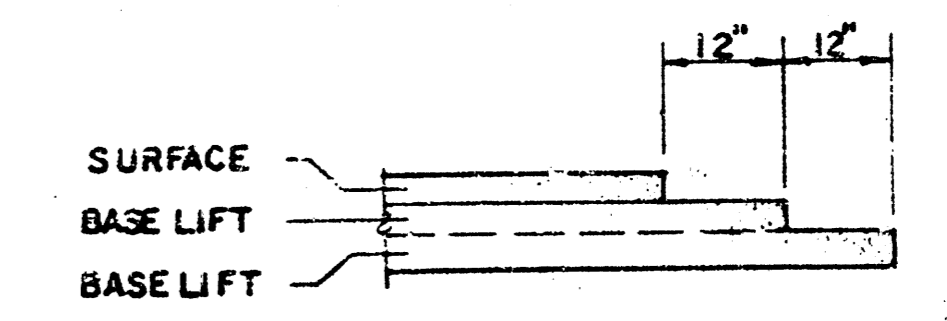

TRANSVERSE CONSTRUCTION JOINTS SHALL BE CONSTRUCTED IN FLEXIBLE BASE PAVEMENTS AT LOCATIONS WHERE PAVEMENT JOINS EXISTING FLEXIBLE BASE PAVEMENT AS SHOWN BY THE DETAIL. ALL COSTS ASSOCIATED WITH THE CONSTRUCTION OF THE TRANSVERSE JOINT SHALL BE INCLUDED IN THE BID PRICE FOR SQUARE YARDS 7\"/>

GENERAL NOTES

- 1) THE ASPHALTIC CONCRETE PAVEMENT BETWEEN THE COMBINED CURB AND GUTTER SHALL BE PAID AS SQUARE YARDS OF 7\"/>
- 2) THE BITUMINOUS BASE UNDER AND BEHIND THE COMBINED CURB AND GUTTER SHALL BE PAID AS SQUARE YARDS OF 2 1/2\"/>
- 3) A TACK COAT OF UNSULFIDED ASPHALT (SC-1H OR CSS-1H) SHALL BE APPLIED AT AN APPROXIMATE RATE OF 0.05 GALLONS PER SQUARE YARD BETWEEN EACH LIFT OF ASPHALTIC MATERIAL.
- 4) BITUMINOUS BASE AND ASPHALTIC CONCRETE WEARING SURFACE SHALL BE PLACED WITH A LAYDOWN MACHINE HAVING AUTOMATIC CONTROLS FOR LINE AND GRADE.
- 5) CONSTRUCTION JOINTS IN EACH LIFT SHALL BE STAGGERED A MINIMUM DISTANCE OF ONE (1) FOOT FROM JOINTS IN PRECEDING LIFTS AND PLACED SO THAT A JOINT WILL BE CONSTRUCTED ON THE CENTERLINE OF THE TOP LIFT.
- 6) CONTRACTOR TO BID ONLY ONE SUBGRADE TREATMENT ALTERNATE WHEN ALTERNATES ARE PROVIDED IN THE PROPOSAL AND CONTRACT. THE ALTERNATE CHOSEN BY THE SUCCESSFUL BIDDER SHALL BE USED IN CONSTRUCTING THIS PROJECT.

7 INCH RESIDENTIAL ASPHALTIC CONCRETE PAVEMENT WITH 5 INCH BITUMINOUS BASE
CITY OF WICHITA, KANSAS
 PROJECT NUMBER
472-76-245-81471-000-001

B.M. El. 130.78 "M" in "Muller" on FH of NW Corner 29th and Charles

NOTE: ROLL TYPE COMBINED CURB & GUTTER TO BE CONSTRUCTED ON THIS PROJECT. TOP OF CURB ELEVATIONS GIVEN ARE FOR FULL HEIGHT CURB

SCALE 1" = 20'

3/7

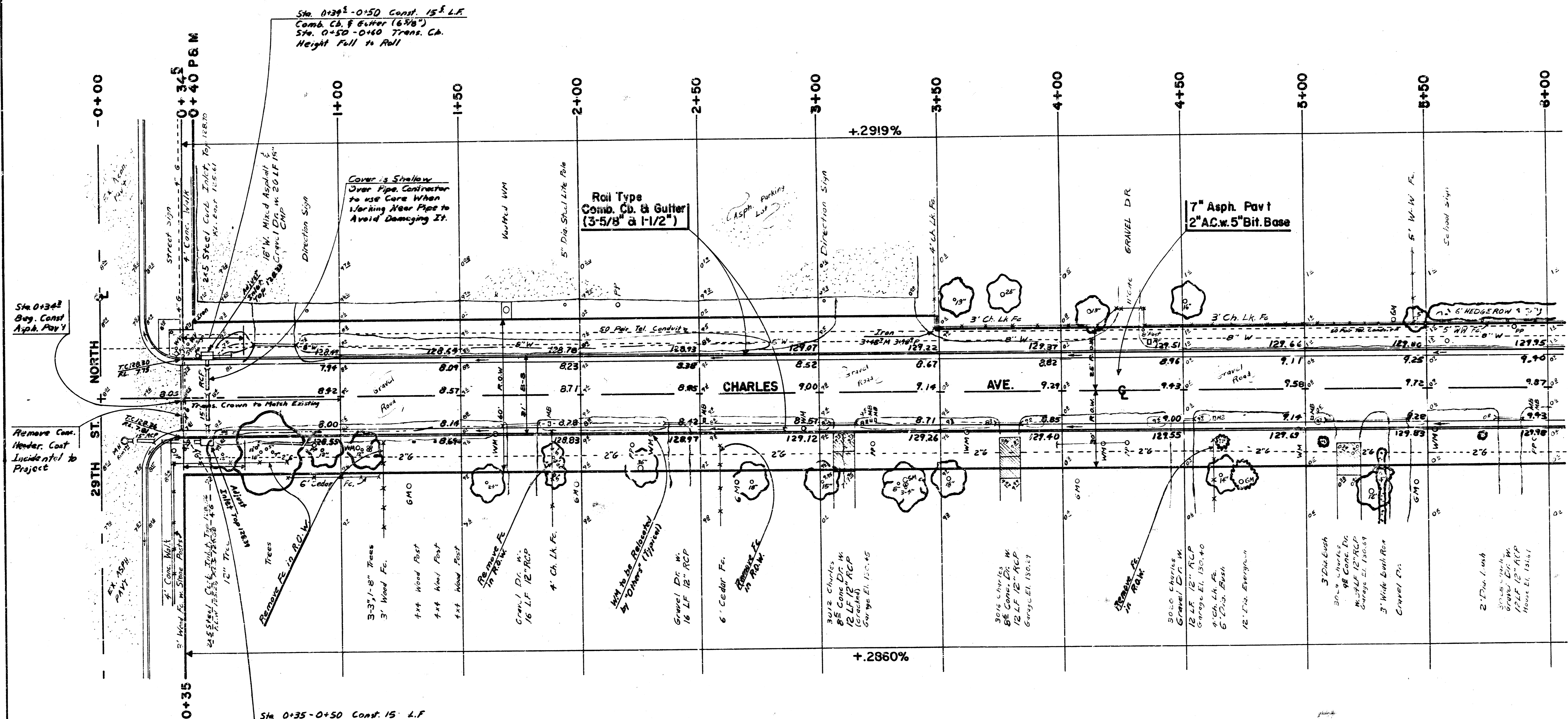

Sta. 0+34 1/2 - 0+50 Const. 15' L.F.
Comb. Cb. & Gutter (6 3/8")
Sta. 0+50 - 0+60 Trans. Cb.
Height Full to Roll

Sta. 0+35 - 0+50 Const. 15' L.F.
Comb. Cb. & Gutter (6 3/8")
Sta. 0+50 - 0+60 Trans. Cb.
Height Full to Roll

EARTHWORK

EXC.	2100.5 C.Y.
+10%	210.0 C.Y.
TOTAL	2310.5 C.Y.

4570 SQ YDS MANIPULATION

NOTE: COST FOR WOOD POSTS REMOVED TO BE SUBSIDIARY TO BID ITEM CU. YDS EXCAVATION.

- NOTE:
- 1) ALL FULL, ROLL & TRANSITION TYPE COMBINED CB. & GUTTER CONST. ON THIS PROJECT SHALL BE PAID FOR AS "LF. COMB. CB. & GUTTER (3 3/8" & 1 1/2")"
 - 2) Water Meters to be Relocated Where Necessary by Wichita Water Dept. Contractor shall contact Dick McClinton, 268-1555 prior to Beginning Construction
 - 3) No work shall be done outside of Street R.O.W. unless such work is authorized on a properly executed driveway request form.
 - 4) Contractor shall give Property Owners adjoining this Project whose lands may be lower than the top of the new curb an opportunity to utilize excess excavated material to regrade their yards to drain to the new pavement. Contractor shall dump and spread the excess material per the Standard Specifications.

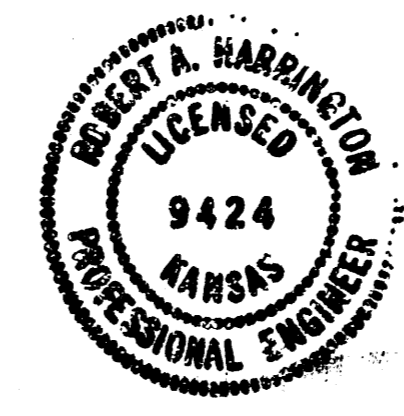

CHARLES AVENUE - N.L. 20TH ST. N. to S.L. 31ST ST. N.
PROJECT NO. 472-76-245-81471-000-003-001
CITY OF WICHITA M.E. LINDEBAK CITY ENGINEER
LANDCO ENGINEERING CONSULTANT ENGINEER
BOOK ES-I DRAWN BY RM DATE 6/85

3/7

B.M. EL. 132.60 "M" in "MUGGER" on FH on W-side Charles Avenue approx 735' N. of E 29th Street

NOTE: ROLL TYPE COMBINED CURB & GUTTER TO BE CONSTRUCTED ON THIS PROJECT. TOP OF CURB ELEVATIONS GIVEN ARE FOR FULL HEIGHT CURB

SCALE 1" = 20' N

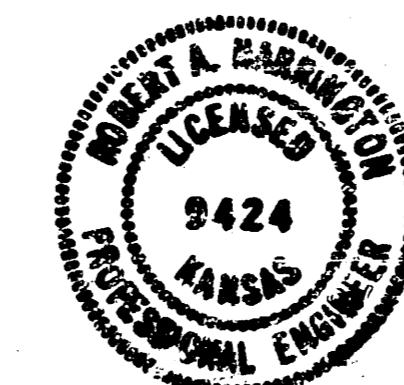
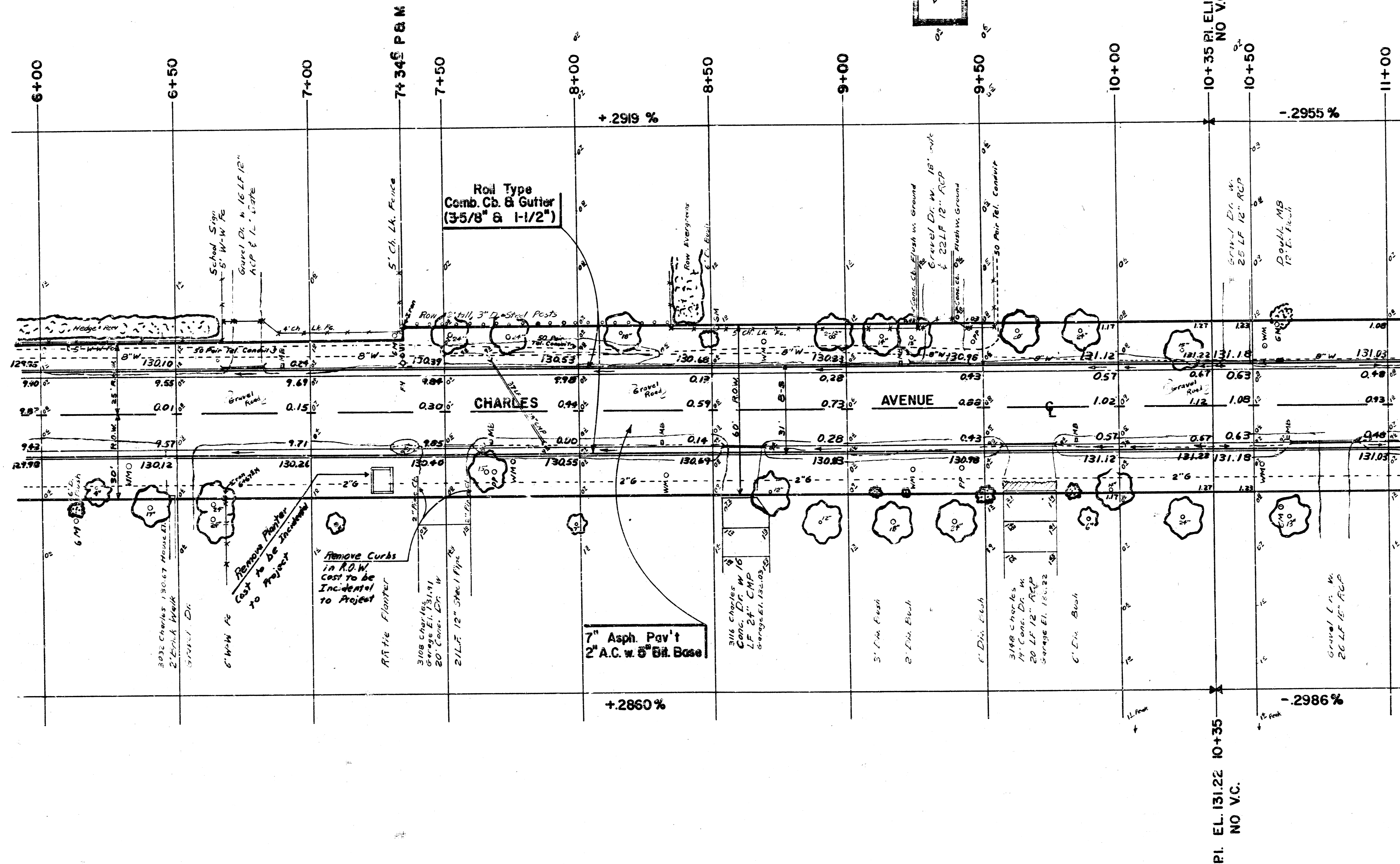

CHARLES AVENUE - N.L. 29th ST. N. to S.L. 31st ST. N.
PROJECT NO. 472-76-245-81471-000-000-001

B.M. E.I. 130.65 # 60 Spk NW-Face PP SE
 Corner 31ST STREET & CHARLES

NOTE: ROLL TYPE COMBINED CURB & GUTTER TO BE CONSTRUCTED ON THIS PROJECT. TOP OF CURB ELEV. GIVEN ARE FOR FULL HEIGHT CURB

SCALE 1" = 20'

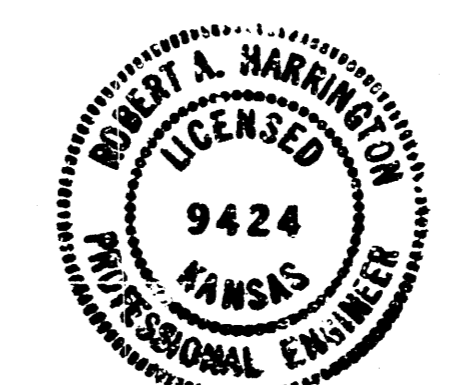
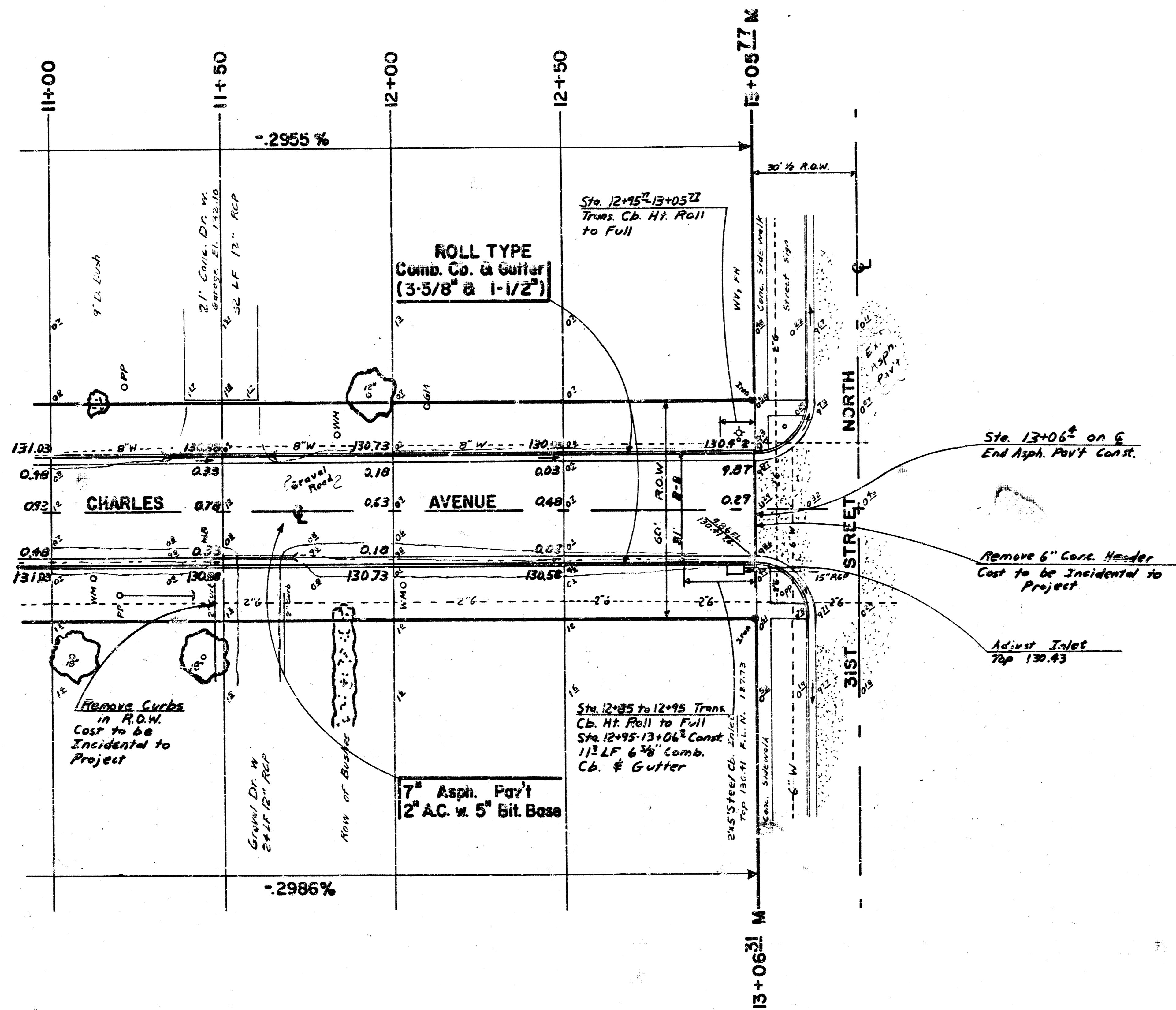

CHARLES AVENUE - N.L. 29th ST. N. to S.L. 31st ST. N.
 PROJECT NO. 472-76-245-51471-000-000-001

