

H 8

B.M. 15340 'T' in Troy Top of Hydrant S.W. Cor. 16th & Chautauqua

0-047 N. Edge Davt of 16th Inters.
3+00 N.L. 16th Comb Cb & 4th Exisig

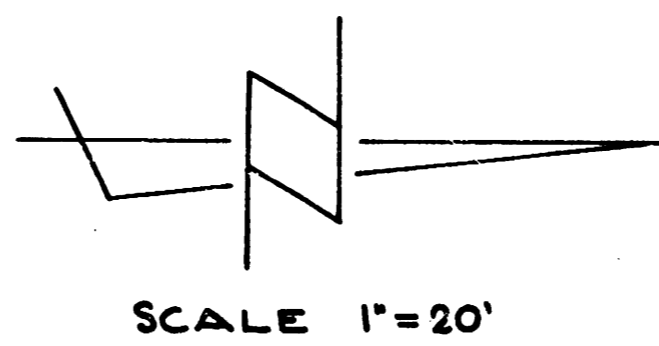

NOTE: STAKE & GRADE.

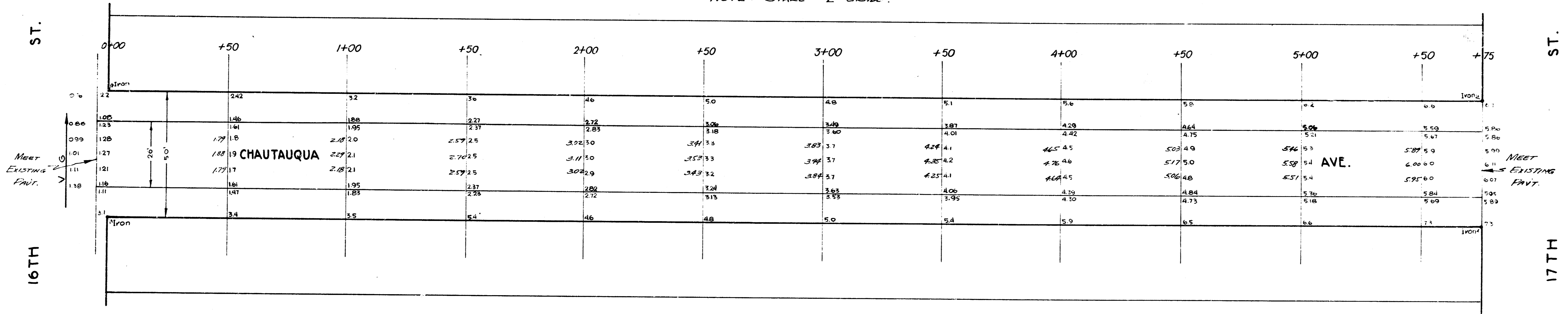

CHAUTAUQUA AVE.
 N.L. 16TH ST. TO S.E. 17TH ST.
 26' Conc.
 CITY OF WICHITA, KANSAS
 L.K. WHITE CITY ENGINEER
 SEPT. 1951 PROJ. NO. C 11-90



1941
CHAUTAQUA NL 16TH ST TO SL 17TH
COMB CURB & GUTTER

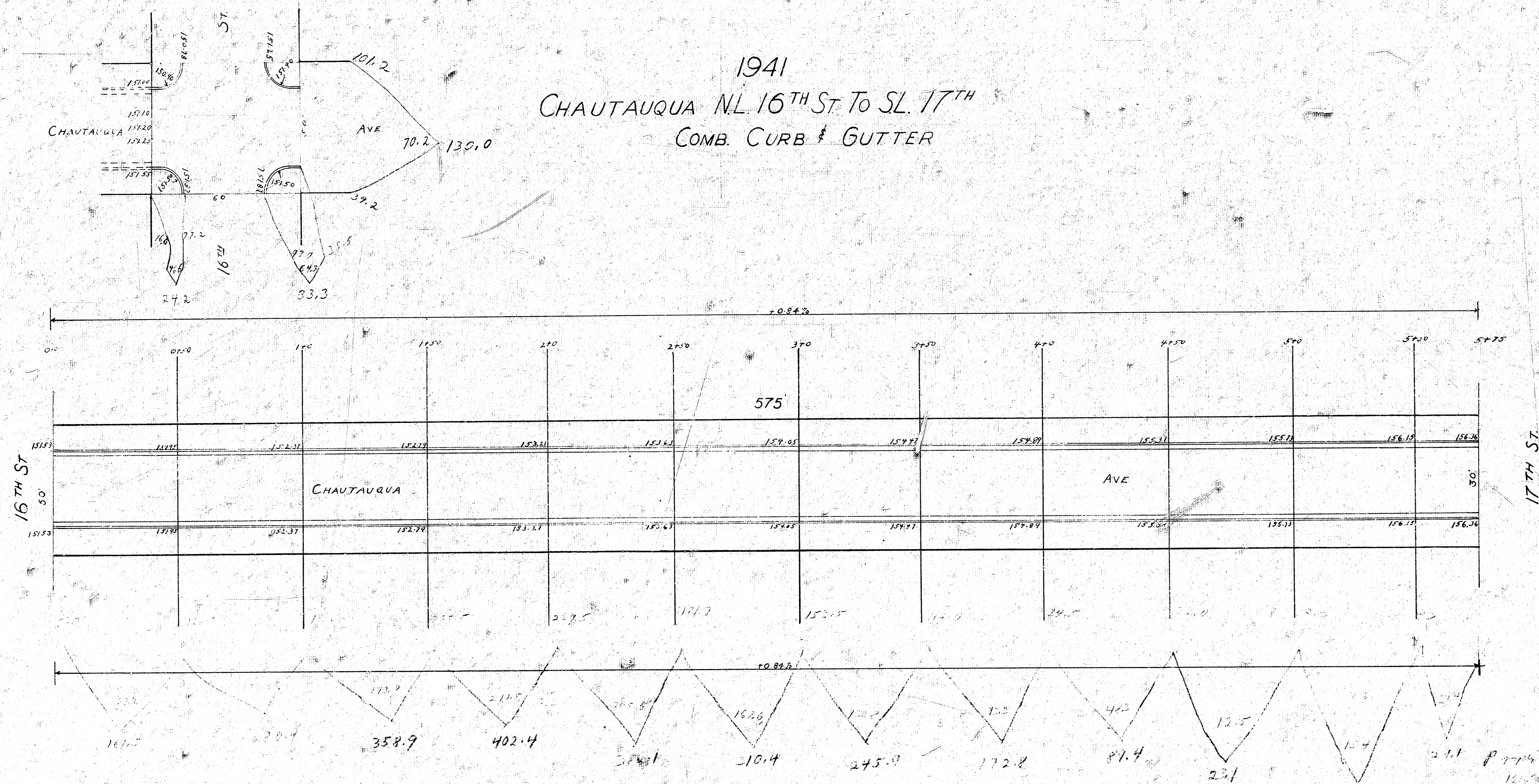

B.M. 15340 T IN TROY TOP OF HYDRANT S.W. COR 16TH + CHAUTAUQUA

2482.5 + 10% = 2730.8
 2482.5 + 248.3 = 2730.8
 187.5 + 18.8 = 206.3
 2482.5 + 206.3 = 2688.8
 2688.8 + 248.3 = 2937.1
 2482.5