

STREETS IN THIRD ADDITION TO CHERRY CREEK HILLS

PROJECT NUMBER: 472-76-245-80775-000-000-001

- CHALET DRIVE - FROM THE N.L. OF LOT 1, BLOCK 2, 3RD ADDITION TO CHERRY CREEK HILLS TO THE W.L. CAPRI
- CHALET COURT - FROM THE S.L. CHALET DRIVE TO AND INCLUDING CUL-DE-SAC
- ROSALIE LANE - FROM THE N.L. CHERRY CREEK DRIVE TO THE S.L. CHALET DRIVE

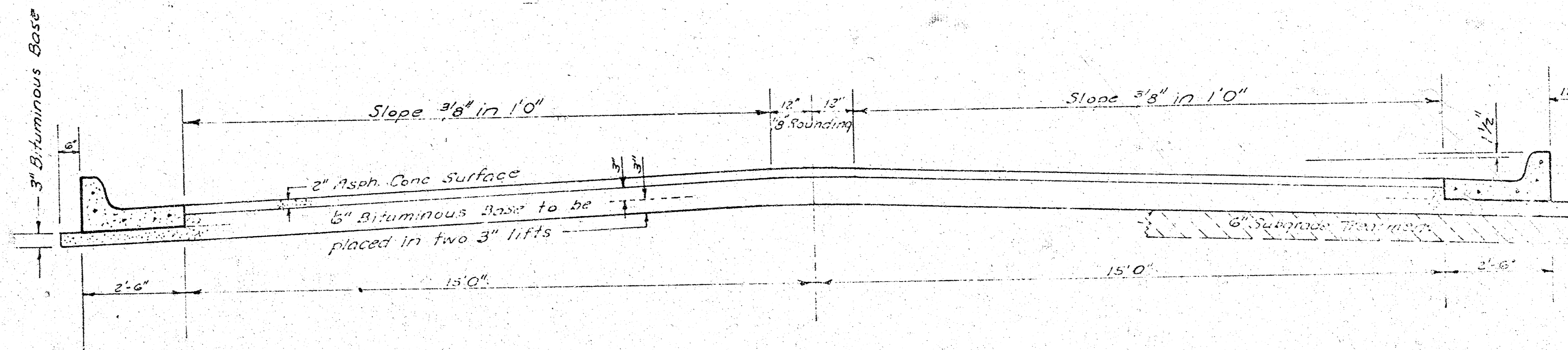

TYPICAL SECTION

35' ASPHALTIC CONCRETE PAVEMENT WITH BITUMINOUS BASE

A TACK COAT OF EMULSIFIED ASPHALT (SS-1H) SHALL BE APPLIED AT AN APPROXIMATE RATE 0.05 GALLONS PER SQ YD BETWEEN LIFTS OF ASPHALTIC MATERIALS WHEN ORDERED BY THE ENGINEER. TACK COAT WILL NOT BE PAID FOR DIRECTLY AND SHALL BE CONSIDERED AS SUBSIDIARY TO PRICE BID FOR ASPHALTIC PAVEMENT.

BITUMINOUS BASE AND ASPHALTIC CONCRETE WEARING SURFACE SHALL BE PLACED WITH A LAYDOWN MACHINE HAVING AUTOMATIC ELECTRONIC CONTROLS FOR CROWN AND GRADE. CONSTRUCTION JOINTS IN EACH LIFT SHALL BE STAGGERED A MINIMUM DISTANCE OF 1' WITH JOINTS IN PRECEDING LIFTS AND PLACED SUCH THAT A JOINT WILL BE CONSTRUCTED ON THE CENTERLINE IN THE TOP LIFT.

The A.C. Pavement between the curb and gutter shall be paid as 35' A.C. Pavement (3" Bituminous Base). The bituminous base under the curb & gutter shall be paid as 35' Bituminous Base.

COMBINED CURB & GUTTER

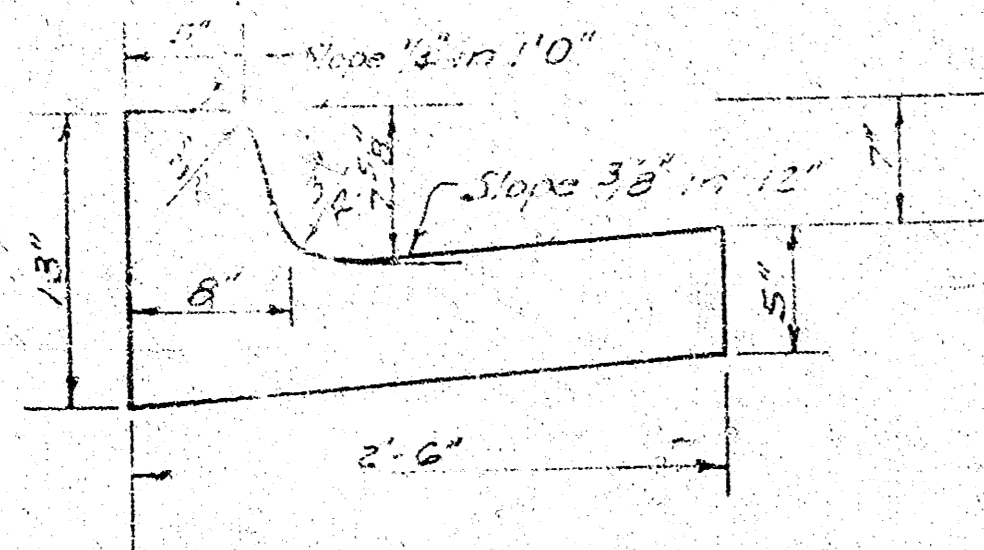

ROLL TYPE CURB & GUTTER

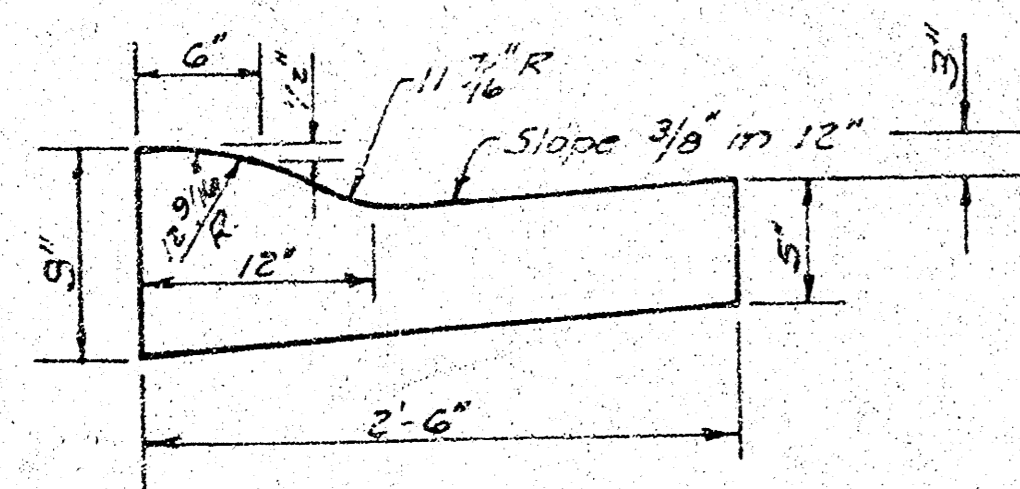

DETAIL OF TRANSVERSE CONSTRUCTION JOINTS

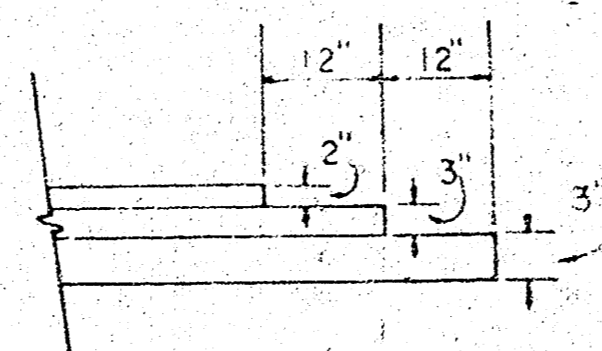

TRANSVERSE CONSTRUCTION JOINTS SHALL BE CONSTRUCTED IN FLEXIBLE BASE PAVEMENTS AT LOCATIONS WHERE PAVEMENT TEMPORARILY ENDS TO FACILITATE FUTURE PAVEMENT CONSTRUCTION AS SHOWN BY DETAIL. THE COST OF CONSTRUCTING THE TRANSVERSE CONSTRUCTION JOINTS SHALL NOT BE MEASURED OR PAID FOR DIRECTLY BUT SHALL BE INCLUDED IN THE BID PRICE FOR SQUARE YARDS OF ASPHALTIC CONCRETE PAVEMENT.

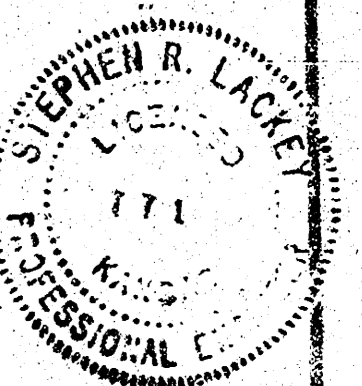

CITY OF WICHITA KANSAS

DEPARTMENT of PUBLIC WORKS - Engineering Division.

R. W. LINN CITY ENGINEER

DATE _____ Proj No. _____

B.M. EL. 178.46 "□" TOP W-CURB ROSALIE 5.5' S. OF S.L. CHERRY CREEK DRIVE
 □ IS CHALET DRIVE

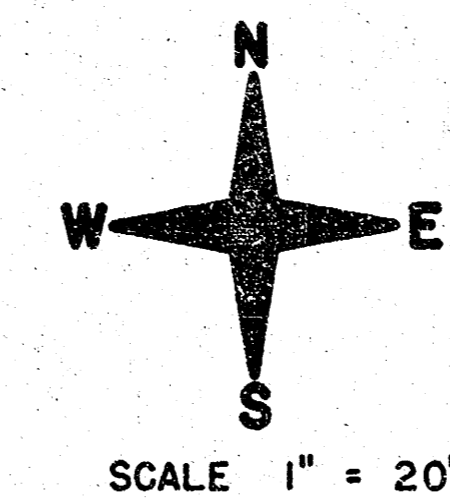

CAUTION
 UNDERGROUND
 UTILITIES
 Please Refer to Plans for Location
 of Utilities. No
 Excavation to be Made
 Without Call to Location

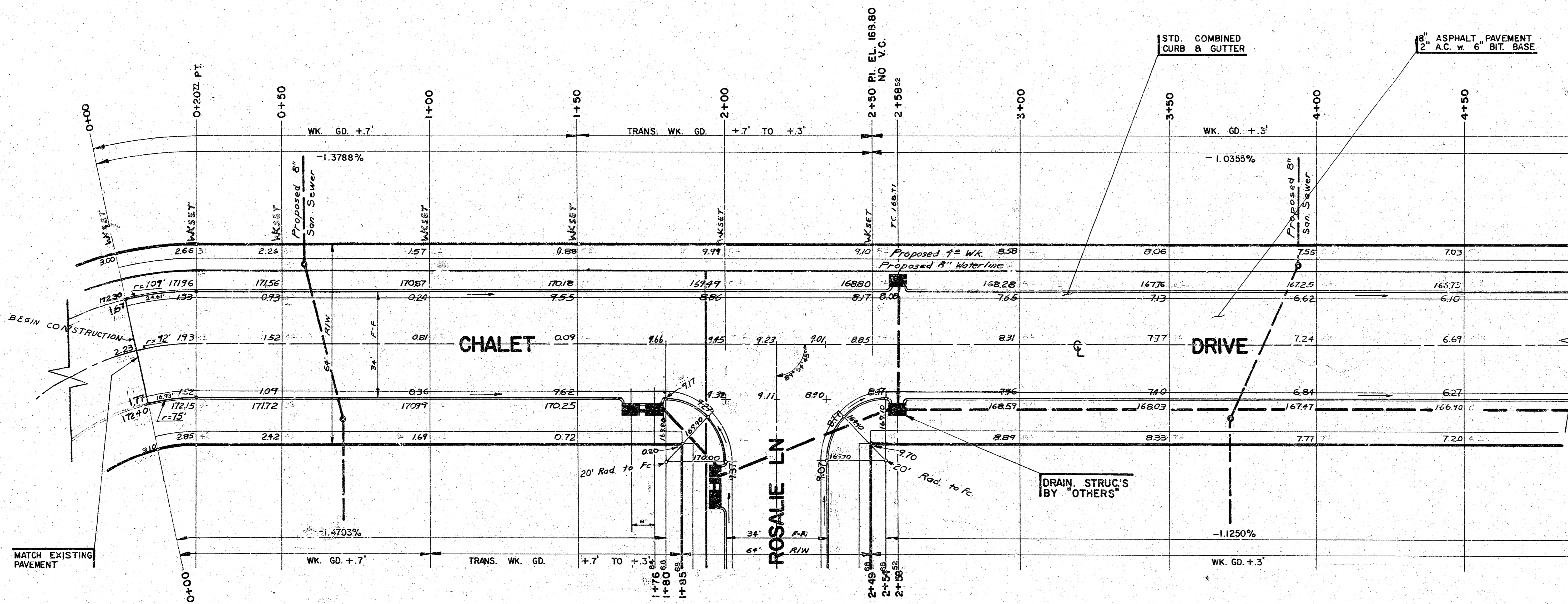

SUB-GRADE
 TYPE OF SUB-GRADE TREATMENT SHALL BE DETERMINED BY THE FIELD ENGINEER. SUB-GRADE TREATMENT MAY CONSIST OF LIME TREATMENT, CEMENT TREATMENT, SUB-GRADE MODIFICATION, OR ANY COMBINATION OF THESE.

GENERAL NOTES:

1. FIELD ENGINEER SHALL TAKE TIES TO ALL IRONS & THIMBLES WHICH MAY BE DESTROYED, AND REPLACE THOSE WHICH ARE DESTROYED.
2. CONTRACTOR SHALL COORDINATE WORK WITH UTILITY COMPANIES, SANITARY & STORM SEWER CONTRACTORS, AND OTHER AGENCIES CONNECTED WITH THE PROJECT SITE DEVELOPMENT.
3. EXCESS EARTHWORK FROM THIS PROJECT TO BE HAULED TO THE FOLLOWING LOCATIONS AND DUMPED AT THE FIELD ENGINEER'S DIRECTION. THE LOCATIONS ARE: CHERRY CREEK DR. (472-76-245-80776-000-000-001), AND CHERRY CREEK DRIVE @ CAPRI (472-76-245-80777-000-000-001). COST TO BE INCIDENTAL TO THIS PROJECT.
4. NO MORE THAN 40 20' DRIVES TO BE CONSTRUCTED ON THIS PROJECT.

Curve Data:

Δ	12° 56' 15"
R	12.00'
T	10.43'
L	50.77'
C	20.73'

EARTHWORK:	PROPERTY	CITY
EXCAVATION	5205.7	233.5
+10 %	520.6	23.4
TOTAL	5726.3 CY.	256.9 CY.
MANIPULATION	7306.6 SY.	406.0 SY.

CHALET DRIVE - From the W.L. Lot 1, Block 2, 3rd. Addn. to Cherry Creek Hills to the W.L. Capri.
 Proj. No. 472-76-245-80775-000-000-001

B.M. EL. 161.40 " " ON TOP E-CURB CAPRI
 B.M. EL. 164.60 RR. SPK. NE-SIDE SMALL BOX ELDER TREE 12' W. OF WL. CAPRI CIR. & 5' N. OF S.L. CEDAR LAKE VILLAGE 4TH ADDN.
 BASELINE IS CHALET DRIVE

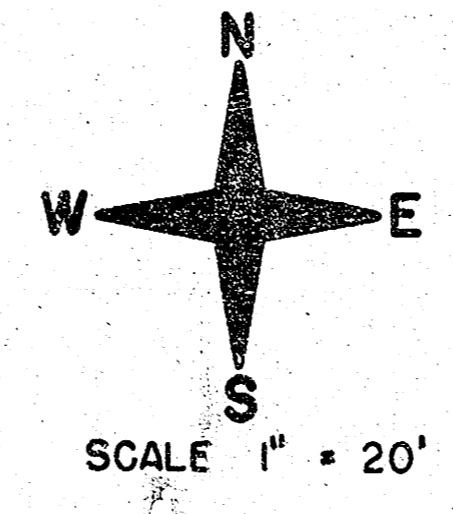

$\Delta = 24^{\circ}33'55'' R = 375'$ $T = 81.44'$ $L = 160.78'$ $LC = 159.55'$

CURVE DATA BASED ON $\frac{E}{2}$ RAD. $\Delta = 12^{\circ}16'50''$

STA.	ARC.	CHORD LENGTH	DEFLECTION	TOTAL DEFLECTION
		$\frac{C}{2}$	$\frac{D}{2}$	
6+49.72				0°00'00"
7+00	10.02	9.35	10.69	8°45'56"
7+50	50.00	46.43	53.29	3°41'11"
8+00	50.00	46.43	53.29	3°41'11"
8+35.52	35.40	33.03	37.75	2°42'16"
8+36.22	1.37	1.28	1.46	0°06'17"
8+37.22	2.30	2.15	2.45	0°10'32"
8+42.22	3.25	3.03	3.47	0°14'54"
8+43.22	1.30	1.21	1.39	0°05'57"
8+50.22	7.14	6.66	7.62	0°32'44"

4.5837 Min. 1 Ft.

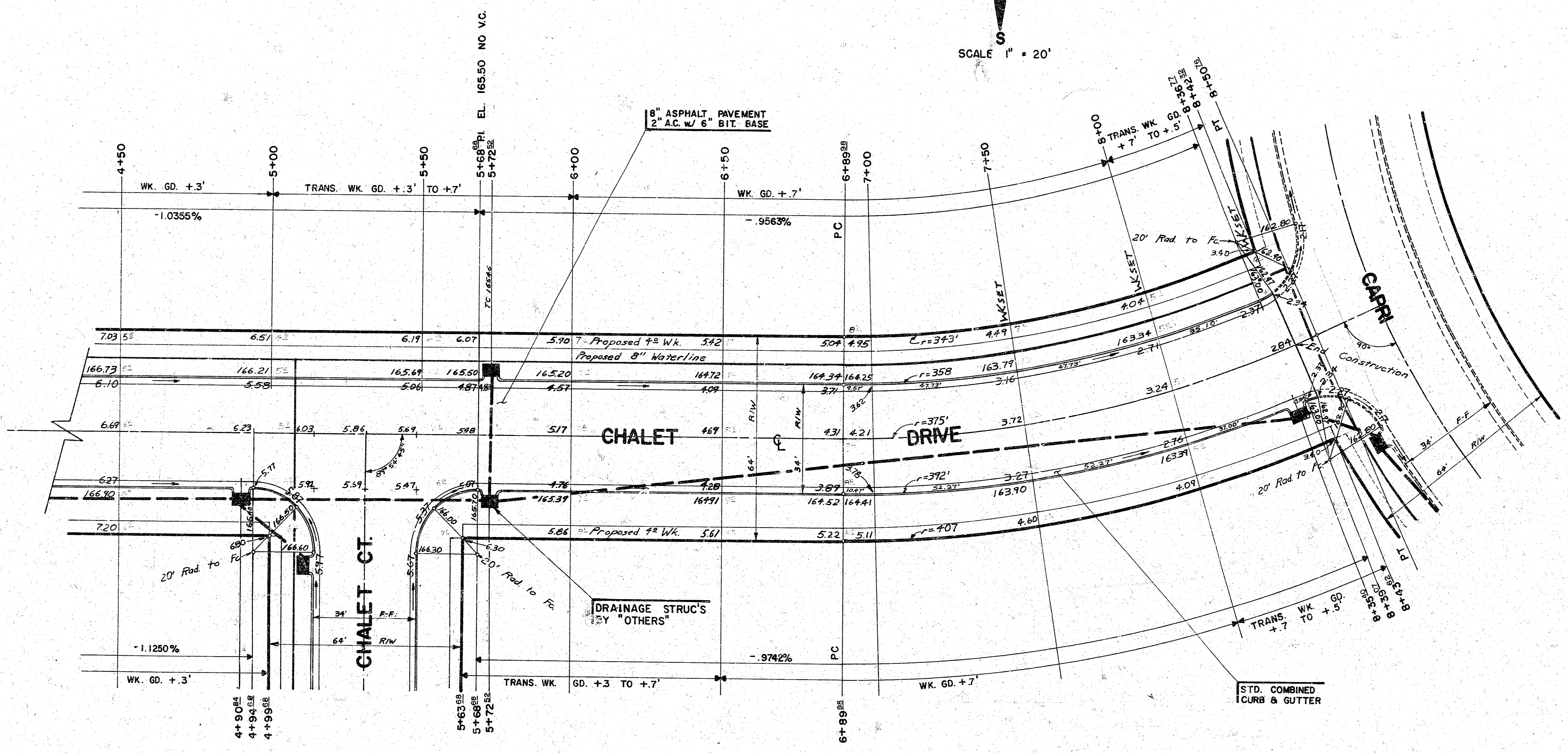

CHALET DRIVE - From the W.L. Lot 1,
 Block 2, 3rd Addn. to Cherry Creek
 Hills to the W.L. Capri
 Proj. No: 472-76-245-80715-000-000-001

3/5

FILMED FROM THE BEST AVAILABLE COPY

B.M. EL. 161.40 " " CUT ON TOP E-CURB CAPRI
 BASELINE IS ϕ ROSALIE LANE

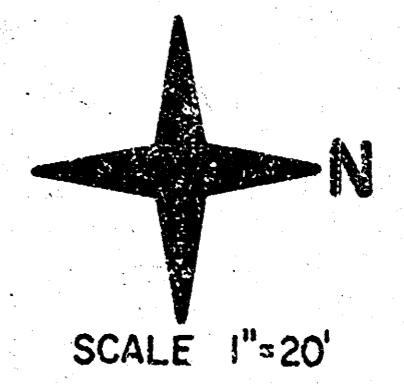

SCALE 1"=20'

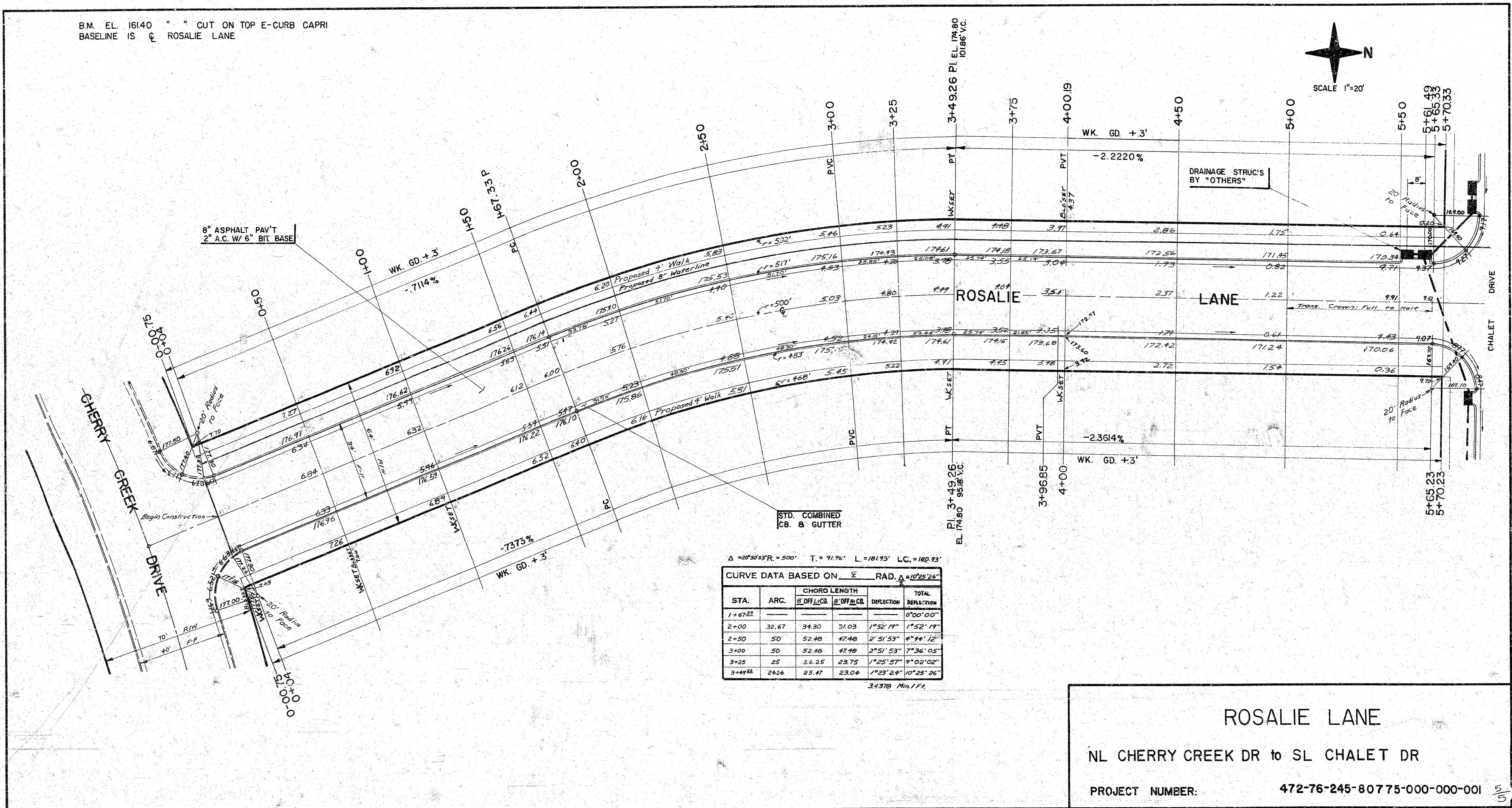

$\Delta = 20^{\circ}50'53''$ R. = 500' T. = 91.96' L. = 181.93' LC. = 182.93'

CURVE DATA BASED ON ϵ RAD. $\Delta = 10^{\circ}25'26''$

STA.	ARC.	CHORD LENGTH		DEFLECTION	TOTAL DEFLECTION
		$\frac{2}{3}$ OFF CG	$\frac{1}{3}$ OFF CG		
1+67.23					0°00'00"
2+00	32.67	34.30	31.03	1°52'19"	1°52'19"
2+50	50	52.48	47.48	2°51'53"	4°44'12"
3+00	50	52.48	47.48	2°51'53"	7°36'05"
3+25	25	26.25	23.75	1°25'57"	9°02'02"
3+49.26	24.26	25.47	23.04	1°23'24"	10°25'26"

34378 Min. 1/P.

ROSALIE LANE

NL CHERRY CREEK DR to SL CHALET DR

PROJECT NUMBER: 472-76-245-80775-000-000-001 5/01

FILMED FROM THE BEST AVAILABLE COPY