

# CHERYL PLACE

E. L. LOT 30, BLK. 10, WESTLINK VILLAGE 11TH ADD<sup>N</sup> TO  
W. L. LOT 40, BLK. 10, WESTLINK VILLAGE 11TH ADD<sup>N</sup>

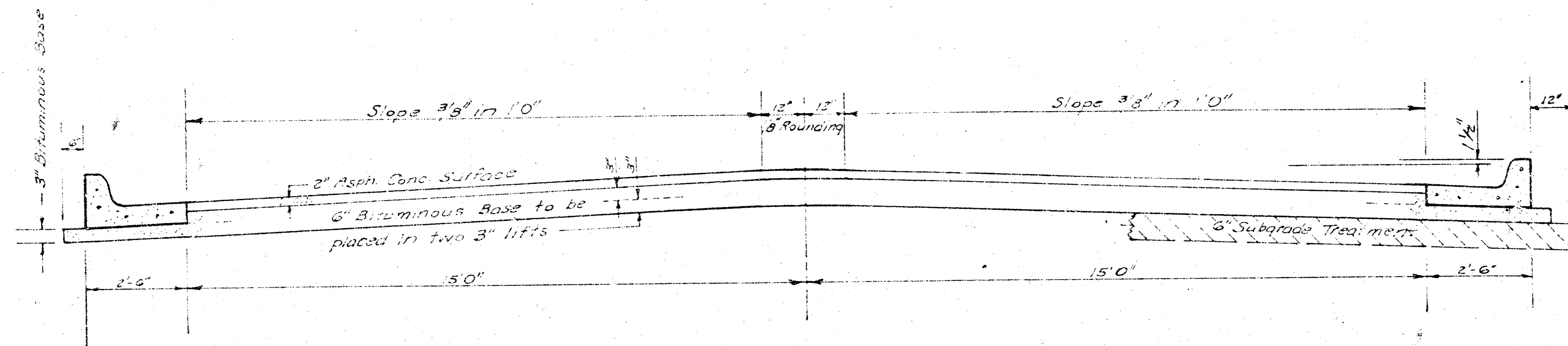

## TYPICAL SECTION

35' ASPHALTIC CONCRETE PAVEMENT WITH BITUMINOUS BASE

*The A.C. Pavement between the curb & gutter shall be paid as Sq. Yds. 8" A.C. Pavement (6" Bituminous Base).  
The Bituminous Base under the curb & gutter shall be paid as Sq. Yds. 3" Bituminous Base.*

COMBINED CURB & GUTTER

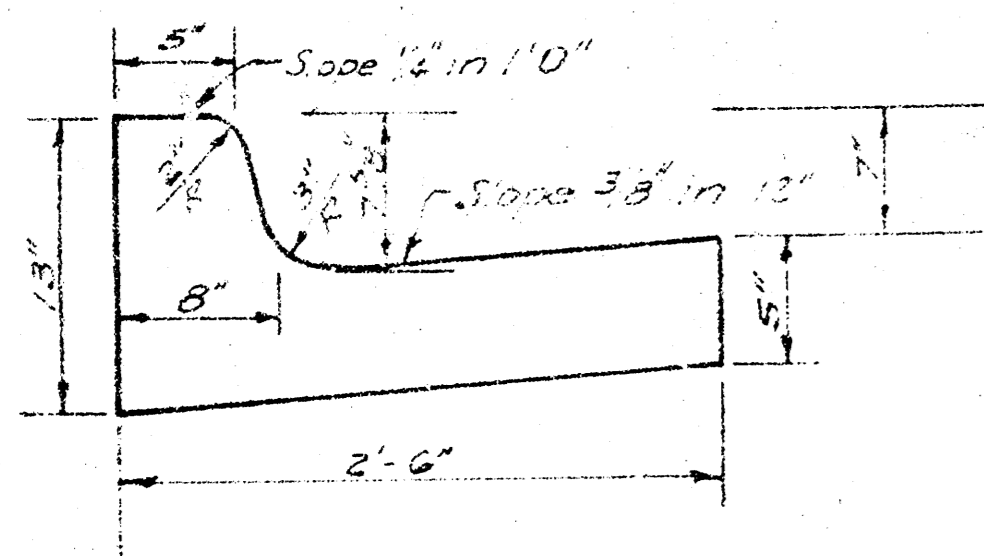

~~ROD TYPE CURB & GUTTER~~

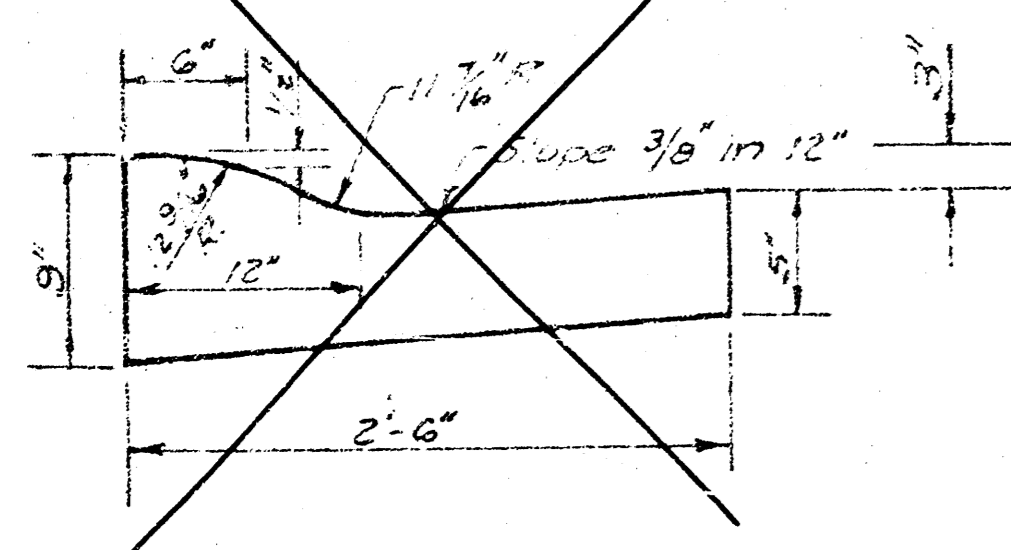

A TACK COAT OF EMULSIFIED ASPHALT (SS-1H) SHALL BE APPLIED AT AN APPROXIMATE RATE 0.05 GALLONS PER SQ YD BETWEEN LIFTS OF ASPHALTIC MATERIALS WHEN ORDERED BY THE ENGINEER. TACK COAT WILL NOT BE PAID FOR DIRECTLY AND SHALL BE CONSIDERED AS SUBSIDIARY TO PRICE BID FOR ASPHALTIC PAVEMENT.  
BITUMINOUS BASE AND ASPHALTIC CONCRETE WEARING SURFACE SHALL BE PLACED WITH A LAYDOWN MACHINE HAVING AUTOMATIC ELECTRONIC CONTROLS FOR CROWN AND GRADE. CONSTRUCTION JOINTS IN EACH LIFT SHALL BE STAGGERED A MINIMUM DISTANCE OF 1' WITH JOINTS IN PRECEDING LIFTS AND PLACED SUCH THAT A JOINT WILL BE CONSTRUCTED ON THE CENTERLINE IN THE TOP LIFT.

### DETAIL OF TRANSVERSE CONSTRUCTION JOINTS

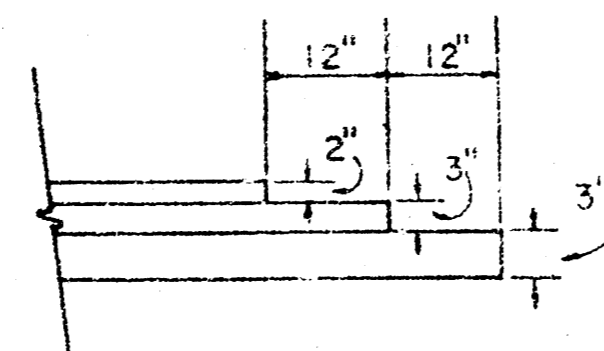

TRANSVERSE CONSTRUCTION JOINTS SHALL BE CONSTRUCTED IN FLEXIBLE BASE PAVEMENTS AT LOCATIONS WHERE PAVEMENT TEMPORARILY ENDS TO FACILITATE FUTURE PAVEMENT CONSTRUCTION AS SHOWN BY DETAIL. THE COST OF CONSTRUCTING THE TRANSVERSE CONSTRUCTION JOINTS SHALL NOT BE MEASURED OR PAID FOR DIRECTLY BUT SHALL BE INCLUDED IN THE BID PRICE FOR SQUARE YARDS OF ASPHALTIC CONCRETE PAVEMENT.

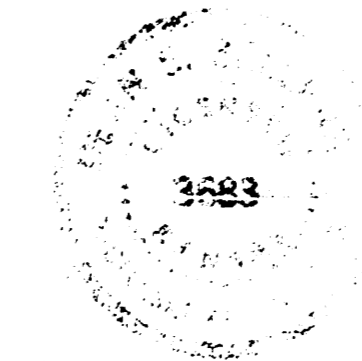

CITY OF WICHITA KANSAS

DEPARTMENT of PUBLIC WORKS - Engineering  
Division

R. W. LINN CITY ENGINEER  
DATE June 1976 Proj No. DAKS 574052



FILMED FROM THE BEST AVAILABLE COPY.....

B.M. 158.97 N.E. Cor. Conc. Porch @ 9125 Thurman  
 B.M. 151.43 "a" Top E. Curb Wood @ N.L. Thurman  
 B.M. 158.32 "a" Top E. Curb Wood @ S.L. Cheryl

STATIONING ON & P.V.T.

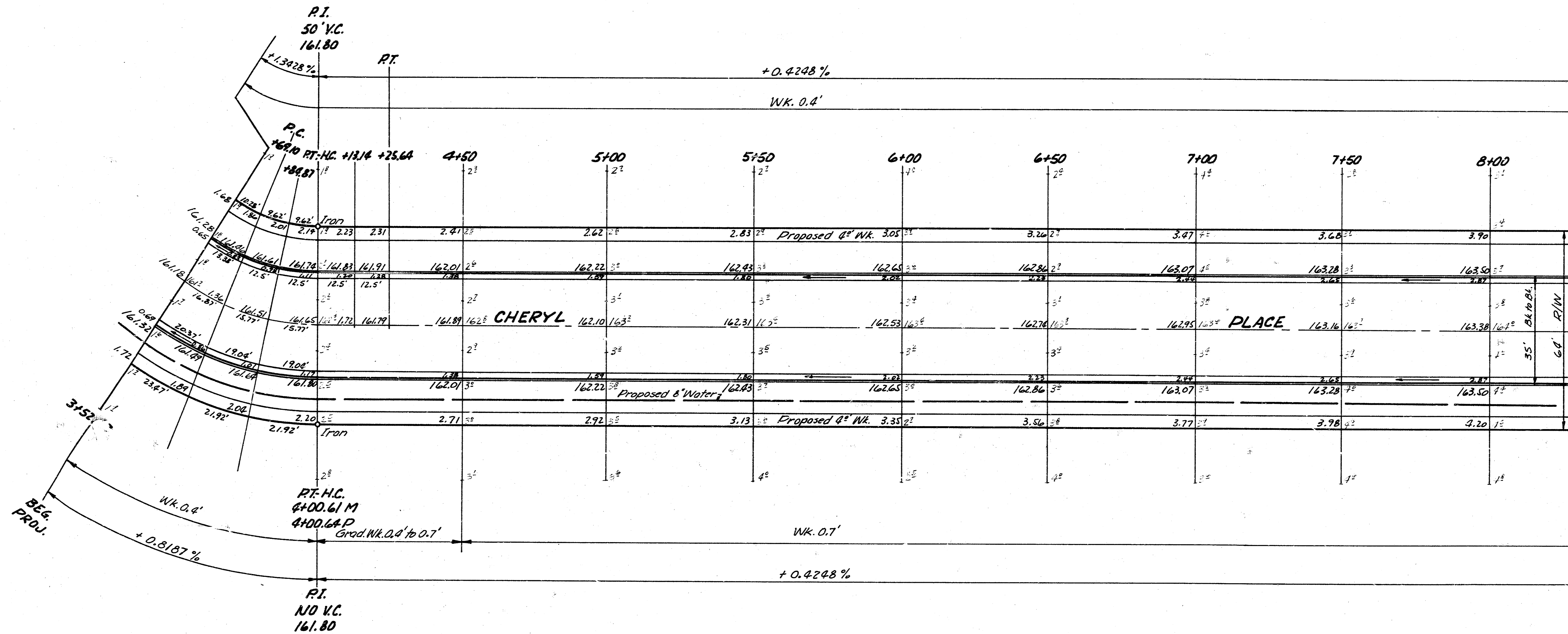
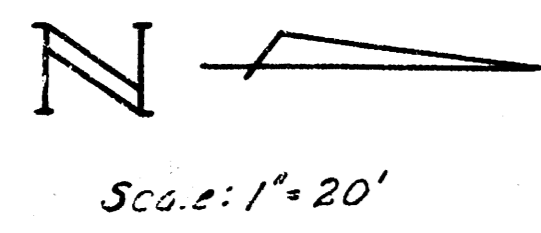

Survey D.A.K.  
 Plan D.E.C.  
 Exp.  
 Checked

$\Delta = 33^\circ 49' 36''$   $R = 82'$   $T = 20.95'$   $L = 48.41'$   $L.C. = 47.71'$

CURVE DATA BASED ON  $\Delta$  RAD.  $\Delta = 16^\circ 54' 48''$

STA	ARC	CHORD LENGTH		TOTAL	
		80 FT. U.C.	DIFF. FROM P.V.T.	DEFLECTION	DEFLECTION
3+52.23				0° 00' 00"	0° 00' 00"
3+69.10	16.87	11.71	21.97	5° 53' 38"	5° 53' 38"
3+86.87	15.77	10.95	20.55	5° 30' 35"	11° 24' 13"
4+00.64	15.77	10.95	20.55	5° 30' 35"	16° 54' 48"

DEFL. / FT. = 20.962411 MIN.

NOTE TO FIELD ENGINEER & CONTRACTOR  
 Grade parking and clear right-of-way for proposed add. to V.C. Compact fill in sidewalk area. TO BE CONSTRUCTED BY "OTHERS".

SUB-GRADE  
 TYPE OF SUB-GRADE TREATMENT SHALL BE DETERMINED BY THE FIELD ENGINEER. SUB-GRADE TREATMENT MAY CONSIST OF LIME TREATMENT CEMENT TREATMENT, SUB-GRADE MODIFICATION, OR ANY COMBINATION OF THESE.

<b>EARTHWORK - TOTAL</b>	
<u>EXCAVATION</u>	<u>C.F.</u>
<u>Property</u>	<u>Property</u>
2245.7 CU. YD.	32.3 CU. YD.
+10% 224.6	+10% 3.2
TOTAL 2470.3 CU. YD.	TOTAL 35.5 CU. YD.

TOTAL MANIPULATION = 3351.0 SQ. YD.

2  
6

**CHERYL PLACE**  
 E.L. LOT 30, BLK. 10, WESTLINK VILLAGE  
 11<sup>th</sup> ADD<sup>n</sup> TO W.L. LOT 40, BLK. 10  
 WESTLINK VILLAGE 11<sup>th</sup> ADD<sup>n</sup>  
 30'-2'-34" ASPH. CONC.  
 WITH COMB. CB & GTR.  
 CITY OF WICHITA, KANSAS  
 R.W. LINN CITY ENGINEER  
 DATE <sup>June</sup> 1976 PROJ. No. DAKS 574052 <sup>2</sup>/<sub>3</sub>

FILMED FROM THE BEST  
 AVAILABLE COPY .....

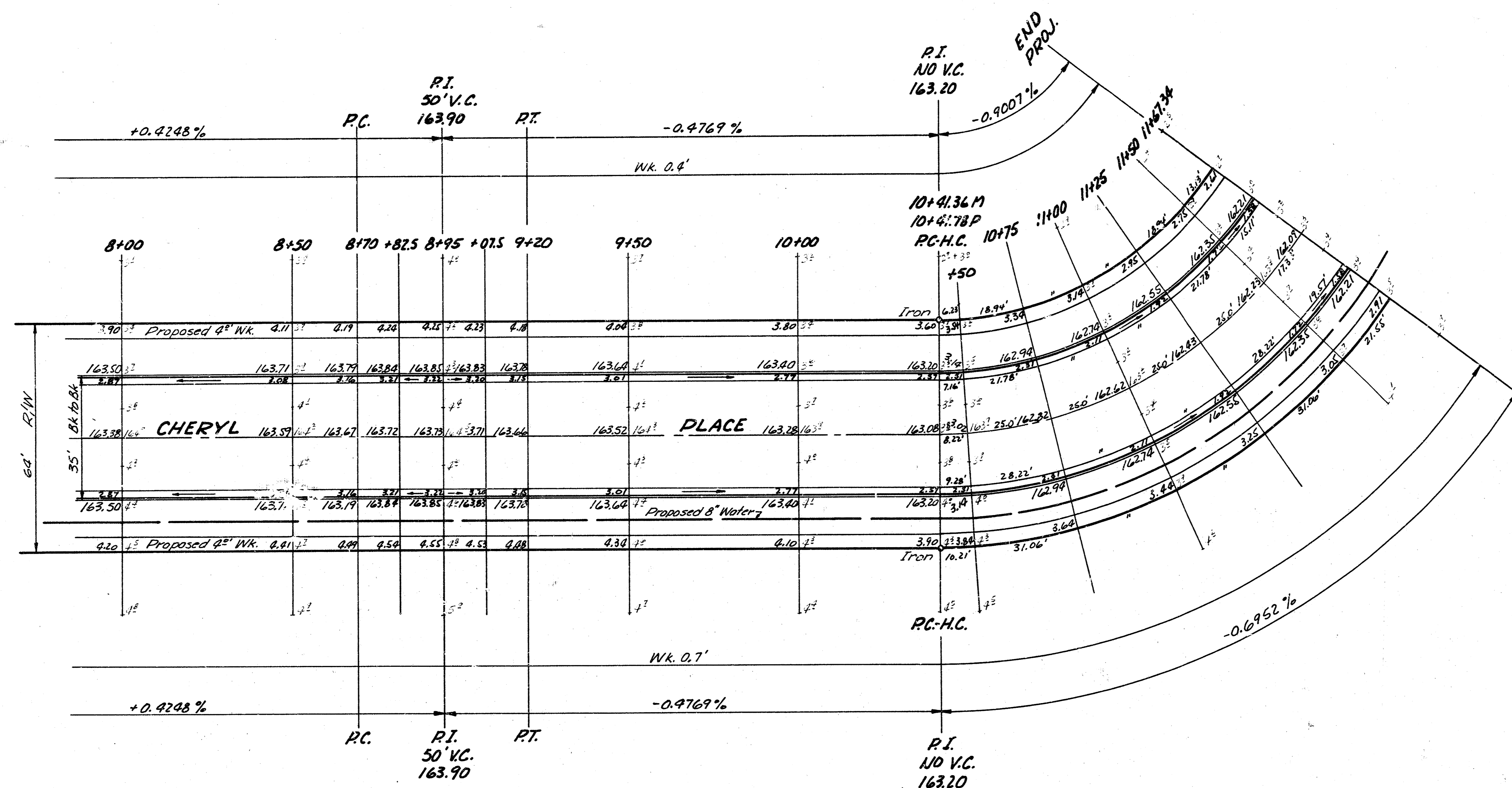
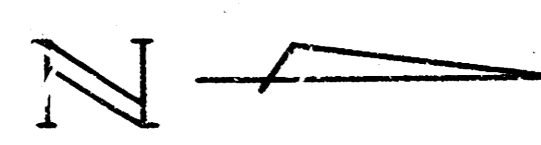

$\Delta = 54^{\circ}30'06''$   $R = 132'$   $T = 47.99'$   $L = 125.56'$   $L.C. = 128.88'$   
 CURVE DATA BASED ON  $\epsilon$  RAD.  $\frac{1}{2} = 27^{\circ}15'03''$

STA.	ARC	CHORD LENGTH		DEFLECTION	
		OFF. L.C.	OFF. R.C.	DEFLECTION	TOTAL DEFLECTION
10+41.78				0° 00' 00"	0° 00' 00"
10+50	8.22	6.44	9.78	1° 47' 03"	1° 47' 03"
10+75	25.0	20.24	29.49	5° 25' 33"	7° 12' 36"
11+00	25.0	20.24	29.49	5° 25' 33"	12° 38' 09"
11+25	25.0	20.24	29.49	5° 25' 33"	18° 03' 42"
11+50	25.0	20.24	29.49	5° 25' 33"	23° 29' 15"
11+67.34	17.34	14.05	20.61	3° 45' 48"	27° 15' 03"

DEFL. / FT. = 13.022061 MIN.

**CHERYL PLACE**  
 E.L. LOT 30, BLK. 10, WESTLINK VILLAGE  
 11<sup>th</sup> ADD<sup>ed</sup> TO W.L. LOT 40, BLK. 10,  
 WESTLINK VILLAGE 11<sup>th</sup> ADD<sup>ed</sup>  
 PROJ. No. DAKS 574052

3/6

FILMED FROM THE BEST AVAILABLE COPY.....