

B.M. 16032 'G' in Globe S end rad. SE Cor. Christine & Morris
 B.M. 16305 'M' in Mueller Fire Hydrant NW Cor. Lightner & Morris
 NOTE: Stations on E. St.

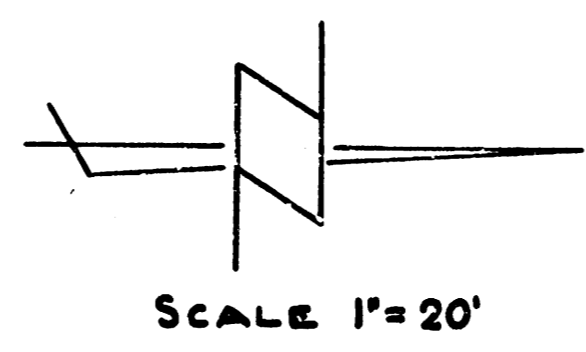

- 135.0
- 136.5
- 138.0
- 139.5
- 141.0
- 142.5
- 144.0
- 145.5
- 147.0
- 148.5
- 150.0
- 151.5
- 153.0
- 154.5
- 156.0
- 157.5
- 159.0
- 160.5
- 162.0
- 163.5
- 165.0
- 166.5
- 168.0
- 169.5
- 171.0
- 172.5
- 174.0
- 175.5
- 177.0
- 178.5
- 180.0
- 181.5
- 183.0
- 184.5
- 186.0
- 187.5
- 189.0
- 190.5
- 192.0
- 193.5
- 195.0
- 196.5
- 198.0
- 199.5
- 201.0
- 202.5
- 204.0
- 205.5
- 207.0
- 208.5
- 210.0
- 211.5
- 213.0
- 214.5
- 216.0
- 217.5
- 219.0
- 220.5
- 222.0
- 223.5
- 225.0
- 226.5
- 228.0
- 229.5
- 231.0
- 232.5
- 234.0
- 235.5
- 237.0
- 238.5
- 240.0
- 241.5
- 243.0
- 244.5
- 246.0
- 247.5
- 249.0
- 250.5
- 252.0
- 253.5
- 255.0
- 256.5
- 258.0
- 259.5
- 261.0
- 262.5
- 264.0
- 265.5
- 267.0
- 268.5
- 270.0
- 271.5
- 273.0
- 274.5
- 276.0
- 277.5
- 279.0
- 280.5
- 282.0
- 283.5
- 285.0
- 286.5
- 288.0
- 289.5
- 291.0
- 292.5
- 294.0
- 295.5
- 297.0
- 298.5
- 300.0
- 301.5
- 303.0
- 304.5
- 306.0
- 307.5
- 309.0
- 310.5
- 312.0
- 313.5
- 315.0
- 316.5
- 318.0
- 319.5
- 321.0
- 322.5
- 324.0
- 325.5
- 327.0
- 328.5
- 330.0
- 331.5
- 333.0
- 334.5
- 336.0
- 337.5
- 339.0
- 340.5
- 342.0
- 343.5
- 345.0
- 346.5
- 348.0
- 349.5
- 351.0
- 352.5
- 354.0
- 355.5
- 357.0
- 358.5
- 360.0
- 361.5
- 363.0
- 364.5
- 366.0
- 367.5
- 369.0
- 370.5
- 372.0
- 373.5
- 375.0
- 376.5
- 378.0
- 379.5
- 381.0
- 382.5
- 384.0
- 385.5
- 387.0
- 388.5
- 390.0
- 391.5
- 393.0
- 394.5
- 396.0
- 397.5
- 399.0
- 400.5
- 402.0
- 403.5
- 405.0
- 406.5
- 408.0
- 409.5
- 411.0
- 412.5
- 414.0
- 415.5
- 417.0
- 418.5
- 420.0
- 421.5
- 423.0
- 424.5
- 426.0
- 427.5
- 429.0
- 430.5
- 432.0
- 433.5
- 435.0
- 436.5
- 438.0
- 439.5
- 441.0
- 442.5
- 444.0
- 445.5
- 447.0
- 448.5
- 450.0
- 451.5
- 453.0
- 454.5
- 456.0
- 457.5
- 459.0
- 460.5
- 462.0
- 463.5
- 465.0
- 466.5
- 468.0
- 469.5
- 471.0
- 472.5
- 474.0
- 475.5
- 477.0
- 478.5
- 480.0
- 481.5
- 483.0
- 484.5
- 486.0
- 487.5
- 489.0
- 490.5
- 492.0
- 493.5
- 495.0
- 496.5
- 498.0
- 499.5
- 501.0
- 502.5
- 504.0
- 505.5
- 507.0
- 508.5
- 510.0
- 511.5
- 513.0
- 514.5
- 516.0
- 517.5
- 519.0
- 520.5
- 522.0
- 523.5
- 525.0
- 526.5
- 528.0
- 529.5
- 531.0
- 532.5
- 534.0
- 535.5
- 537.0
- 538.5
- 540.0
- 541.5
- 543.0
- 544.5
- 546.0
- 547.5
- 549.0
- 550.5
- 552.0
- 553.5
- 555.0
- 556.5
- 558.0
- 559.5
- 561.0
- 562.5
- 564.0
- 565.5
- 567.0
- 568.5
- 570.0
- 571.5
- 573.0
- 574.5
- 576.0
- 577.5
- 579.0
- 580.5
- 582.0
- 583.5
- 585.0
- 586.5
- 588.0
- 589.5
- 591.0
- 592.5
- 594.0
- 595.5
- 597.0
- 598.5
- 600.0
- 601.5
- 603.0
- 604.5
- 606.0
- 607.5
- 609.0
- 610.5
- 612.0
- 613.5
- 615.0
- 616.5
- 618.0
- 619.5
- 621.0
- 622.5
- 624.0
- 625.5
- 627.0
- 628.5
- 630.0
- 631.5
- 633.0
- 634.5
- 636.0
- 637.5
- 639.0
- 640.5
- 642.0
- 643.5
- 645.0
- 646.5
- 648.0
- 649.5
- 651.0
- 652.5
- 654.0
- 655.5
- 657.0
- 658.5
- 660.0
- 661.5
- 663.0
- 664.5
- 666.0
- 667.5
- 669.0
- 670.5
- 672.0
- 673.5
- 675.0
- 676.5
- 678.0
- 679.5
- 681.0
- 682.5
- 684.0
- 685.5
- 687.0
- 688.5
- 690.0
- 691.5
- 693.0
- 694.5
- 696.0
- 697.5
- 699.0
- 700.5
- 702.0
- 703.5
- 705.0
- 706.5
- 708.0
- 709.5
- 711.0
- 712.5
- 714.0
- 715.5
- 717.0
- 718.5
- 720.0
- 721.5
- 723.0
- 724.5
- 726.0
- 727.5
- 729.0
- 730.5
- 732.0
- 733.5
- 735.0
- 736.5
- 738.0
- 739.5
- 741.0
- 742.5
- 744.0
- 745.5
- 747.0
- 748.5
- 750.0
- 751.5
- 753.0
- 754.5
- 756.0
- 757.5
- 759.0
- 760.5
- 762.0
- 763.5
- 765.0
- 766.5
- 768.0
- 769.5
- 771.0
- 772.5
- 774.0
- 775.5
- 777.0
- 778.5
- 780.0
- 781.5
- 783.0
- 784.5
- 786.0
- 787.5
- 789.0
- 790.5
- 792.0
- 793.5
- 795.0
- 796.5
- 798.0
- 799.5
- 801.0
- 802.5
- 804.0
- 805.5
- 807.0
- 808.5
- 810.0
- 811.5
- 813.0
- 814.5
- 816.0
- 817.5
- 819.0
- 820.5
- 822.0
- 823.5
- 825.0
- 826.5
- 828.0
- 829.5
- 831.0
- 832.5
- 834.0
- 835.5
- 837.0
- 838.5
- 840.0
- 841.5
- 843.0
- 844.5
- 846.0
- 847.5
- 849.0
- 850.5
- 852.0
- 853.5
- 855.0
- 856.5
- 858.0
- 859.5
- 861.0
- 862.5
- 864.0
- 865.5
- 867.0
- 868.5
- 870.0
- 871.5
- 873.0
- 874.5
- 876.0
- 877.5
- 879.0
- 880.5
- 882.0
- 883.5
- 885.0
- 886.5
- 888.0
- 889.5
- 891.0
- 892.5
- 894.0
- 895.5
- 897.0
- 898.5
- 900.0
- 901.5
- 903.0
- 904.5
- 906.0
- 907.5
- 909.0
- 910.5
- 912.0
- 913.5
- 915.0
- 916.5
- 918.0
- 919.5
- 921.0
- 922.5
- 924.0
- 925.5
- 927.0
- 928.5
- 930.0
- 931.5
- 933.0
- 934.5
- 936.0
- 937.5
- 939.0
- 940.5
- 942.0
- 943.5
- 945.0
- 946.5
- 948.0
- 949.5
- 951.0
- 952.5
- 954.0
- 955.5
- 957.0
- 958.5
- 960.0
- 961.5
- 963.0
- 964.5
- 966.0
- 967.5
- 969.0
- 970.5
- 972.0
- 973.5
- 975.0
- 976.5
- 978.0
- 979.5
- 981.0
- 982.5
- 984.0
- 985.5
- 987.0
- 988.5
- 990.0
- 991.5
- 993.0
- 994.5
- 996.0
- 997.5
- 999.0
- 1000.5

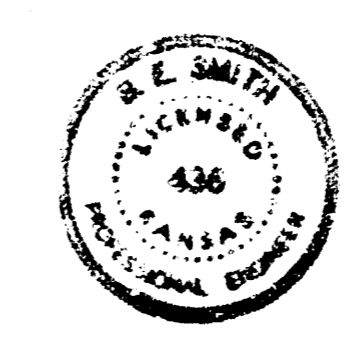
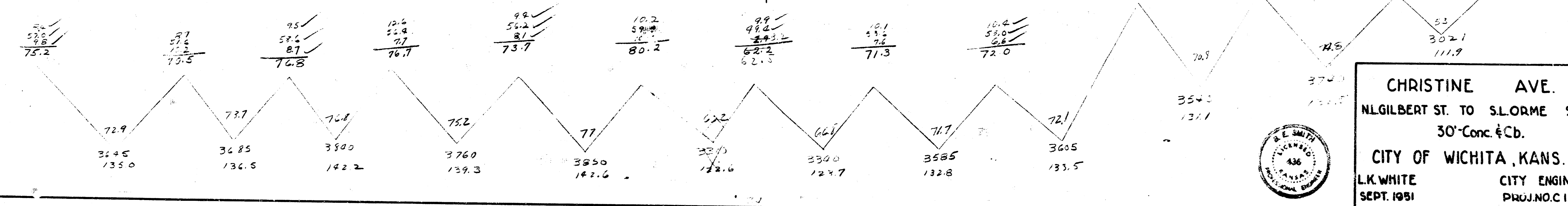
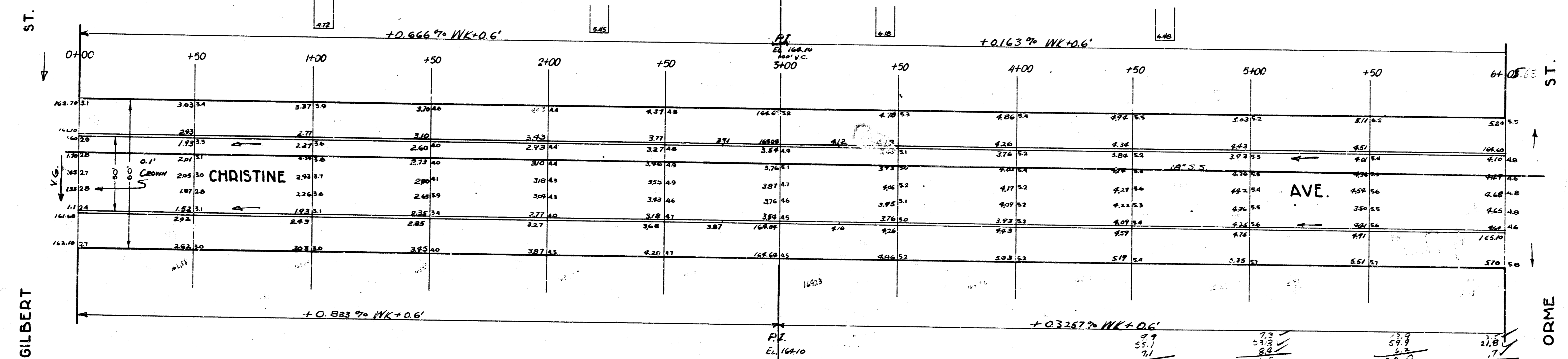
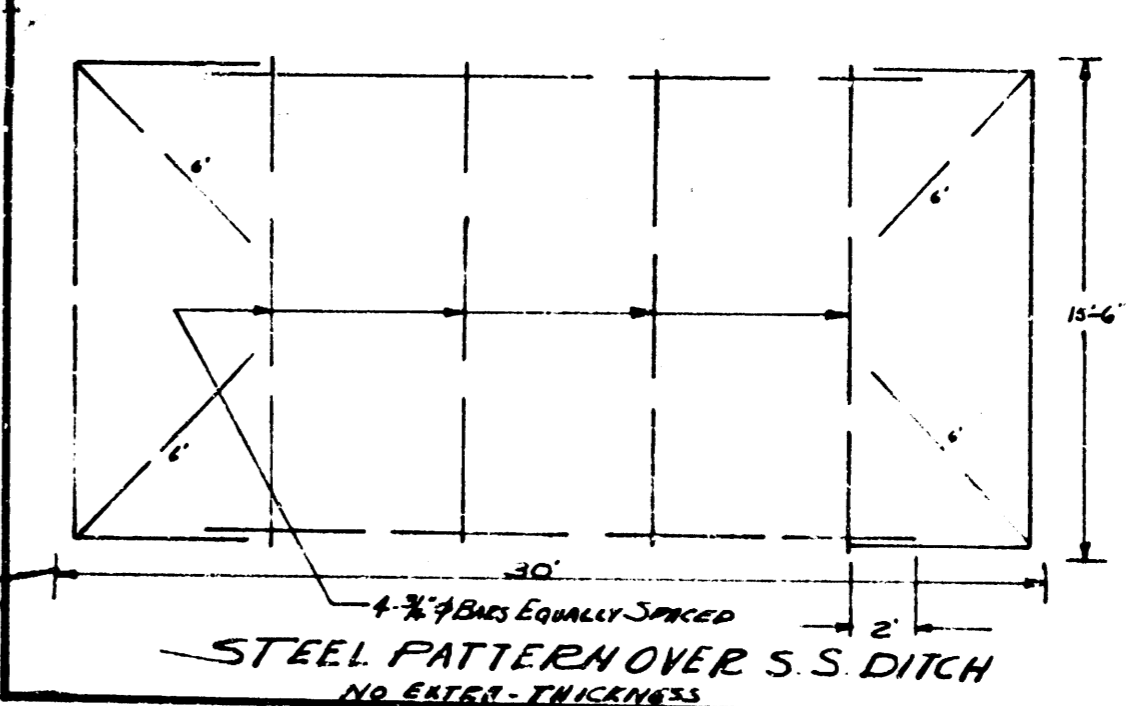

CHRISTINE AVE.
 NL GILBERT ST. TO S. ORME ST.
 30' Conc. & Cb.
 CITY OF WICHITA, KANS.
 L.K. WHITE CITY ENGINEER
 SEPT. 1951 PROJ. NO. C 11-91