

**STREET IMPROVEMENTS
FOR**

CLARA STREET

**FROM THE SOUTH LINE OF BRATCHER ADDITION
TO AND INCLUDING CUL-DE-SAC**

PROJECT NO.

472-76-245-81493-000-000-001

**THE CITY OF WICHITA, KS.
MICHAEL E. LINDEBAK
CITY ENGINEER**

GENERAL NOTES

1. No more than 5 drives 60' feet in width, or equivalent combinations thereof, are to be constructed with this project.
2. Mailboxes within the limits of the project shall be removed and replaced by the Contractor as approved by the Engineer. Contractor will be required to make satisfactory provisions for mail delivery to properties affected by this project during its construction.
3. Trees and shrubs in public right-of-way which are in direct conflict with proposed new construction shall be removed by the Contractor with the Engineer's approval. Trees and shrubs which are not in direct conflict with proposed new construction shall be saved and protected from damage.
4. The Contractor shall be responsible for preserving property irons. The Contractor will be required to re-establish any property irons which are damaged or destroyed by his construction operations. Such irons shall be re-established by a licensed land surveyor or a licensed professional engineer in accordance with state laws.

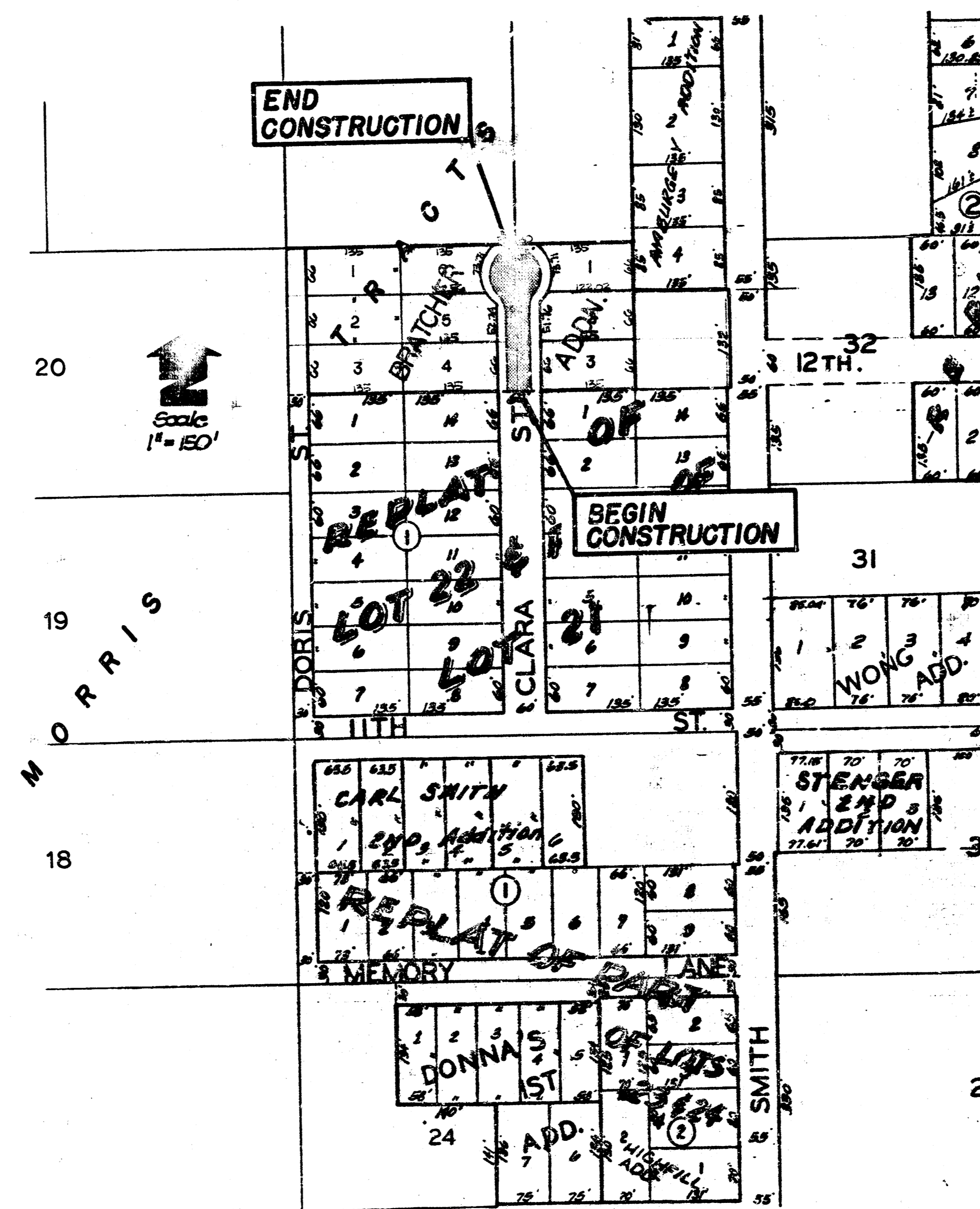

INDEX OF SHEETS

TITLE SHEET.....	1
TYPICAL SECTION.....	2
STREET PLAN.....	3
EARTHWORK SECTIONS.....	4

BENCHMARKS

1. So. rim Manhole 163' N. & 155' W. of E. Smith at 12th Street.
Elev. = 125.46 City Datum.
2. 1/2" cut in top of curb, right-of-way at 0-01.5. Elev. = 127.25 City Datum

BENEFIT DISTRICT

TITLE SHEET

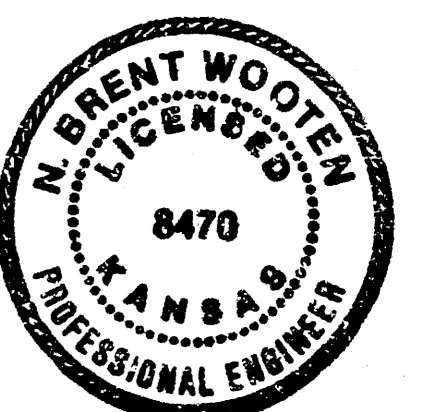

BAUGHMAN COMPANY, P.A.				
SURVEYING & ENGINEERING				
316262-7271 • 315 ELLIS • WICHITA, KANSAS 67211				
DESIGN	DRAWN	APPROVED	DATE	SCALE
NIS Wooten	R.J. Plush		March 87	

REV.	
SHEET	1
OF	4

**FILMED FROM THE BEST
AVAILABLE COPY**

TYPICAL 31' PAVEMENT DETAILS

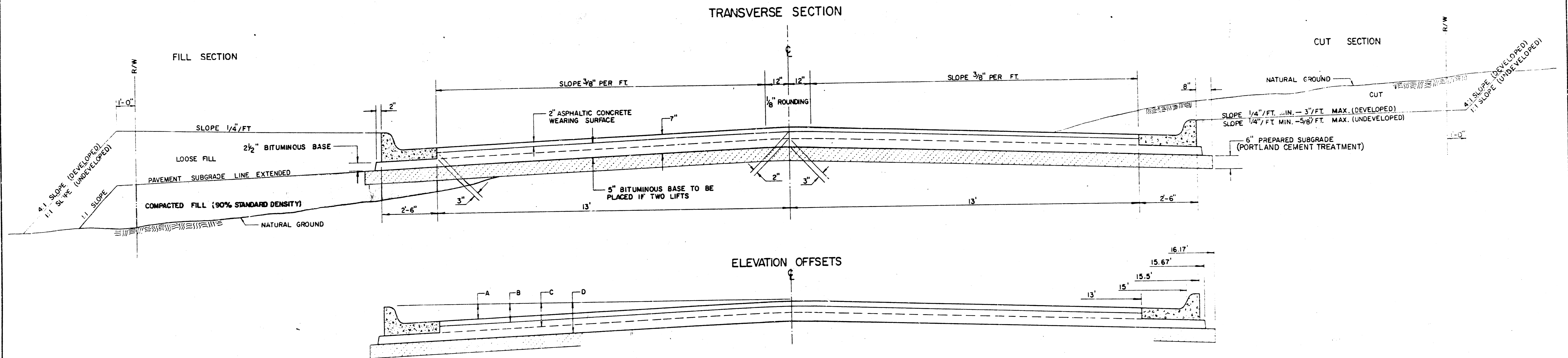

	DISTANCE FROM CENTERLINE (LT. & RT.)												
	0'	2'	4'	6'	7.5'	10'	12'	13'	15'	15.5'	15.67'	16.17'	
A. TOP OF CURBS TO TOP OF SURFACE LIFT	0.10	0.14	0.21	0.27	0.32	0.39	0.46	0.49	—	—	—	—	
B. TOP OF CURBS TO TOP OF UPPER BASE LIFT	0.27	0.31	0.38	0.44	0.49	0.56	0.63	0.66	—	—	—	—	
C. TOP OF CURBS TO TOP OF LOWER BASE LIFT	0.44	0.49	0.57	0.64	0.70	0.79	0.87	0.90	0.98	1.00	1.00	—	
D. TOP OF CURBS TO TOP OF SUBGRADE	0.69	0.73	0.80	0.87	0.93	1.01	1.08	1.12	1.19	1.21	1.21	1.23	

COMBINED CURB & GUTTER

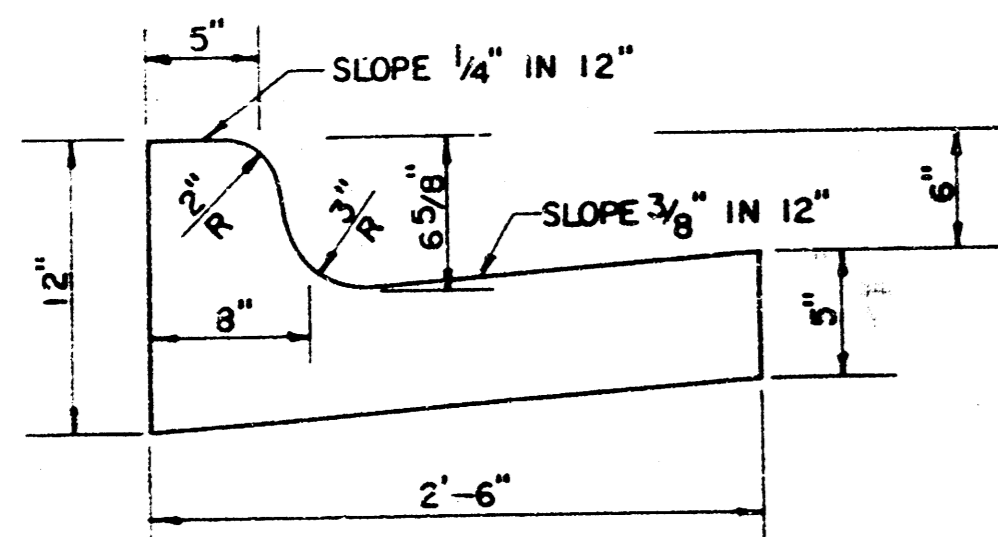

TRANSVERSE CONSTRUCTION JOINTS

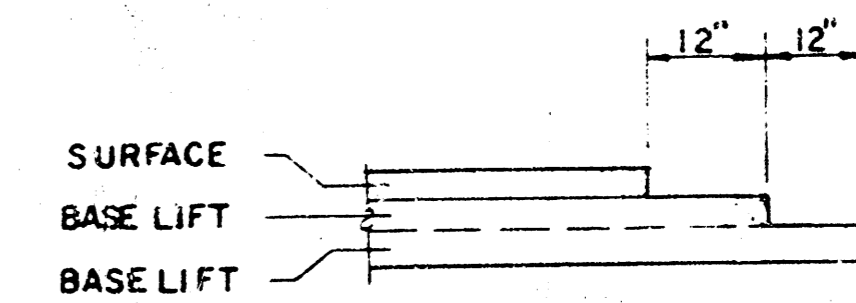

GENERAL NOTES

- 1) THE ASPHALTIC CONCRETE PAVEMENT BETWEEN THE COMBINED CURB AND GUTTER SHALL BE PAID AS SQUARE YARDS OF 7" ASPHALTIC CONCRETE (5" BITUMINOUS BASE).
- 2) THE BITUMINOUS BASE UNDER AND BEHIND THE COMBINED CURB AND GUTTER SHALL BE PAID AS SQUARE YARDS OF 2 1/2" BITUMINOUS BASE.
- 3) A TACK COAT OF EMULSIFIED ASPHALT (SC-1H OR CSS-1H) SHALL BE APPLIED AT AN APPROXIMATE RATE OF 0.05 GALLONS PER SQUARE YARD BETWEEN EACH LIFT OF ASPHALTIC MATERIAL.
- 4) BITUMINOUS BASE AND ASPHALTIC CONCRETE WEARING SURFACE SHALL BE PLACED WITH A LAYDOWN MACHINE HAVING AUTOMATIC CONTROLS FOR LINE AND GRADE.
- 5) CONSTRUCTION JOINTS IN EACH LIFT SHALL BE STAGGERED A MINIMUM DISTANCE OF ONE (1) FOOT FROM JOINTS IN PRECEDING LIFTS AND PLACED SO THAT A JOINT WILL BE CONSTRUCTED ON THE CENTERLINE OF THE TOP LIFT.
- 6) CONTRACTOR TO BID ONLY ONE SUBGRADE TREATMENT ALTERNATE WHEN ALTERNATES ARE PROVIDED IN THE PROPOSAL AND CONTRACT. THE ALTERNATE CHOSEN BY THE SUCCESSFUL BIDDER SHALL BE USED IN CONSTRUCTING THIS PROJECT.

TRANSVERSE CONSTRUCTION JOINTS SHALL BE CONSTRUCTED IN FLEXIBLE BASE PAVEMENTS AT LOCATIONS WHERE PAVEMENT MEETS EXISTING FLEXIBLE BASE PAVEMENT AS SHOWN BY THE DETAIL. ALL COSTS ASSOCIATED WITH THE CONSTRUCTION OF THE TRANSVERSE JOINT SHALL BE INCLUDED IN THE BID PRICE FOR SQUARE YARDS 7" ASPHALTIC CONCRETE (5" BITUMINOUS BASE).

7 INCH RESIDENTIAL ASPHALTIC CONCRETE PAVEMENT WITH 5 INCH BITUMINOUS BASE
CITY OF WICHITA, KANSAS
PROJECT NUMBER
472-76-245-81493-000-000-001

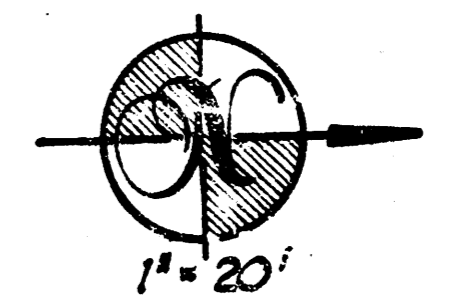
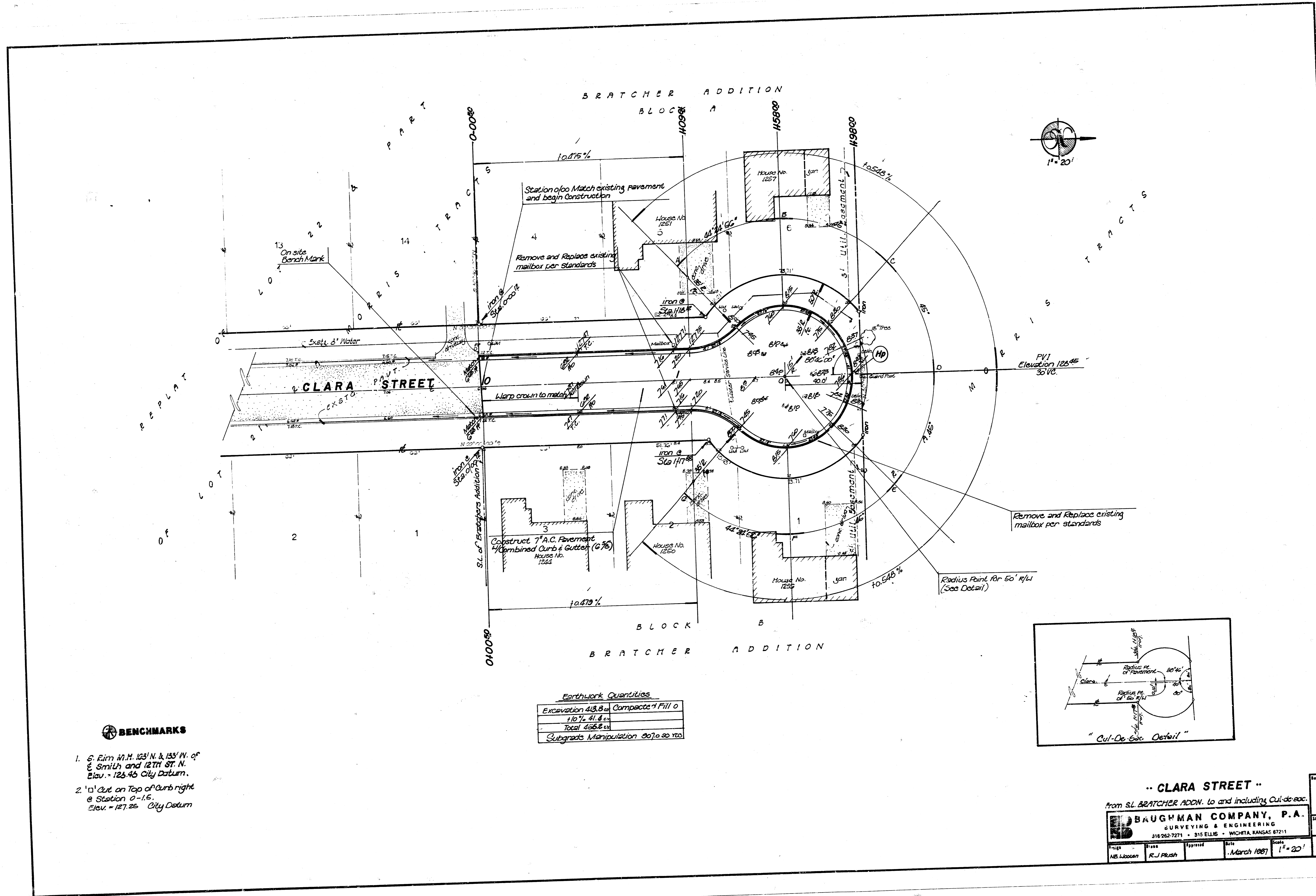

BENCHMARKS

1. S. Rim W.H. 123' N. & 133' W. of E. Smith and 12TH ST. N. Elev. = 123.45 City Datum.
2. 1'0\"/>

Earthwork Quantities

Excavation	413.8 cu yds	Compacted Fill	0
	+10% = 45.5 cu yds		
Total	459.3 cu yds		
Subgrade Manipulation 2070 sq yds			

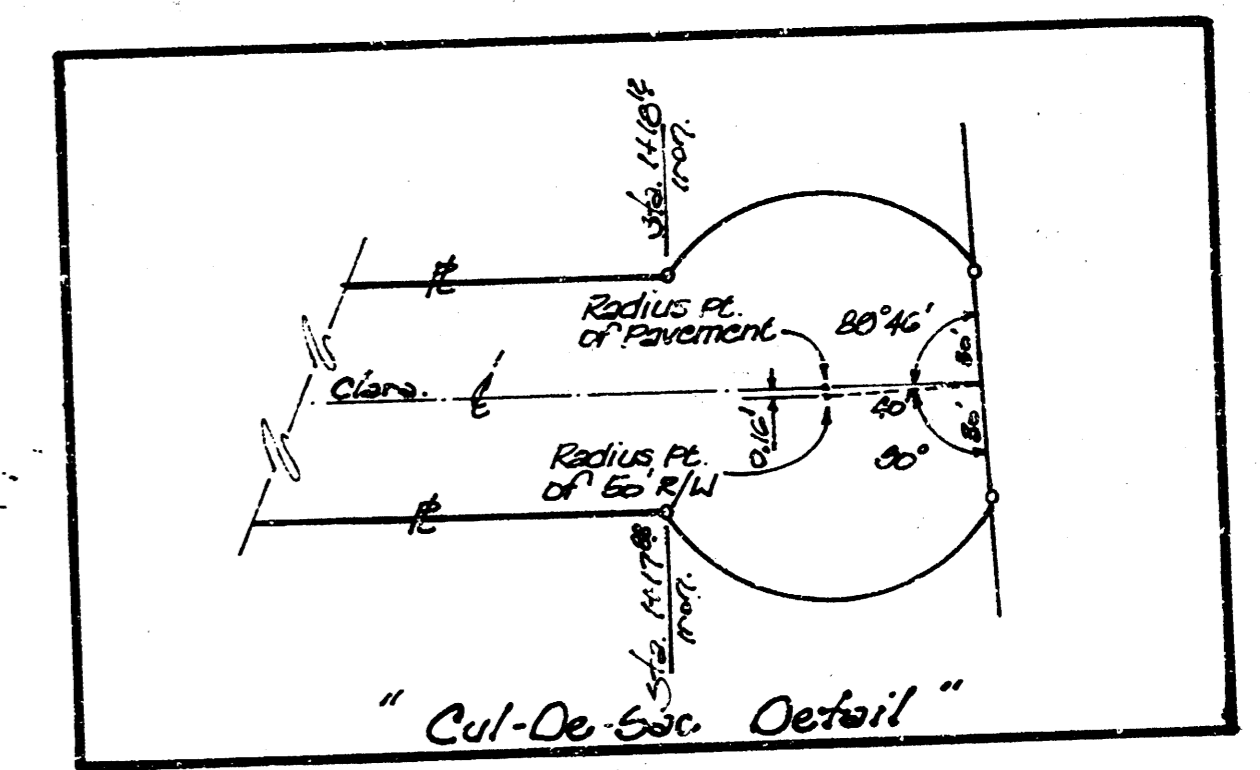

CLARA STREET

From S.L. BRATCHER ADDN. to and including Cul-de-sac.

BAUGHMAN COMPANY, P.A.
 SURVEYING & ENGINEERING
 315 262-7271 • 315 ELLIS • WICHITA, KANSAS 67211

Project	Drawn	Approved	Date	Scale
MS. Lizzoran	R.J. Plush		March 1987	1" = 20'

FILMED FROM THE BEST AVAILABLE COPY

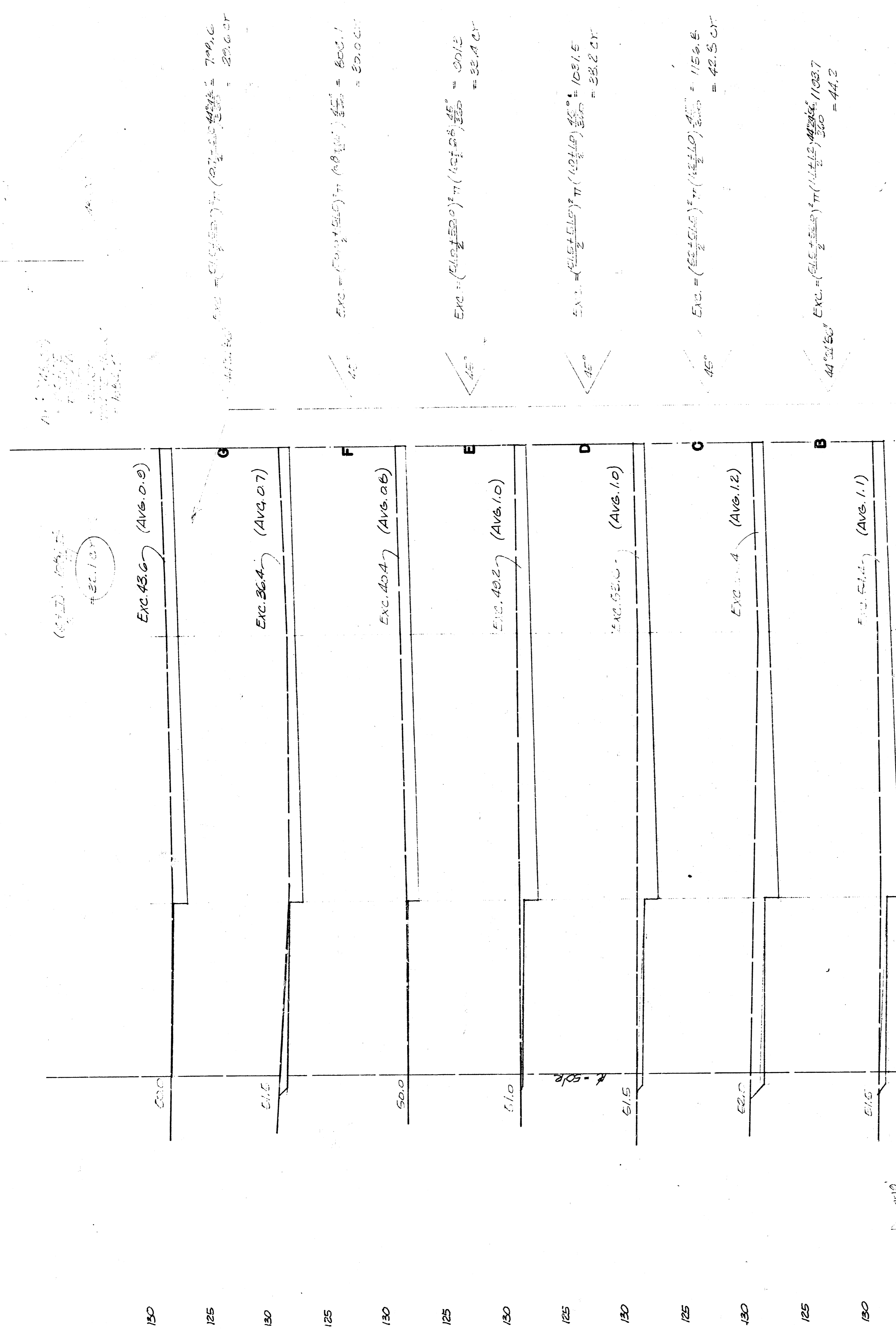

Exc. = $(\frac{100 \times 100}{100}) \times (\frac{100}{100}) = 100.0$
Exc. = $(\frac{100 \times 100}{100}) \times (\frac{100}{100}) = 100.0$
Exc. = $(\frac{100 \times 100}{100}) \times (\frac{100}{100}) = 100.0$
Exc. = $(\frac{100 \times 100}{100}) \times (\frac{100}{100}) = 100.0$
Exc. = $(\frac{100 \times 100}{100}) \times (\frac{100}{100}) = 100.0$
Exc. = $(\frac{100 \times 100}{100}) \times (\frac{100}{100}) = 100.0$

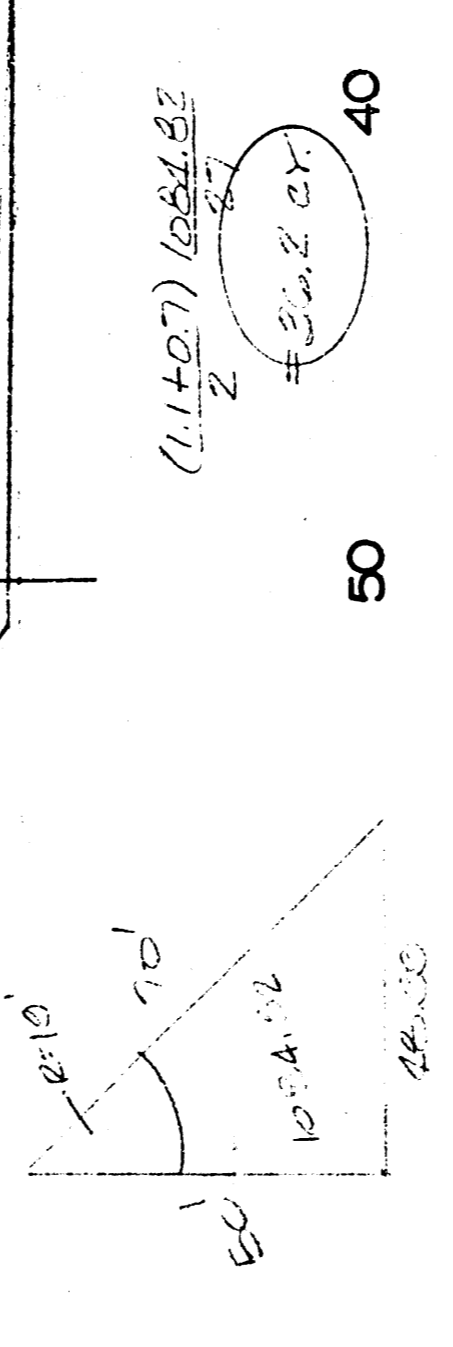

$A = \frac{1}{2} \times (100 + 100) \times 100 = 10000$
 $Z = \frac{10000}{100} = 100$
 $Z = 100$
 $10000 - 10000 = 0$
 $10000 - 10000 = 0$

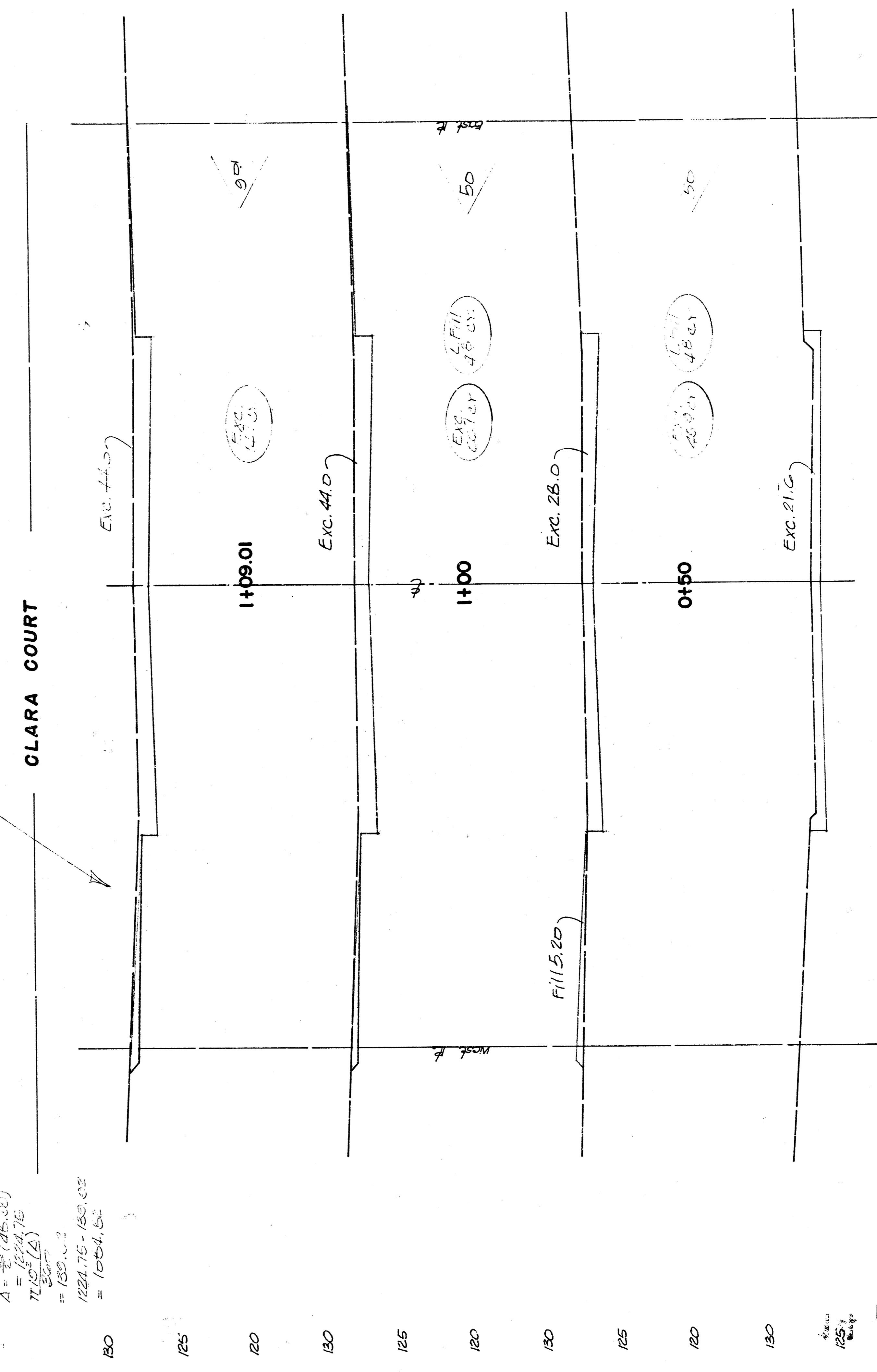

CLARA STREET

EARTHWORK SECTIONS

FILMED FROM THE BEST AVAILABLE COPY

7/24