

J.A.E.
A.E.
J.T.

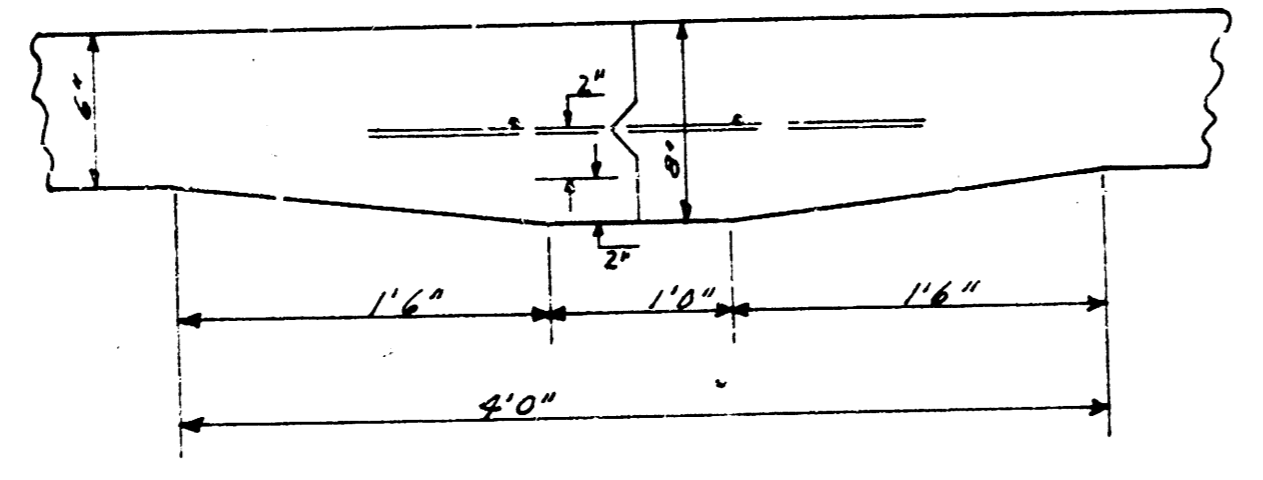

CLARK ST.
 E.L. HILLSIDE TO W.L. GEO. WASH. DR.
 30' CONC. & CO.
 CITY OF WICHITA KANSAS
 B.E. SMITH CITY ENGINEER
 APRIL 1934 FROM 114-13-233

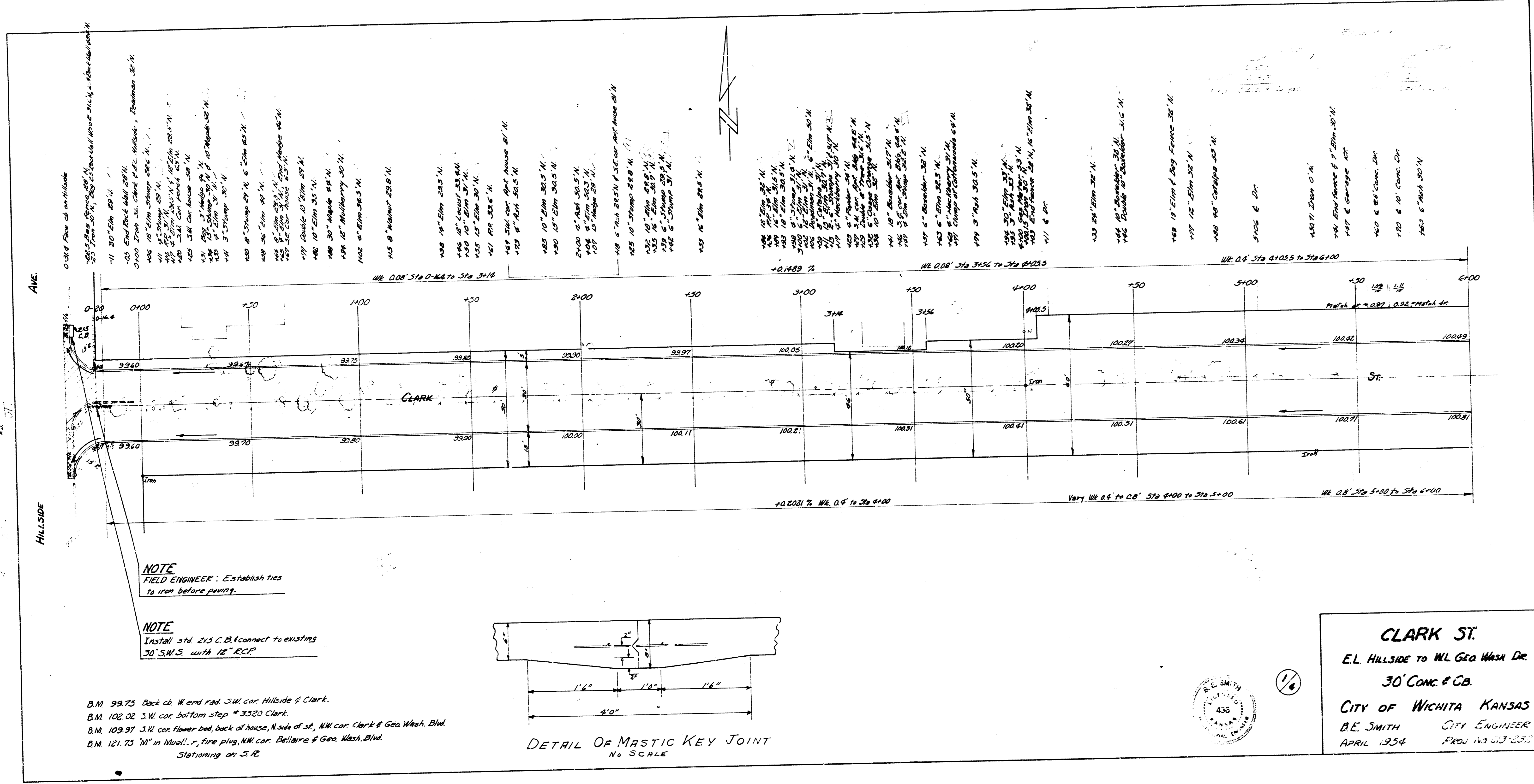

1/6

B.M. 99.75 Back ch. W. end rd. S.W. cor. Hillside & Clark.
 B.M. 100.00 S.W. cor. bottom step # 3320 Clark.
 B.M. 109.97 S.W. cor. flower bed, back of house, N. side of st., NW cor. Clark & Geo. Wash. Blvd.
 B.M. 121.75 7 1/2" in. vial, r. fire plug, NW cor. Bellaire & Geo. Wash. Blvd.
 Stationing on S.R.

