

B.M. 130.38 S.W. Cor. Drive Q Ho. # 2100 Brentwood, 20' W. of H.  
 B.M. 133.06 S.W. Cor. Conc. Parsh. Ho. # 3734 E. Clark St.  
 Base line of Stationing on N.P.L.

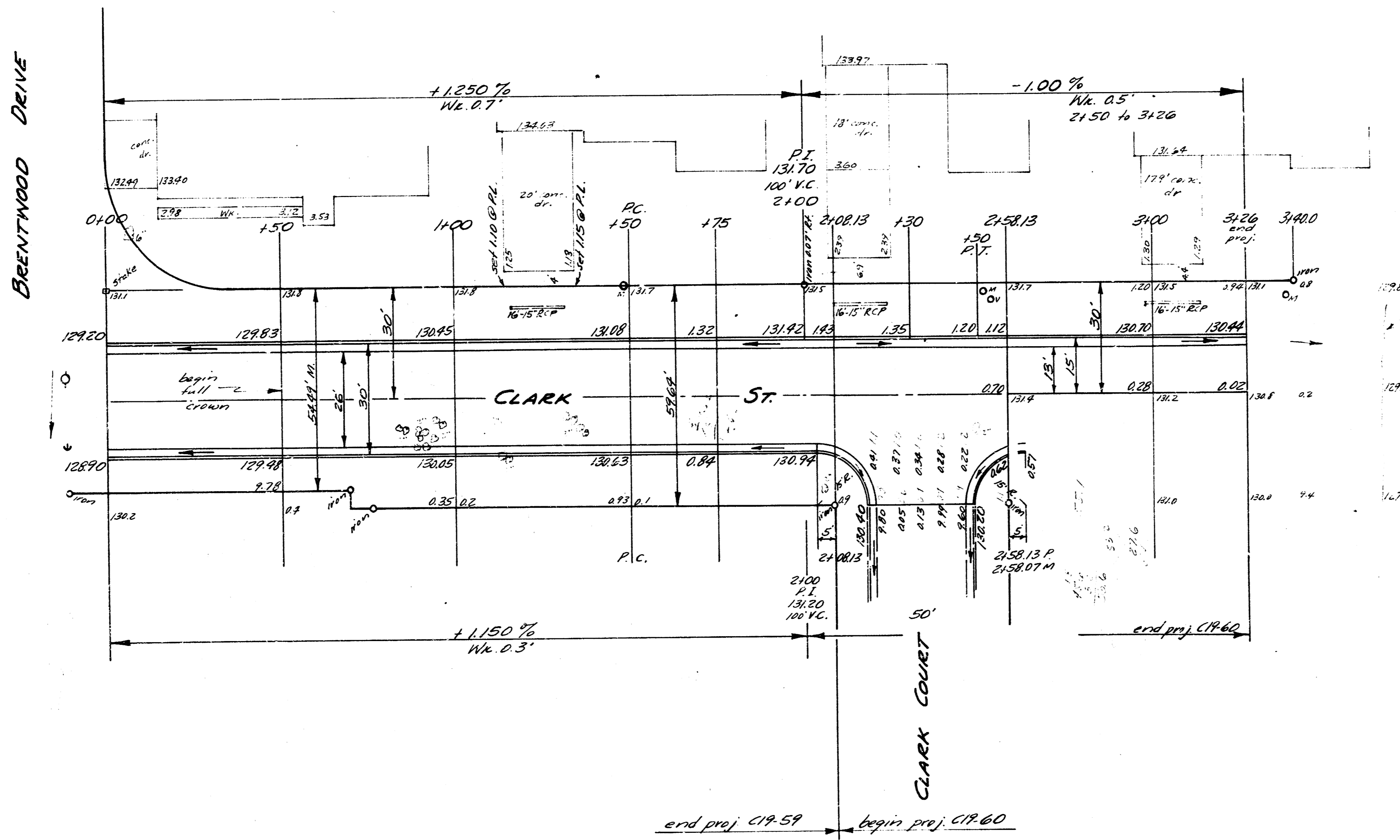

2100 - 2112.5  
 2112.5 - 2125  
 2125 - 2137.5  
 2137.5 - 2150  
 2150 - 2162.5  
 2162.5 - 2175  
 2175 - 2187.5  
 2187.5 - 2200



CLARK ST., N<sup>1</sup>/<sub>2</sub>  
 W.L. CLARK CT. TO 26' E. OF W.L.  
 LOT 5, BLK. B, MT. VERNON HEIGHTS  
 13-2-15 A.C.  
 1959 PROJ. C19-60

CLARK ST.  
 E.L. BRENTWOOD TO W.L. CLARK CT.  
 26-2-30 A.C.  
 CITY OF WICHITA, KANSAS  
 B.E. SMITH - CITY ENGINEER  
 APRIL, 1959 PROJ. C19-59

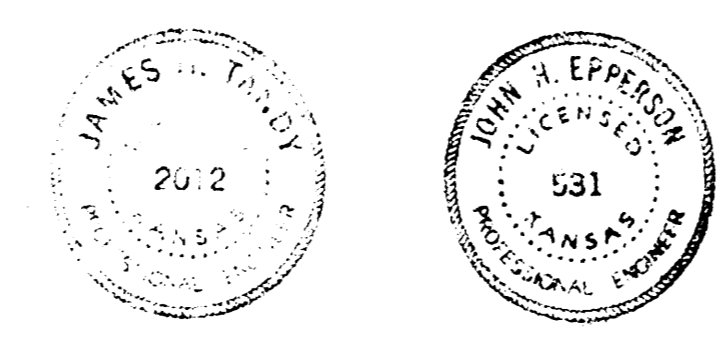

1/2