

Note to Engineer & Contractor:  
 Set walk grade as shown on plans.  
 Set walk grade +0.7' above top of curb thru drives.

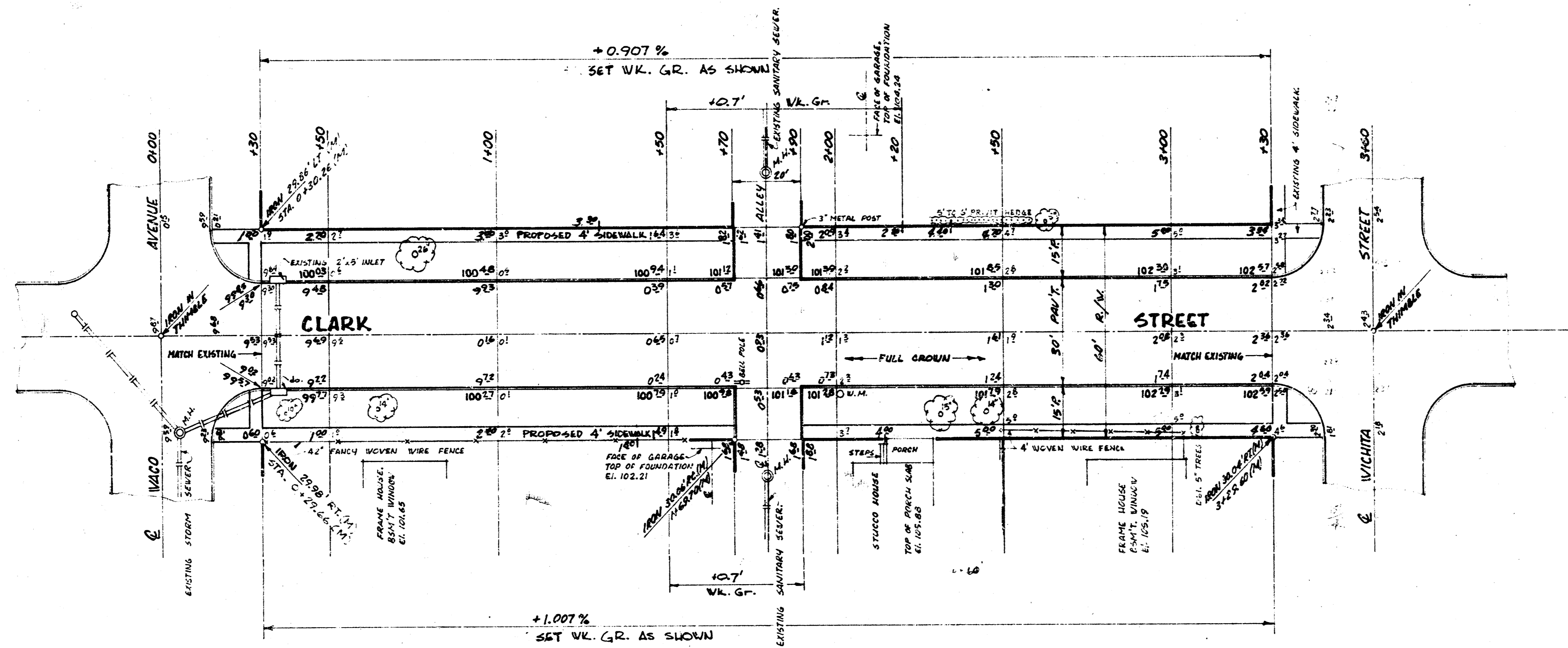

B.M. 99.70 IRON IN THIMBLE, @ WACO & CLARK.  
 T.B.M. 102.53 "X" CUT, TOP S. CB. CLARK @ W. END RAD. ON S.W. COR.,  
 CLARK & WICHITA.  
 BASE LINE ON @ of CLARK.

- GENERAL NOTES:
- 1) CONTRACTOR TO CLEAR, GRADE, & COMPACT FILL IN R/W. AS NECESSARY TO CONSTRUCT PROPOSED 4' SIDEWALK. SIDEWALK TO BE CONSTRUCTED UNDER SEPARATE CONTRACT.
  - 2) ALL DISTANCES BASED ON PLATTED DIMENSIONS, EXCEPT MEASURED DISTANCES DENOTED BY (M).



|          | EARTHWORK  |            | COMPACTED FILL |                 |
|----------|------------|------------|----------------|-----------------|
|          | EXCAVATION | PROPERTY   | CITY           | PROP.           |
| PLUS 10% | 38.7 C.Y.  | 417.9 C.Y. | 12.2 C.Y. S&M. | 171.1 C.Y. S&M. |
| TOTAL    | 42.6 C.Y.  | 459.7 C.Y. | 12.2 C.Y. S&M. | 171.1 C.Y. S&M. |

DRAWN BY: B.K. JONES 164  
 CHECKED BY: [Signature]  
 EXACT C.A.S.  
 CIRCLED: [Signature]



**CLARK STREET** FROM THE EAST LINE OF WACO AVENUE TO THE WEST LINE OF WICHITA STREET.

30' WIDE CONCRETE PAVEMENT, 6" THK., W/ INT. CURB

CITY OF WICHITA, KANSAS.

B.E. SMITH, CITY ENGINEER

DATE: MAY, 1969

PROJECT No. C18-36

SHEET 1 of 2