

B.M. 144.58 3rd NW Cor. Lincoln & Park Road
 B.M. 148.05 S.E. Cor. Conc. Pavt. H. 16. 2084 Clay St.

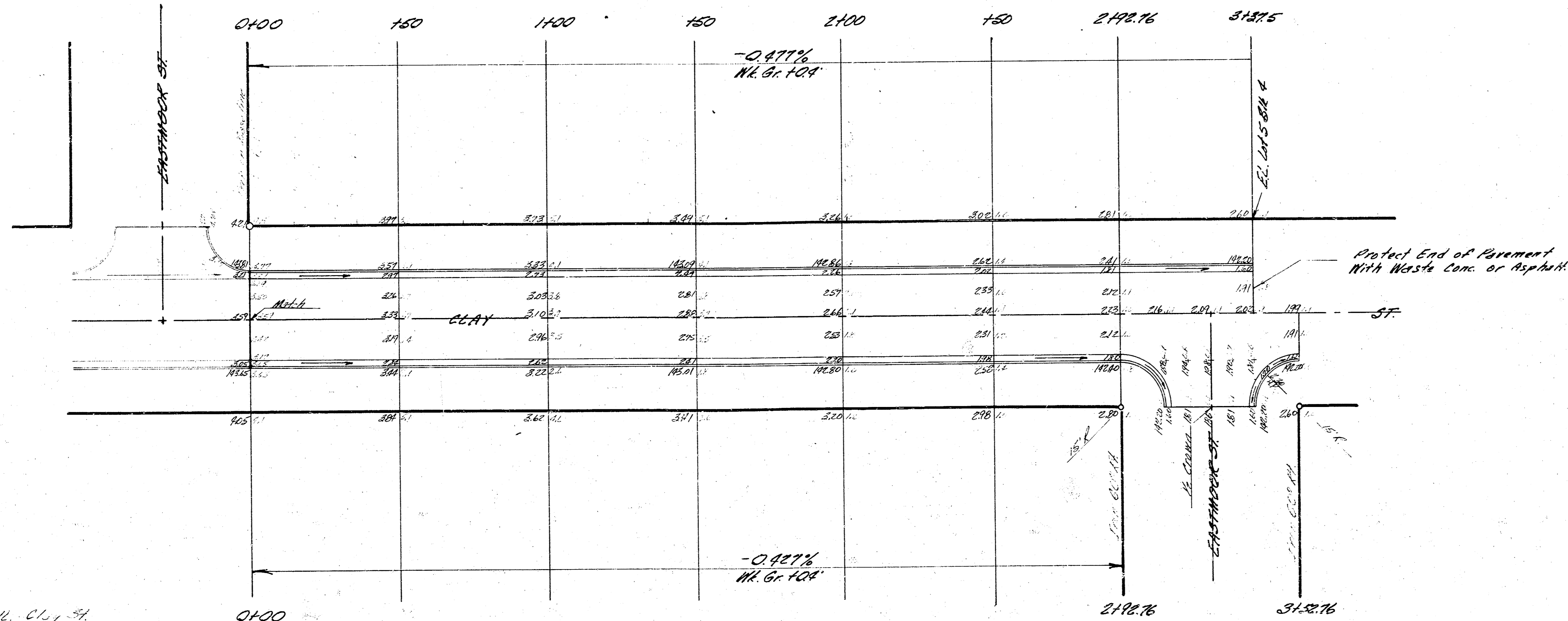
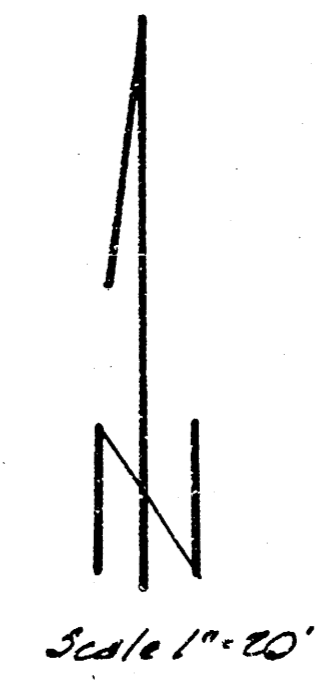

Excavation N.W. Clay St.

Excavation
 Prop.
 288.9 C.Y.
 28.9 +10%
 317.8 Total C.Y.

Compacted Fill
 Prop. City
 63.2 C.Y. 26.7 C.Y.
 6.3 +10% 2.7 +10%
 67.5 Total C.Y. 29.4 Total C.Y.

CLAY ST.
 E.L. EASTMOOR ST. TO E.L. LOT'S
 BLK. 4, EASTRIDGE PARK ADDN.
 26' - 2" - 30' AC.
 CITY OF WICHITA, KANSAS
 B.E. SMITH CITY ENGINEER
 DATE: MAY 1965
 PROJNO C14-12

