

K-10

B.M. 12989 WITH H.L. 3 IN CTR. SLAB @ HARRY & CLIFTON



STATIONING ON W.R.

1677 P.P. 58' 4" E

1686 R.C.P. 140' 0" S

1625 R.C.P. 16' 11" S

+3.65% W.C. 0.2'

1688 S.I.A.M.C. CONC. 10' 0" S

1662 CURB HOUSING DE. ON R.

1691 CURB HOUSING DE. ON R.

+5.29 CURB 58' 1" E

1618 W.L. ON R.

1635 W.L. 55.6' E

+6.59 CURB 58' 1" E

+71 P.P. 55' 1" E

CITY PROPERTY

- 118.9
- 118.1
- 21.7
- 35.7
- 27.8
- 47.2
- 37.2
- 59.2
- 27.2
- 32.2
- 70.2
- 1.1

GRAND

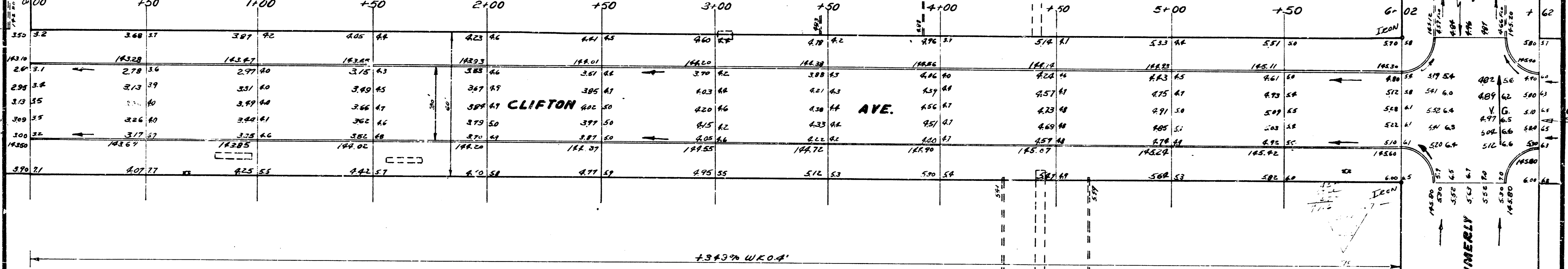

+3.43% W.C. 0.4'

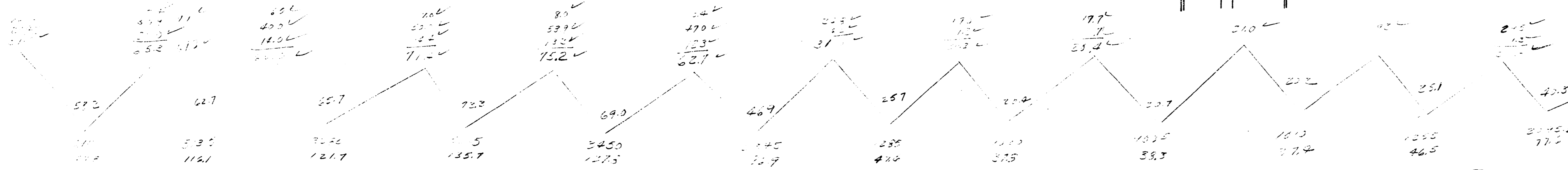

REVISED
8-6-52

CLIFTON
N.L. ZIMMERLY TO N.L. GRAND
30' CONC. & C.B.

CITY OF WICHITA KANSAS
L.K. WHITE CITY ENGINEER
APRIL 1952 P.W. No. C11-305



1951 1225 1604 CI-523
 G.K. WHITE CIVIL ENGINEER
 CITY OF MICHIGAN
 30. CONCRETE
 10 WEST 10th ST
 DETROIT, MICH.

