

B.M. 11874 Step bench N.S. Guy Pole
S.S. Maple & W.S. Colorado No.

NOTE- CONTRACTOR: Utility service lines may be located unusually close to the surface. Therefore, extreme care shall be used in excavating & grading in connection with this project.

Scale: 1"=20'

Ref. Points to Iron N.L. Maple & Colorado N.
1. 4135 S. to N. edge brick pavement.
2. 347' E. to W. Face of 1st building N.

NOTE: Match all drives.

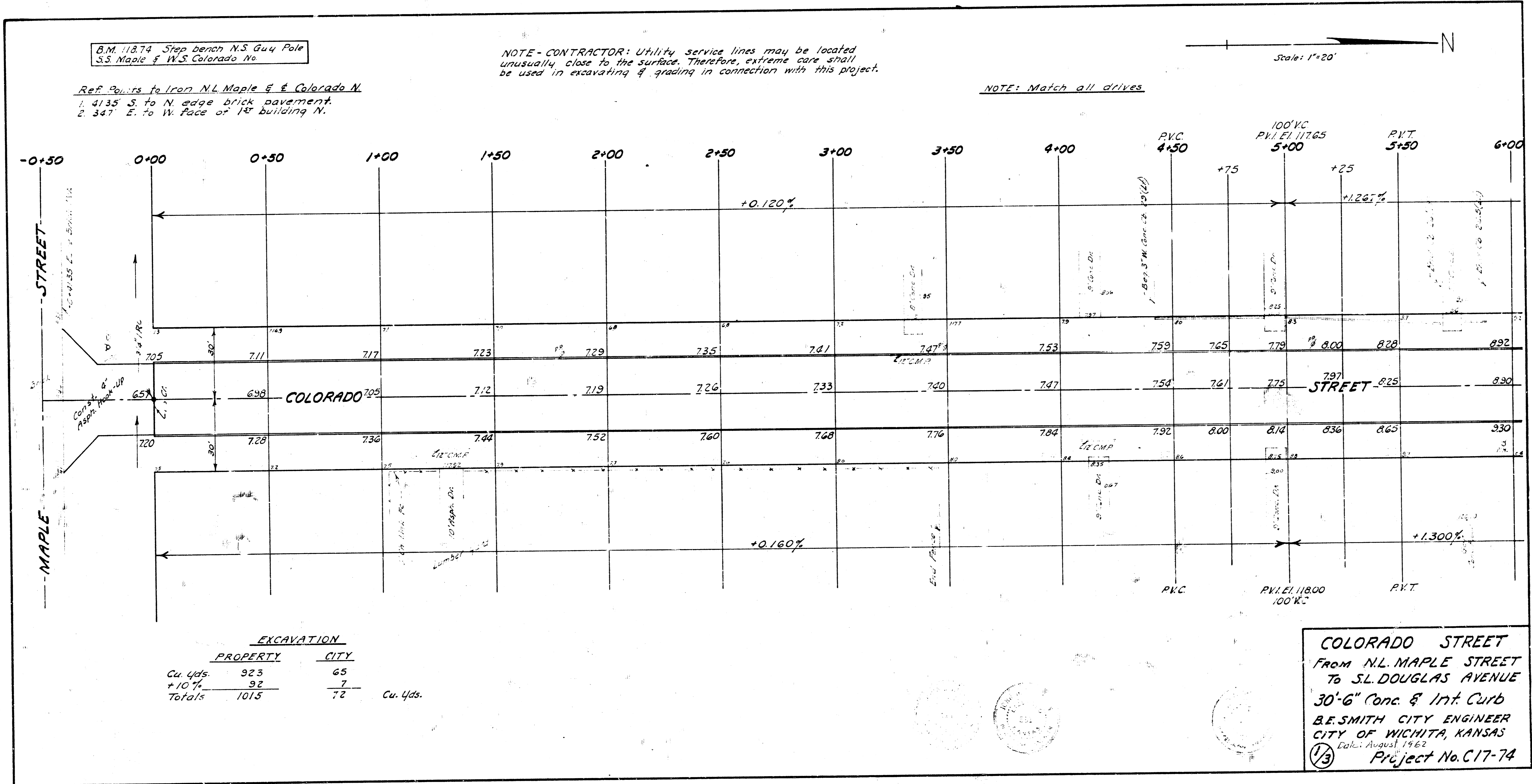

EXCAVATION		
PROPERTY	CITY	
Cu. Yds.	923	65
+10%	92	7
Totals	1015	72

Cu. Yds.

COLORADO STREET
FROM N.L. MAPLE STREET
TO S.L. DOUGLAS AVENUE
30'-6" Conc. & Int. Curb
B.E. SMITH CITY ENGINEER
CITY OF WICHITA, KANSAS
Date: August 1962
Project No. C17-74

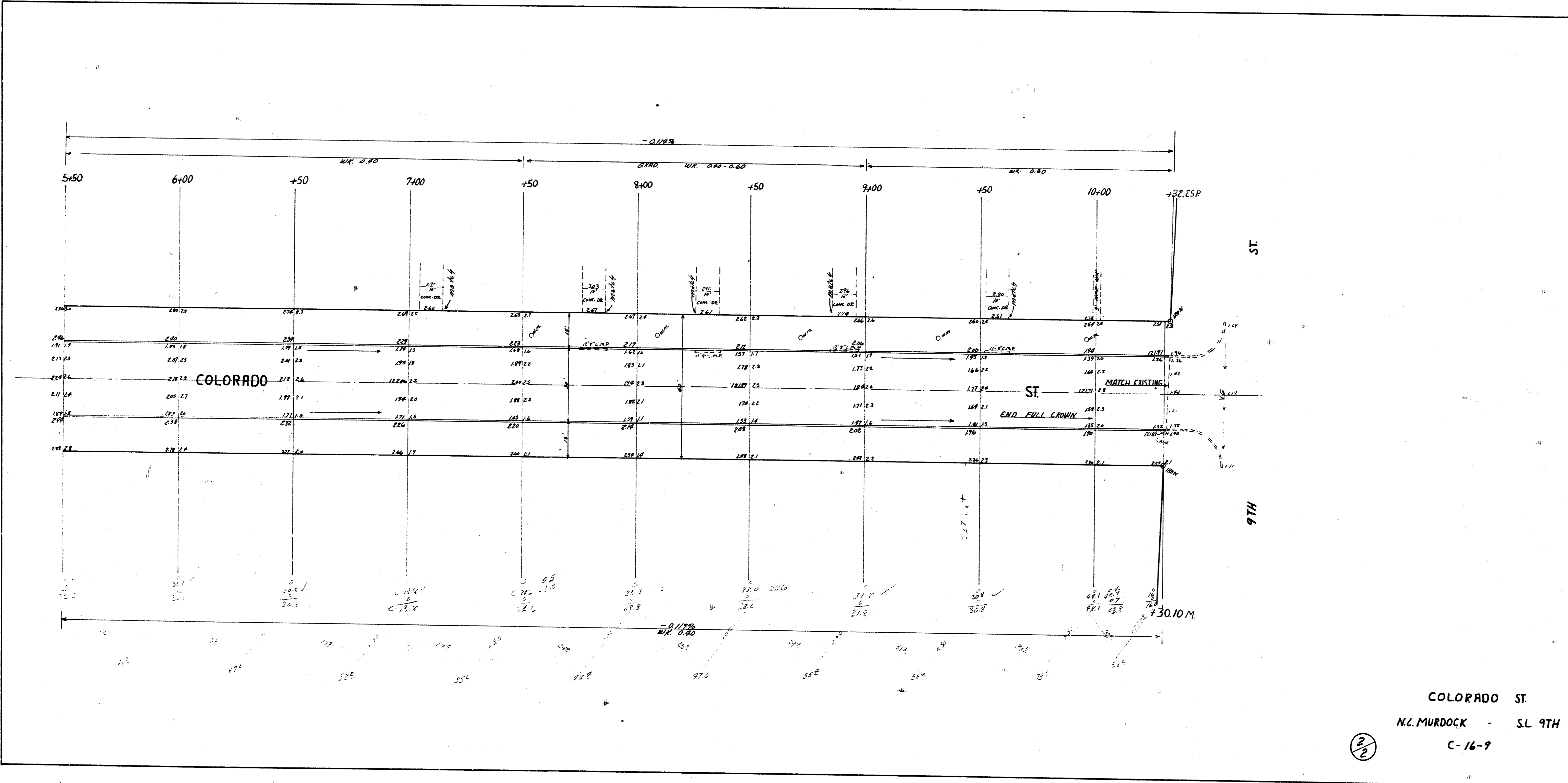

2/2

10 2 1 13