

Columbine Lane

E.L. Benjamin Hills Estates To S.L. Red Bud Lane

TYPICAL SECTIONS of 30' ASPHALTIC CONCRETE PAVEMENT

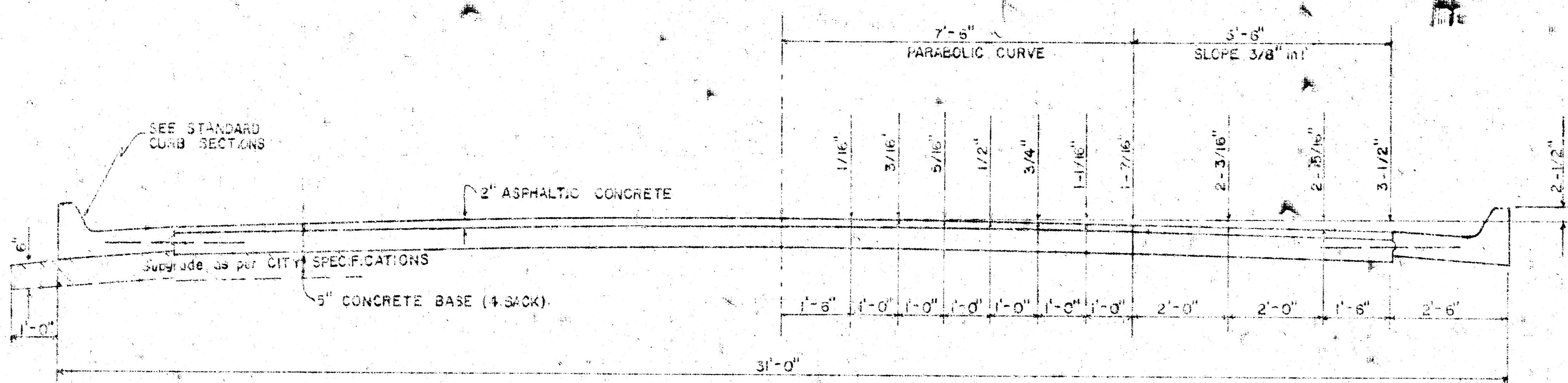

TYPICAL SECTION WITH STANDARD CROWN

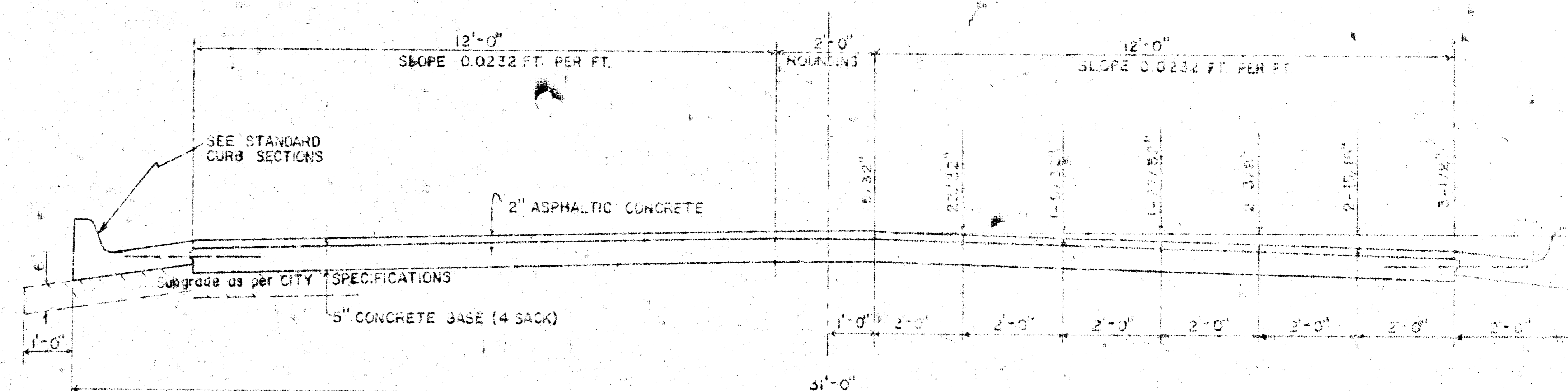

TYPICAL SECTION WITH ALTERNATE CROWN

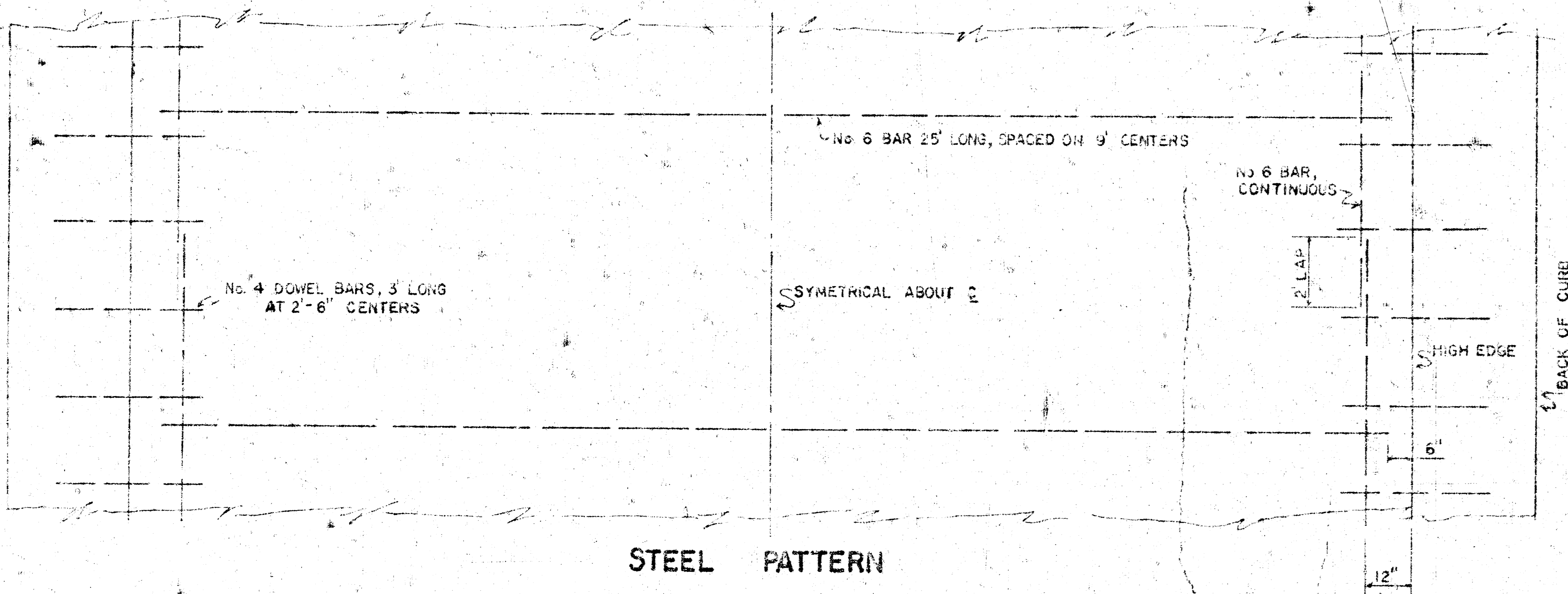

STEEL PATTERN

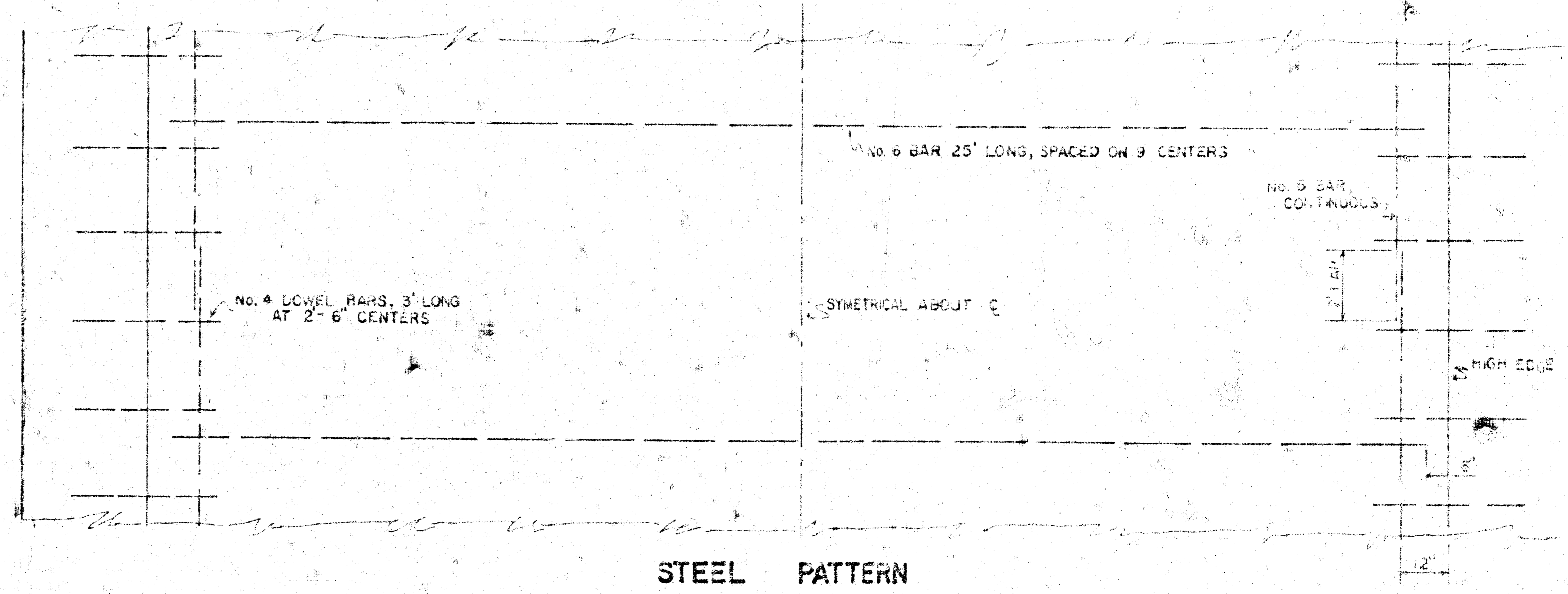

STEEL PATTERN

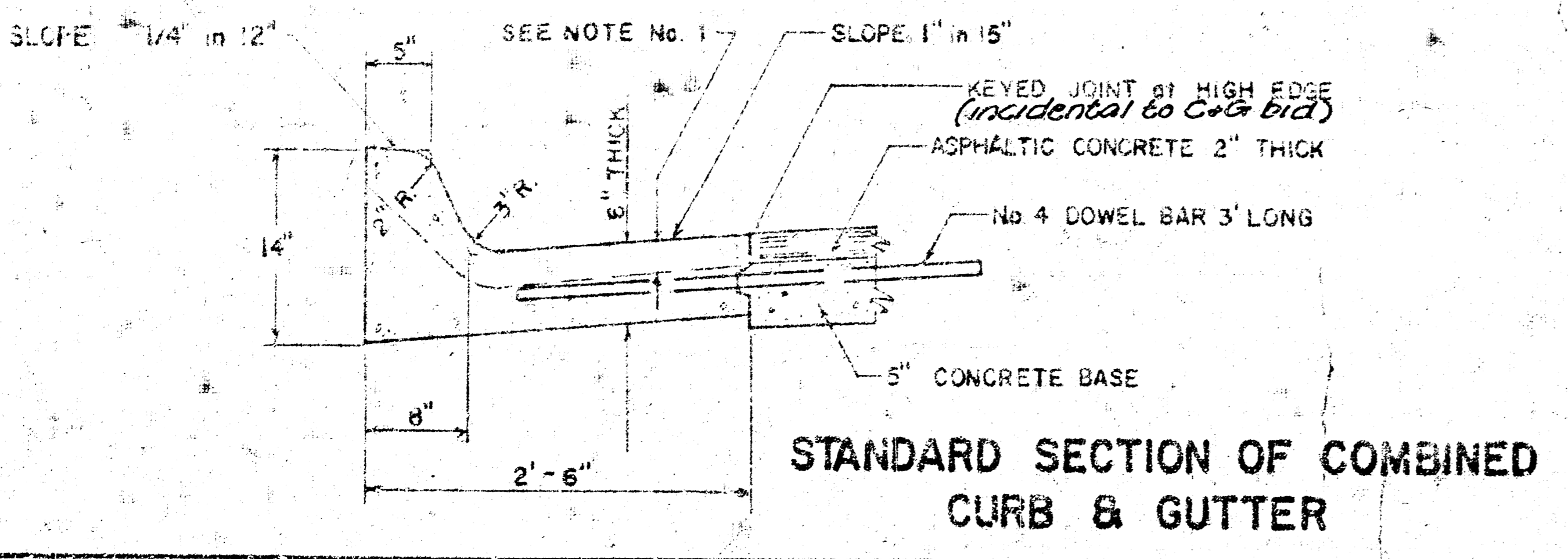

STANDARD SECTION OF COMBINED CURB & GUTTER

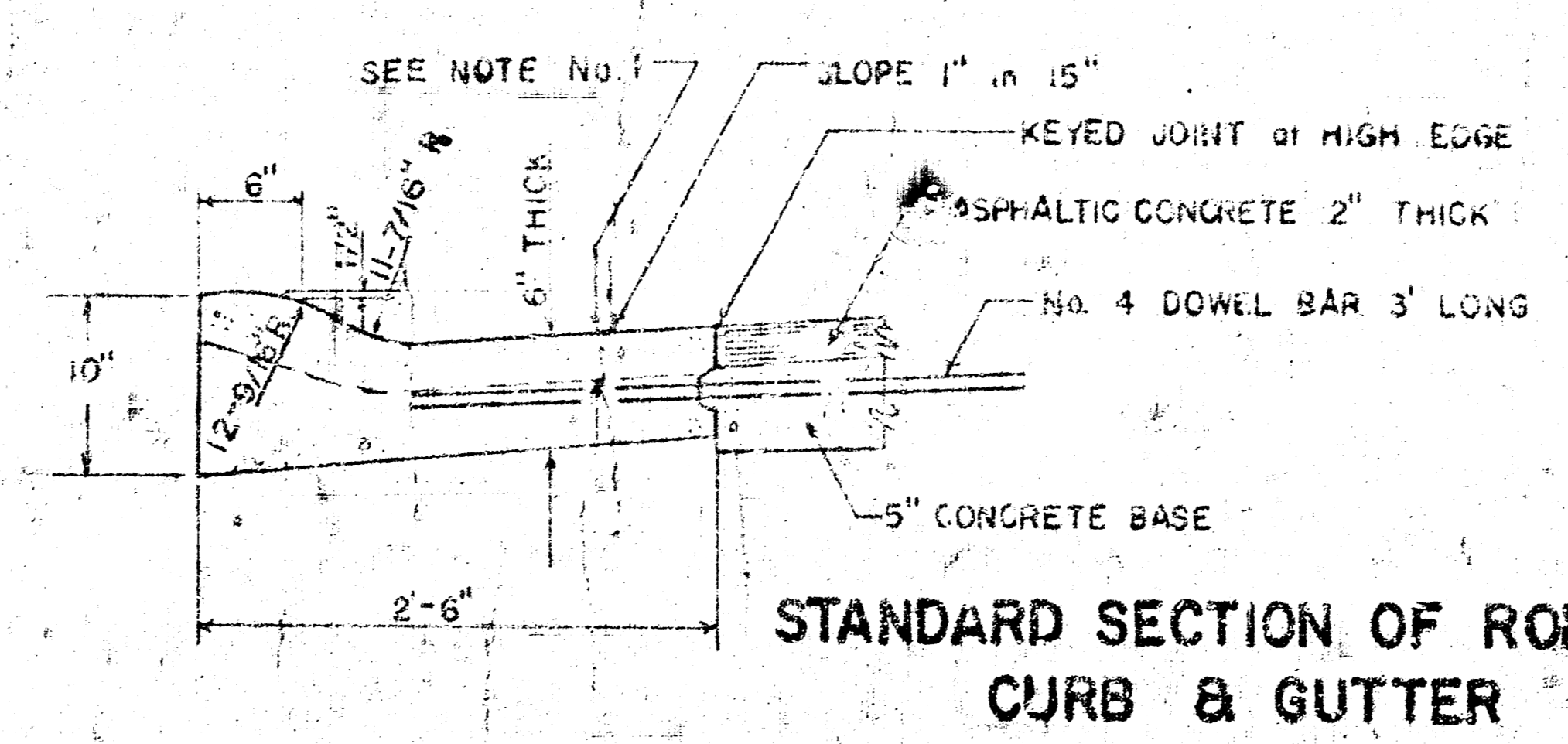

STANDARD SECTION OF ROLL-TYPE CURB & GUTTER

GENERAL NOTES

1. CONTRACTION JOINTS MAY BE CONSTRUCTED IN COMBINED CURB AND GUTTER BY SAWING WITH AN APPROVED CONCRETE SAW. THE SAW CUT SHALL EXTEND 2-1/2" BELOW THE SURFACE OF THE GUTTER AND CURB. SAWED CONTRACTION JOINTS SHALL HAVE A MAXIMUM SPACING OF 10' AND BE FILLED WITH A SPECIFIED JOINT FILLER, SUCH THAT THE JOINT IN THE GUTTER SECTION WILL BE COMPLETELY FILLED.



CITY OF WICHITA, KANSAS
 Department of Public Works - Engineering Division
 R.W. Linn City Engineer
 Date: _____ Project No. DAKS566
 Proj. No. 472 76 245 80015 000 000 001

BASELINE IS CTR. OF COLUMBINE LANE

B.M. 12865 City Std. SW Cor. Cardinal Drive & McLean Blvd.
 B.M. 12931 NE Cor. Cong. Porch House # 3045 COLUMBINE LANE
 B.M. 12964 SW Cor. Cong. Porch House # 2998 COLUMBINE LANE
 B.M. 12965 SE Cor. Cong. Porch House # 2824 COLUMBINE LANE

NO MORE THAN 15'-20' DRIVES ARE TO BE CONSTRUCTED ON THIS PROJECT

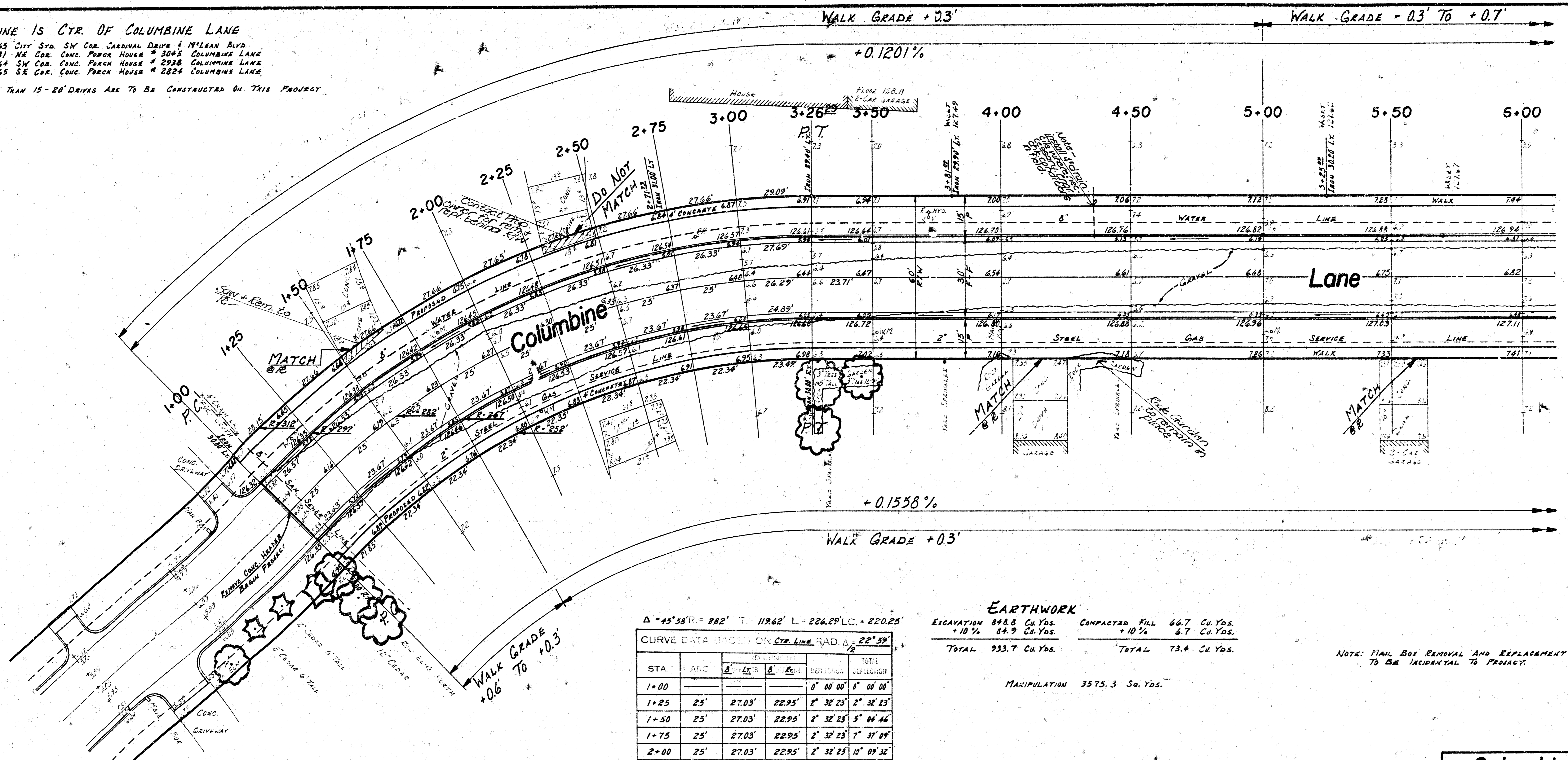

$\Delta = 45^{\circ}58' R = 282'$ T = 119.62' L = 226.29' LC = 220.25'

CURVE DATA BASED ON CTR. LINE RAD. $\Delta = 22^{\circ}59'$

STA.	ANG.	CHORD	CHORD	DEFLECTION	TOTAL DEFLECTION
1+00				0° 00' 00"	0° 00' 00"
1+25	25'	27.03'	22.95'	2° 32' 23"	2° 32' 23"
1+50	25'	27.03'	22.95'	2° 32' 23"	5° 04' 46"
1+75	25'	27.03'	22.95'	2° 32' 23"	7° 37' 09"
2+00	25'	27.03'	22.95'	2° 32' 23"	10° 09' 32"
2+25	25'	27.03'	22.95'	2° 32' 23"	12° 41' 55"
2+50	25'	27.03'	22.95'	2° 32' 23"	15° 14' 18"
2+75	25'	27.03'	22.95'	2° 32' 23"	17° 46' 41"
3+00	25'	27.03'	22.95'	2° 32' 23"	20° 19' 04"
3+26.22	26.29'	28.42'	24.14'	2° 40' 14"	22° 59' 18"

DEFL./FT. = 6.095295693 MIN.

EARTHWORK
 EXCAVATION 848.8 Cu. Yds. COMPACTED FILL 66.7 Cu. Yds.
 +10% 84.9 Cu. Yds. +10% 6.7 Cu. Yds.
 TOTAL 933.7 Cu. Yds. TOTAL 73.4 Cu. Yds.
 MANIPULATION 3575.3 Sq. Yds.

NOTE: MANHOLE REMOVAL AND REPLACEMENT TO BE INCIDENTAL TO PROJECT.

SUB-GRADE
 TYPE OF SUB-GRADE TO BE USED SHALL BE DETERMINED BY THE FIELD ENGINEER. TRADE TRENCHES SHALL BE CONSTRUCTED TO MEET CITY OF WICHITA, KANSAS SPECIFICATIONS.

NOTE TO FIELD ENGINEER & CONTRACTOR
 Grade, paving and clear-right-of-way for proposed sidewalk. Co. position is shown on plan. TO BE CONSTRUCTED BY OTHERS.

Columbine Lane
 E.L. Benjamin Hills Estate
 To S.L. Red Bud Lane
 Asphaltic Concrete Pavement
 30' F-F With Comb. Cb. & S.
 City Of Wichita, Kansas
 R. W. Linn City Engineer
 Proj. No. 472 76 245 80015 000
 Proj. No. DAKS566051 Date:

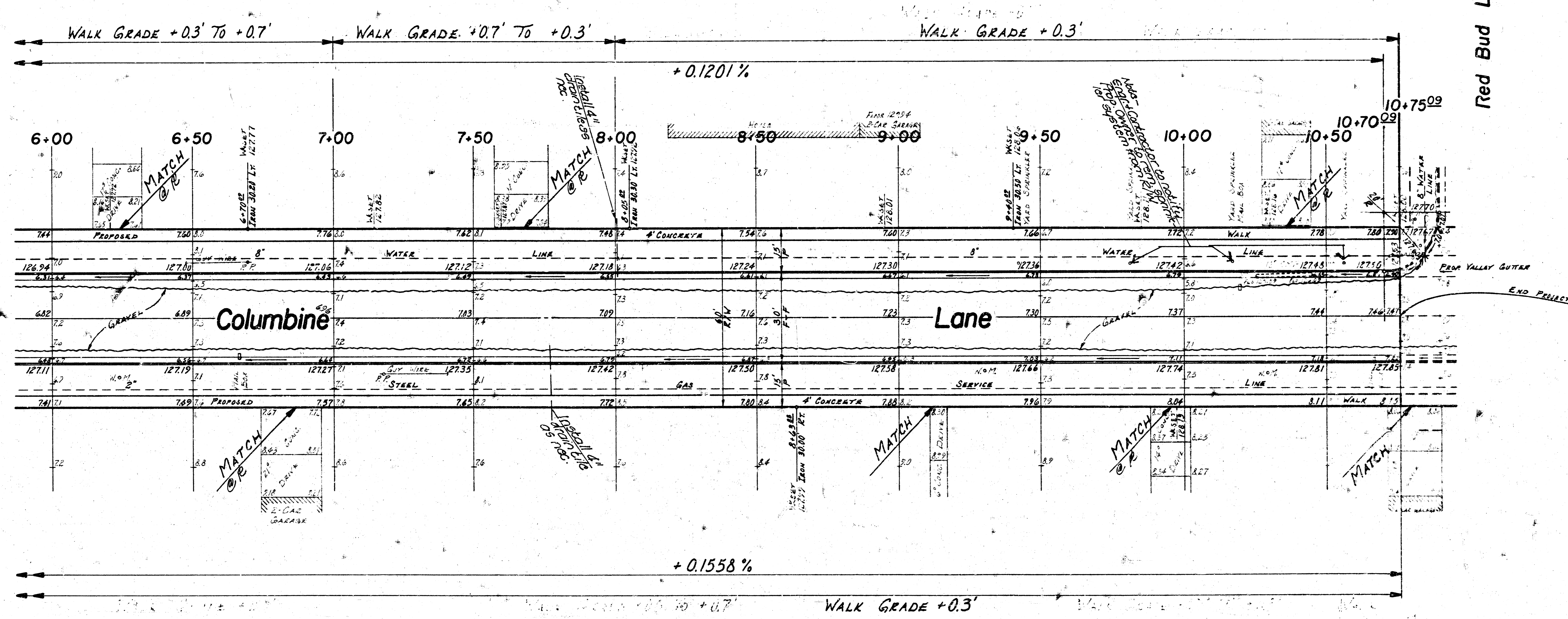

Red Bud Lane

Columbine Lane
 E.L. Benjamin Hills Estates
 To S.L. Red Bud Lane
 Asphaltic Concrete Pavement
 30' F-F With Comb. Cb. &
 City Of Wichita, Kansas
 R. W. Linn City Engineer
 Proj. No. 472 76 245 60015 000 000
 Proj. No. DAKS566051 Date: _____ Sht. 3