

Columbine Lane

S.L. Red Bud Lane To S.L. 25th St. N.

TYPICAL SECTIONS of 30' ASPHALTIC CONCRETE PAVEMENT

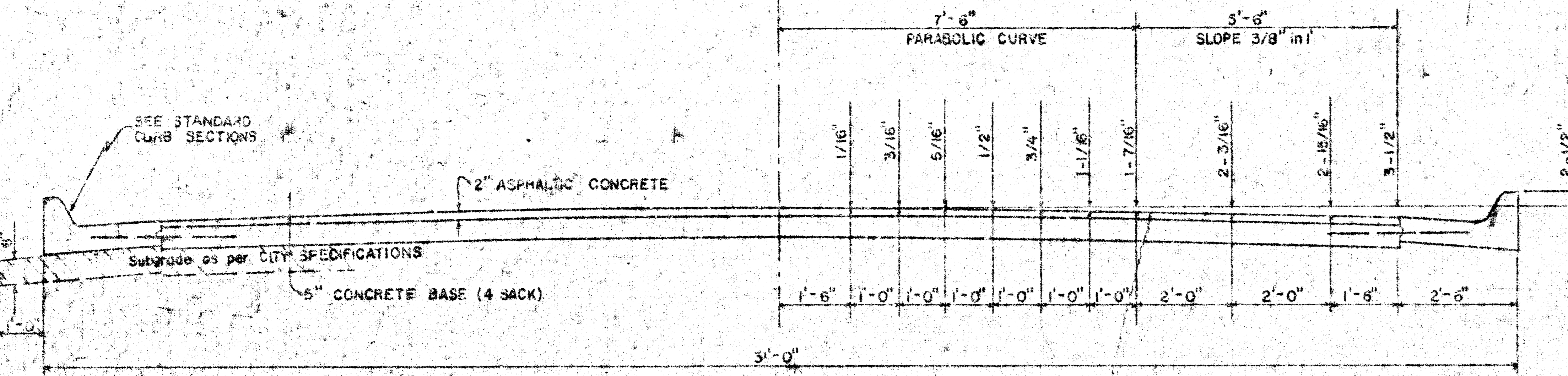

TYPICAL SECTION WITH STANDARD CROWN

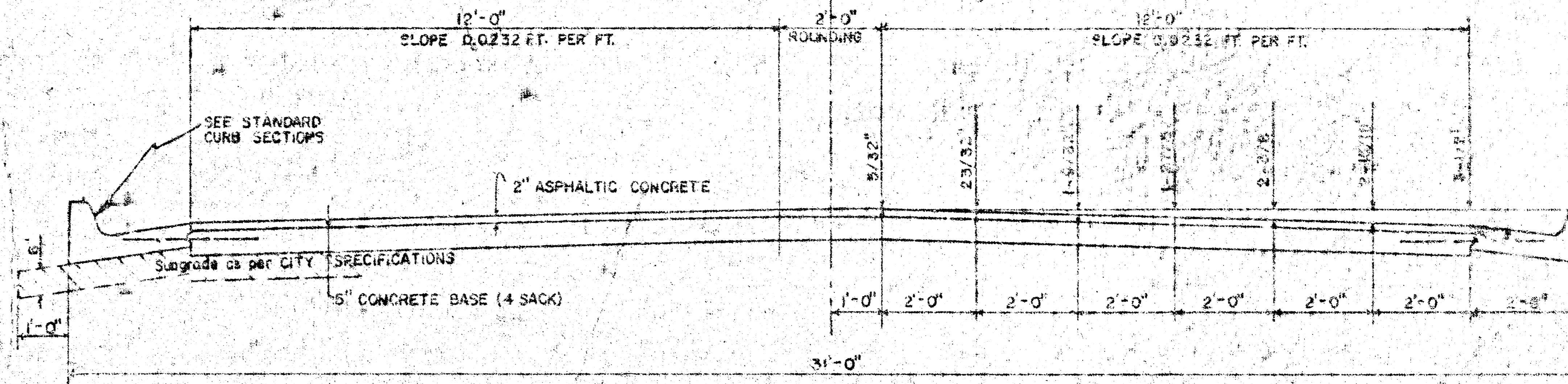

TYPICAL SECTION WITH ALTERNATE CROWN

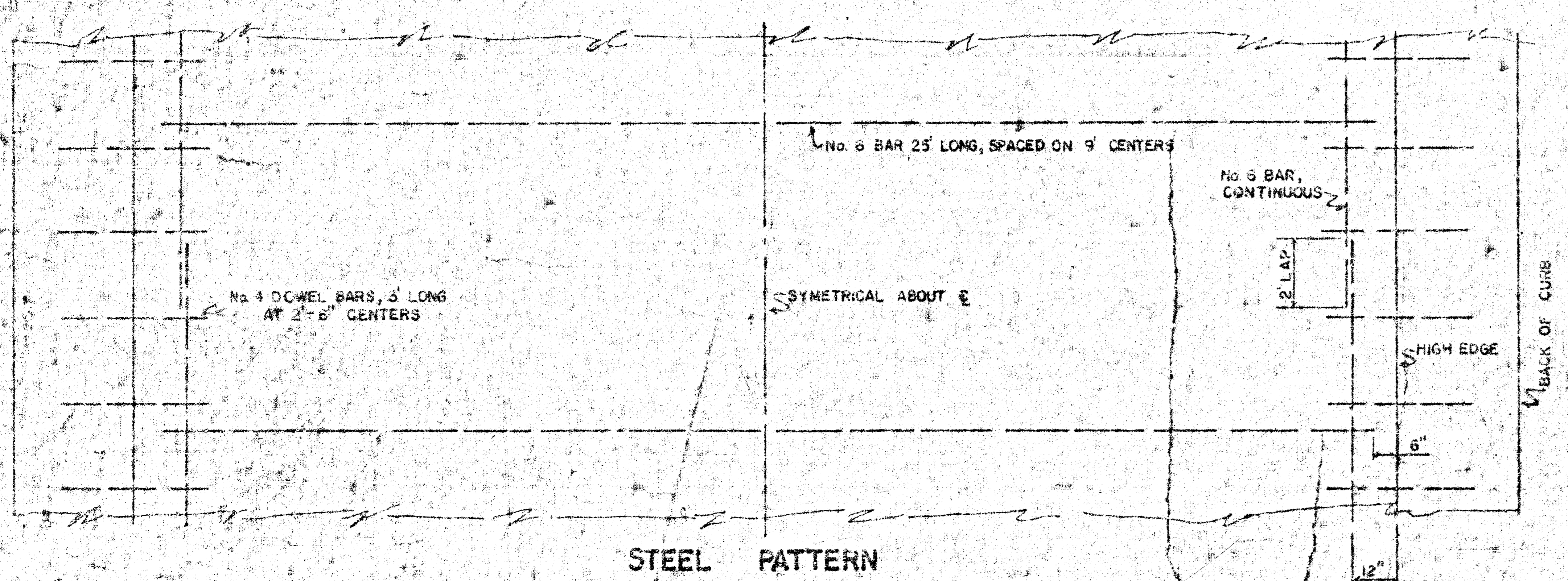

STEEL PATTERN

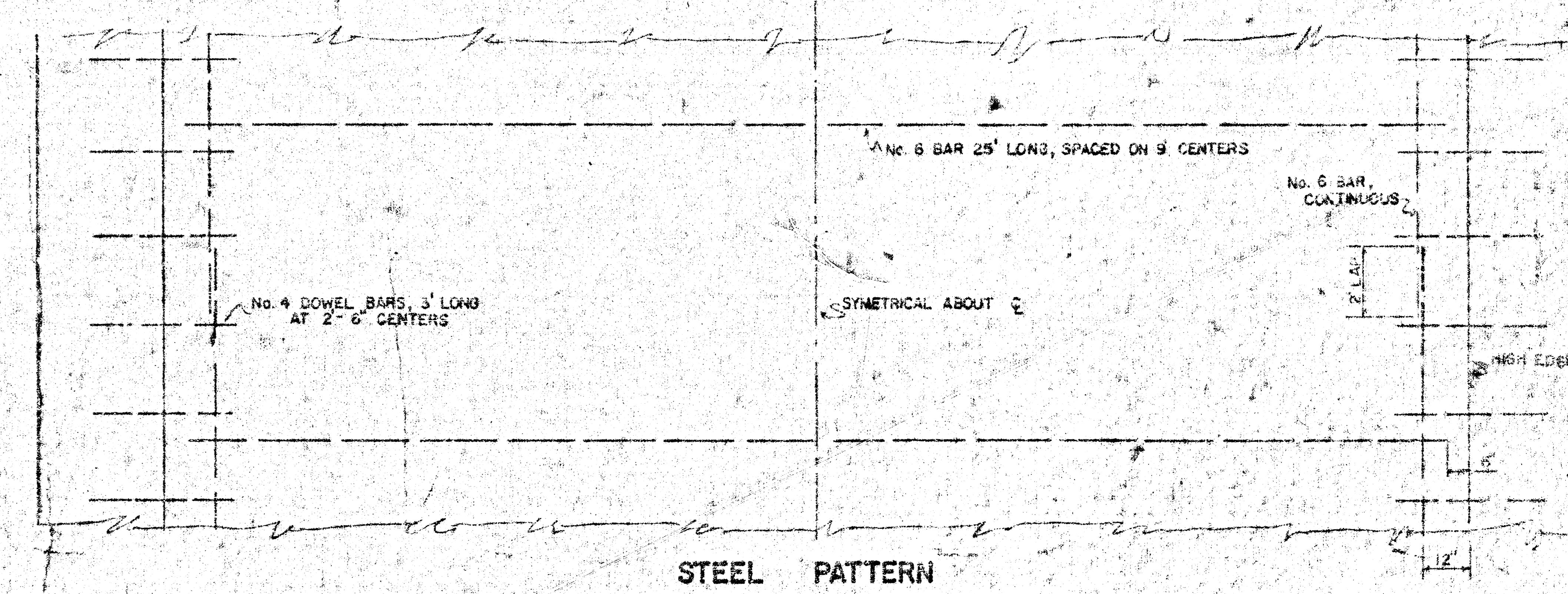

STEEL PATTERN

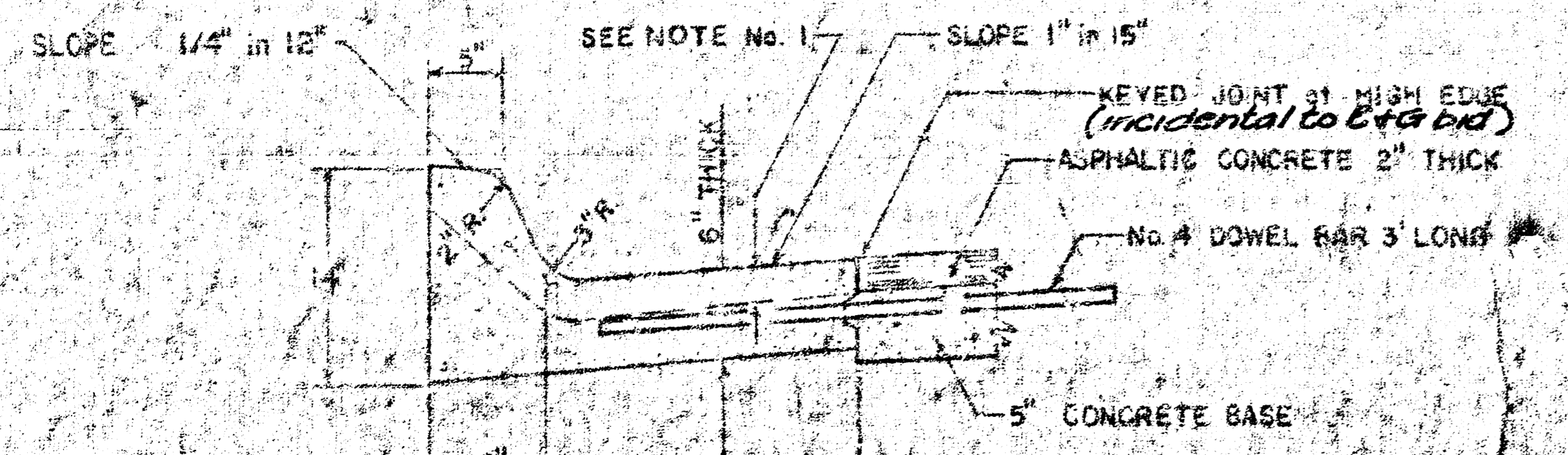

STANDARD SECTION OF COMBINED CURB & GUTTER

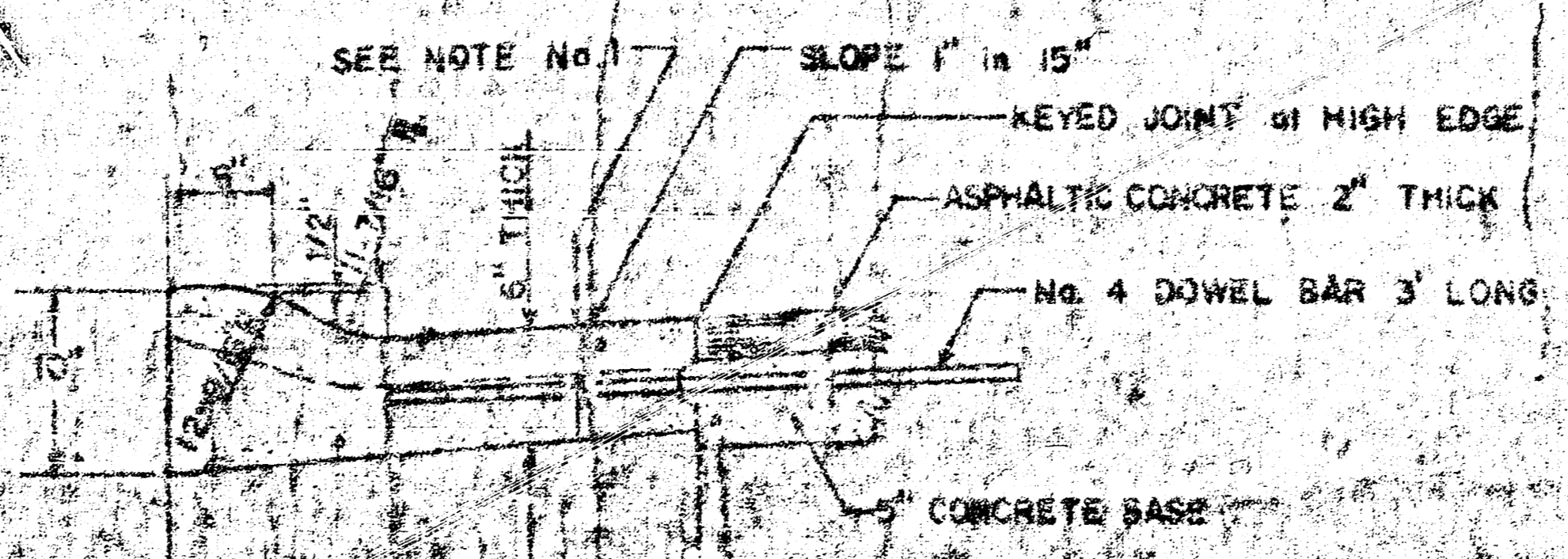

STANDARD SECTION OF ROLL-TYPE CURB & GUTTER

GENERAL NOTES
 1. CONTRACTION JOINTS MAY BE CONSTRUCTED IN COMBINED CURB AND GUTTER BY SAWING WITH AN APPROVED CONCRETE SAW. THE SAW CUT SHALL EXTEND 2-1/2" BELOW THE SURFACE OF THE GUTTER AND CURB. SAWED CONTRACTION JOINTS SHALL HAVE A MAXIMUM SPACING OF 10' AND BE FILLED WITH A SPECIFIED JOINT FILLER, SUCH THAT THE JOINT IN THE GUTTER SECTION WILL BE COMPLETELY FILLED.



CITY OF WICHITA, KANSAS
 Department of Public Works - Engineering Division
 R.W. Linn City Engineer
 Date: _____ Project No. SAKS 56
 Proj. No. 472 76 245 80016 000 000 0

BASELINE IS CTR. OF COLUMBINE LANE

B.M. 128.65 CITY STD. SW COR. CARDINAL DRIVE & McLEAN BLVD.
 B.M. 129.31 NE COR. CONC. PORCH HOUSE # 3045 COLUMBINE LANE
 B.M. 129.64 SW COR. CONC. PORCH HOUSE # 2938 COLUMBINE LANE
 B.M. 129.65 SE COR. CONC. PORCH HOUSE # 2824 COLUMBINE LANE

NO MORE THAN 8-20' DRIVAYS ARE TO BE CONSTRUCTED ON THIS PROJECT

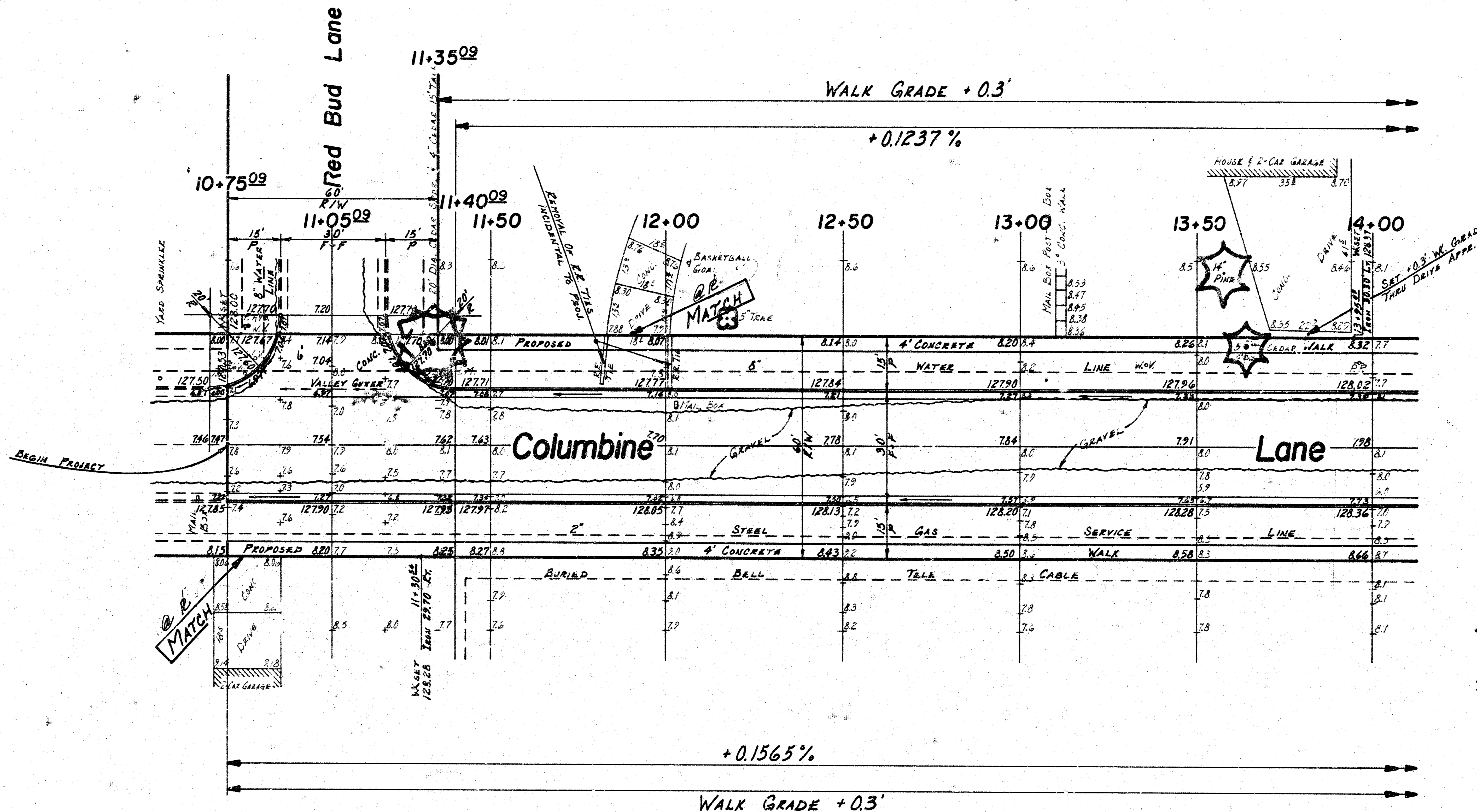
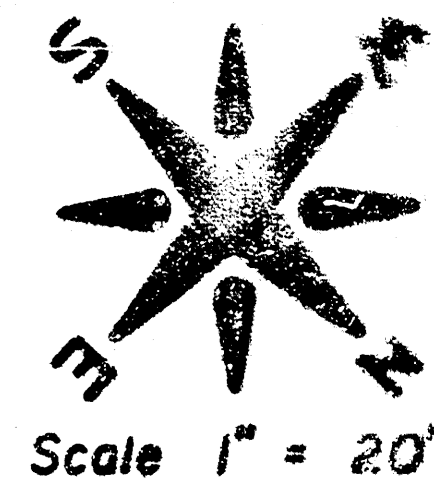

NOTE: TREES MARKED THUS ARE TO BE REMOVED EXCEPT THOSE ANY TREE MARKED FOR REMOVAL WHICH IN THE OPINION OF THE ENGINEER CAN BE SAVED, SHALL BE SAVED.

NOTE: MAIL BOX REMOVAL AND REPLACEMENT TO BE INCIDENTAL TO PROJECT.

CAUTION
UNDERGROUND UTILITIES
 Please check with K G & E or Southwestern Bell Telephone Co. for Location

EARTHWORK PROPERTY		EARTHWORK CITY	
EXCAVATION	497.3 Cu. Yds.	EXCAVATION	56.8 Cu. Yds.
+ 10%	49.7 Cu. Yds.	+ 10%	5.7 Cu. Yds.
TOTAL	547.0 Cu. Yds.	TOTAL	62.5 Cu. Yds.
COMPACTED FILL	44.5 Cu. Yds.	COMPACTED FILL	0.6 Cu. Yds.
+ 10%	4.5 Cu. Yds.	+ 10%	0.1 Cu. Yds.
TOTAL	49.0 Cu. Yds.	TOTAL	0.7 Cu. Yds.

MANIPULATION 2353.2 Sq. Yds.

SUB-GRADE
 TYPE OF SUB-GRADE TREATMENT SHALL BE DETERMINED BY THE FIELD ENGINEER. SUB-GRADE TREATMENT MAY CONSIST OF LIME TREATMENT, CEMENT TREATMENT, SUB-GRADE MODIFICATION, OR ANY COMBINATION OF THESE.

NOTE TO FIELD ENGINEER & CONTRACTOR:
 -Grade posting and clear right-of-way for proposed sidewalk. Compact fill in sidewalk area to be constructed by others.

Columbine Lane
 S.L. Red Bud Lane To S
 25th St. N.
 Asphaltic Concrete Pavement
 30' F-F With Comb. Cb. & C
 City Of Wichita, Kansas
 R. W. Linn City Engineer
 Proj. No. 472 76 245 80016 000 000
 Proj. No. DAKS566052 Date: Sht 2

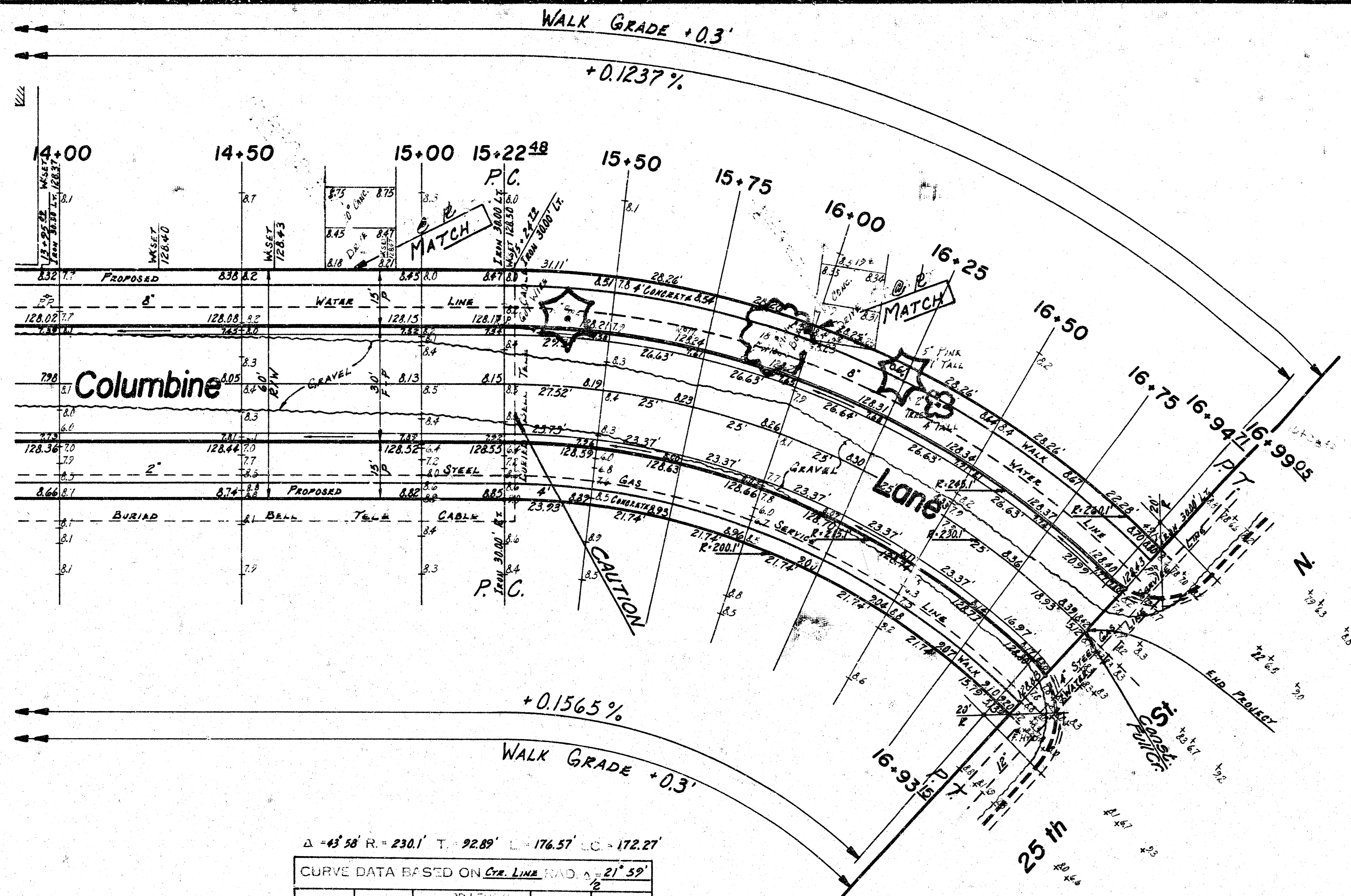
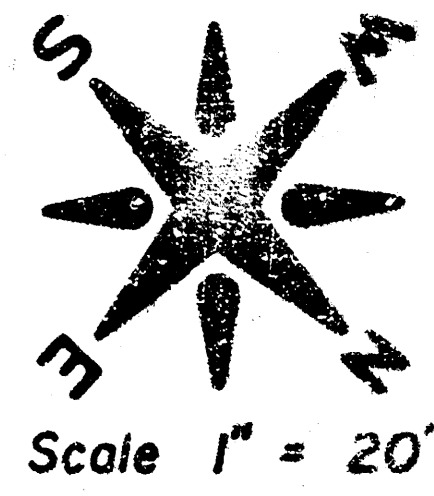

$\Delta = 45^{\circ} 58' R = 230.1' T = 92.89' L = 176.57' LC = 172.27'$

CURVE DATA BASED ON CUR. LINE (RAD. $\Delta = 21^{\circ} 59'$)

STA.	ARC	ORDINATE	CHORD	DEFLECTION	TOTAL DEFLECTION
15+22 ⁴⁸				0° 00' 00"	0° 00' 00"
15+50	27.52'	30.25'	24.75'	3° 25' 35"	3° 25' 35"
15+75	25'	27.49'	22.49'	3° 06' 45"	6° 32' 20"
16+00	25'	27.49'	22.49'	3° 06' 45"	9° 39' 05"
16+25	25'	27.49'	22.49'	3° 06' 45"	12° 45' 50"
16+50	25'	27.49'	22.49'	3° 06' 45"	15° 52' 35"
16+75	25'	27.49'	22.49'	3° 06' 45"	18° 59' 21"
16+93 ¹⁴	18.15'	19.96'	16.33'	2° 15' 34"	21° 14' 35"
16+94 ²²	1.56'	1.72'	1.40'	0° 11' 40"	21° 26' 35"
16+99 ⁹⁵	4.34'	4.77'	3.91'	0° 32' 25"	21° 59' 00"

DEFL./FT. = 7.470114669 MIN.

Columbine Lane
 S.L. Red Bud Lane To S.L.
 25th St. N.
 Asphaltic Concrete Pavement
 30' F-F With Comb. Ch. & Gr.
 City Of Wichita, Kansas
 R. W. Linn City Engineer
 Proj. No. 472 76 245 80016 000 000 001
 Proj. No. DAKS566052 Date: Sht. 3 of