

BM-13136 City Sid on NE Cor Armidan & 33rd St.
 BM-13134 R.R. Spike N. Side R. Pole on S. Side 33rd St. 15' E. of W.P.L. Coolidge N.
 BM-13139 R.R. Spike N. Side R. Pole on S.E. Cor. Coolidge & 34th St.

Base Line = W.P.L. Coolidge Avenue

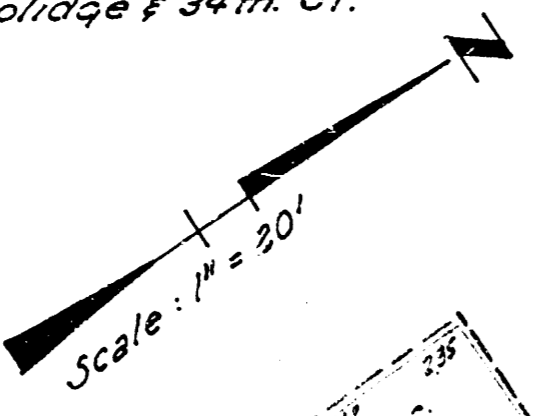

Surveyed by B. E. Smith
 Checked by J. E. Smith
 Date: 10/1/56

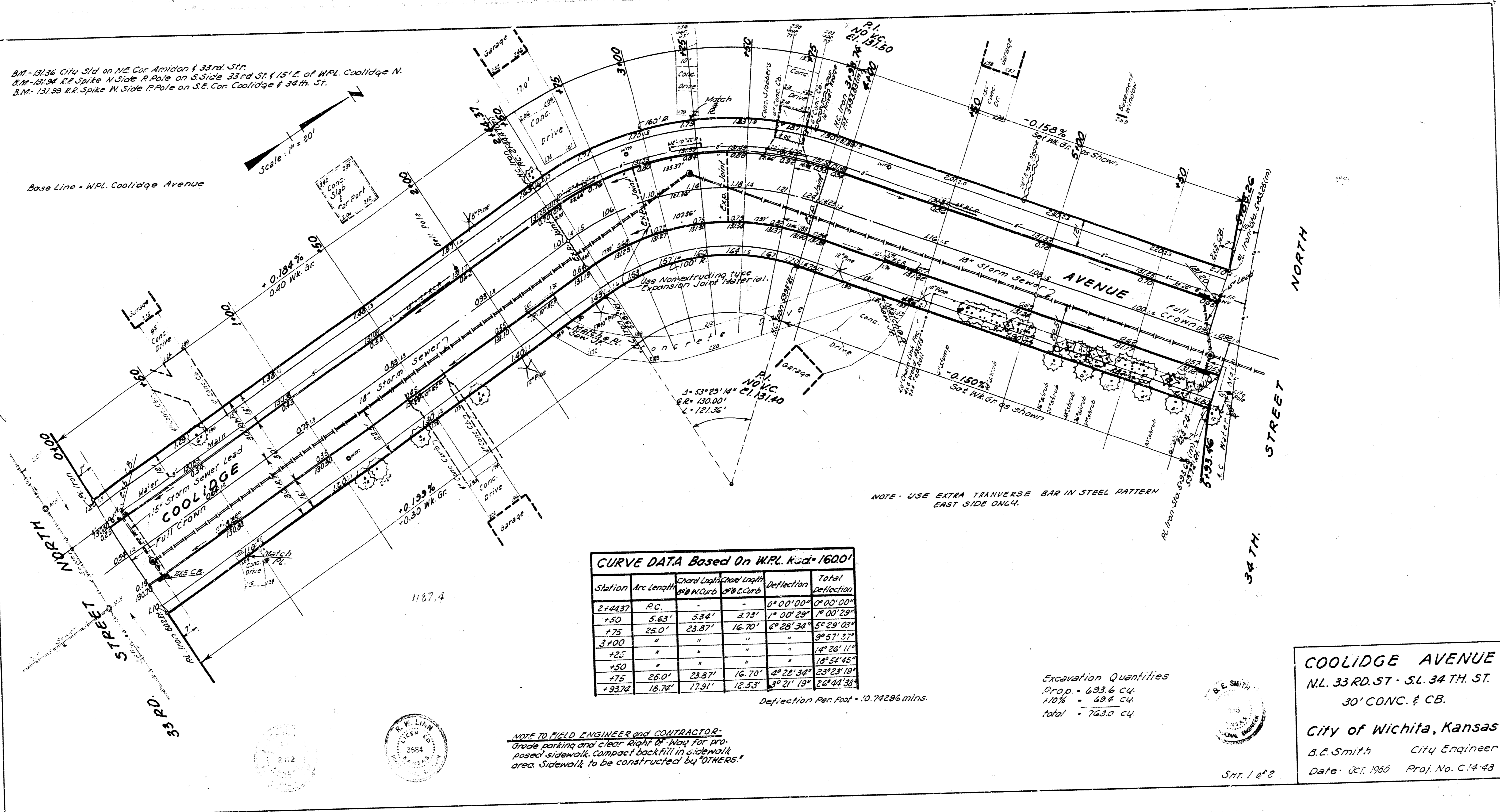

CURVE DATA Based On W.P.L. Rad = 1600'

Station	Arc Length	Chord Length	Chord Length	Deflection	Total
		# of W.C. Curbs	# of E. Curbs		Deflection
2+4437	P.C.	-	-	0° 00' 00"	0° 00' 00"
+30	5.63'	5.34'	3.73'	1° 00' 29"	1° 00' 29"
+75	25.0'	23.87'	16.70'	6° 28' 34"	5° 29' 03"
3+00	"	"	"	"	9° 57' 37"
+25	"	"	"	"	14° 26' 11"
+50	"	"	"	"	18° 54' 45"
+75	25.0'	23.87'	16.70'	4° 28' 34"	23° 23' 19"
+93.74	18.74'	17.91'	12.53'	3° 21' 19"	26° 44' 38"

Deflection Per Foot = 10.74286 mins.

Excavation Quantities
 Prop. = 693.6 cu.
 1.0% = 694.0 cu.
 Total = 763.3 cu.

NOTE TO FIELD ENGINEER and CONTRACTOR:
 Grade parking and clear Right of Way for proposed sidewalk. Compact backfill in sidewalk area. Sidewalk to be constructed by OTHERS.

COOLIDGE AVENUE
 NL. 33RD. ST - SL. 34 TH. ST.
 30' CONC. & C.B.

City of Wichita, Kansas
 B.E. Smith City Engineer
 Date: Oct. 1956 Proj. No. C-14-43

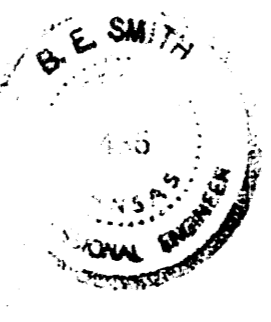

Shr. 1 of 2