

B.M. 12578 Top Bolt in S. Coping, SW Cor. 21st Bridge @ Little River  
Sta. on S.P.L.

**Note to Contractor and Field Eng.**

Remove all of apparent existing dump from approx. Sta. 3+50 to Sta. 4+67.  
Final cross-section to be made before back-filling is begun.

NOTE EXTRA STEEL  
BETWEEN BRIDGES  
4-1/2" EXTRA BARS EQUALLY SPACED  
18'-0" LONG

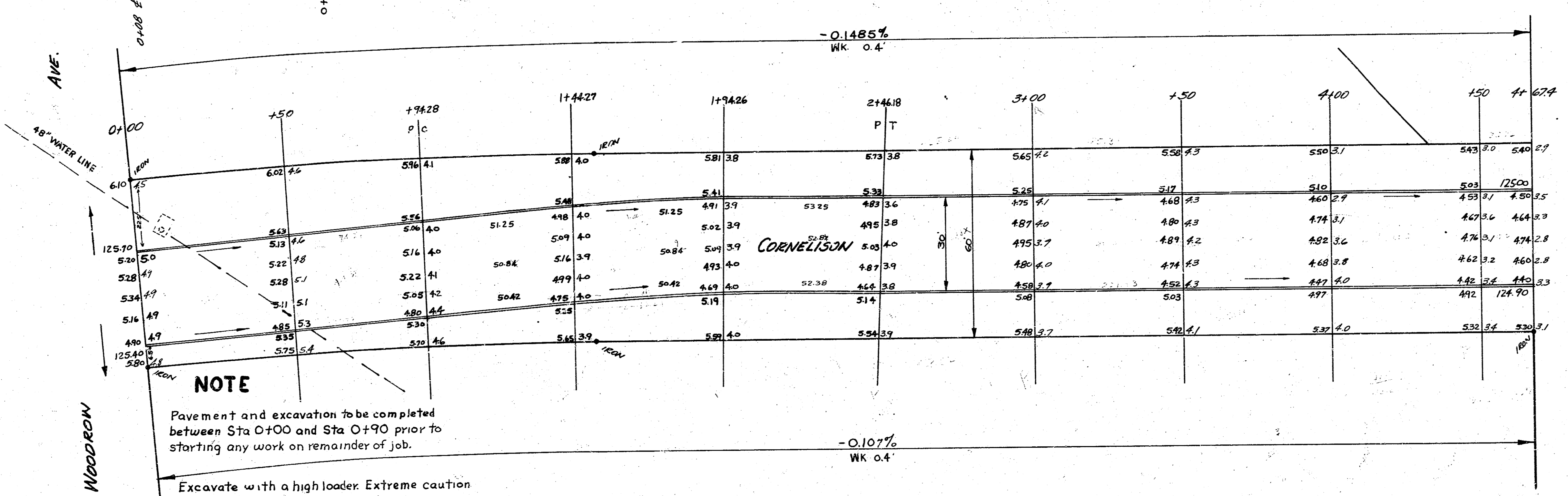
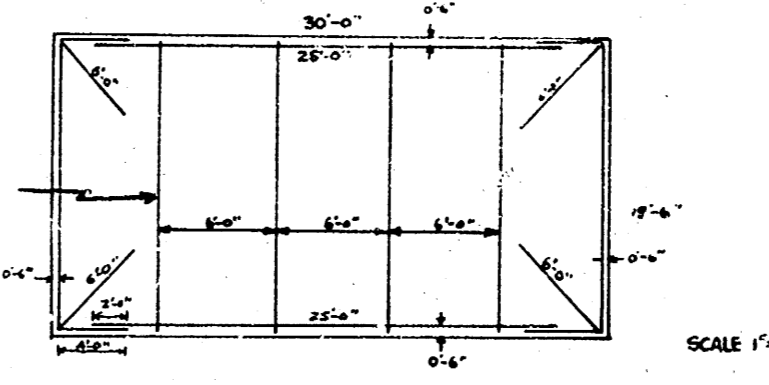

**NOTE**  
Pavement and excavation to be completed between Sta. 0+00 and Sta. 0+90 prior to starting any work on remainder of job.  
Excavate with a high loader. Extreme caution needed because 48" city water line is so near the ground surface.

Survey  
Checked  
Exc.  
Checked



CURVE DATA FOR 6' OFFSET N. CURB				
STA.	CHORD N. CURB	CHORD S. CURB	DEF. L	TOT. DEFL.
0+9428 P.C.	51.26	50.26	0° 47' 53"	0° 47' 53"
1+9426	51.26	50.26	0° 47' 53"	1° 35' 46"
2+4418 P.T.	53.25	52.21	0° 49' 45"	2° 25' 30"

CORNELISON  
E.L. WOODROW TO W.L. PORTER  
30' CONC. & CG.  
CITY OF WICHITA, KANSAS  
B.E. SMITH - CITY ENGINEER  
APRIL, 1954 PROJ. C13-224