

B.M. 113.484 Iron in Thimble Sen. & Central.

EXCAVATION

| |
|------------|
| 90 |
| PLUS 10% 9 |
| TOTAL 99 |

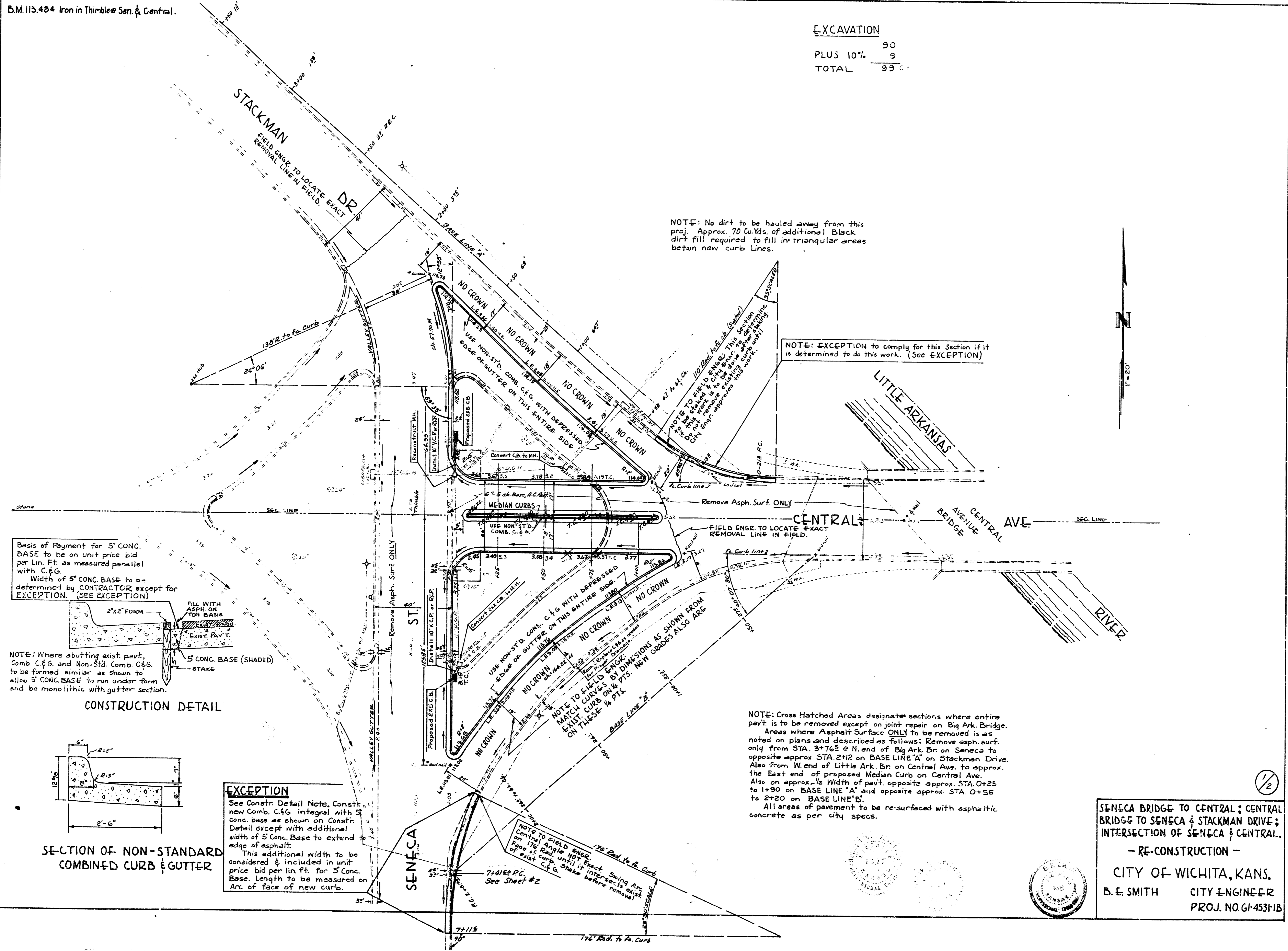

NOTE: No dirt to be hauled away from this proj. Approx. 70 Cu Yds. of additional Black dirt fill required to fill in triangular areas between new curb lines.

NOTE: EXCEPTION to comply for this section if it is determined to do this work. (See EXCEPTION)

Basis of Payment for 5" CONC. BASE to be on unit price bid per lin. Ft. as measured parallel with C.&G.
Width of 5" CONC. BASE to be determined by CONTRACTOR except for EXCEPTION. (SEE EXCEPTION)

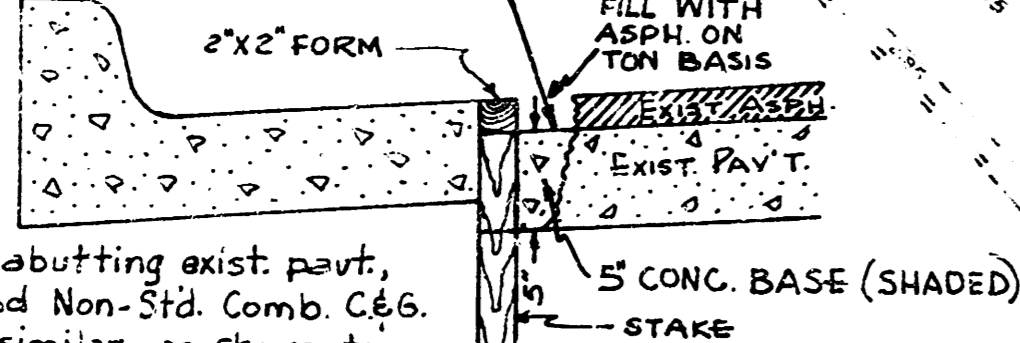

NOTE: Where abutting exist pavt, Comb. C.&G. and Non-Std. Comb. C.&G. to be formed similar as shown to allow 5" CONC. BASE to run under form and be monolithic with gutter section.

CONSTRUCTION DETAIL

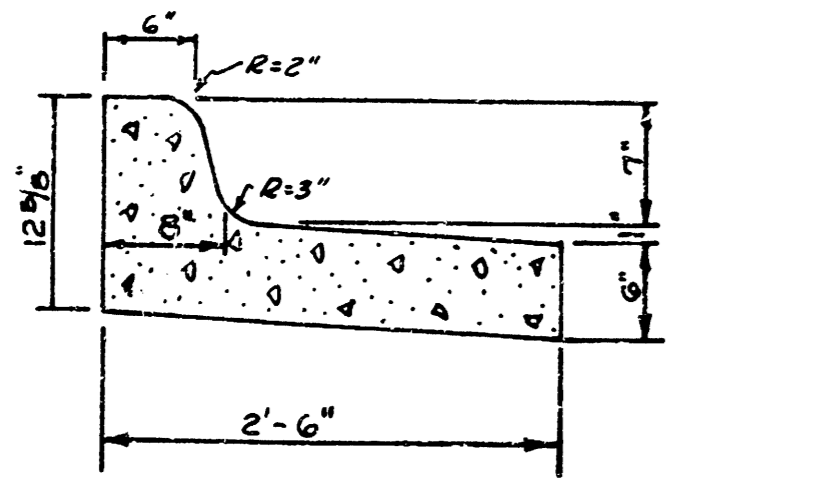

SECTION OF NON-STANDARD COMBINED CURB & GUTTER

EXCEPTION
See Constr. Detail Note, Constr. new Comb. C.&G. integral with 5" conc. base as shown on Constr. Detail except with additional width of 5" Conc. Base to extend to edge of asphalt.
This additional width to be considered & included in unit price bid per lin. ft. for 5" Conc. Base. Length to be measured on Arc. of face of new curb.

NOTE: Cross Hatched Areas designate sections where entire pavt. is to be removed except on joint repair on Big Ark. Bridge.
Areas where Asphalt Surface ONLY to be removed is as noted on plans and described as follows: Remove asph. surf. only from STA. 3+76E @ N. end of Big Ark. Br. on Seneca to opposite approx STA. 2+12 on BASE LINE 'A' on Stackman Drive. Also from W. end of Little Ark. Br. on Central Ave. to approx. the East end of proposed Median Curb on Central Ave.
Also on approx. 1/2 Width of pavt. opposite approx. STA. 0+25 to 1+80 on BASE LINE 'A' and opposite approx. STA. 0+55 to 2+20 on BASE LINE 'B'.
All areas of pavement to be re-surfaced with asphaltic concrete as per city specs.

SENeca BRIDGE TO CENTRAL; CENTRAL BRIDGE TO SENECA & STACKMAN DRIVE; INTERSECTION OF SENECA & CENTRAL.
- RE-CONSTRUCTION -
CITY OF WICHITA, KANS.
B. E. SMITH CITY ENGINEER
PROJ. NO. 61-4531-B

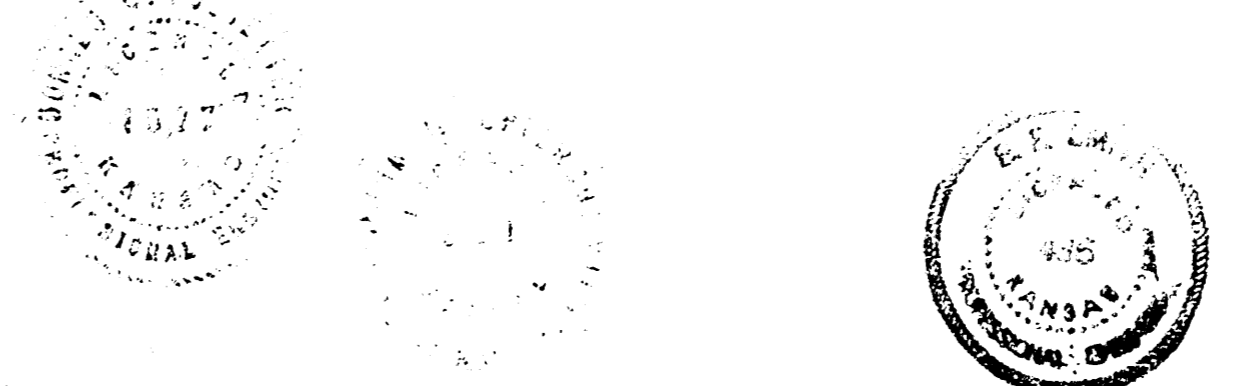

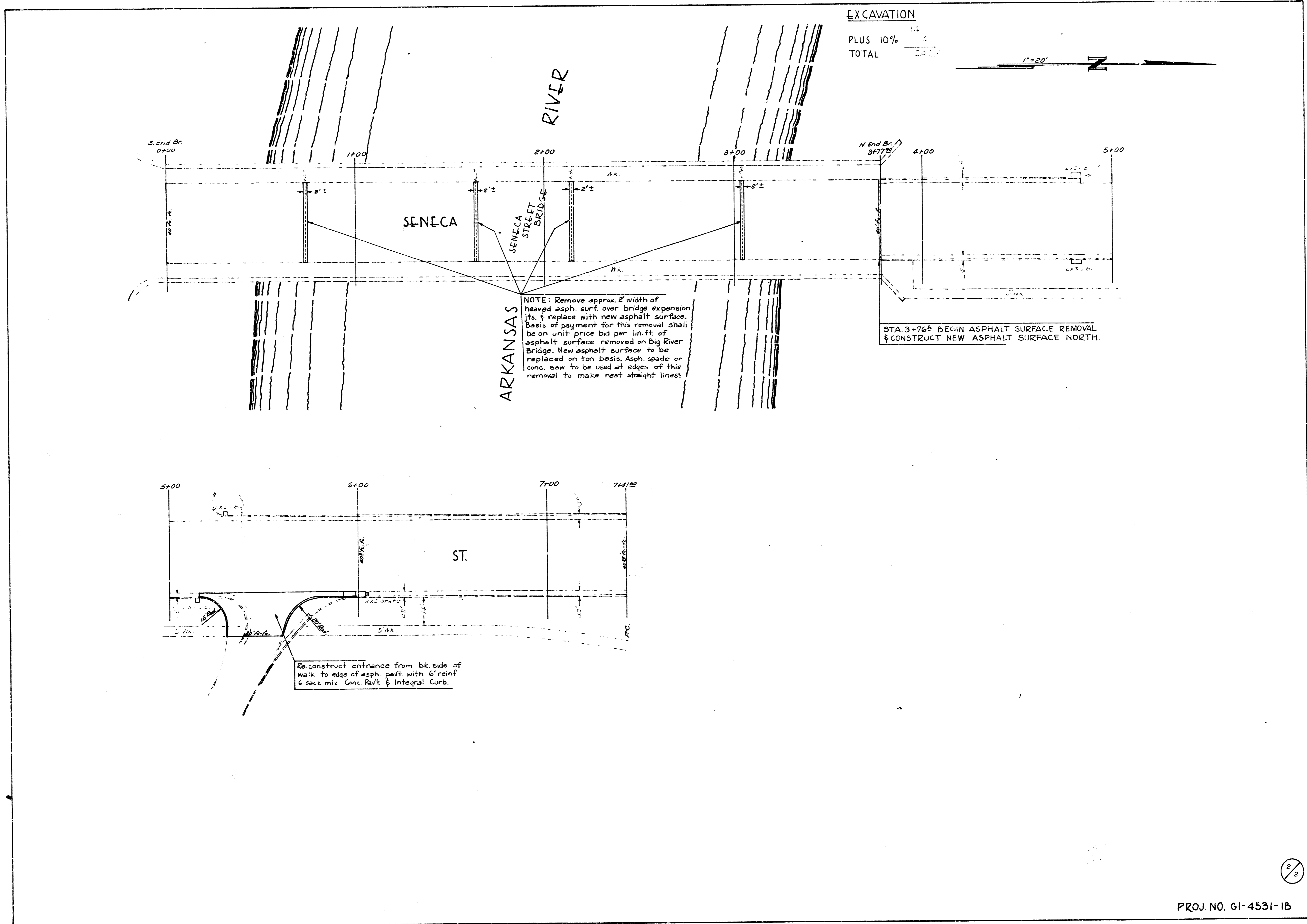

EXCAVATION

| | |
|----------|-------|
| PLUS 10% | 1.14 |
| TOTAL | 24.17 |

1"=20'

NOTE: Remove approx. 2' width of heaved asph. surf over bridge expansion jts. & replace with new asphalt surface. Basis of payment for this removal shall be on unit price bid per lin. ft. of asphalt surface removed on Big River Bridge. New asphalt surface to be replaced on ton basis. Asph. spade or conc. saw to be used at edges of this removal to make neat straight lines.

STA 3+76.5 BEGIN ASPHALT SURFACE REMOVAL & CONSTRUCT NEW ASPHALT SURFACE NORTH.

Reconstruct entrance from bl. side of walk to edge of asph. pav't with 6" reinf. & sack mix Cons. Pav't & Integral Curb.

CHM
DWH
1958

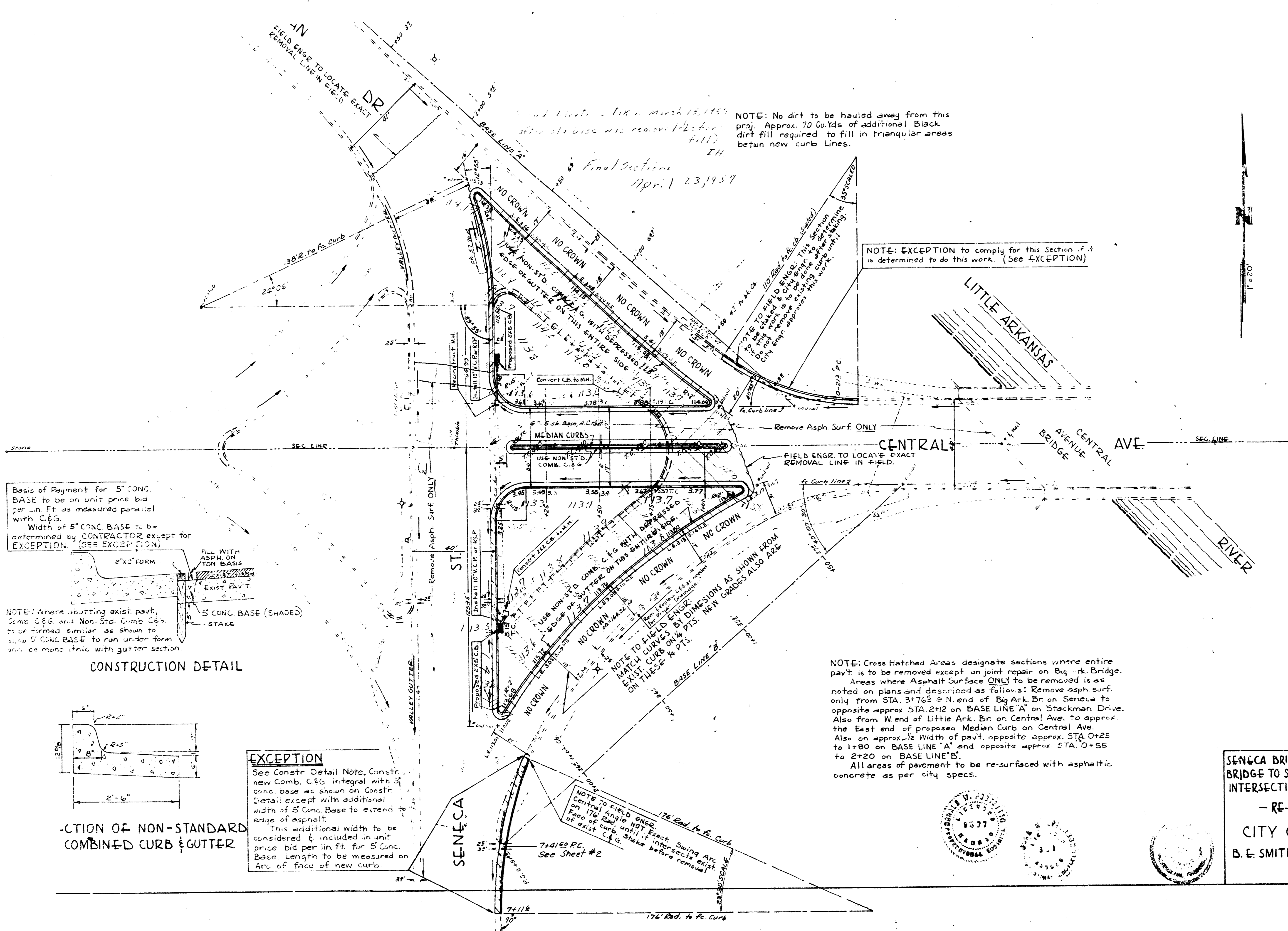

NOTE: No dirt to be hauled away from this project. Approx. 70 Cu.Yds. of additional Black dirt fill required to fill in triangular areas between new curb lines.

NOTE: EXCEPTION to comply for this section if it is determined to do this work. (See EXCEPTION)

Basis of Payment for 5" CONC. BASE to be on unit price bid per lin. Ft. as measured parallel with C.G.C.
Width of 5" CONC. BASE to be determined by CONTRACTOR, except for EXCEPTION.

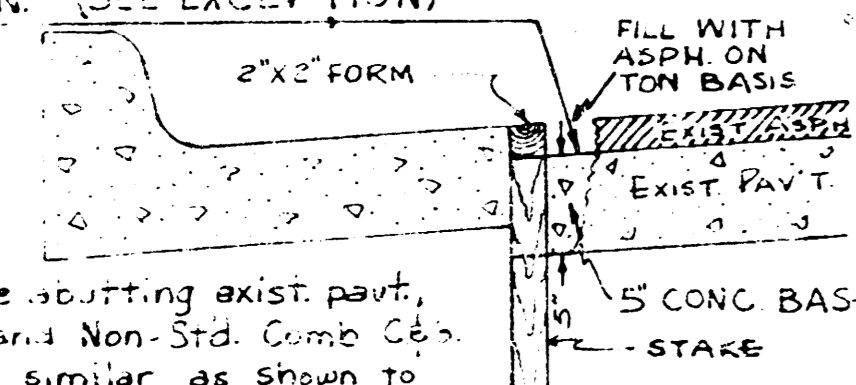

NOTE: Where abutting exist. pavt., same C.G.C. and Non-Std. Comb. C.G. to be formed similar as shown to use 5" CONC. BASE to run under form and be mono. with gutter section.

CONSTRUCTION DETAIL

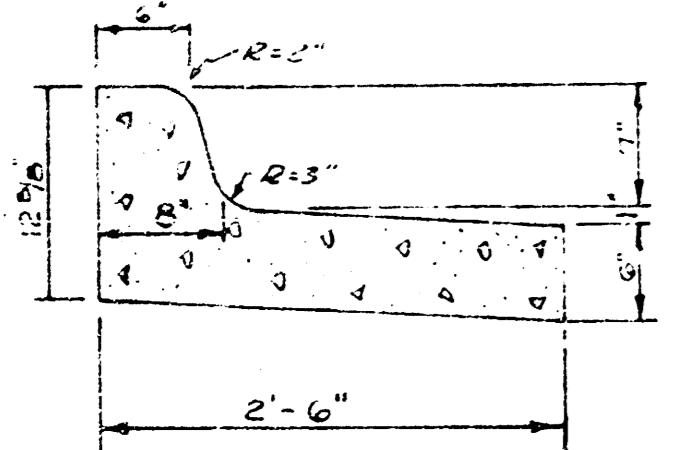

SECTION OF NON-STANDARD COMBINED CURB & GUTTER

EXCEPTION
See Constr. Detail Note, Constr. new Comb. C.G.C. integral with 5" conc. base as shown on Constr. Detail, except with additional width of 5" Conc. Base to extend to edge of asphalt.
This additional width to be considered & included in unit price bid per lin. Ft. for 5" Conc. Base. Length to be measured on Arc. of face of new curb.

NOTE: Cross Hatched Areas designate sections where entire pavt. is to be removed except on joint repair on Big Ark Bridge.
Areas where Asphalt Surface ONLY to be removed is as noted on plans and described as follows: Remove asphalt surf. only from STA. 3+76.8 to N. end of Big Ark Br. on Seneca to opposite approx. STA. 2+12 on BASE LINE 'A' on Stackman Drive. Also from W. end of Little Ark. Br. on Central Ave. to approx. the East end of proposed Median Curb on Central Ave.
Also on approx. 1/2 width of pavt. opposite approx. STA. 0+22 to 1+80 on BASE LINE 'A' and opposite approx. STA. 0+55 to 2+20 on BASE LINE 'B'.
All areas of pavement to be re-surfaced with asphaltic concrete as per city specs.

NOTE: TO FIELD ENGR. Central Ave. NOT to be removed on 176' Rad. to P.C. Curb. See Sheet #2

SENeca BRIDGE TO CENTRAL; CENTRAL BRIDGE TO SENeca & STACKMAN DRIVE; INTERSECTION OF SENeca & CENTRAL.
- RE-CONSTRUCTION -
CITY OF WICHITA, KANS.
B. E. SMITH CITY ENGINEER
PROJ. NO. 61-4531-B



1/2