

B. M. 158.44 Top Iron N.E. Cor. ELLEN & ESTELLE

NOTE:
STATIONING IS IN S.P.L.

N

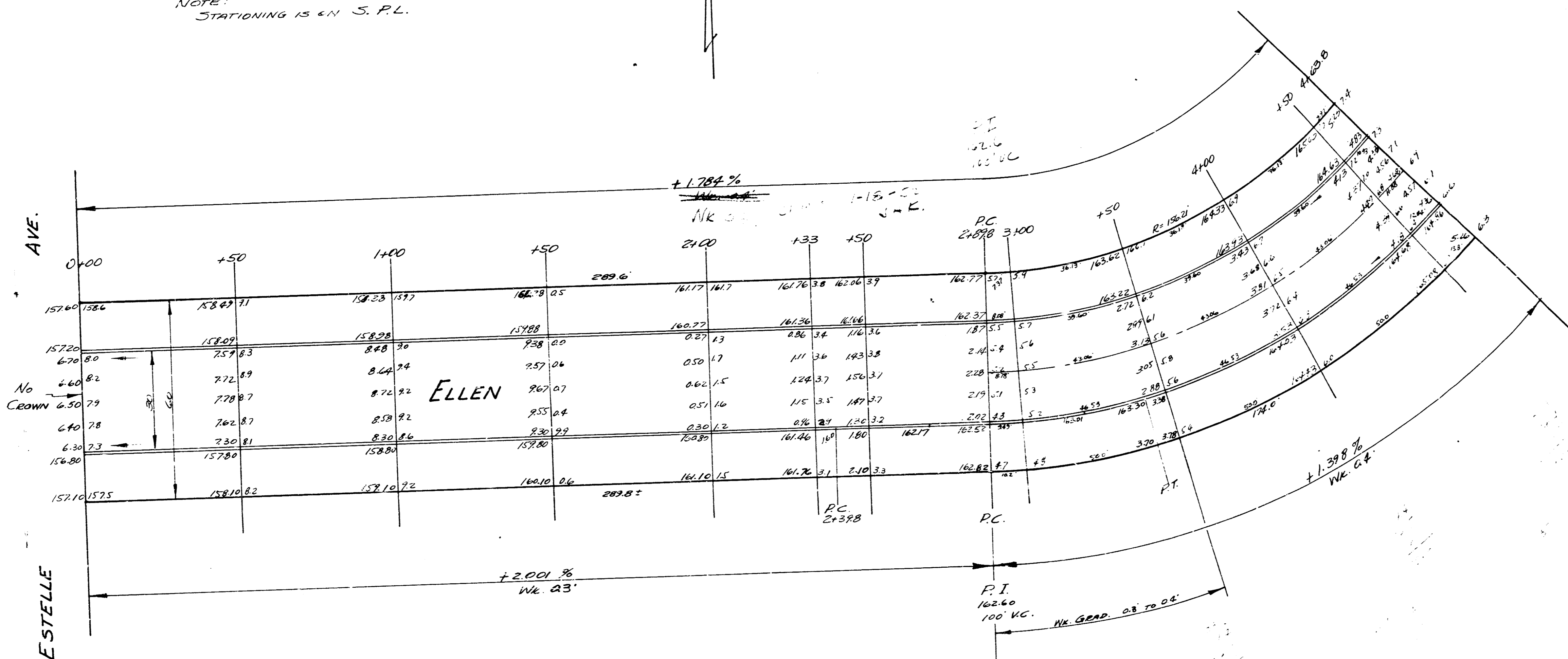

ELLEN
E.L. ESTELLE - E.L. LOT 15, BLK. N.
AUDREY MATLOCK'S HEIGHTS 1ST ADD.
30' CONC. & CO.
CITY OF WICHITA, KANSAS
L. K. WHITE CITY ENGINEER
SEPT. 1951 PROJ. C-11-92