

ELLIS AVENUE

N. L. Selma Ave. to the S. L. Ma-Arthur Rd.  
Proj. No. DAKS577071

B.M. = 86.27 City Std. Hydraulic & MacArthur 31' S. & 31' W. of Sec. Cor.  
 B.M. = 86.10 "□" on S. Cb. Median in Ctr. MacArthur, 6.5' E. of End of Rad. (10'± E. of E.L. Ellis)  
 B.M. = 89.47 N.E. Cor. Conc. Porch 1429 Selma (S.W. Cor. Ellis & Selma)  
 Baseline is Centerline Ellis

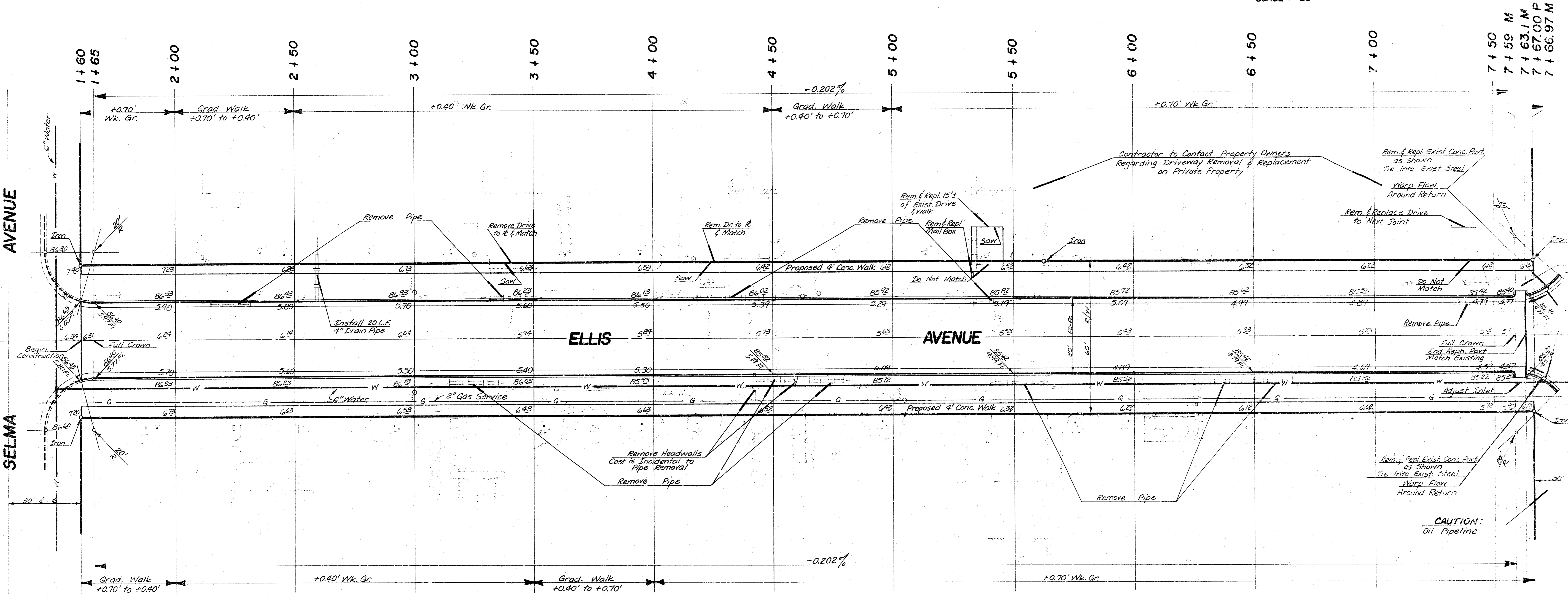
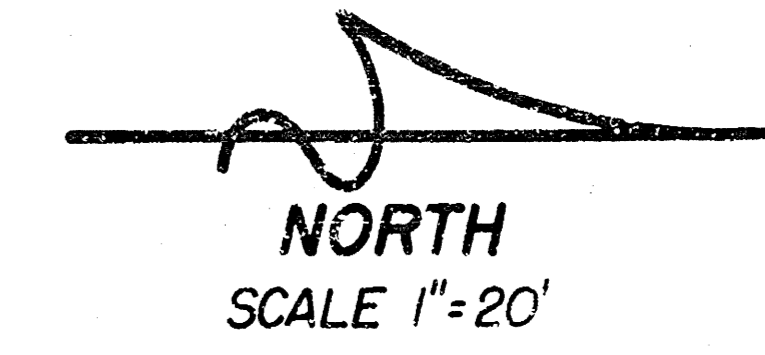

**EMBANKMENT**  
 TYPE OF EMBANKMENT SHALL BE DETERMINED BY THE ENGINEER & CONTRACTOR. Circle parking and clear right-of-way for proposed sidewalk. Compact fill in sidewalk area. TO BE CONSTRUCTED BY "OTHERS".

**EARTHWORK**

Excavation	Property
+10%	1088.7 C.Y.
Total	1088.9 C.Y.
Compacted Fill	—
+10%	—
Total	—
Manipulation	2211.4 S.Y.

Note: Mail Boxes to be Removed & Replaced Shall be Considered Incidental to Project.

**ELLIS AVE.**  
 N.L. Selma Ave. to S.L. MacArthur  
 (30' fc-fc 8" A.C. Pavt. w/ Comb. Cb. &)

**CITY OF WICHITA, KANSAS**  
 R.W. Linn \_\_\_\_\_ City Engineer  
 Proj. No. DAKS577071  
 Date \_\_\_\_\_

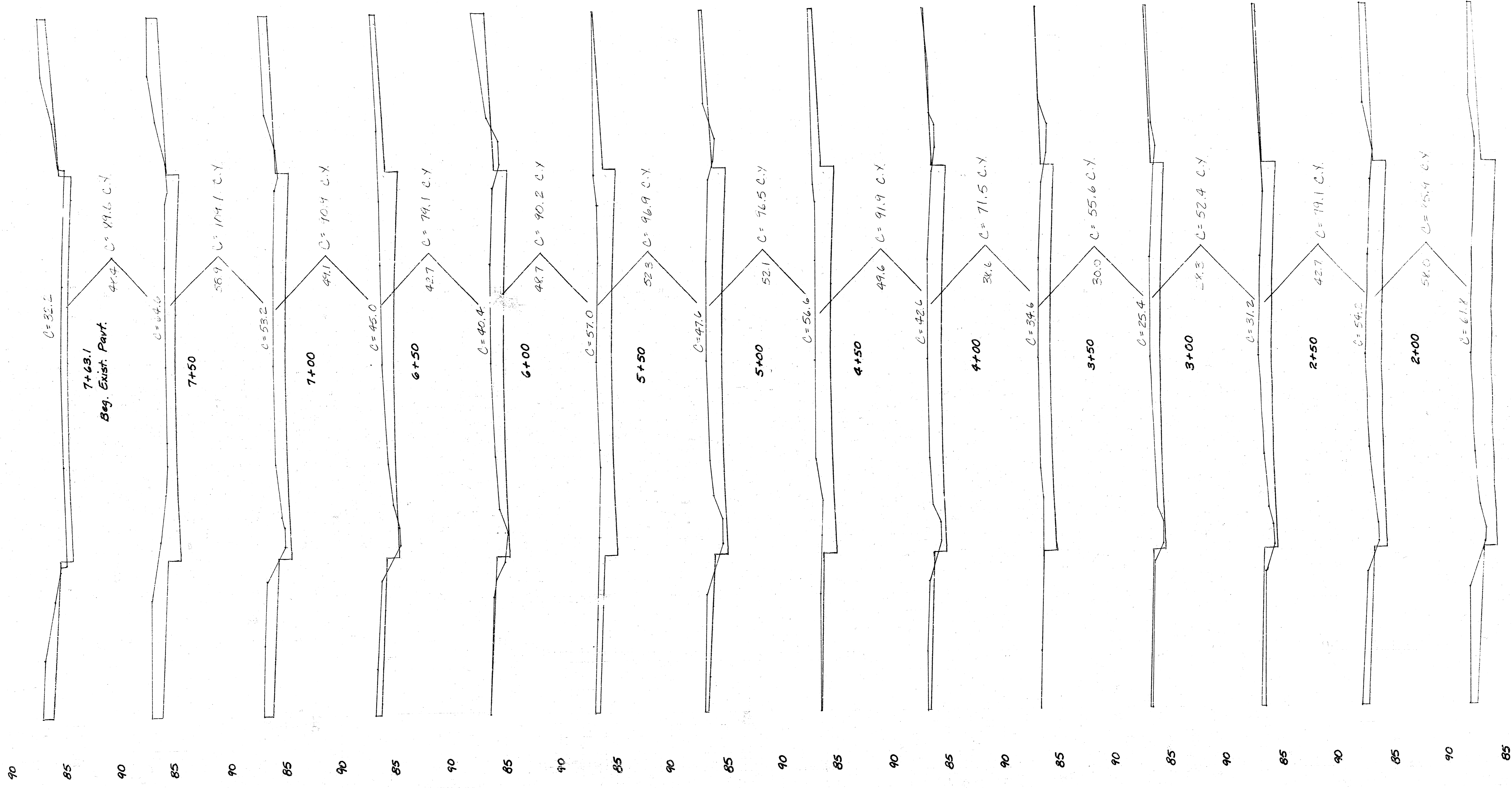

1+60  
N.L. Selma

30 20 10 0 10 20 30

Sheet Totals  
Prod Excav = 1088.7 C.Y.

Ellis & Co.  
DALLAS, TEXAS