

B.M. 9841 'G' in Globe Top cb. E.S. Ellis - S.L. Blake.

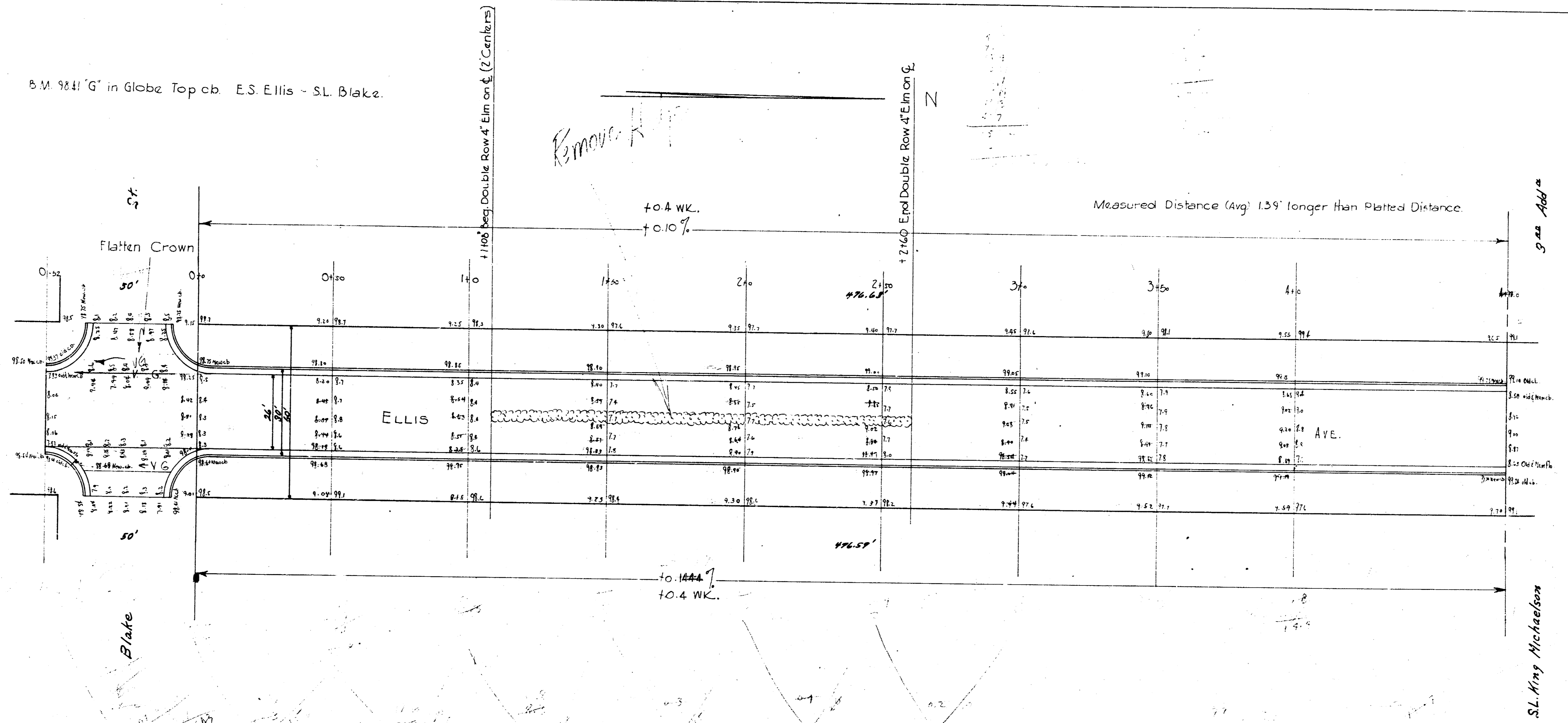

Blake
 32-1
 32-2
 32-3
 32-4
 32-5
 32-6
 32-7
 32-8
 32-9
 32-10

Ellis Ave
 S.L. King Michaelson 3rd Addⁿ - S.L. Blake
 26'-2'-30" AC.
 City of Wichita, Kansas
 L.H. White City Engineer
 February 1988 Project CIP-4

