

B.M. 17045 R.R. Spike E.S. Ball Pole, N.S. Elm @
E.L. Woodlawn Village 2nd Addn.

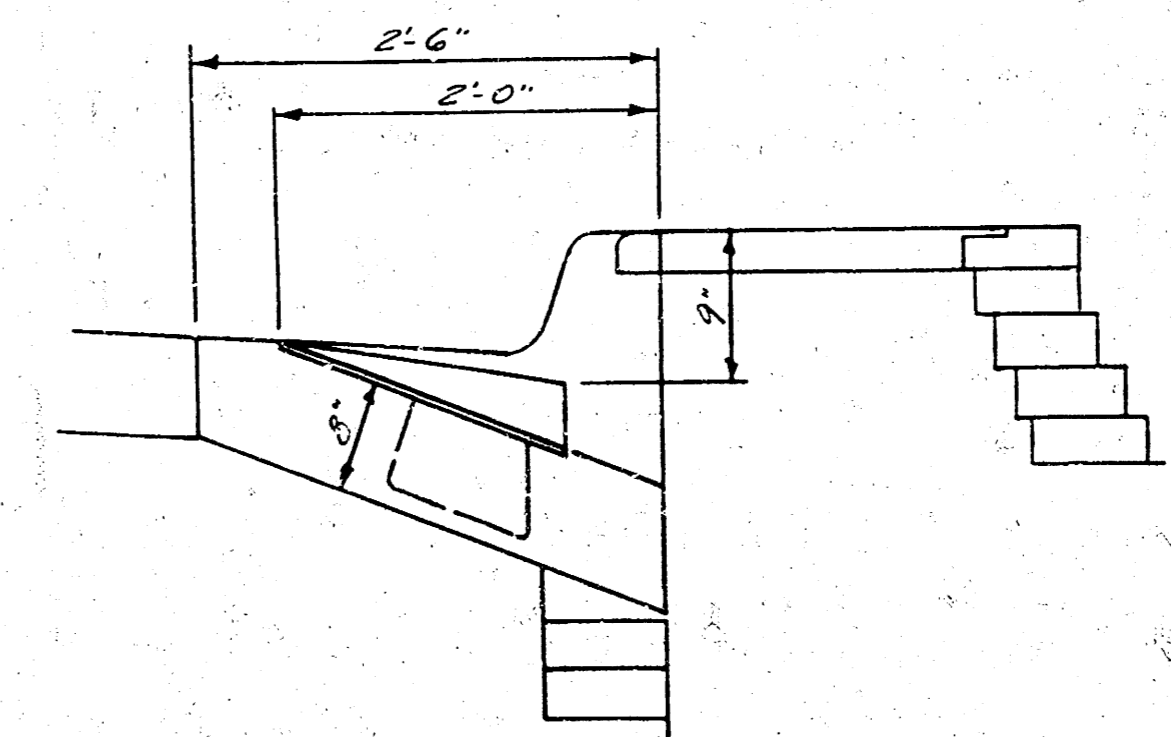

GUTTER DETAIL @ INLET OPENING

Surveyor's Seal
 No. 10787
 State of Kansas
 Exp. 12-31-1963

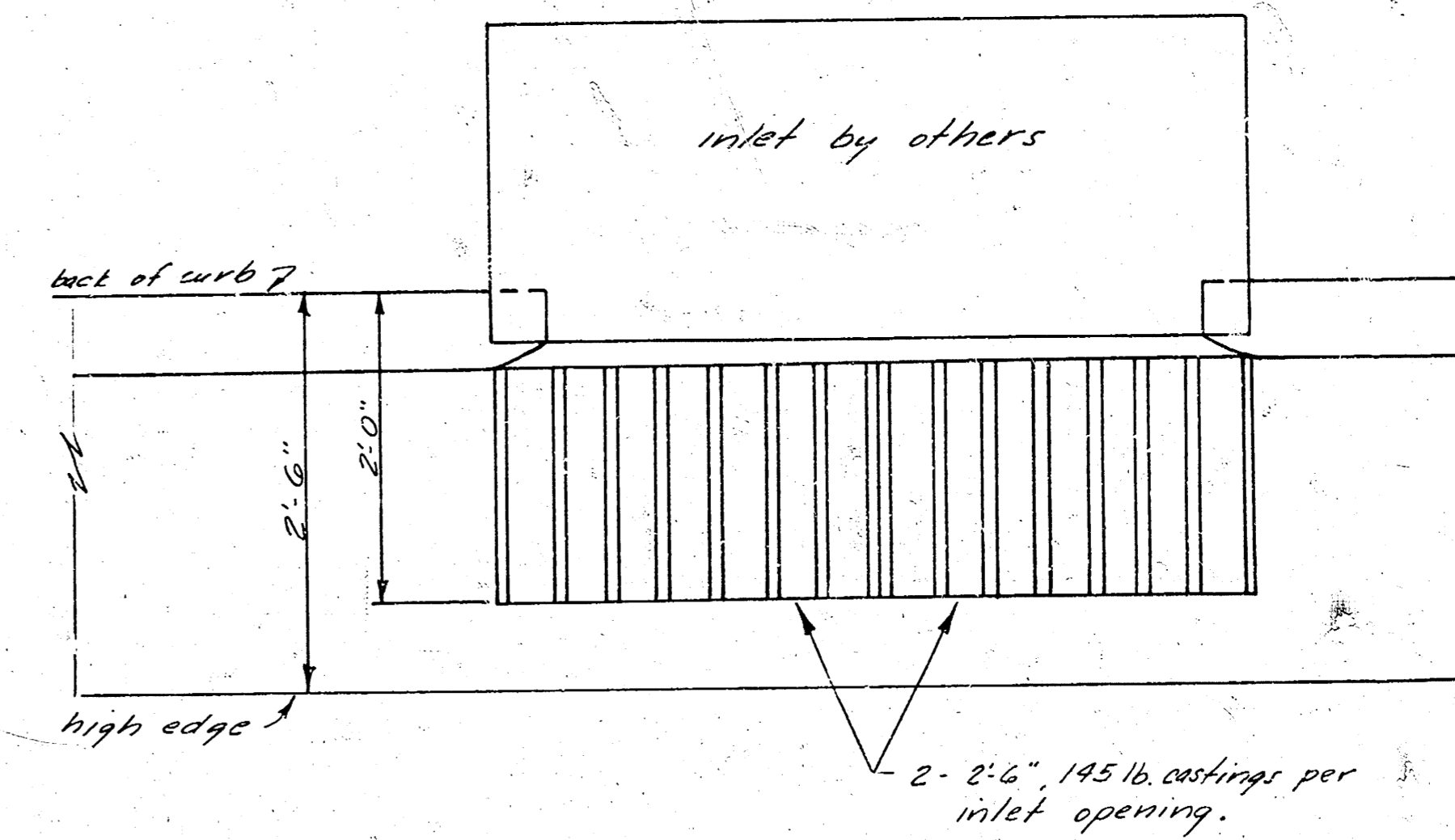
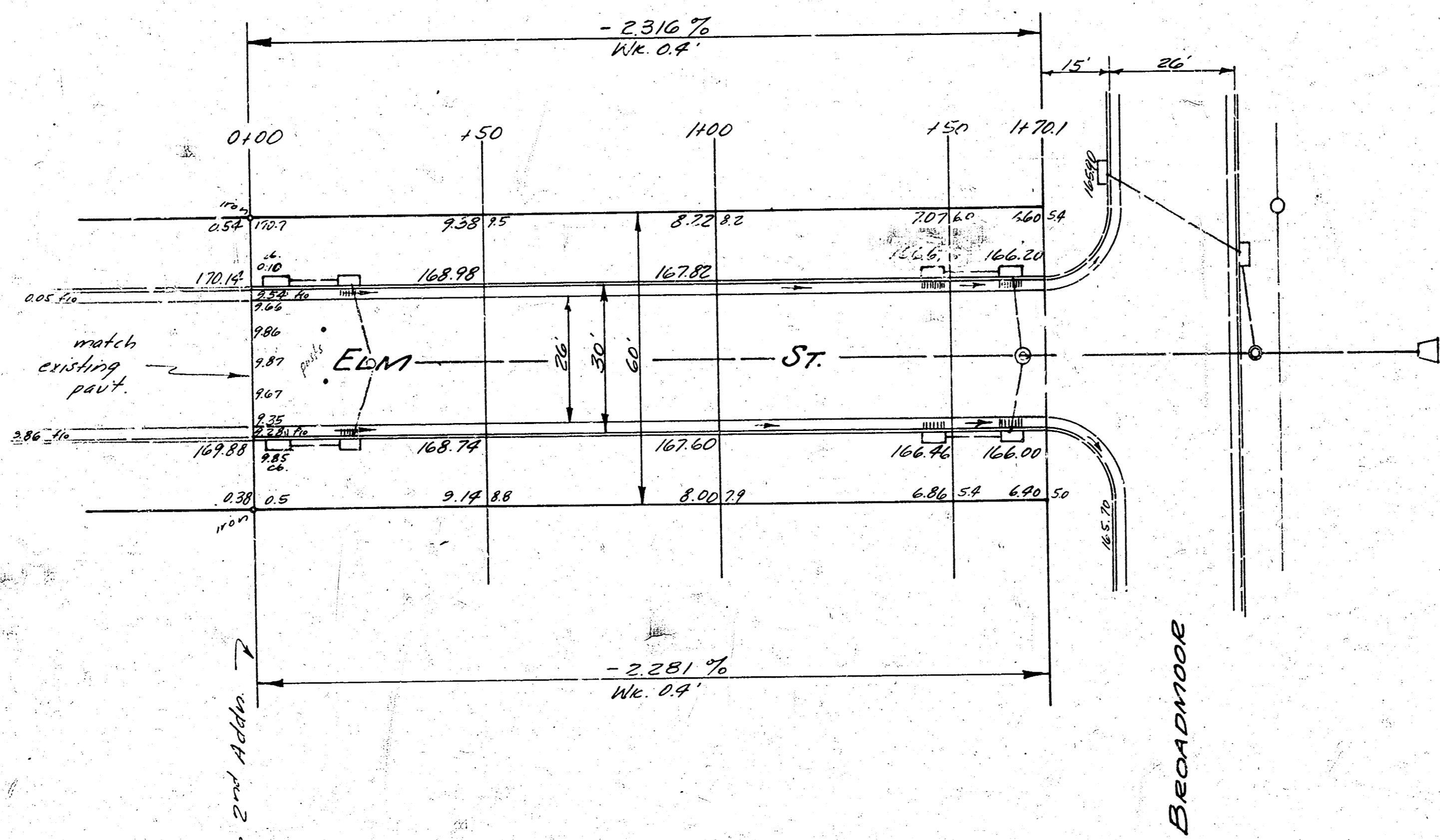
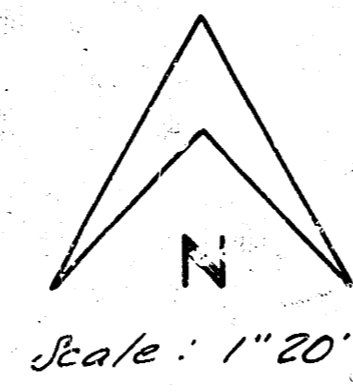
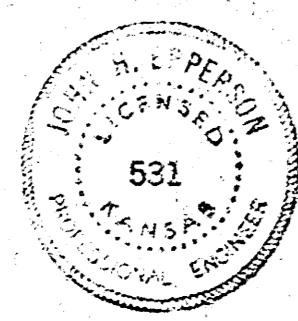
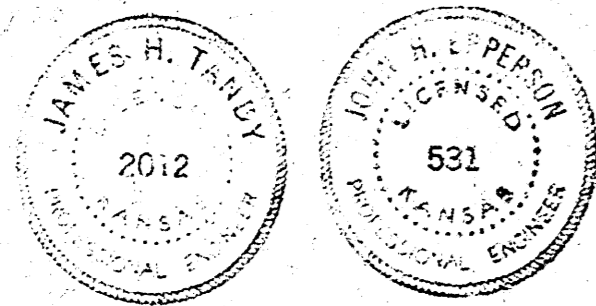

ELM AVE.
 E.L. 2ND ADDN. TO WOODLAWN
 VILLAGE TO W.L. BROADWAY
 26-2-30 A.C.
 CITY OF WICHITA, KANSAS
 B.E. SMITH, CITY ENGINEER
 June 1963 Page C-3-7

1/2

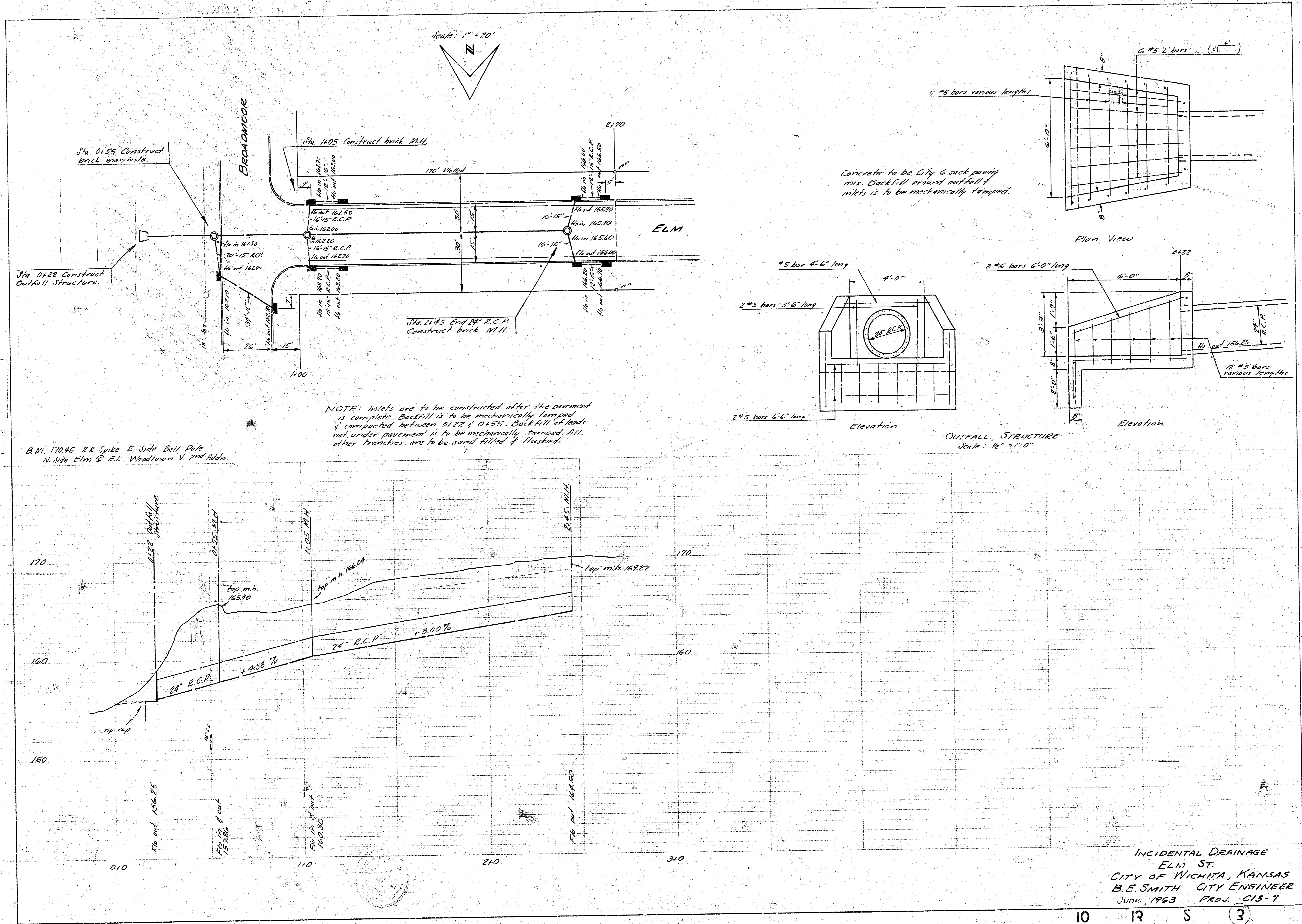

Via 0+55 Construct brick manhole

Via 0+22 Construct Outfall Structure

Via 1+05 Construct brick M.H.

Via 1+45 End 24" R.C.P. Construct brick M.H.

NOTE: Inlets are to be constructed after the pavement is complete. Backfill is to be mechanically tamped & compacted between 0+22 & 0+55. Backfill of leads not under pavement is to be mechanically tamped. All other trenches are to be sand filled & flushed.

Concrete to be City 6 sack paving mix. Backfill around outfall & inlets is to be mechanically tamped.

B.M. 170.45 R.R. Spike E. Side Bell Pole
N. Side Elm @ E.L. Woodlawn V. 2nd Addr.

INCIDENTAL DRAINAGE
ELM ST.
CITY OF WICHITA, KANSAS
B.E. SMITH CITY ENGINEER
June, 1963 PROJ. C13-7