

B.M. 30.60 "P" in P.K.S. W. ch. Pattie & N.L. Del Mar Stationing on E

NOTE TO FIELD ENGINEER TO CHECK  
GROUND SHOTS WHEN SETTING CUT STAKES  
GET RE-X SECTIONS IF NECESSARY

Catch basins to be built in connection  
with storm sewer. Construct curb  
& flo for standard 2'-5" C.B.

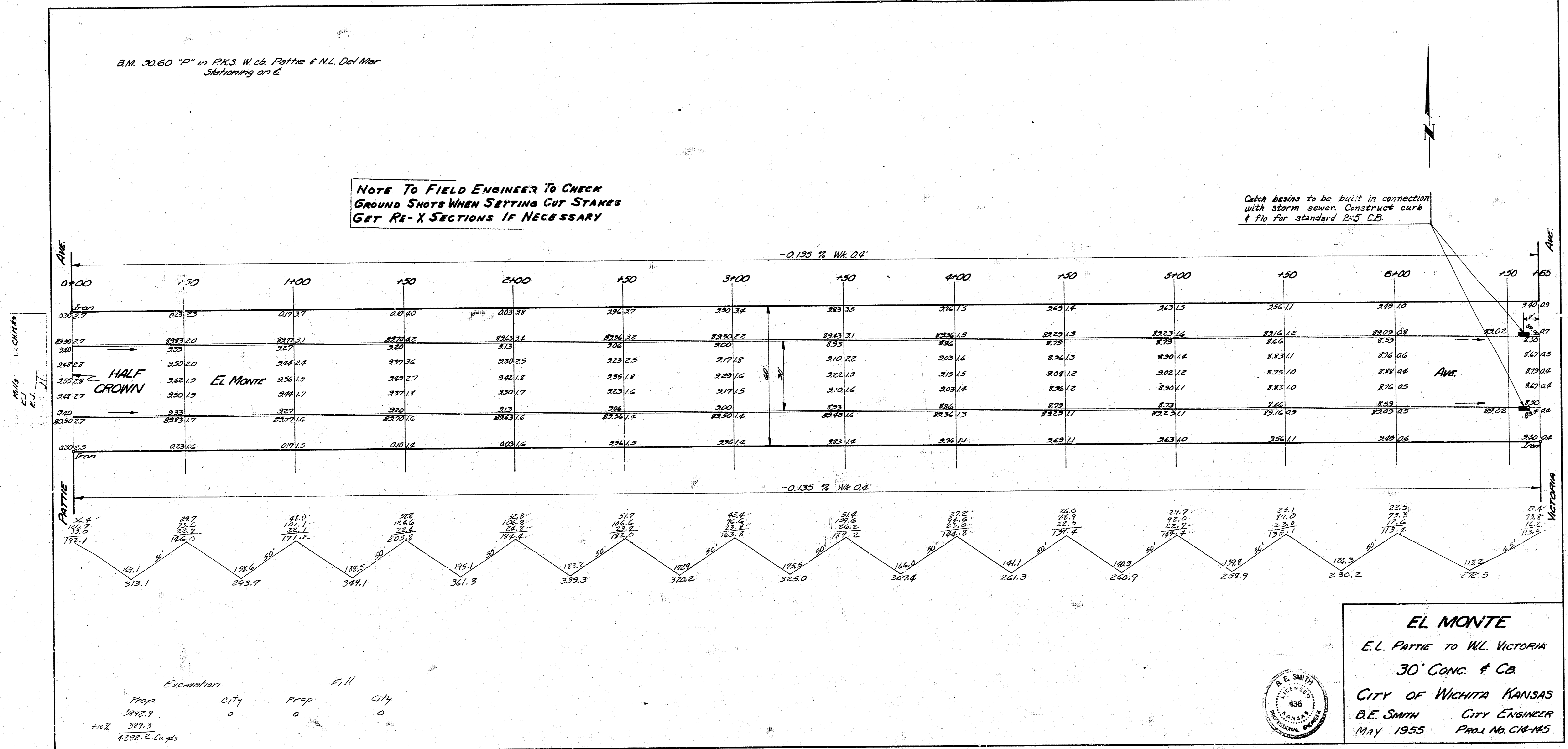

**EL MONTE**  
E.L. PATTIE TO W.L. VICTORIA  
30' CONC. & CB  
CITY OF WICHITA KANSAS  
B.E. SMITH CITY ENGINEER  
May 1955 PROJ. NO. CH-145

