

B.M. 151.78 22 SPIKE N. SIDE K&E TRANS. POLE 100' E. OF ELPYCO ST. HARRY
 B.M. 151.10 "G" IN GLOBE E. END RAD. N.E. COR. OSIE AVE. ELPYCO

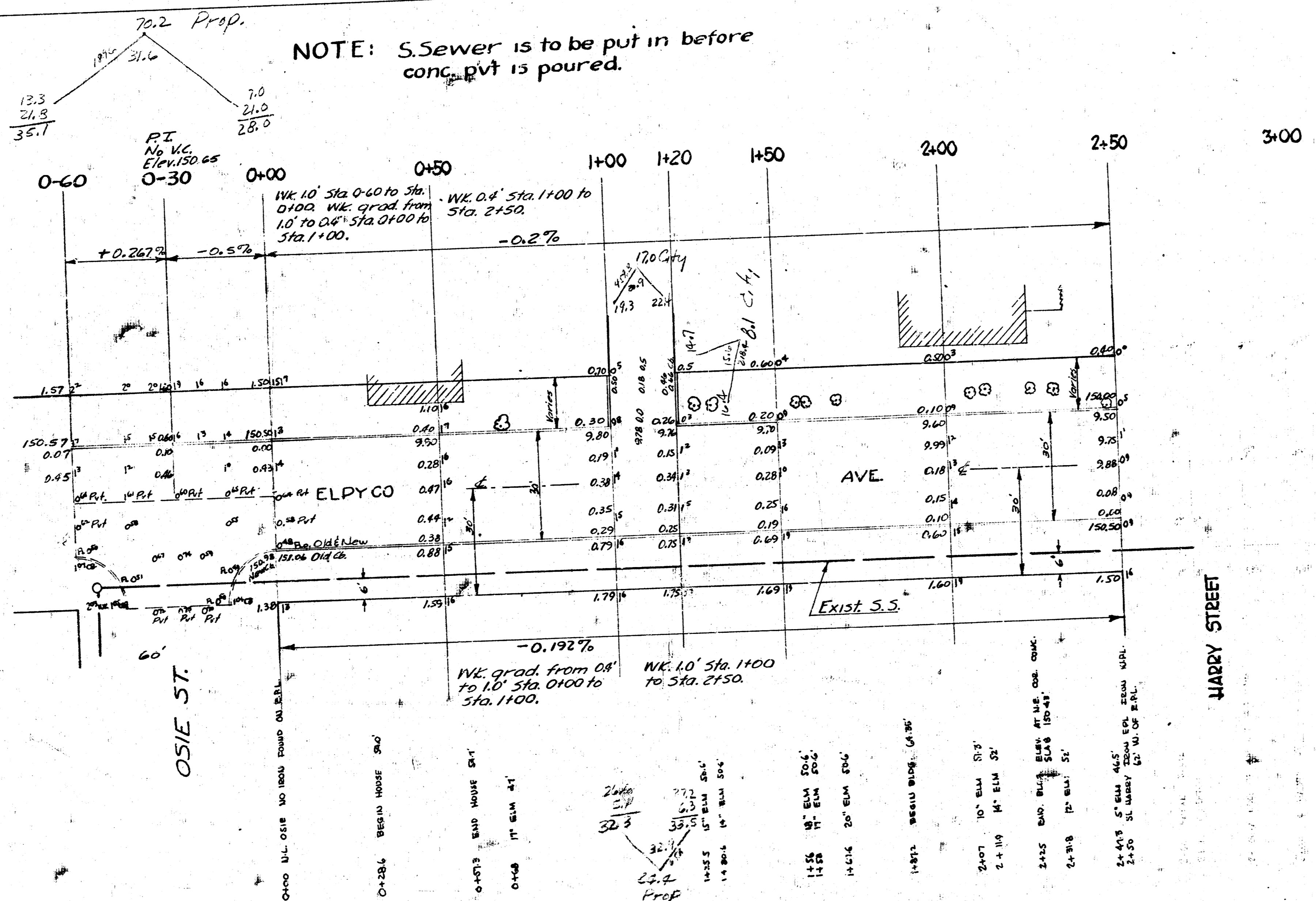

NOTE: Pavement to be located from E.P.L. of Elpyco.

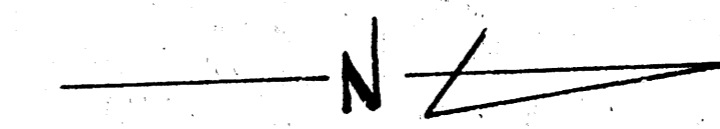

Prop.	Exc.	City
70.2		17.0
93.7		8.1
108.1		25.1
24.4		110.0
69.7		2.5
122.0		total 27.6 Cu. Yds.
616.9		
110.0		
total 678.6 Cu. Yds.		

NOTE: CHAINING NORTH ON E.P.L. LAID OFF FROM E.P.L.

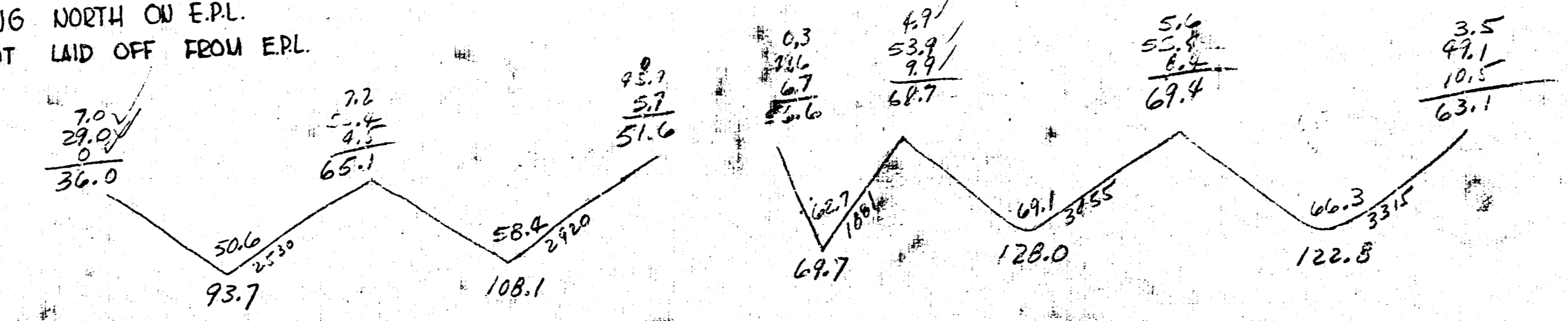

ELPYCO AVE.
 SL HARRY ST. SL OSIE ST.
 30' CONC. AND CO.
 CITY OF WICHITA, KANS.
 LK WHITE CITY ENGINEER
 JUNE, 1950 P.W. No. C10-70