

B.M. 15303 S.W. Cor. Parth. Ho. # 858 Pinecrest  
 B.M. 14941 S.W. Cor. Conc. Parth. Ho. # 836 Elpyco  
 B.M. 14715 E. W. L. Edge, N. Side Bridge on Lincoln, N. of Elpyco

Charming N. on E. R.

0+46.5 Driv. 6' E.E.B. of width  
 1+08 Driv. 6' E.E.B. of width  
 1+17 RR 48" to E. base from E.R.  
 1+41.5 Dr. 6' E.E.B. of width  
 1+52.5 Dr. 6' E.E.B. of width  
 2+19.5 Dr. 6' E.E.B. of width  
 2+55.5 End. 6' E.E.B. of width  
 3+16.5 Dr. 6' E.E.B. of width  
 3+46.5 End. 6' E.E.B. of width

Excav.		Fill	
Prop.	City	Prop.	City
2.0	0	5.0	0
10.2		36.9	
0.9		41.5	
2.0		46.1	
2.6		51.2	
2.3		40.7	
22.8 cu yd.		205.4	
2.3		414.2 cu yd.	
Total 25.1 cu yd.		Total 291.9 cu yd.	

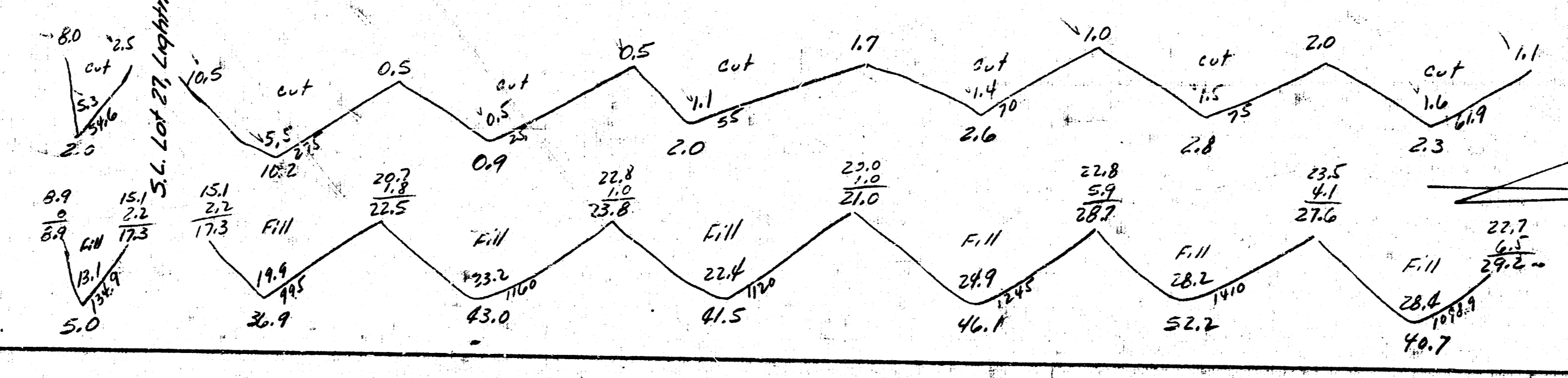
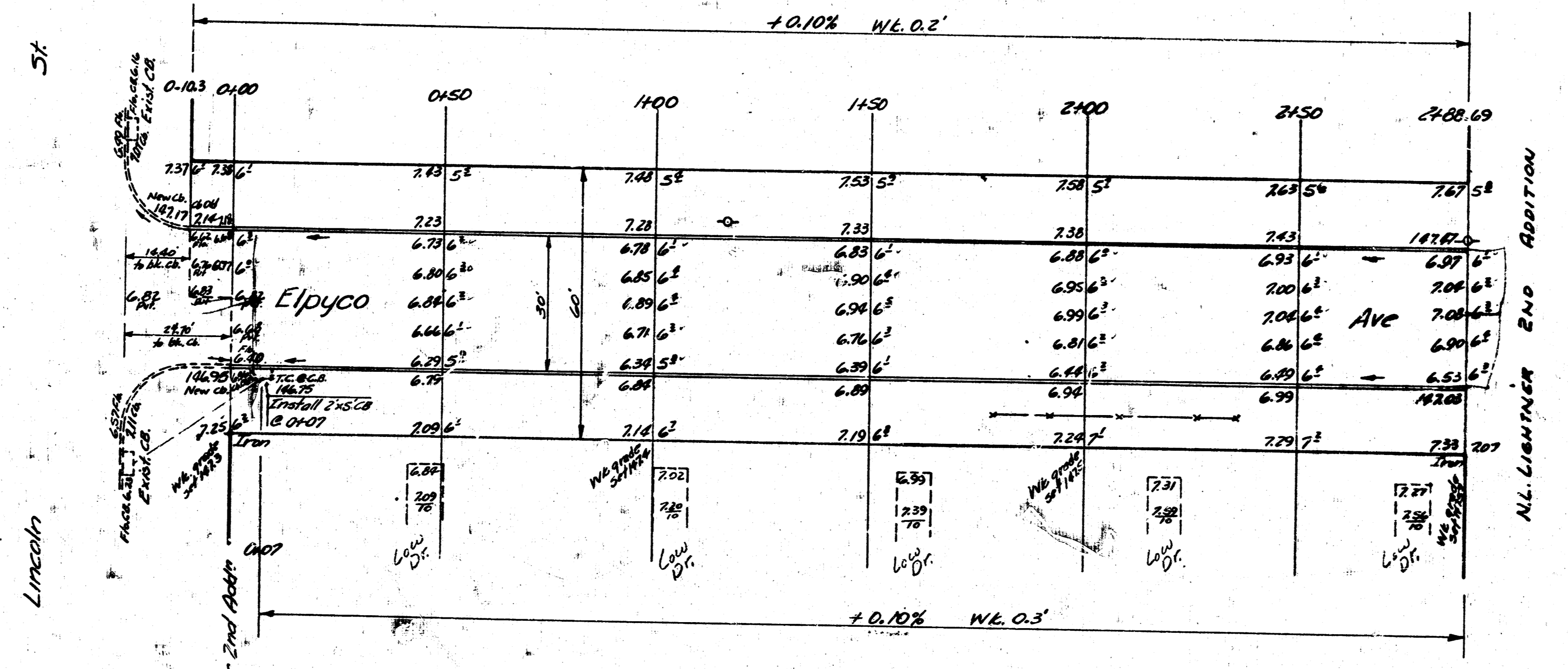

STONY, J.A.C.  
 Plain 1/2" = 10'  
 Exc. 1/4" = 10'  
 Checked: J.P.F.

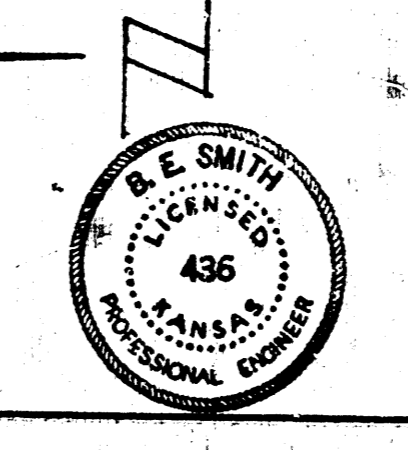

ELPYCO AVE.  
 S.W. Lot 27, Lightner 2nd to N.L. Lightner 2nd  
 30' CONC. & CB

CITY OF WICHITA, KANSAS  
 B.E. SMITH CITY ENGINEER  
 JAN. 19, 1953 PROJ. No. C12-196