

B.M. 96.35 S. End E. Ch. El Rancho, S.L. Cheyenne
 B.M. 76.61 6' in Globe Cr. Wk W. S.S. Cheyenne, 30' W. of E. El Rancho

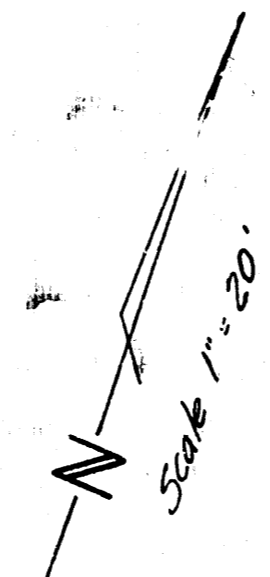

NOTE: City to install 215' C.B. & 12" R.C.P. Remove existing conc. C.B. @ existing pipe & connect new pipe with marker collar.

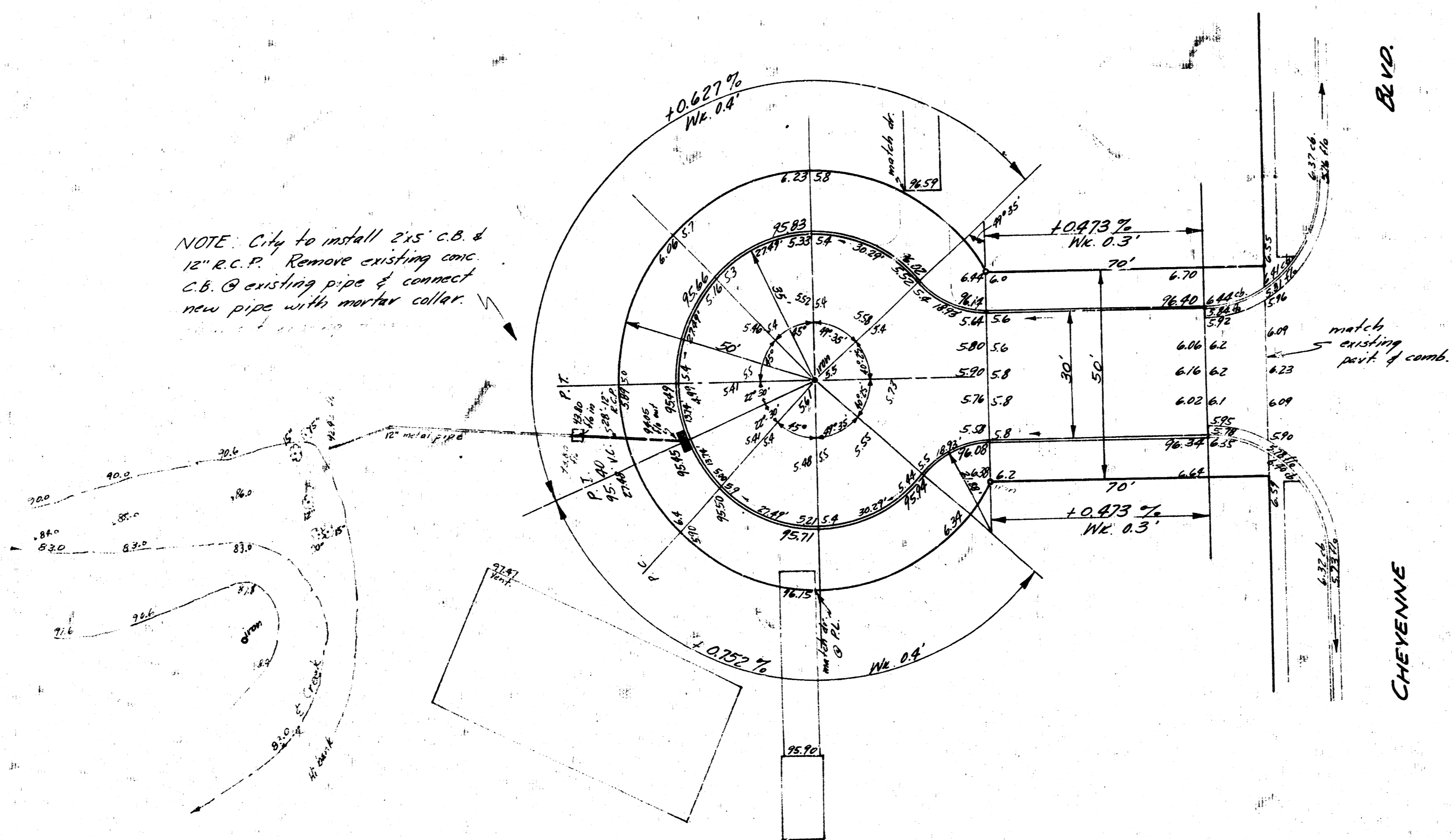

EL RANCHO COURT
 W.L. CHEYENNE TO W.L. CO. DE SAC
 30' CONC. & CO.
 CITY OF WICHITA, KANSAS
 B.E. SMITH - CITY ENGINEER
 JULY 1957 PROJ. No. 115-118



B.E. SMITH
 CIVIL ENGINEER
 No. 115-118