

B.M. 99.92 Stop Bench in PAVE N.E. Cor. Emporia & Pawnee
 B.M. 99.50 "D" in W.B. PAVE N.S. W. W. S.W. Cor. Hinkard & Emporia

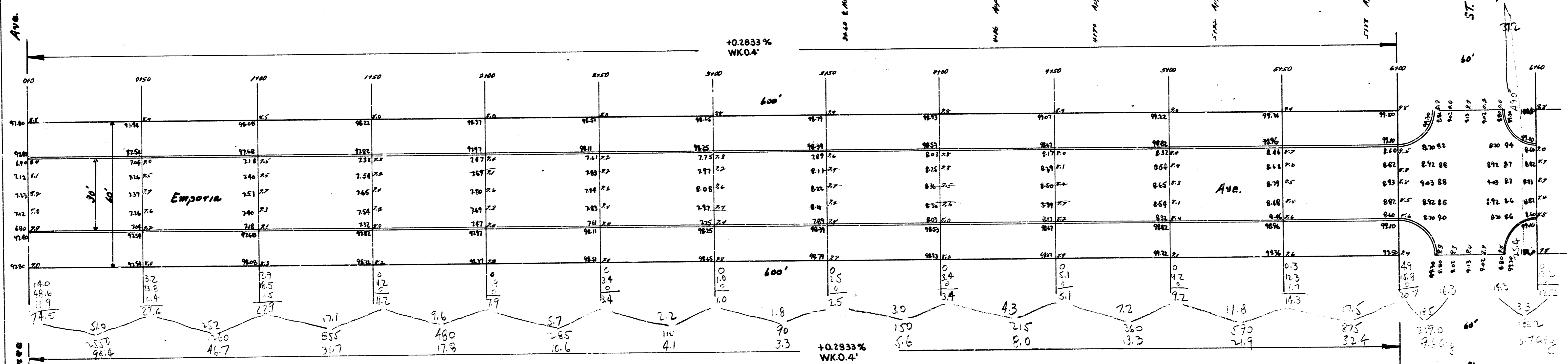
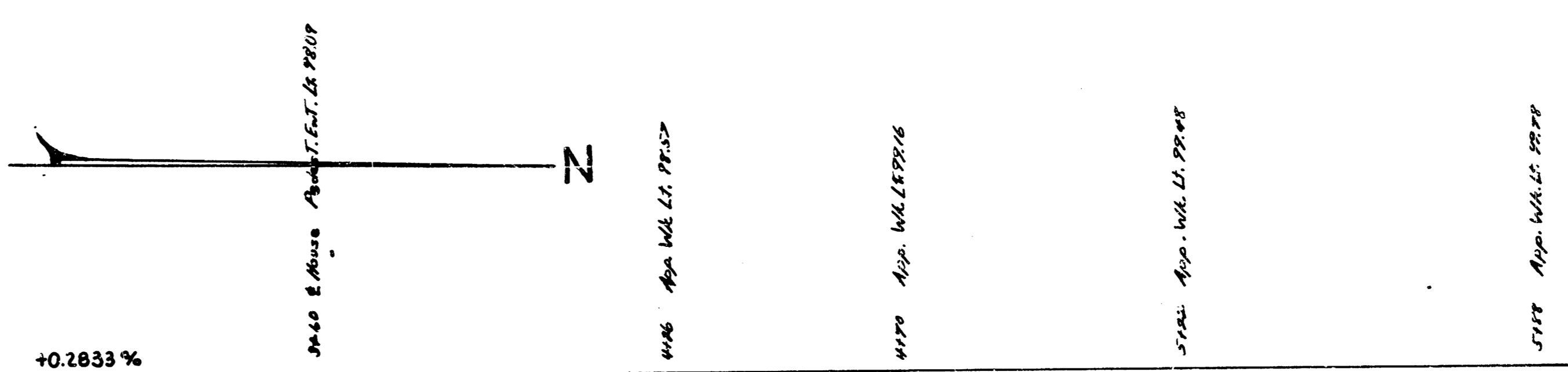

7.00	7.00
7.22	7.22
7.47	7.47
7.71	7.71
7.95	7.95
8.19	8.19
8.43	8.43
8.67	8.67
8.91	8.91
9.15	9.15
9.39	9.39
9.63	9.63
9.87	9.87
10.11	10.11
10.35	10.35
10.59	10.59
10.83	10.83
11.07	11.07
11.31	11.31
11.55	11.55
11.79	11.79
12.03	12.03
12.27	12.27
12.51	12.51
12.75	12.75
12.99	12.99
13.23	13.23
13.47	13.47
13.71	13.71
13.95	13.95
14.19	14.19
14.43	14.43
14.67	14.67
14.91	14.91
15.15	15.15
15.39	15.39
15.63	15.63
15.87	15.87
16.11	16.11
16.35	16.35
16.59	16.59
16.83	16.83
17.07	17.07
17.31	17.31
17.55	17.55
17.79	17.79
18.03	18.03
18.27	18.27
18.51	18.51
18.75	18.75
18.99	18.99
19.23	19.23
19.47	19.47
19.71	19.71
19.95	19.95
20.19	20.19
20.43	20.43
20.67	20.67
20.91	20.91
21.15	21.15
21.39	21.39
21.63	21.63
21.87	21.87
22.11	22.11
22.35	22.35
22.59	22.59
22.83	22.83
23.07	23.07
23.31	23.31
23.55	23.55
23.79	23.79
24.03	24.03
24.27	24.27
24.51	24.51
24.75	24.75
24.99	24.99
25.23	25.23
25.47	25.47
25.71	25.71
25.95	25.95
26.19	26.19
26.43	26.43
26.67	26.67
26.91	26.91
27.15	27.15
27.39	27.39
27.63	27.63
27.87	27.87
28.11	28.11
28.35	28.35
28.59	28.59
28.83	28.83
29.07	29.07
29.31	29.31
29.55	29.55
29.79	29.79
30.03	30.03
30.27	30.27
30.51	30.51
30.75	30.75
30.99	30.99
31.23	31.23
31.47	31.47
31.71	31.71
31.95	31.95
32.19	32.19
32.43	32.43
32.67	32.67
32.91	32.91
33.15	33.15
33.39	33.39
33.63	33.63
33.87	33.87
34.11	34.11
34.35	34.35
34.59	34.59
34.83	34.83
35.07	35.07
35.31	35.31
35.55	35.55
35.79	35.79
36.03	36.03
36.27	36.27
36.51	36.51
36.75	36.75
36.99	36.99
37.23	37.23
37.47	37.47
37.71	37.71
37.95	37.95
38.19	38.19
38.43	38.43
38.67	38.67
38.91	38.91
39.15	39.15
39.39	39.39
39.63	39.63
39.87	39.87
40.11	40.11
40.35	40.35
40.59	40.59
40.83	40.83
41.07	41.07
41.31	41.31
41.55	41.55
41.79	41.79
42.03	42.03
42.27	42.27
42.51	42.51
42.75	42.75
42.99	42.99
43.23	43.23
43.47	43.47
43.71	43.71
43.95	43.95
44.19	44.19
44.43	44.43
44.67	44.67
44.91	44.91
45.15	45.15
45.39	45.39
45.63	45.63
45.87	45.87
46.11	46.11
46.35	46.35
46.59	46.59
46.83	46.83
47.07	47.07
47.31	47.31
47.55	47.55
47.79	47.79
48.03	48.03
48.27	48.27
48.51	48.51
48.75	48.75
48.99	48.99
49.23	49.23
49.47	49.47
49.71	49.71
49.95	49.95
50.19	50.19
50.43	50.43
50.67	50.67
50.91	50.91
51.15	51.15
51.39	51.39
51.63	51.63
51.87	51.87
52.11	52.11
52.35	52.35
52.59	52.59
52.83	52.83
53.07	53.07
53.31	53.31
53.55	53.55
53.79	53.79
54.03	54.03
54.27	54.27
54.51	54.51
54.75	54.75
54.99	54.99
55.23	55.23
55.47	55.47
55.71	55.71
55.95	55.95
56.19	56.19
56.43	56.43
56.67	56.67
56.91	56.91
57.15	57.15
57.39	57.39
57.63	57.63
57.87	57.87
58.11	58.11
58.35	58.35
58.59	58.59
58.83	58.83
59.07	59.07
59.31	59.31
59.55	59.55
59.79	59.79
60.03	60.03

City
 98.0
 8.9
 82.7
 73.2
 +10.6
 109.1 cu yds

Totals
 City
 109.1

Totals
 Paved
 318.8
 342.7
 262.5 cu yds

Emporia Ave.
 N.E. Pawnee - S.E. Hinkard
 90' Conc. + Cb.
 City of Wichita, Kansas
 L.K. White City Engineer
 May 1948 Project CIP-61



25.1
 25.0
 24.9
 24.8
 24.7
 24.6
 24.5
 24.4
 24.3
 24.2
 24.1
 24.0
 23.9
 23.8
 23.7
 23.6

