

3.11 106.15 12" TOP CURB 3" CONC. LEWIS & EMPORIA
 11.58 106.15 12" TOP CURB 3" CONC. WATERMAN & EMPORIA
 11.58 106.15 12" TOP CURB 3" CONC. WILLIAM

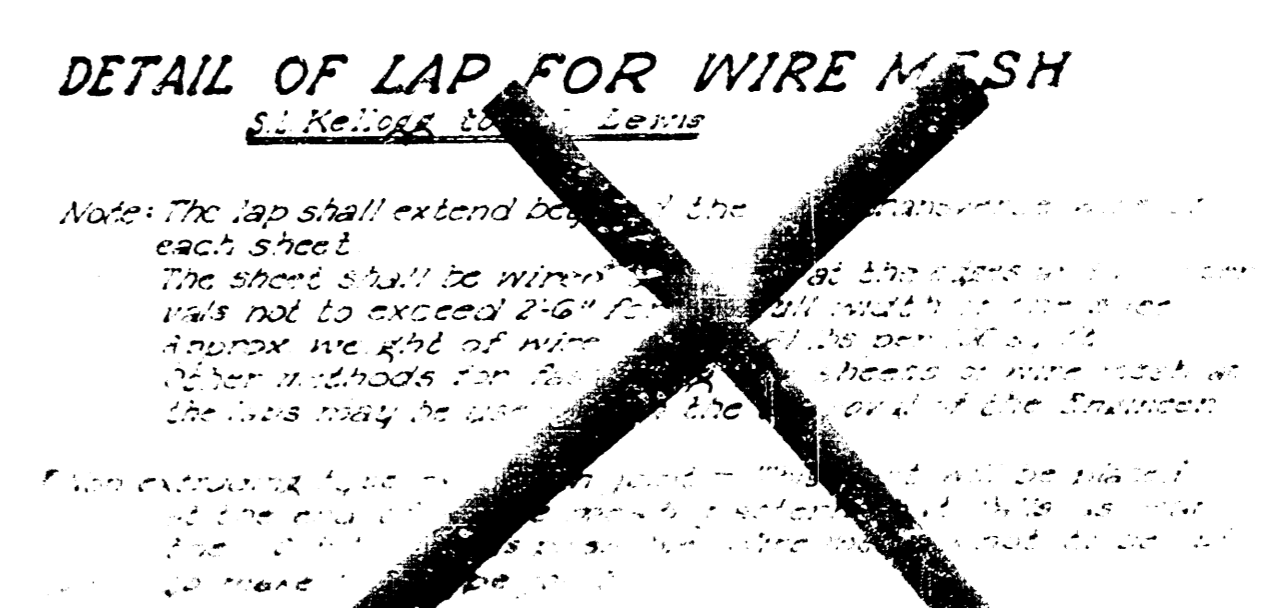

Street: EMPORIA AVENUE
 Construction: LEWIS ST. to WILLIAM STR.
 Type of Construction: COMBINED OR IMPROVE-RECONSTRUCT
 Date: _____

END CONSTRUCTION ON PROJECT C10-70
 BEGIN C10-71

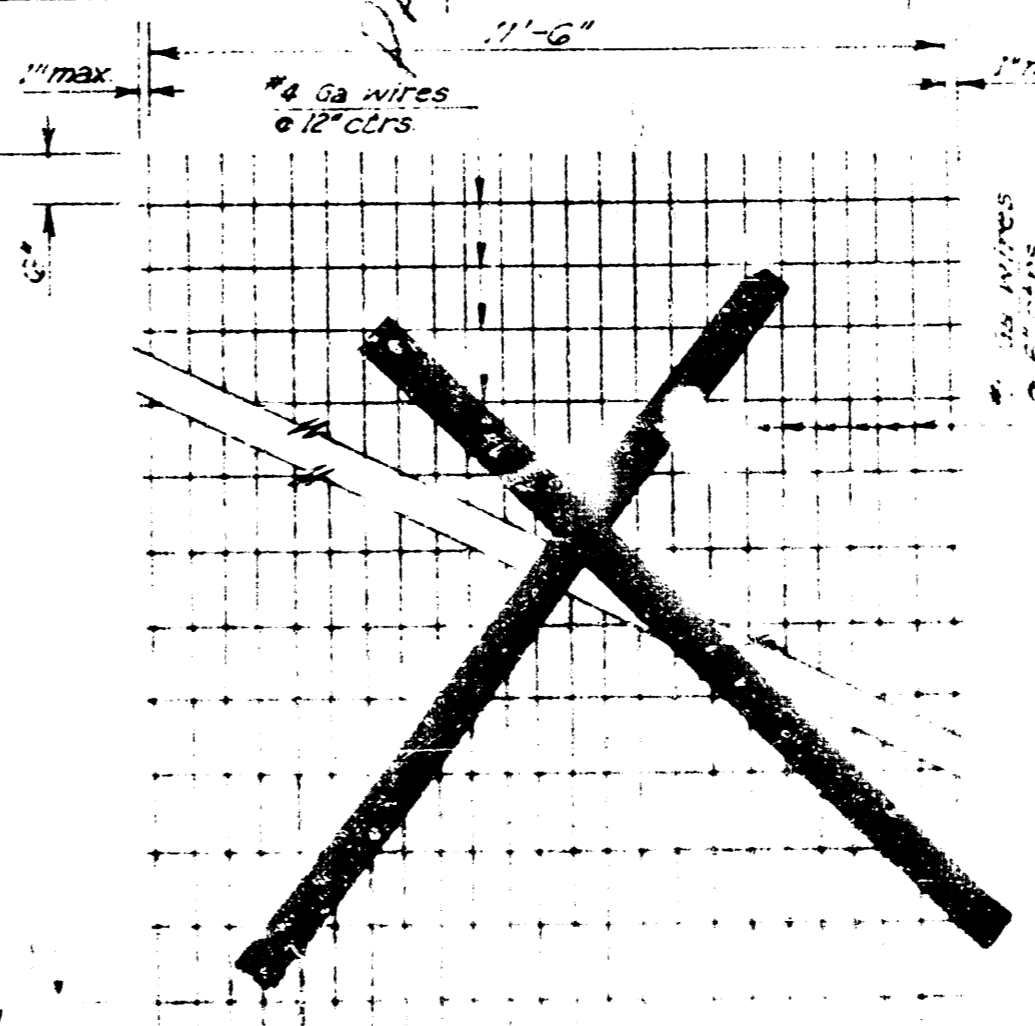
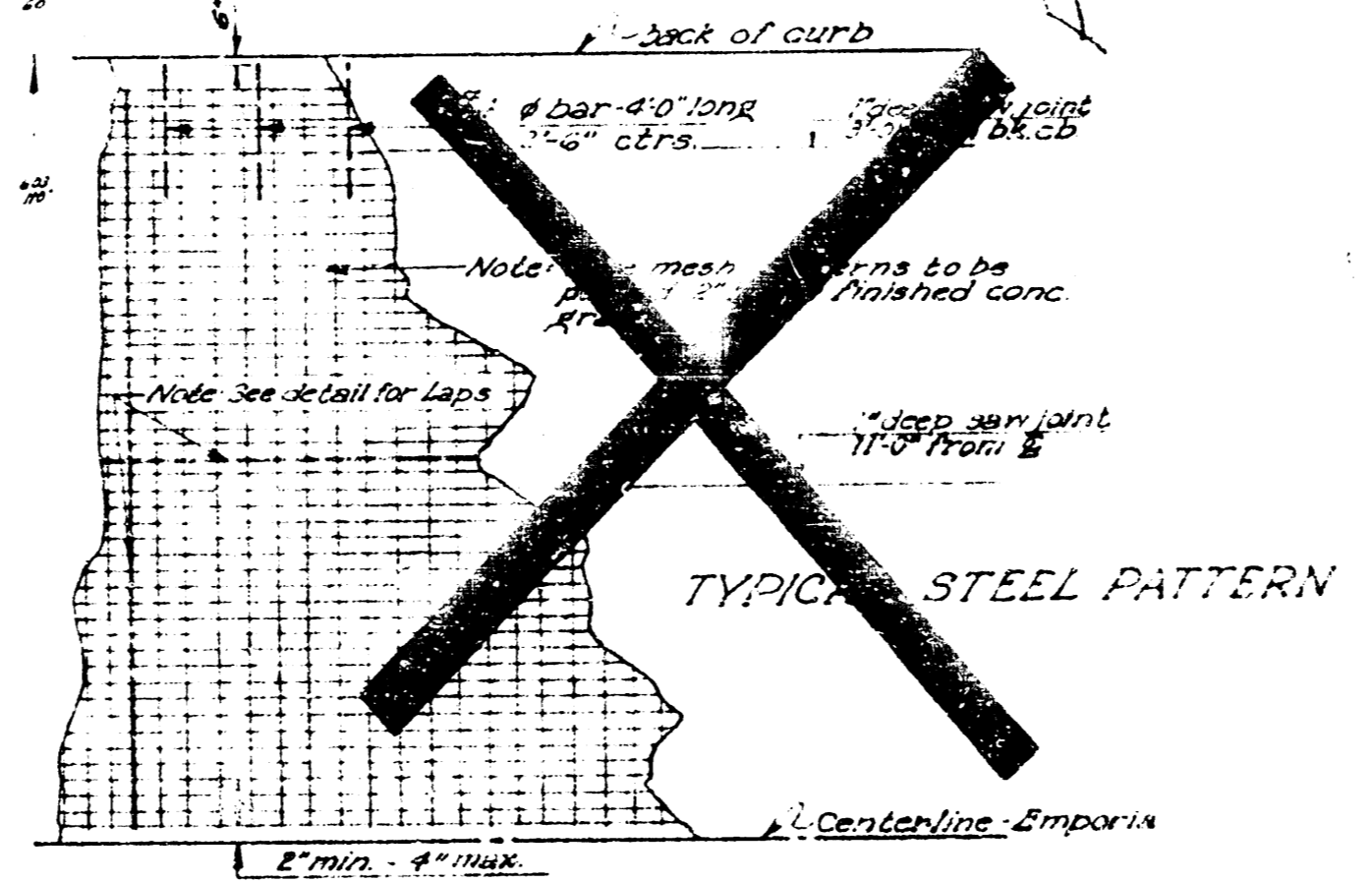
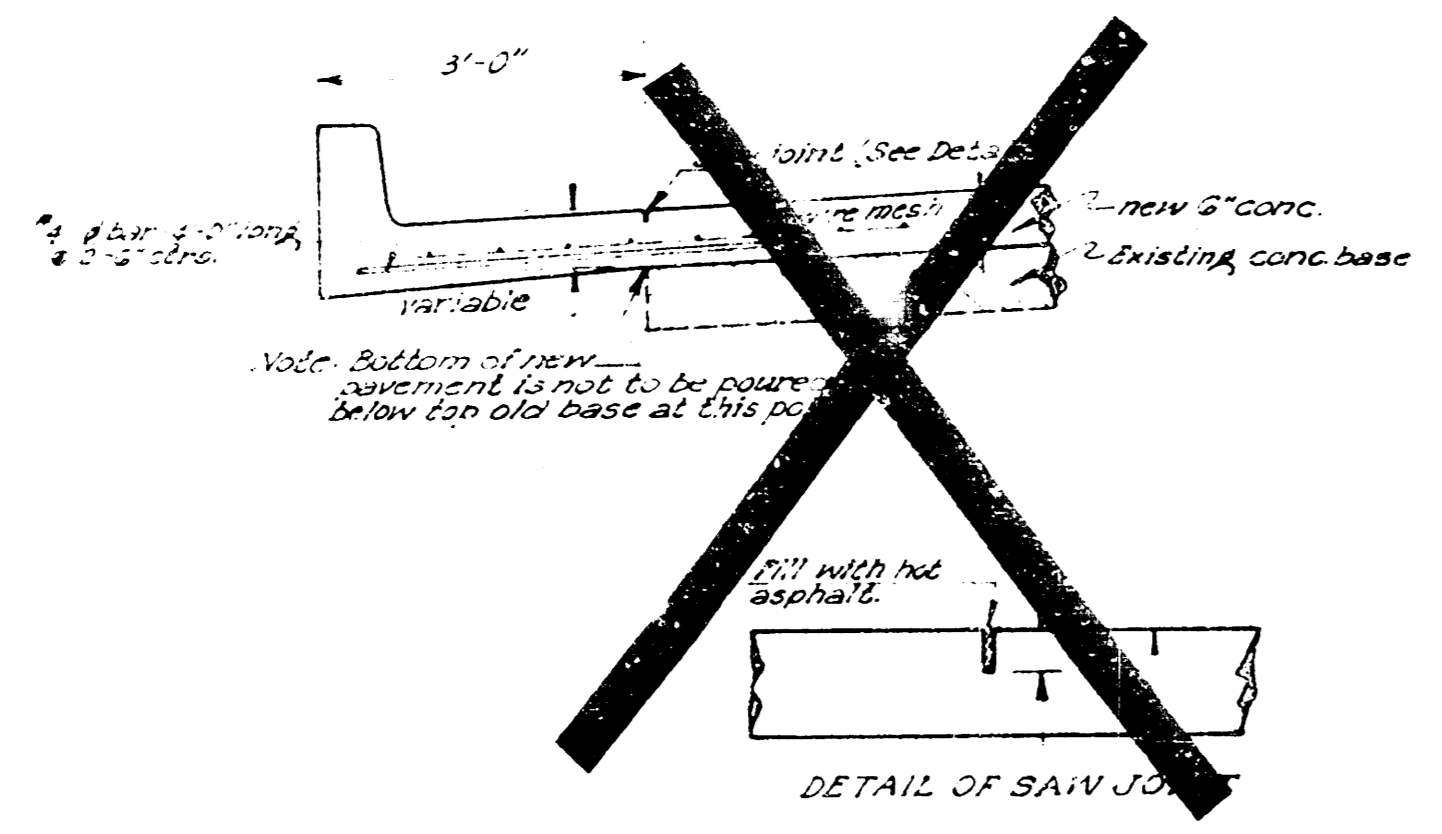
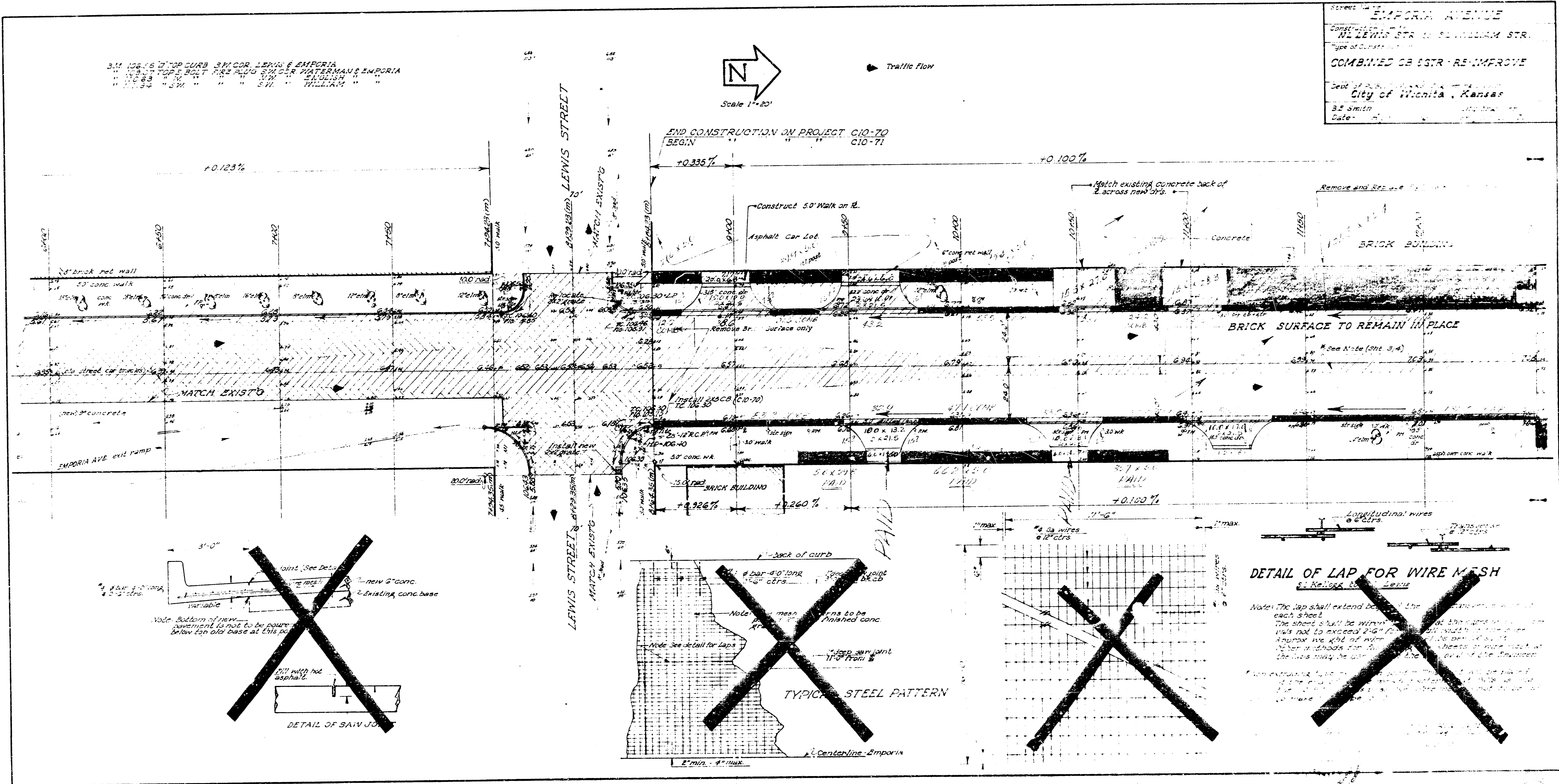

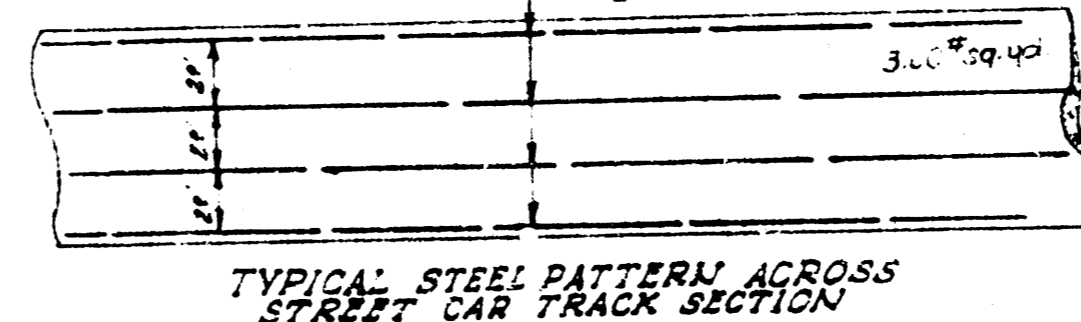
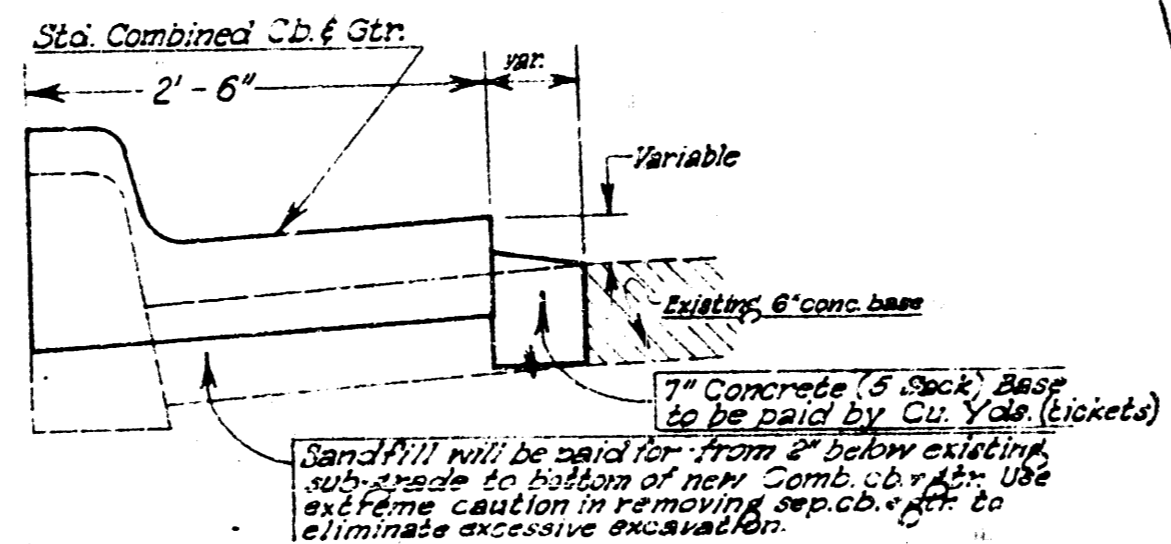
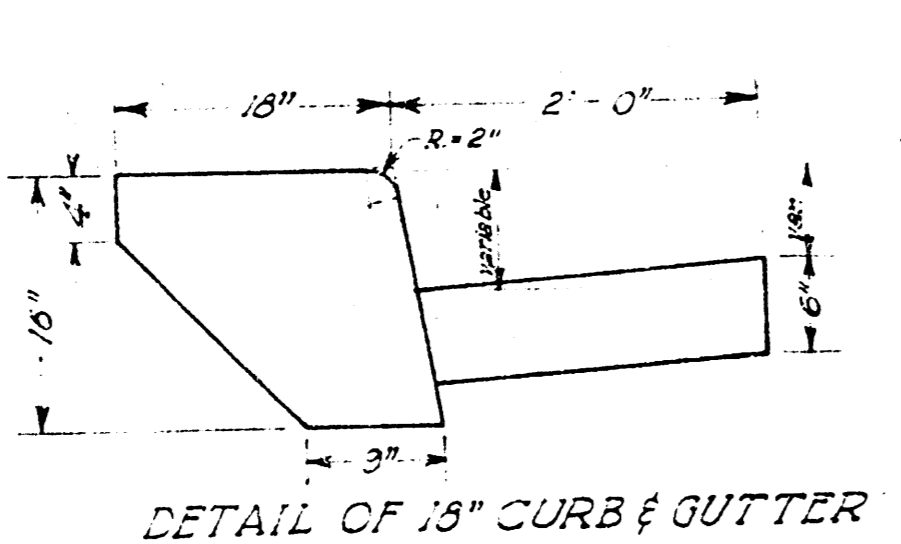
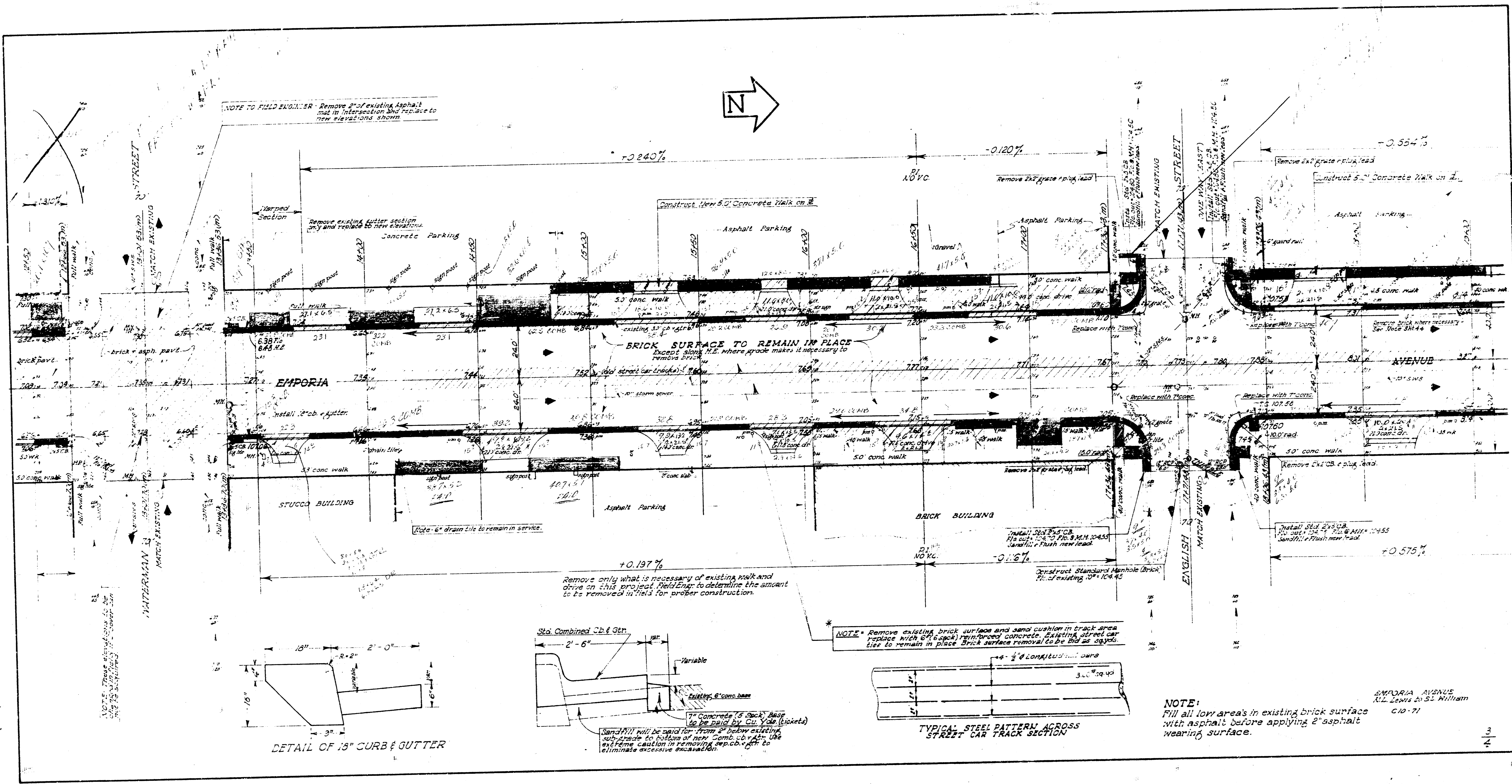

EMPORIA AVENUE
ALL Levels to St. William
C/10-71

BM 107.95 Top E.S. bolt fire plug NW Kellogg & Emporia.
 " 105.91 " " top cb NW cor Dewey & Emporia.
 " 101.11 Top E. bolt fire plug midway bet. Lewis & Dewey.
 " 106.56 " " top cb SW cor Lewis & Emporia.
 " 108.07 Top E. bolt fire plug SW cor Waterman & Emporia.
 " 102.63 " " " " NW cor English & Emporia.
 " 111.94 " " " " SW cor William & Emporia.

Note: Existing conc. slabs to remain in place. True
 corners where brick and conc. join together
 to be sawed, gutter section to front of catch
 basins to remain in place also.

Traffic Flow →

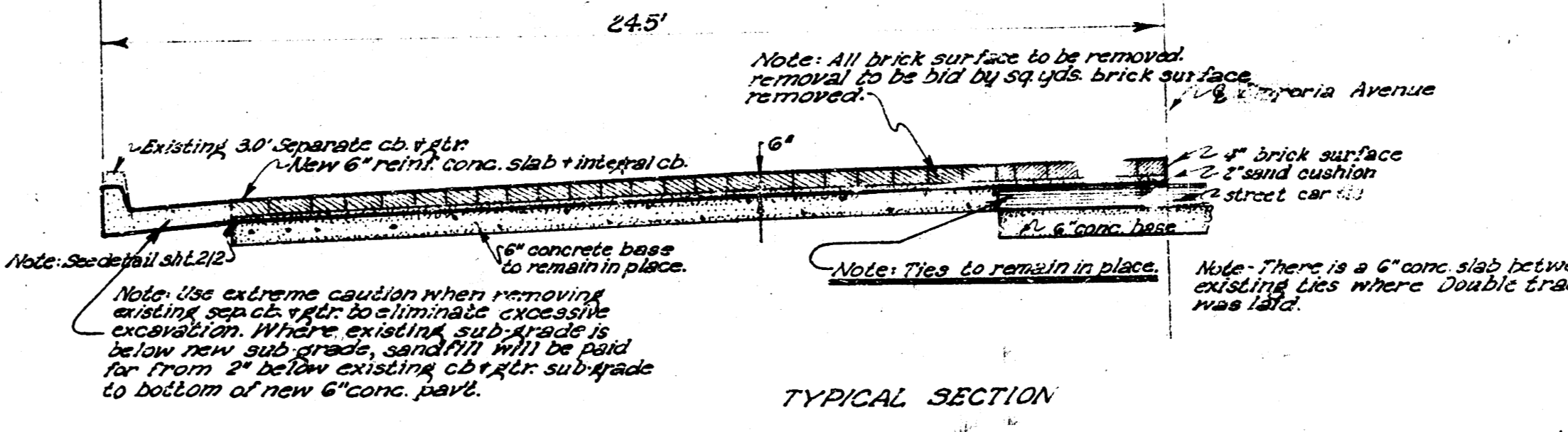
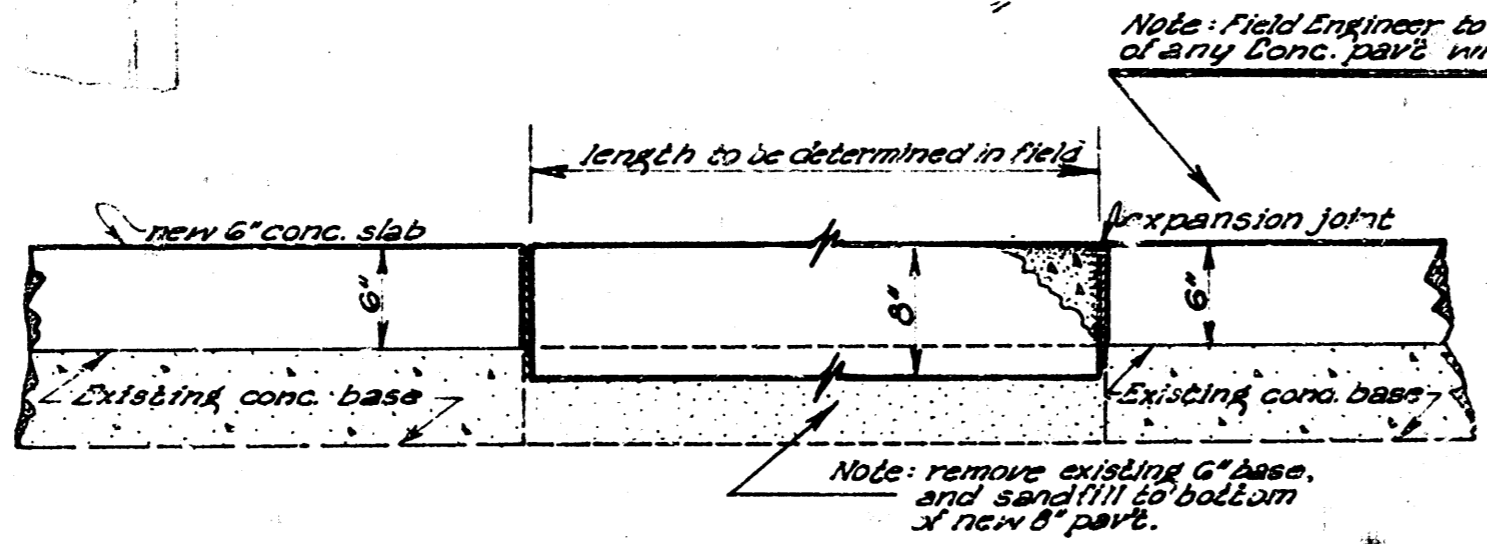
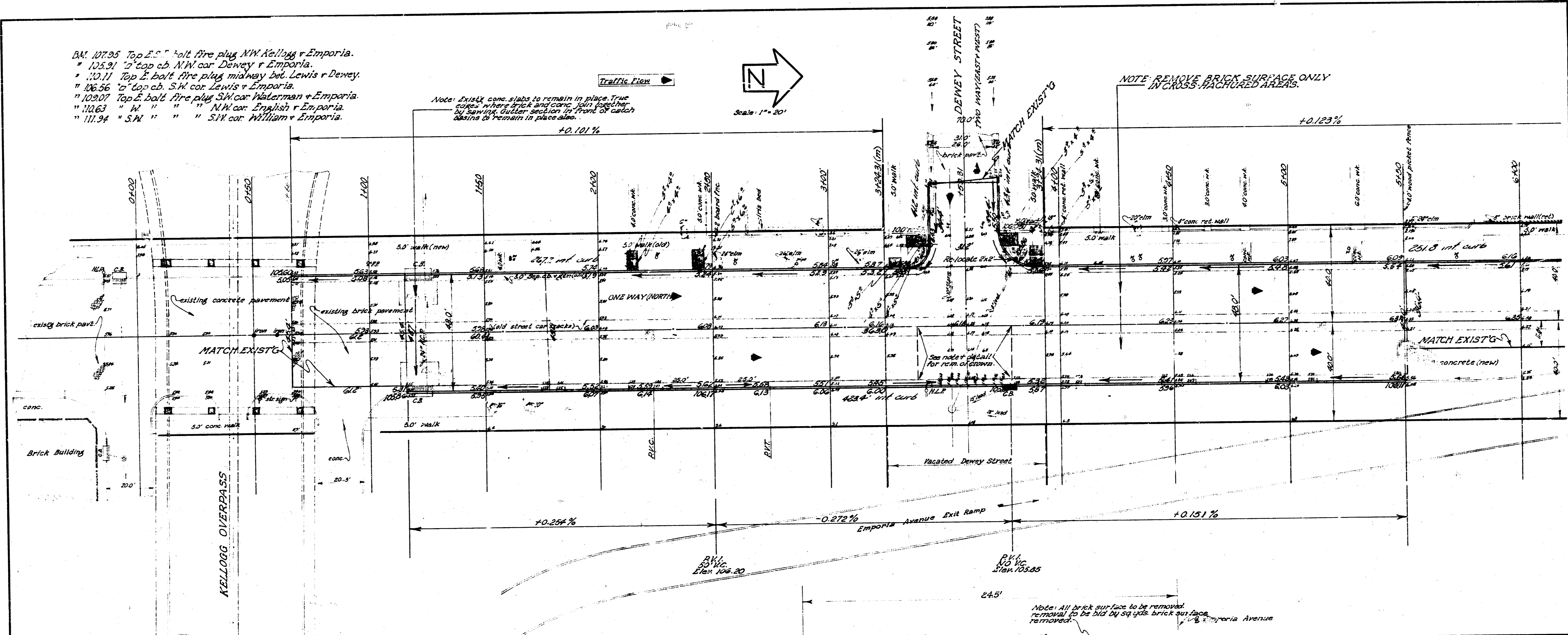

EMPORIA AVENUE
 SL Kellogg Street to SL Lewis Street
 6" Conc. & c.b. Re-improvement
 City of Wichita, Kansas
 B.E. Smith, City Engineer
 Date: Sept. 1940
 Proj. No. C10-70

1/2

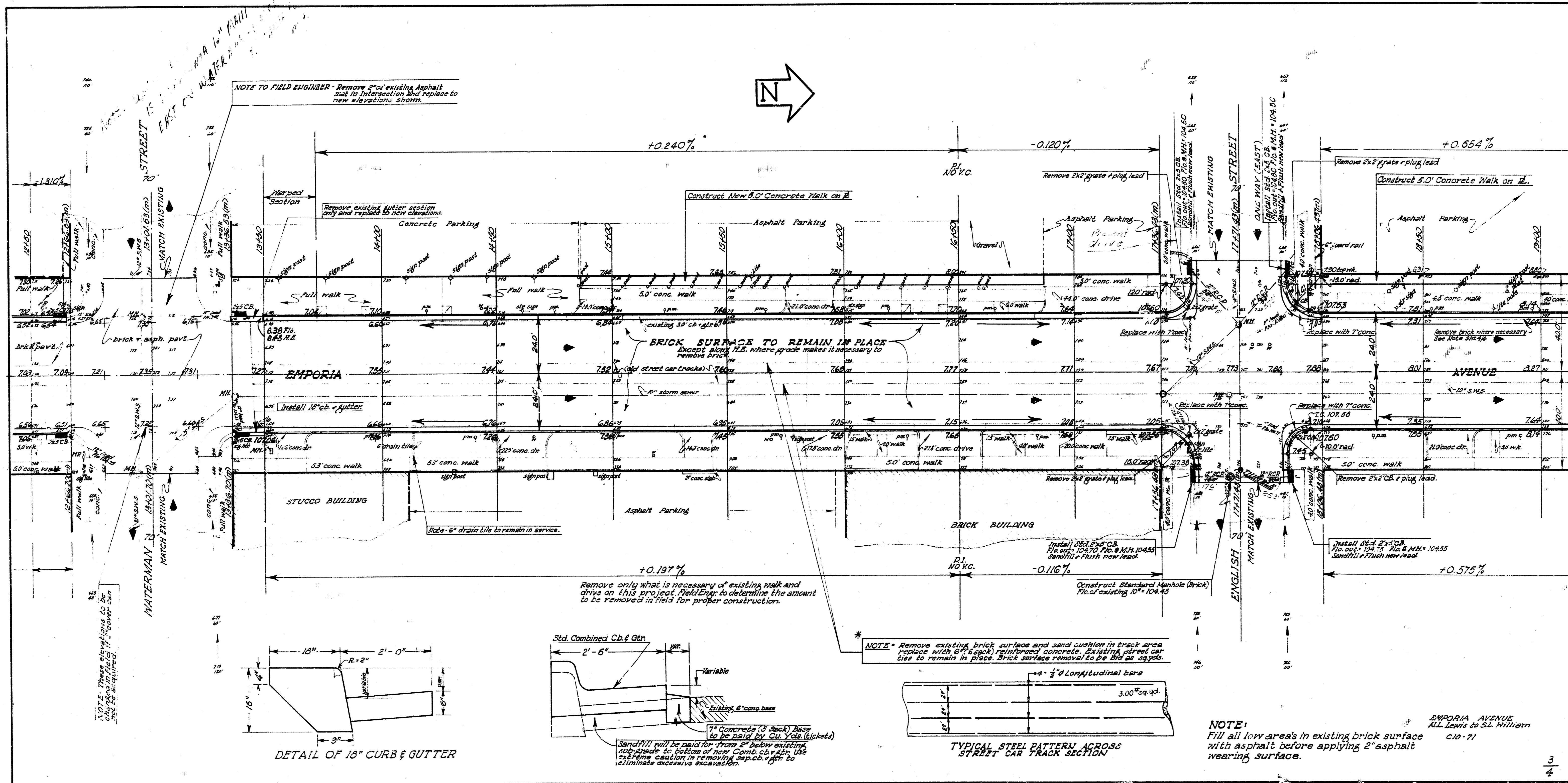



EMPORIA

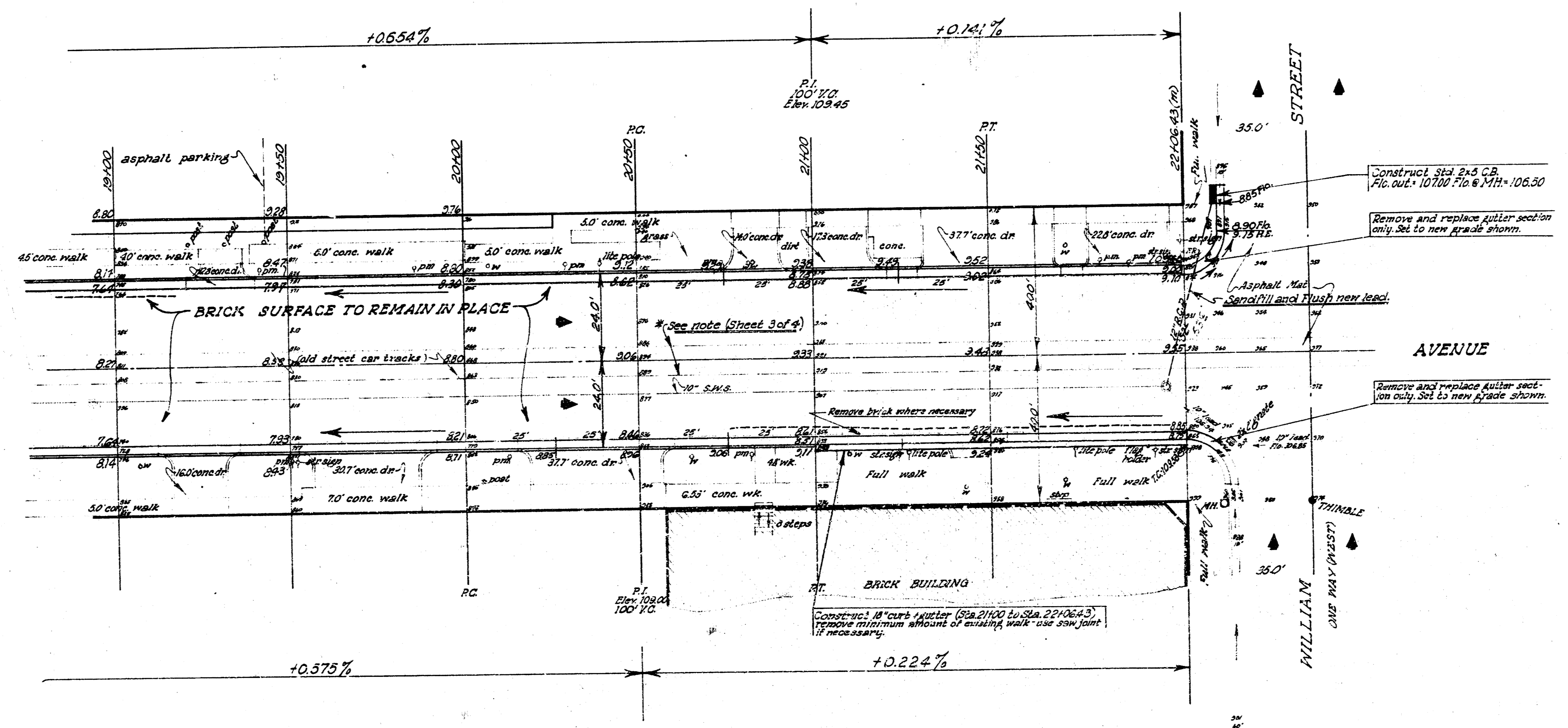

BRICK REMOVAL AT H.E. LINE
It will be necessary at various locations on project site to new H.E. elev. Field engineer to determine to field the minimum amount of removal to maintain 1/2" or more of asphalt cover at old H.E. line.