

NOTE: WK. on W.S. Estelle to match exist. drives sta. 0+00 to sta. 4+00.  
 WK. 0.4' from sta. 4+00 to sta. 6+0235.

Prop.	City
100.0	58.3
79.3	21.9
73.0	21.5
68.0	
65.2	101.2
64.1	
72.6	
77.0	
67.0	
61.5	
59.6	
65.9	
853.2	
107.0	101.1
total 938.5	total 111.3

Excav. City  
 107.0 101.1  
 total 208.1 Cu. Yds.

BM 0041 SE COR. 1<sup>ST</sup> STEP HQ# 1855 S. ESTELLE  
 BM 10076 'S' IN GLOBE S. END E. CD. ESTELLE, NL FUNSTON  
 NOTE: CHAINING SOUTH TO NORTH ON E.P.L.

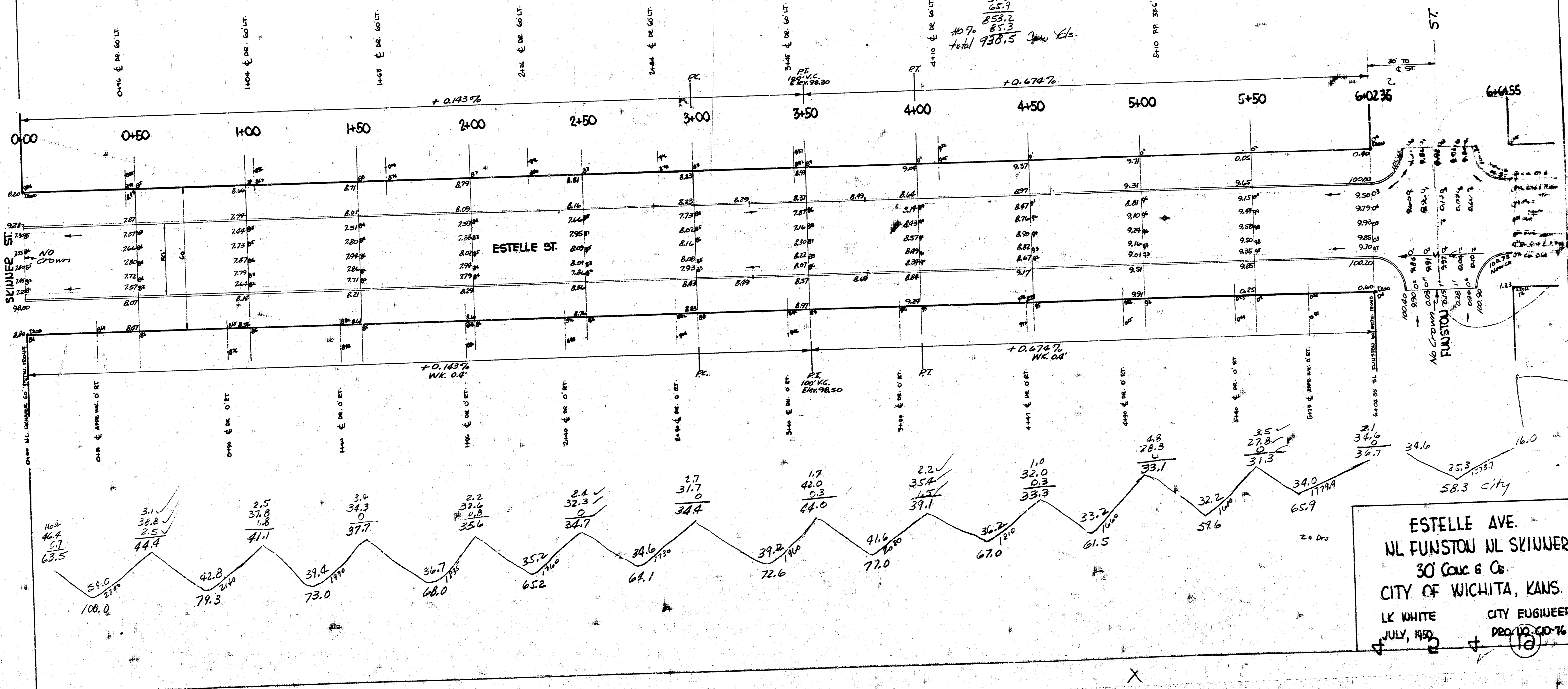

**ESTELLE AVE.**  
 NL FUNSTON NL SKINNER  
 30 COR. 6 C.  
 CITY OF WICHITA, KANS.  
 LK WHITE CITY ENGINEER  
 JULY, 1950 PROJ. 10-10-76