

BM = 106.07 R.R. spike N.S. HLP SW cor Hiram & Esthner.
 Stationing on \pm .

Ties to Iron - \pm Bonn & \pm Esthner
 Iron - 1" steel pin 4" deep
 85.7 SW to NE cor House
 93.2 SE to NW cor House

NOTE:
 See proj. No C16-93, HIRAM,
 May Ave. to Orient Blvd.
 for intersection.

Ties to Iron - \pm Hiram & \pm Esthner
 Iron - 1" steel pin - 5" deep
 38.9 N to S Face House W
 60.4 W to E Face House N
 29.0 SW to Rec St. Gite Pole.

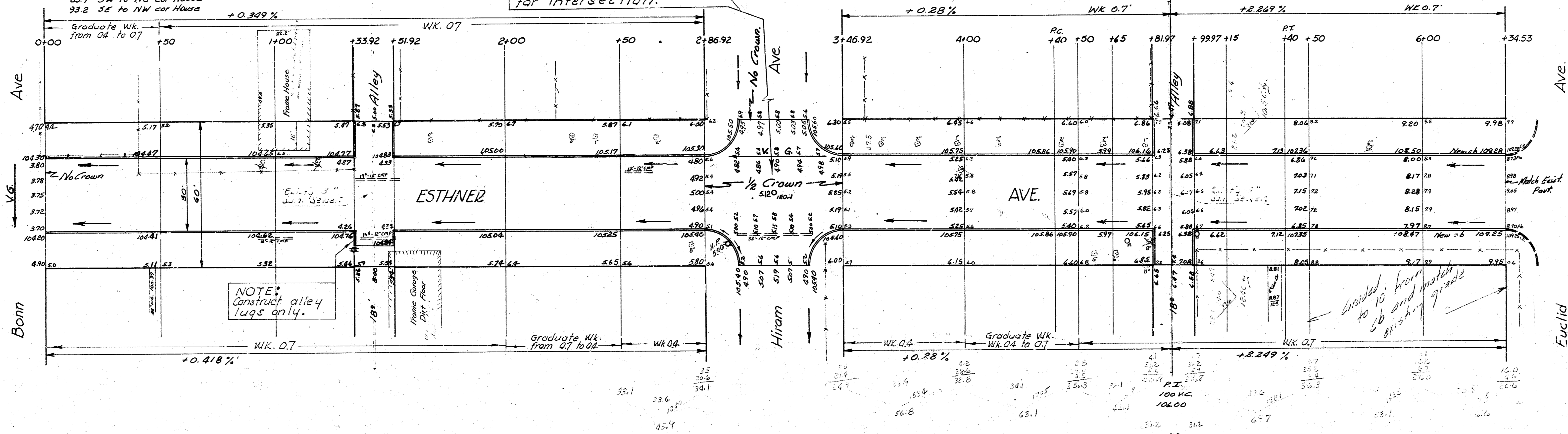

NOTICE TO CONTRACTOR:
 All entrance pipes are to be disposed of in
 accordance with instructions of City Dil Checker.

Excavation Totals	
Property	67.4
730.1	77.3
73.0	7.7
833.1	85.0 cu yds

NOTE:
 Field Engineer is to re-X-Section
 prior to excavation.
 Prop. fill, estimated at
 10 cu. yds.

Sheet 1 of 2



ESTHNER AVE.
 EL Bonn to WL Euclid
 30' Conc & Cb
 CITY OF WICHITA, KANSAS
 B.E. SMITH CITY ENGINEER
 JULY 1980 PROJ NO C16-95