

B.M. 133.55 4" in Globe E. cb. of Grove S.L. 21st
 B.M. 148.57 Iron N.L. 22nd E.L. Poplar
 B.M. 168.76 Knurled 60° spike S.W. side cor. post & 25th - & Volusia N.

STATIONING ON S.R.
 CURVE DATA FOR 9' OFFSET FROM S.R.
 R = 685.05
 Δ = 40° 21' on S.R. and 40° 46' 38" on N.R.
 D = 81° 21' 43"
 L = 484.44'
 Deflect for 1' Arc = 2.5091'

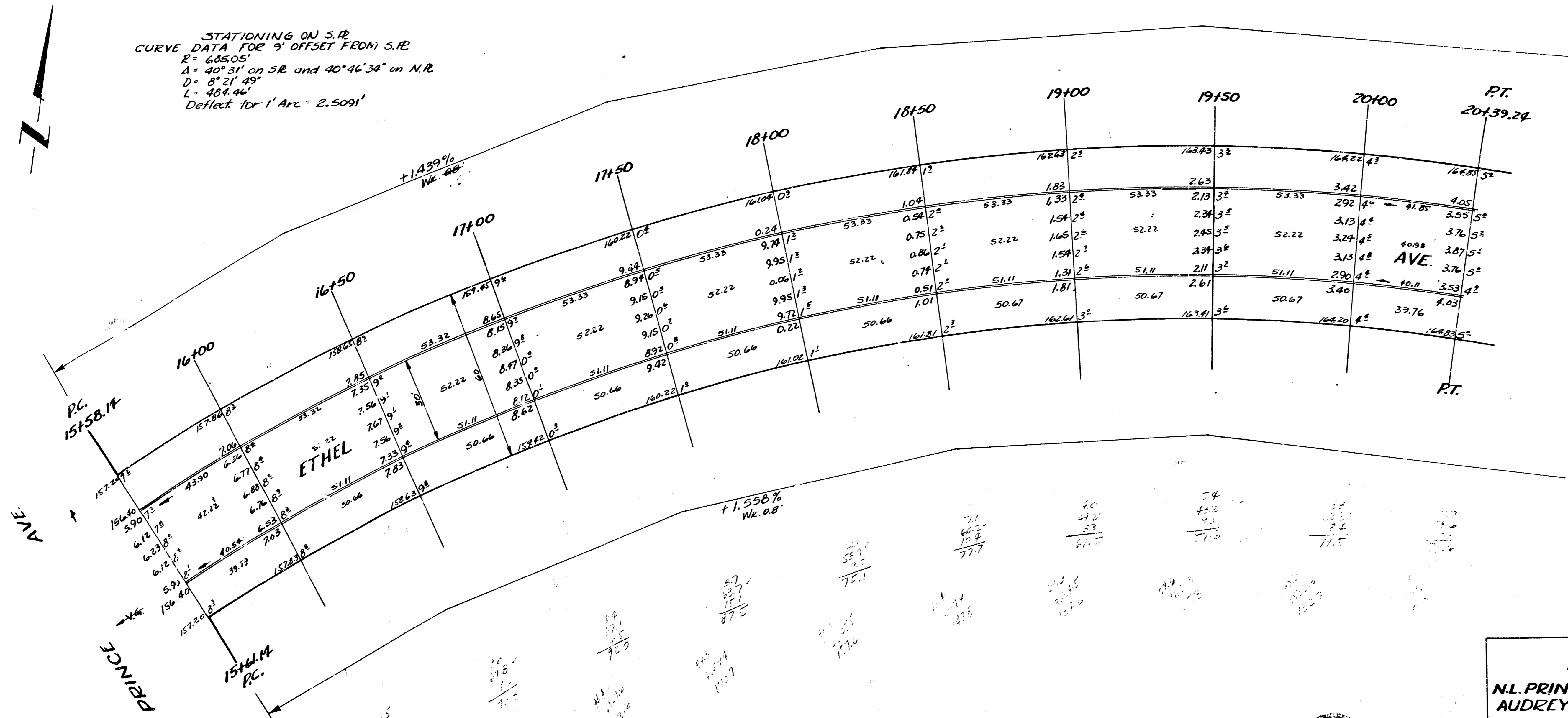

1/2

ETHEL
 N.L. PRINCE - S.L. 1017, BLOCK V
 AUDREY MATLOCK HTS. 1st
 30' CONC. & CB.
 CITY OF WICHITA, KANS.
 L.K. WHITE CITY ENGINEER
 APRIL 1951 PROJ. NO. C11-67

