

Sta On 4
 BM 95.647 Standard - N.E. Cor. Glenn # 31 st. St. So.
 BM 96.64 N.E. Cor. 1st Conc. Stop, Ho. N.W. Cor. Hiram # 33rd St. So.

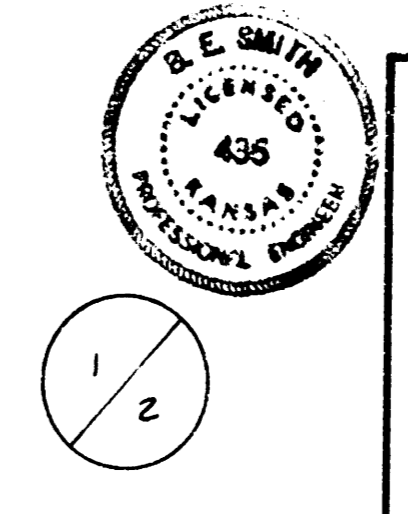

Euclid Ave.
 N.L. 35 TH ST. SO. TO S.L. 33 RD ST. SO.
 26-2-30 AC.
 CITY OF WICHITA, KANSAS
 B.E. SMITH CITY ENGINEER
 March 1956 PROJ. NO. C 15-69

J. Young, Inc. 1956
 B. E. Smith
 Mechanical Engineering

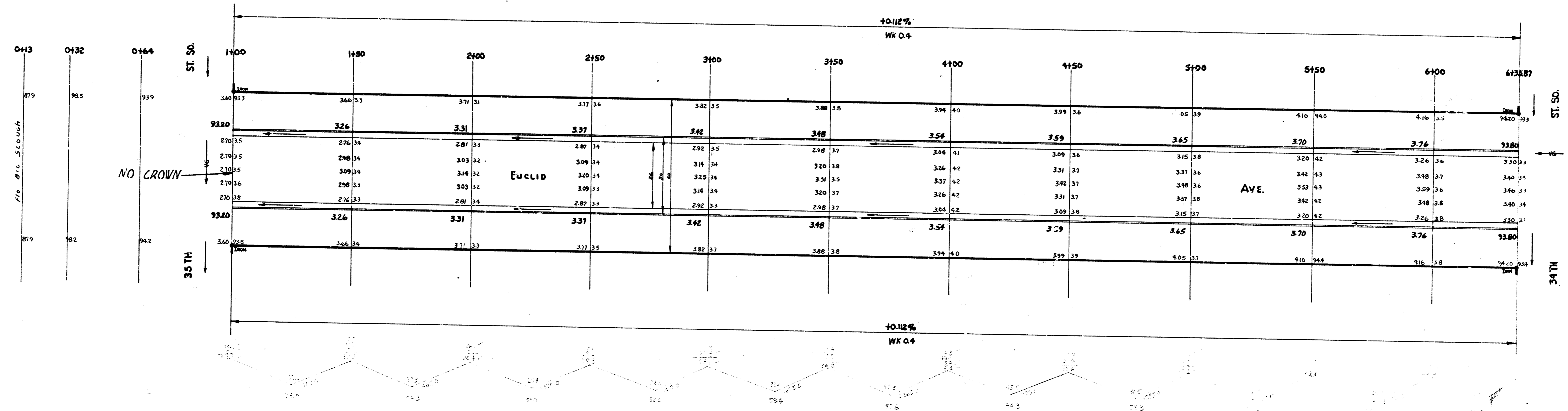
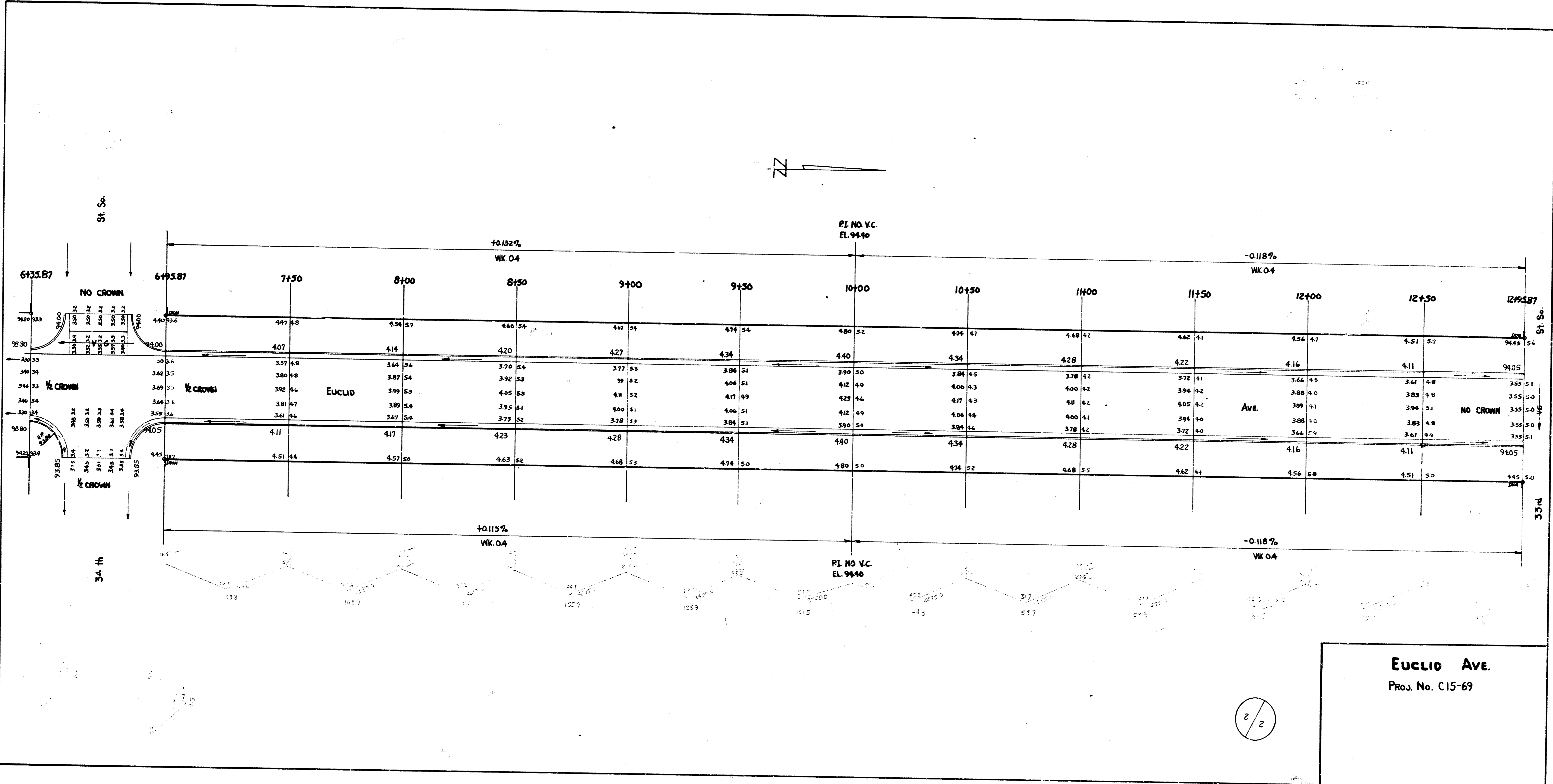
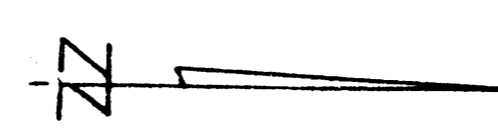

EUCLID AVE.
Proj. No. C15-69

