

B.M. 100.985 N.E. Cor. Conc. Porch Ho 2203 W 27<sup>TH</sup> St. Everett  
 B.M. 99.667 Sid. N.E. Cor. Meridian & 27<sup>TH</sup>  
 Stationing: Base Line East Prop. Line.

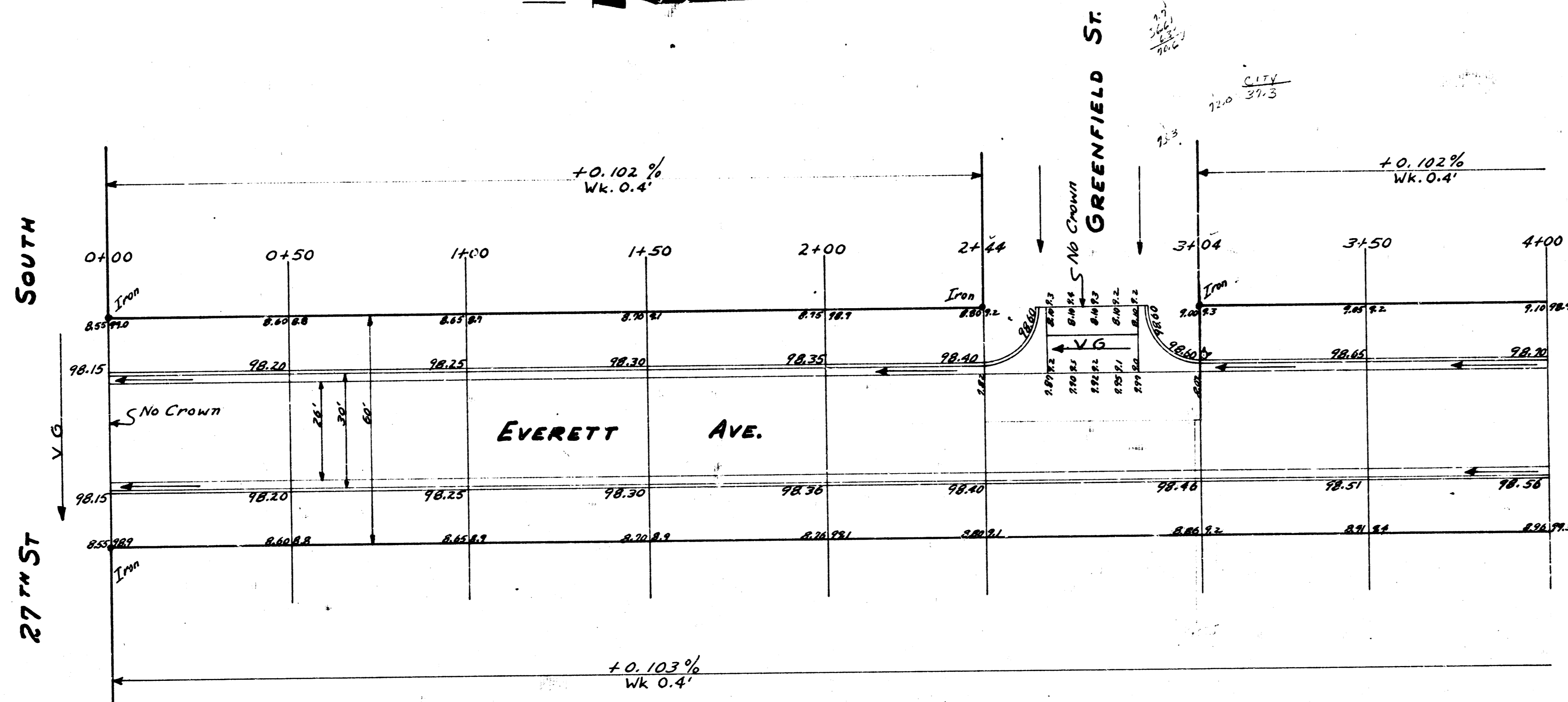

B.M. 100.985  
 B.M. 99.667  
 Stationing: Base Line East Prop. Line.

PROPERTY  
 1611.6  
 +10% 161.2  
 1117.8 CU. 105 CUT

CITY  
 224.8  
 +10% 22.5  
 247.3 CU. 105 CUT

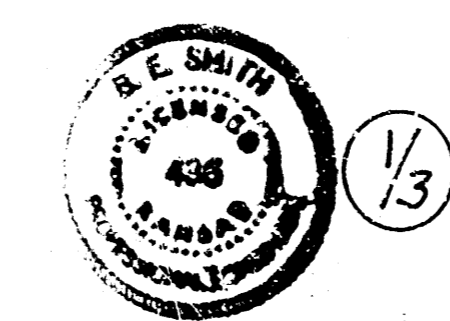

**EVERETT**  
 N.L. 27<sup>TH</sup> ST. SOUTH TO N.L. ANITA  
 26-2-30-A.C.  
**CITY OF WICHITA KAN.**  
 B.E. SMITH CITY ENGINEER  
 SEPT. 1955 PROJ. No. C14-241

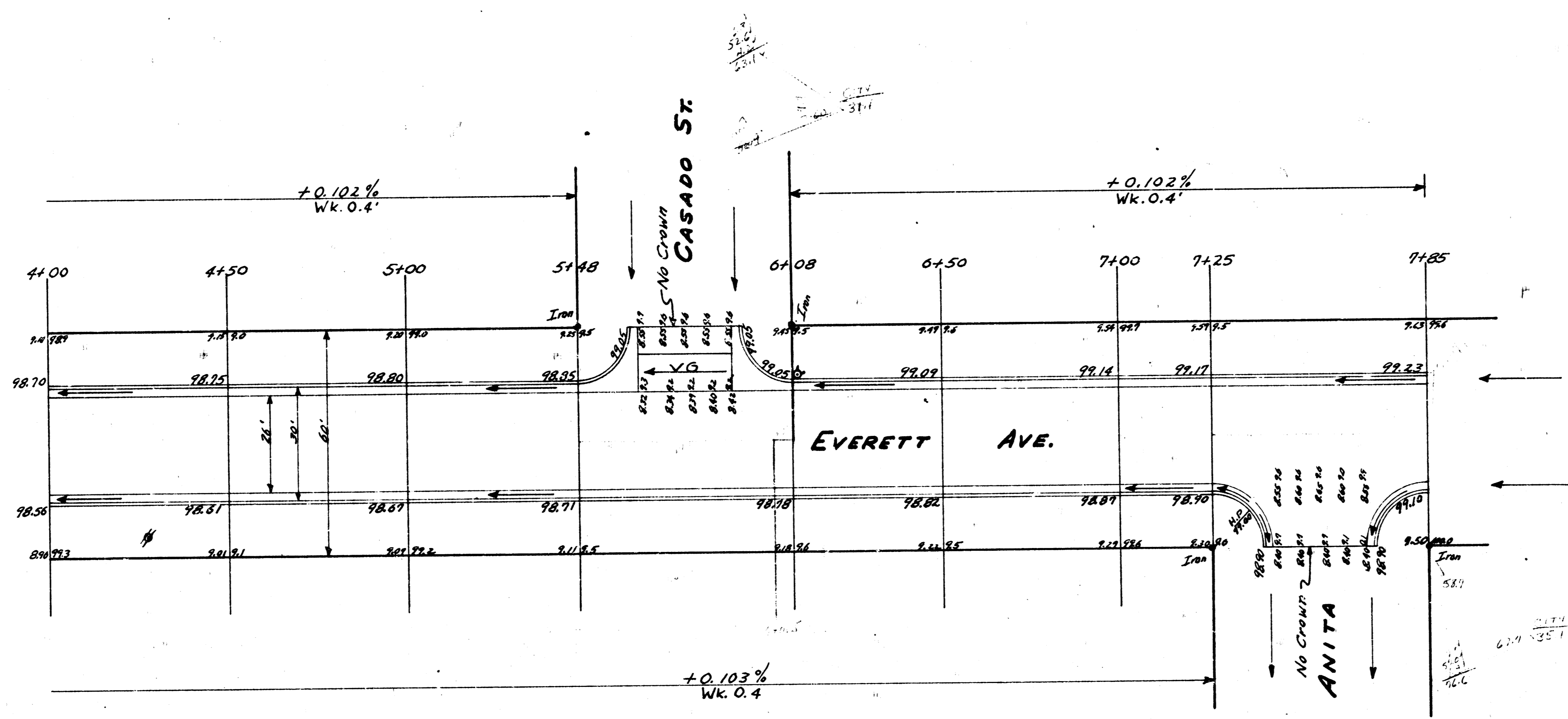

**EVERETT**  
 N.L. 27<sup>TH</sup> ST SOUTH TO N.L. ANITA