

B.M. 99.337 Std. NE. Cor. Meridian & 27<sup>th</sup>  
 B.M. 101.985 NE. Cor. Conc. Porch. No. 2203 W 27<sup>th</sup>  
 B.M. 102.00 NE. Cor. Conc. Porch. 1<sup>st</sup> Ho Facing East North Of Savannah K.S. Everett  
 B.M. 101.87 NE. Cor. Conc. Porch. 1<sup>st</sup> Ho Facing East South Of Pawnee W.S. Everett  
 B.M. 103.51 Std. NE. Cor. Pawnee & Meridian  
 Stationing & Base Line East Prop Line

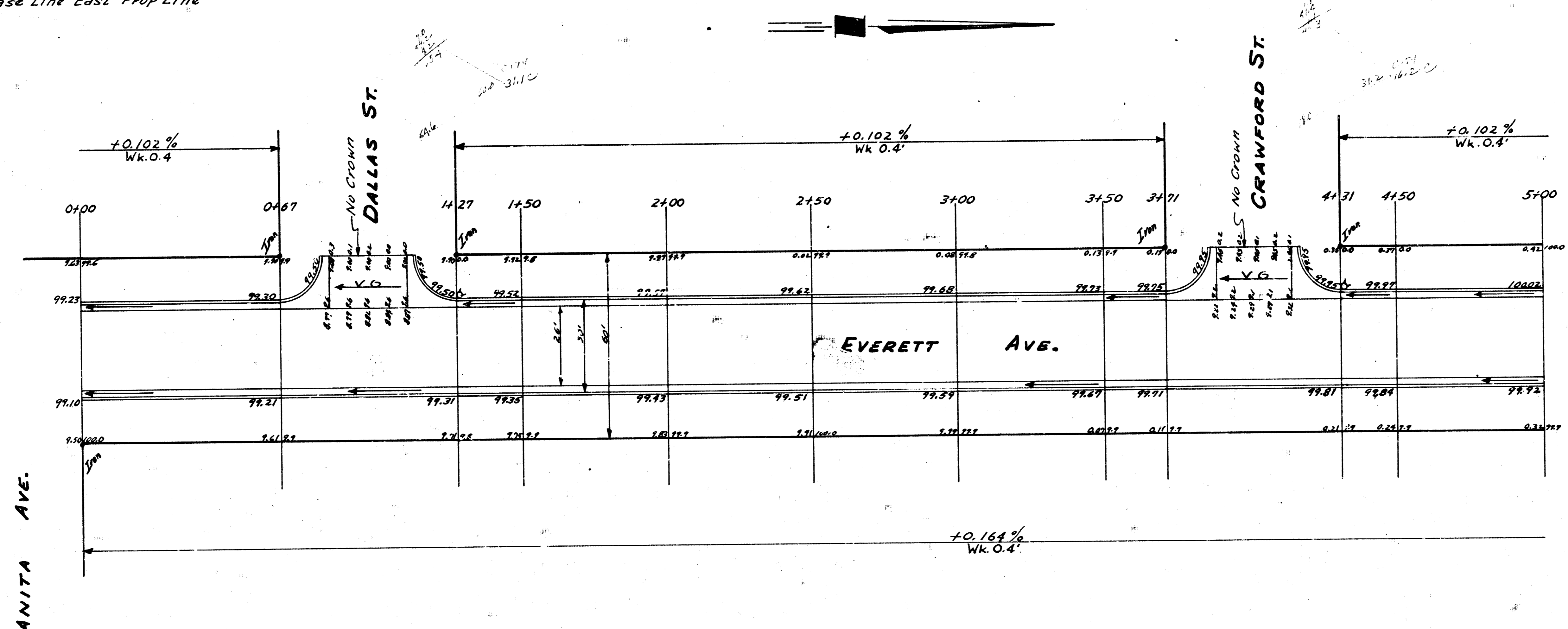

CITY 224.0  
 PROPERTY 67.9.0  
 + 4.0' 22.0' 691.9' CURVES CUT



**EVERETT**  
 N.L. ANITA To N.L. SAVANNAH  
 26-2-30-AC.  
 CITY OF WICHITA KAN.  
 B.E. SMITH CITY ENGINEER  
 OCT. 1955 Proj. C14-242

1/4

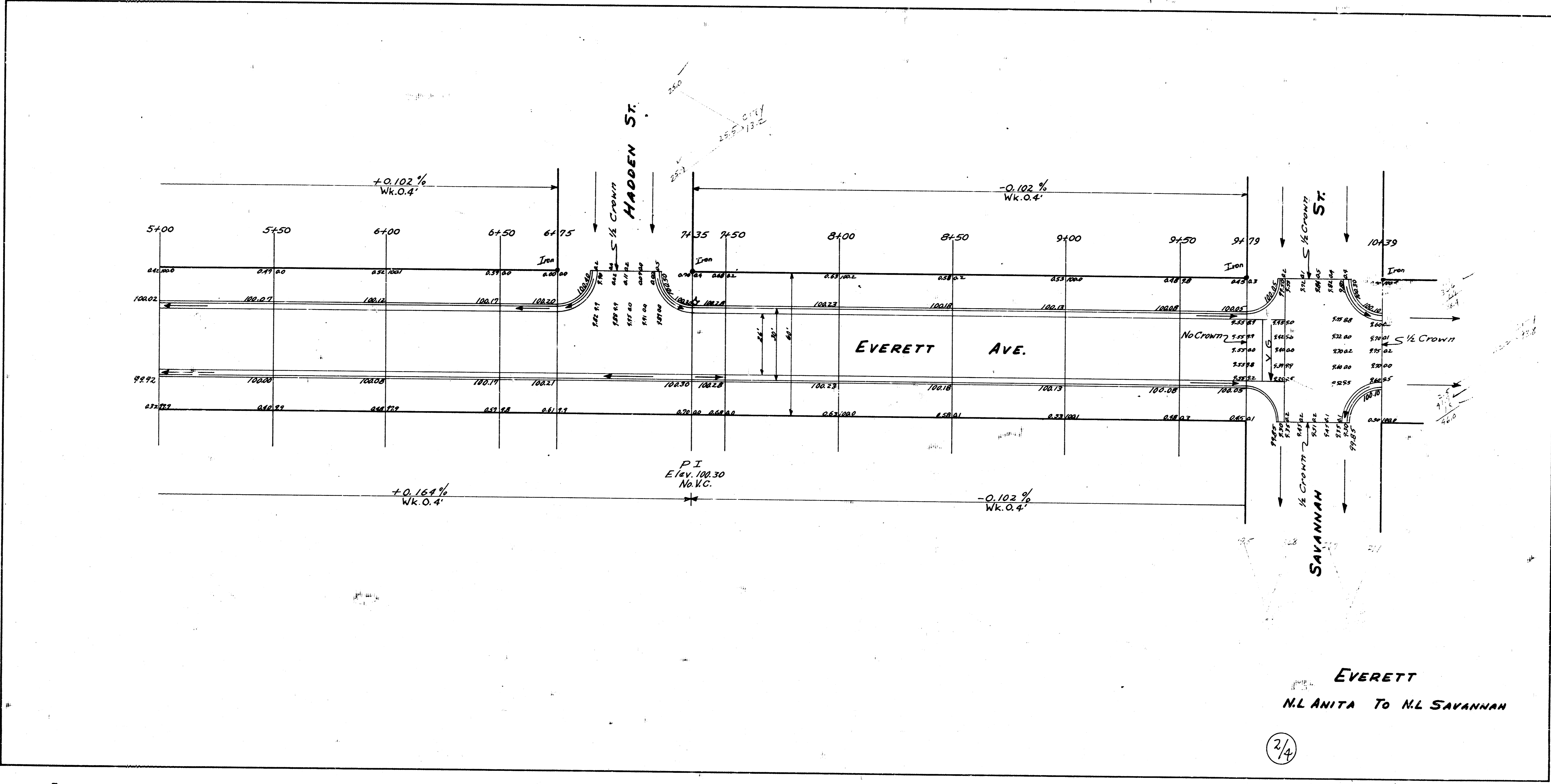

EVERETT  
 N.L. ANITA TO N.L. SAVANNAH