

**INTERSECTION RECONSTRUCTION  
HENDRYX AND OSAGE  
OSIE AND PALISADE**

**PROJECT NO. 818-58-192-50207-430-102-000**

**CITY OF WICHITA, KANSAS**

**M. E. LINDEBAK - CITY ENGINEER**

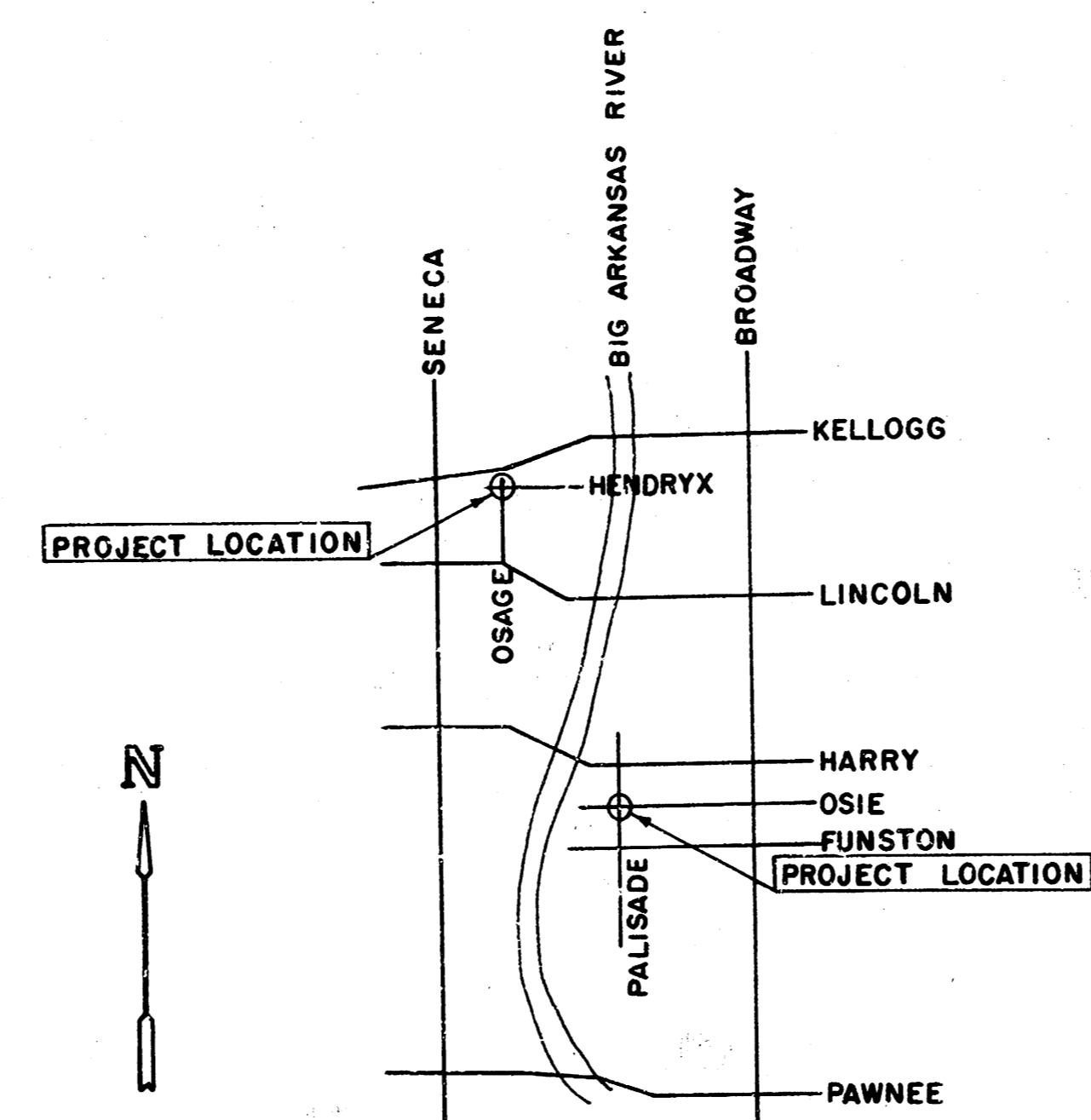

*NOTE: EXCAVATION; BORROW, IF ANY; AND COMPACTED FILL, EXCEPT THE COMPACTED FILL IN THE 6 INCHES IMMEDIATELY UNDER THE PAVEMENT, SHALL BE INCIDENTAL TO OTHER BID ITEMS OF WORK.*

**INDEX**

CONSTRUCTION DETAILS	SHEETS 2
HENDRYX & OSAGE PLAN	SHEET 3
OSIE & PALISADE PLAN	SHEET 4

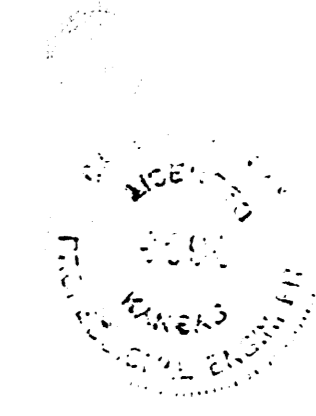

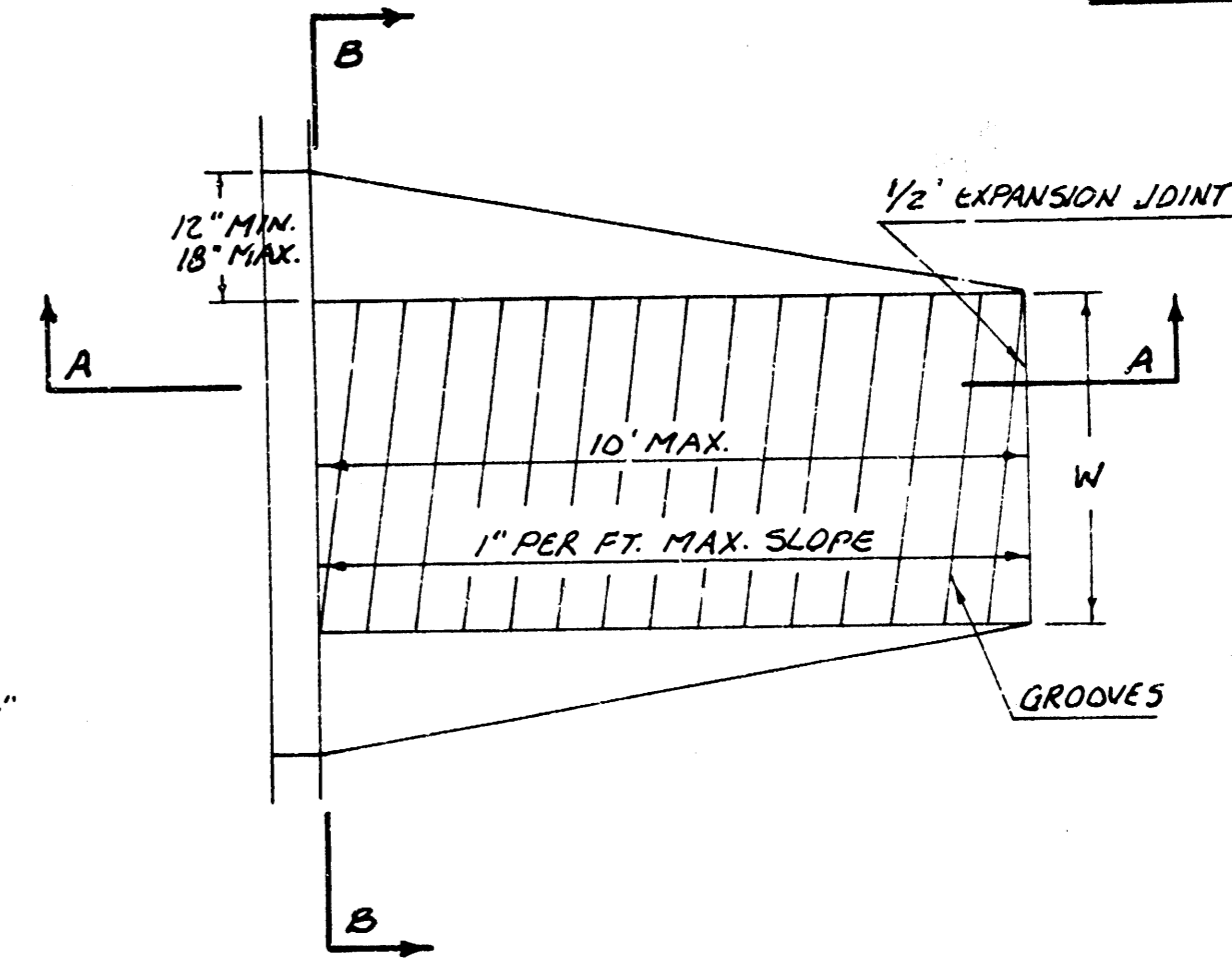
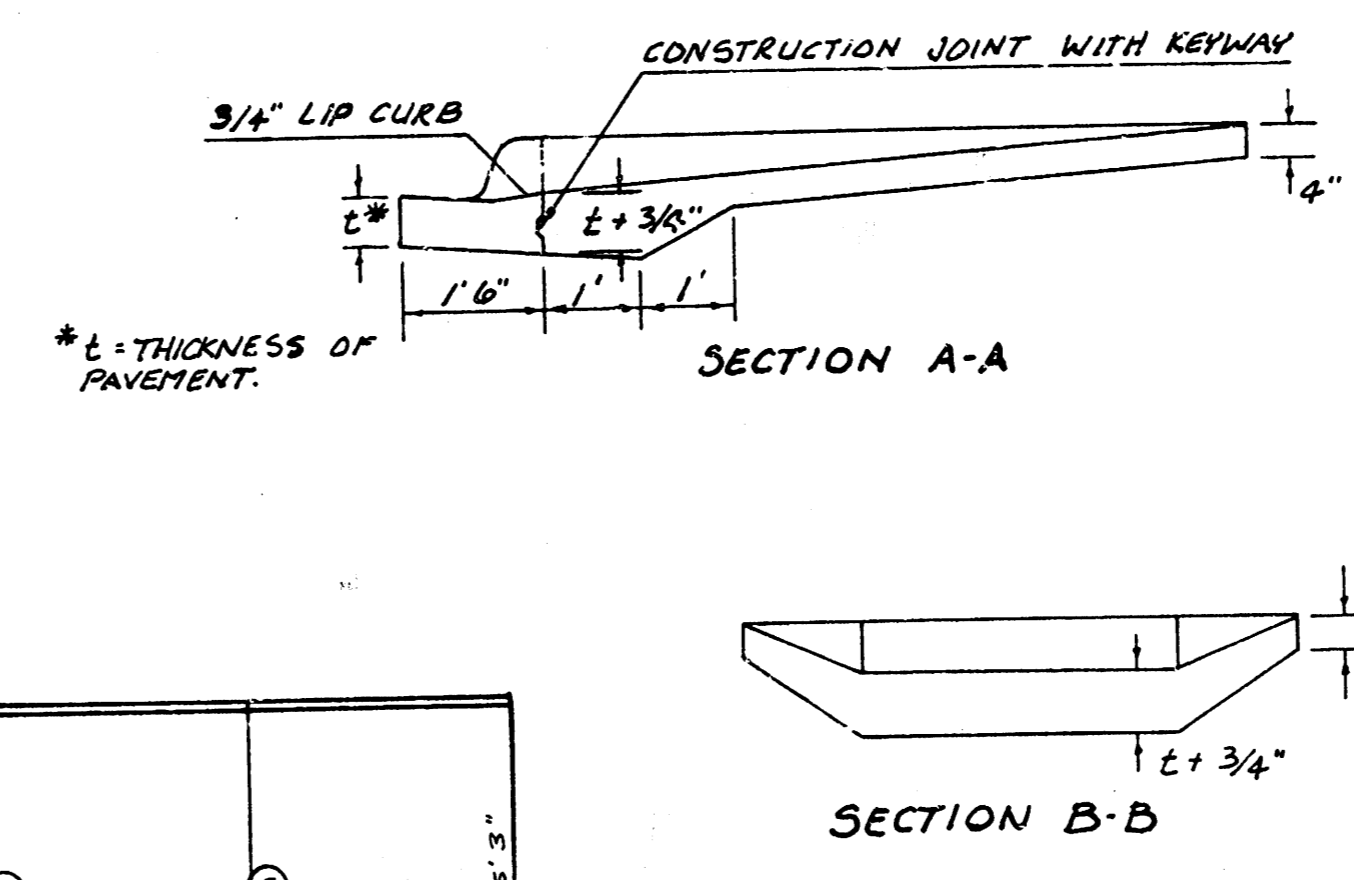
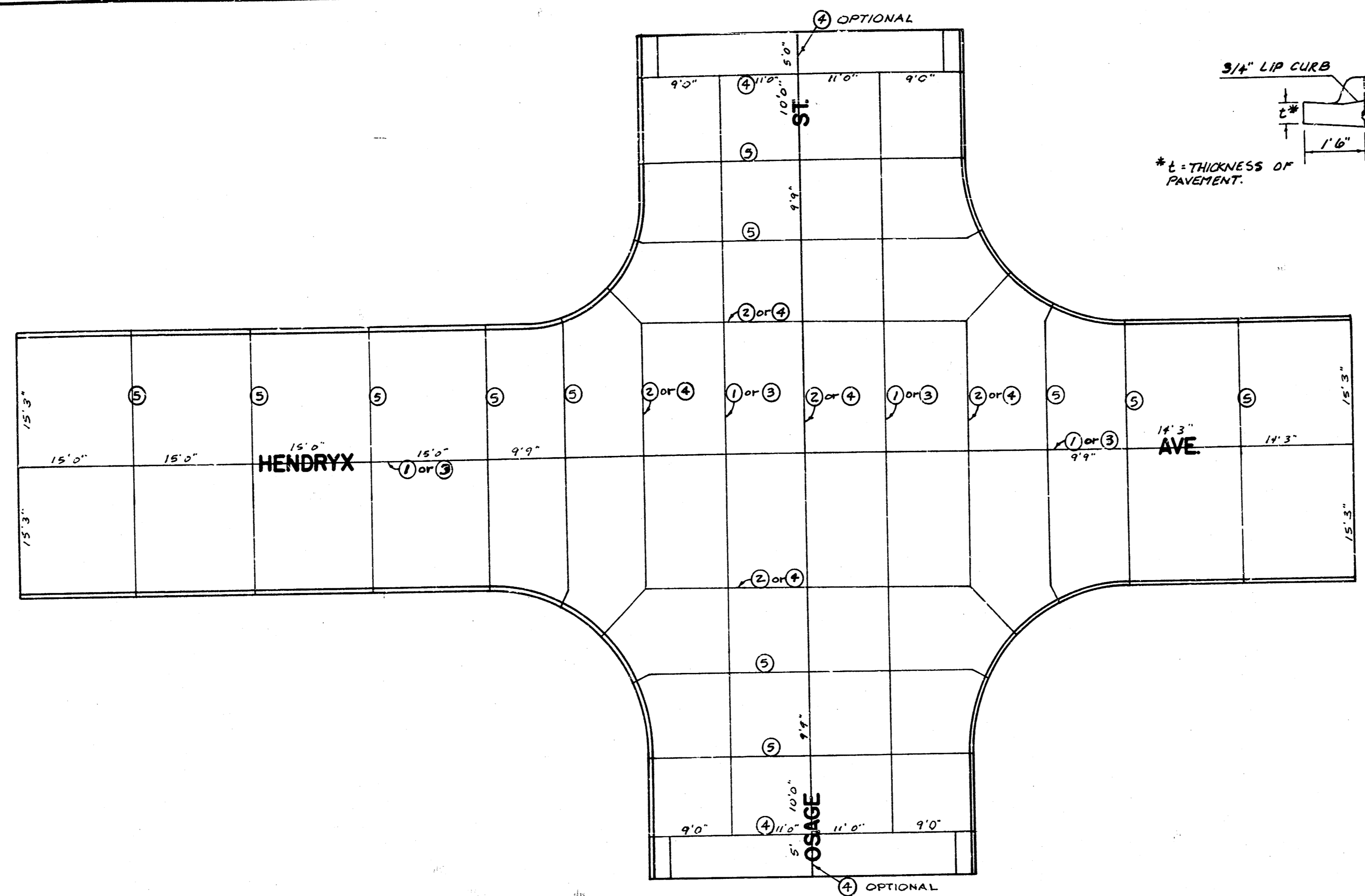

STANDARD WHEELCHAIR RAMP CONSTRUCTION DETAIL

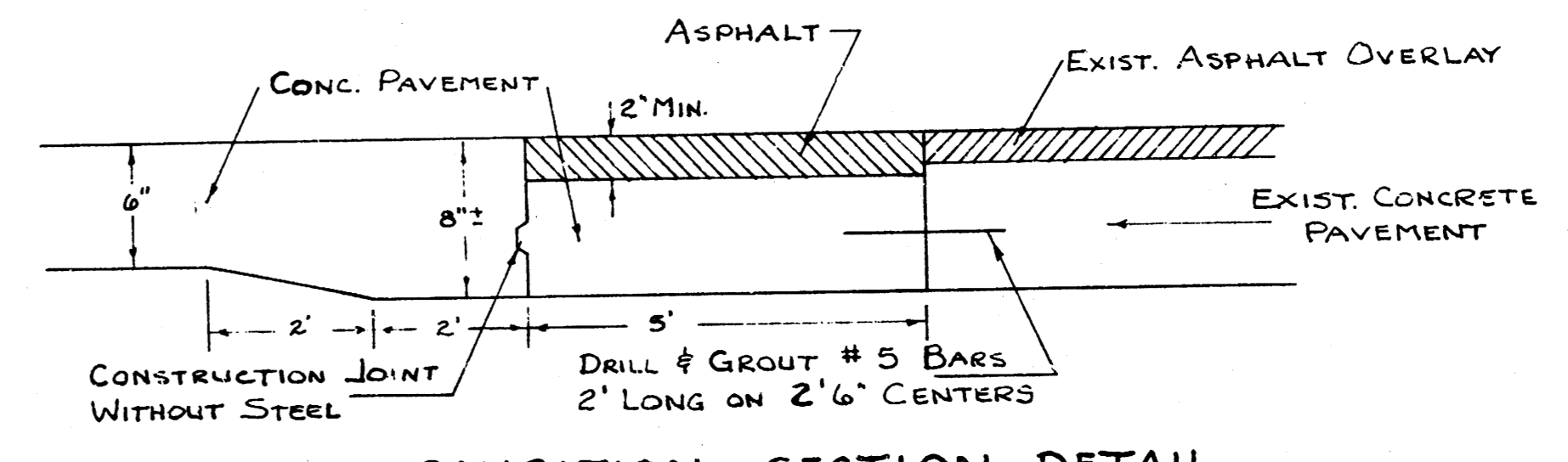

TRANSITION SECTION DETAIL

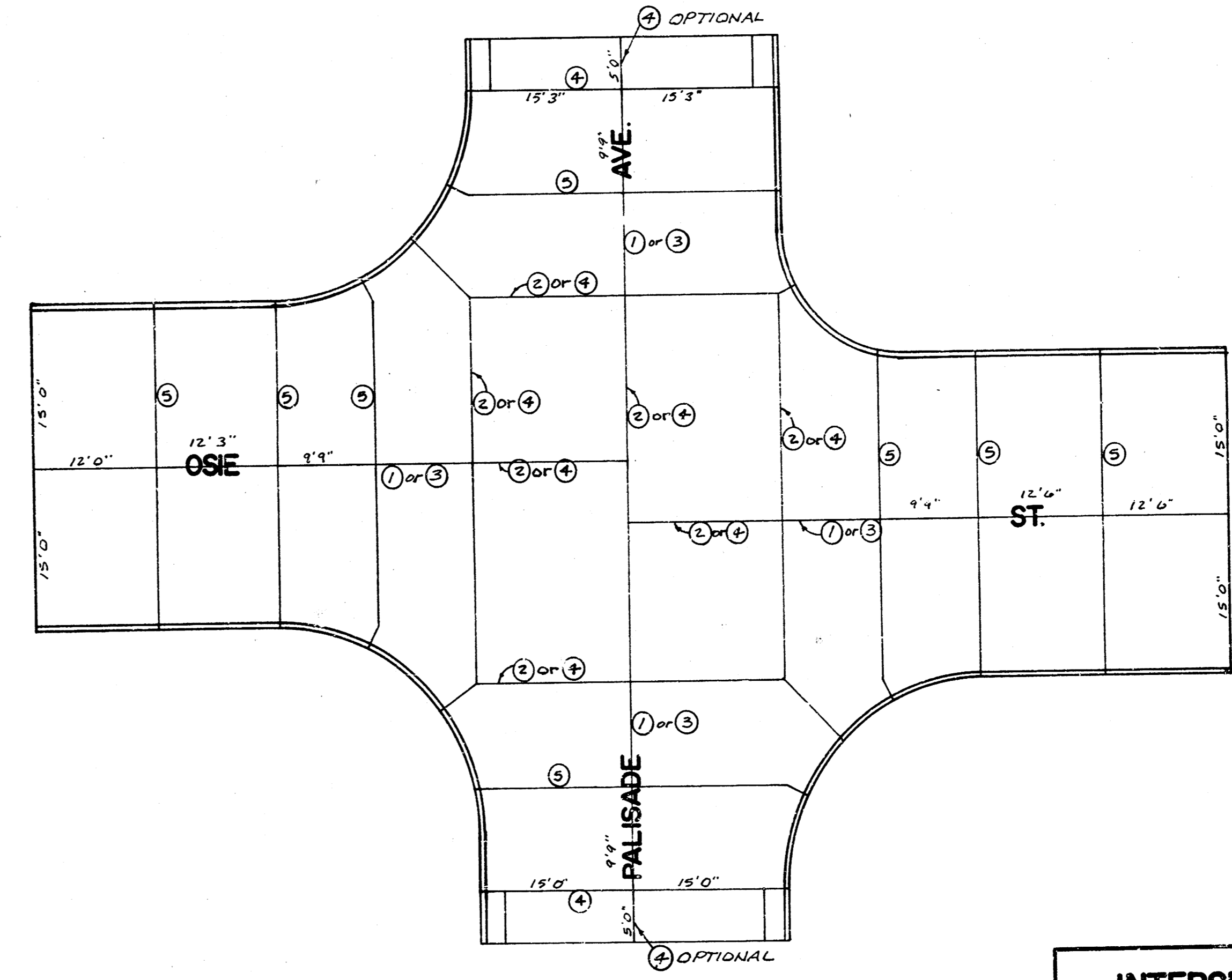

- ① SAWED LONGITUDINAL JOINT WITH STEEL
- ② SAWED LONGITUDINAL JOINT WITHOUT STEEL
- ③ CONSTRUCTION JOINT WITH STEEL
- ④ CONSTRUCTION JOINT WITHOUT STEEL
- ⑤ SAWED CONTRACTION JOINT
- ⑥ EXPANSION JOINT

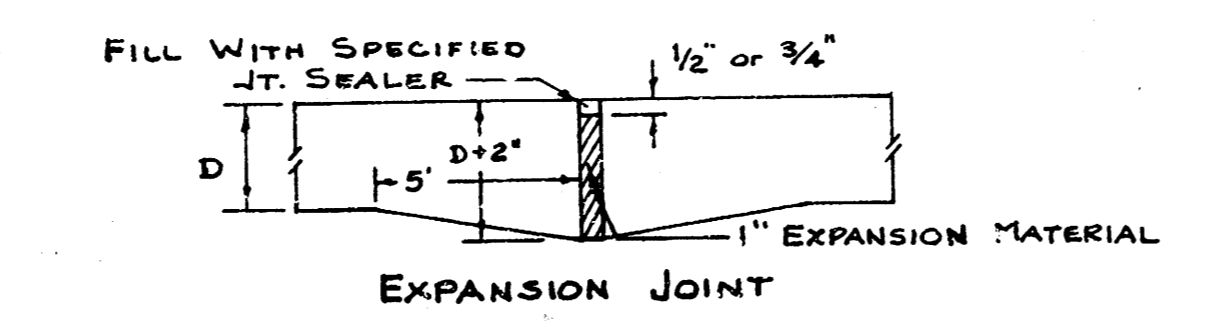
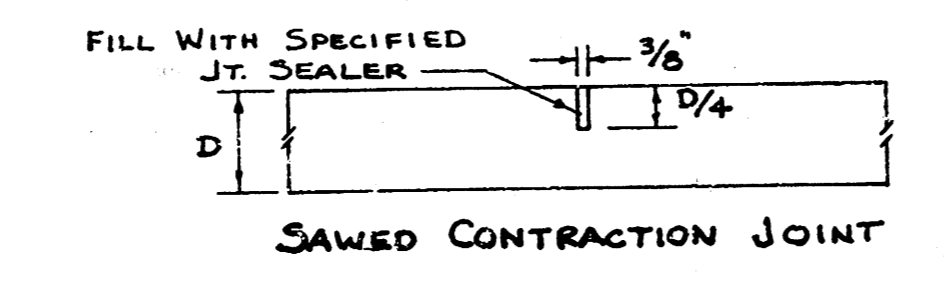
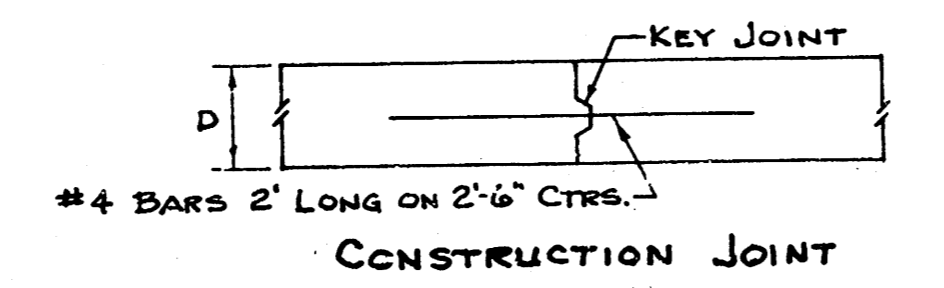
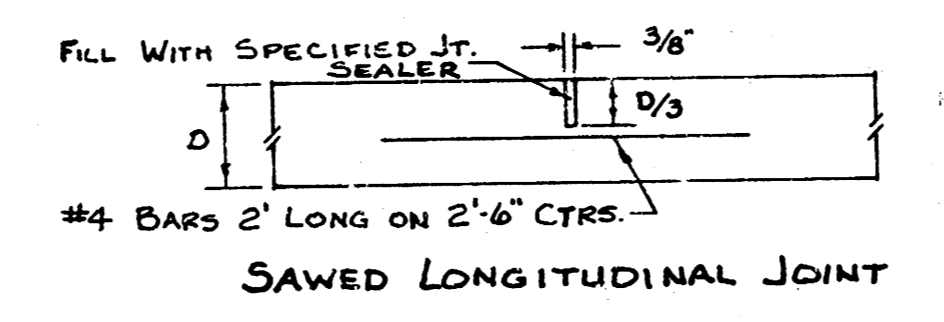

JOINT DETAILS

PROJECT DESCRIPTION  
**INTERSECTION RECONSTRUCTION**  
**CONSTRUCTION DETAILS**  
 PROJECT NUMBER  
 818 58 192 50207 430 102 000 2/4

BM 10722 Seneca & McCormick, Brass Rod in conc. post.  
 NW cor. 32' N of 223' W of & both.  
 B.M. 11034 NE cor. bottom conc. step, house @ S.W. cor.  
 Hendryx & Osage, 803 W. Hendryx.

1108-40

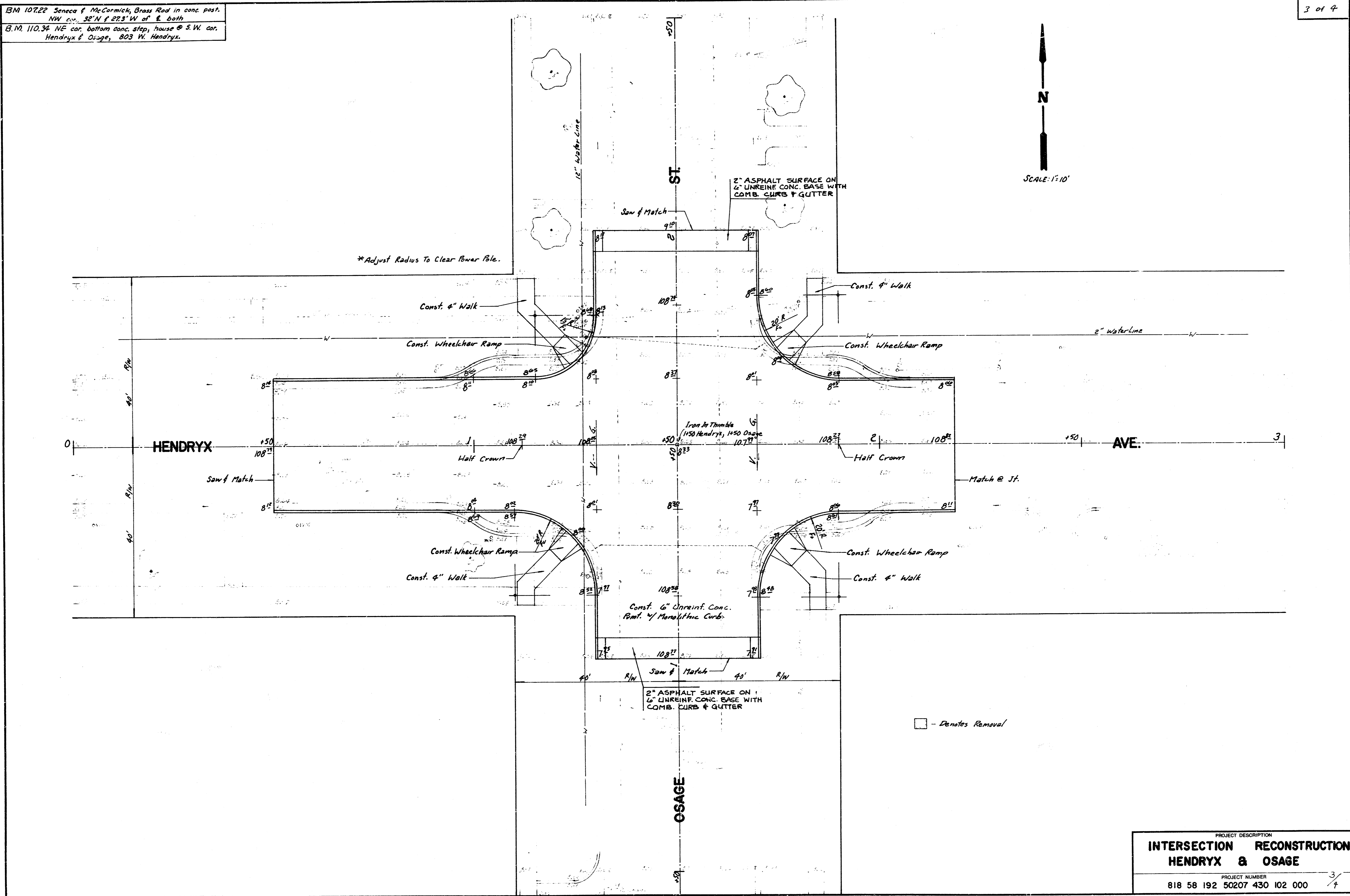

SCALE: 1"=10'

PROJECT DESCRIPTION  
**INTERSECTION RECONSTRUCTION**  
**HENDRYX & OSAGE**  
 PROJECT NUMBER  
 818 58 192 50207 430 102 000 3/4

