

BM 85.76 Standard SE Cor. Seneca f 31<sup>st</sup> St. So.  
 Base Line of Stationing On E. of Alley

Scale 1"=20'

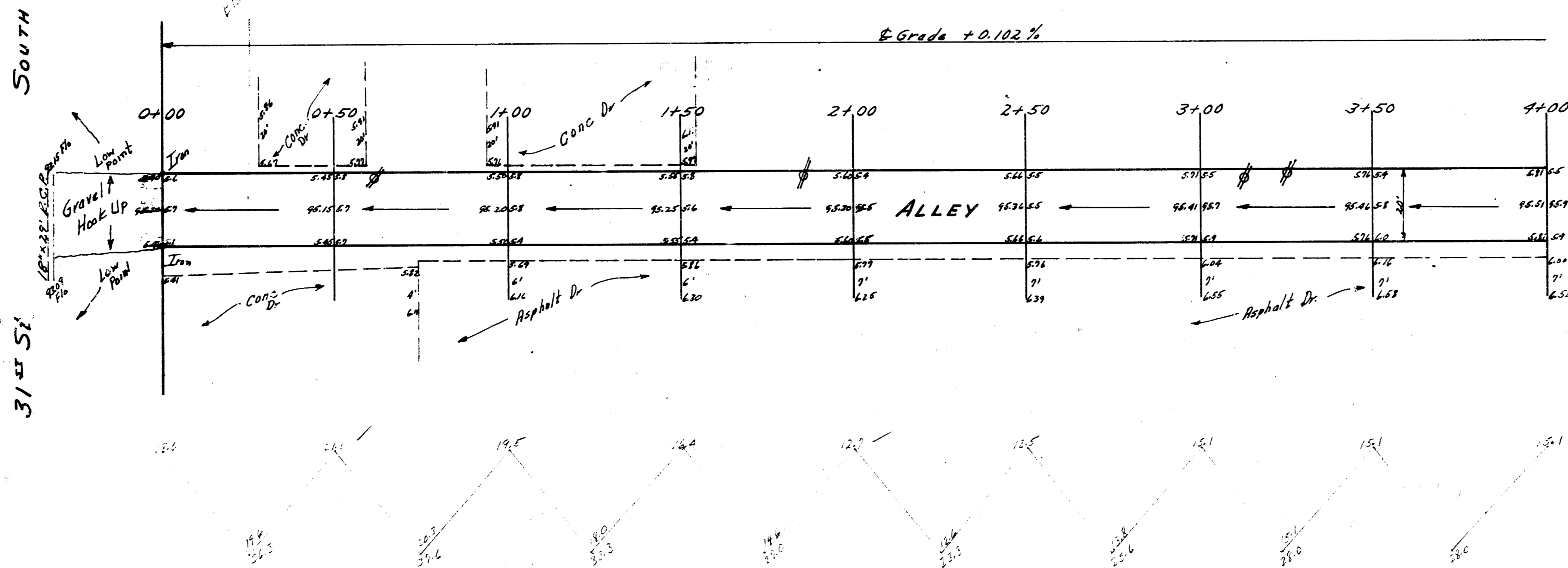
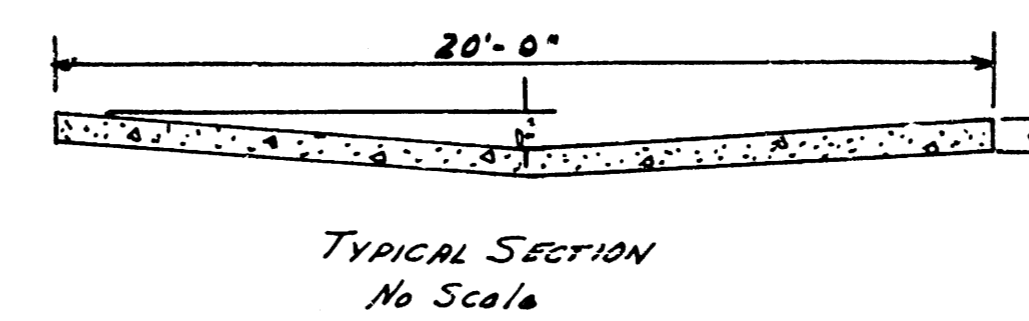
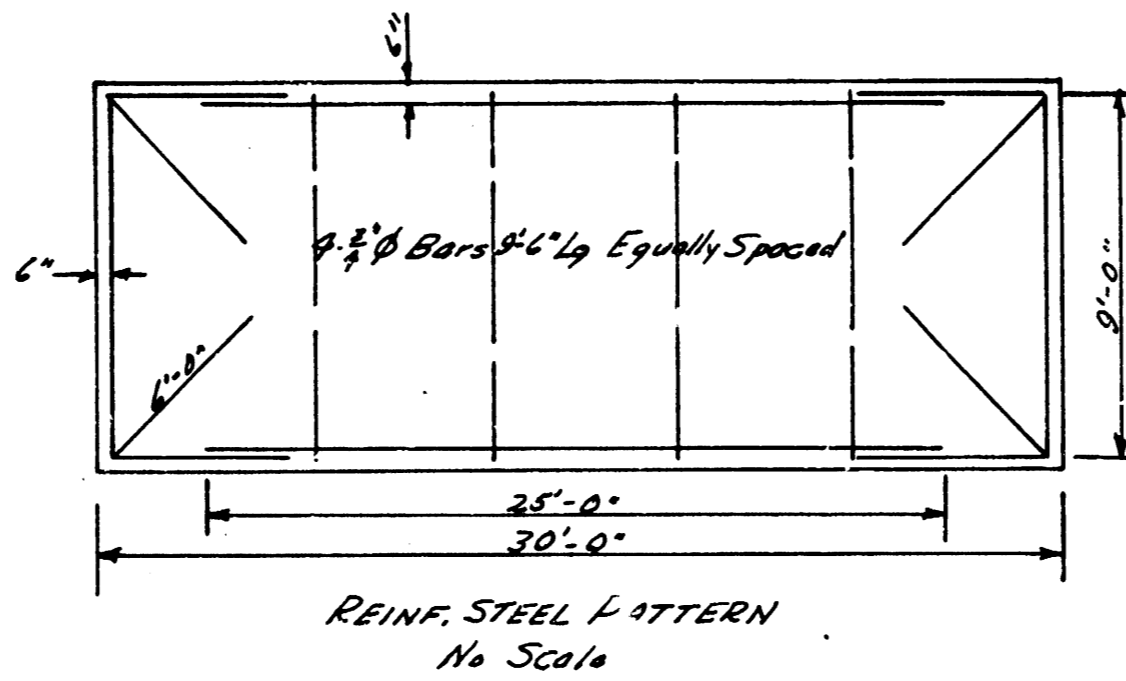

Property  
 199.6  
 + 107.8 = 307.4  
 899.6 Cont'd

371  
 45.7  
 1107.4 = 1143.1  
 50.3 Cont'd



1/3

**ALLEY WEST OF SENECA**  
 N.L. 31<sup>ST</sup> TO W.L. SENECA  
 20' CONC. 7" THICK  
**CITY OF WICHITA KAN**  
**BE SMITH** CITY ENGINEER  
 AUG. 1956 Proj. No. C16-104

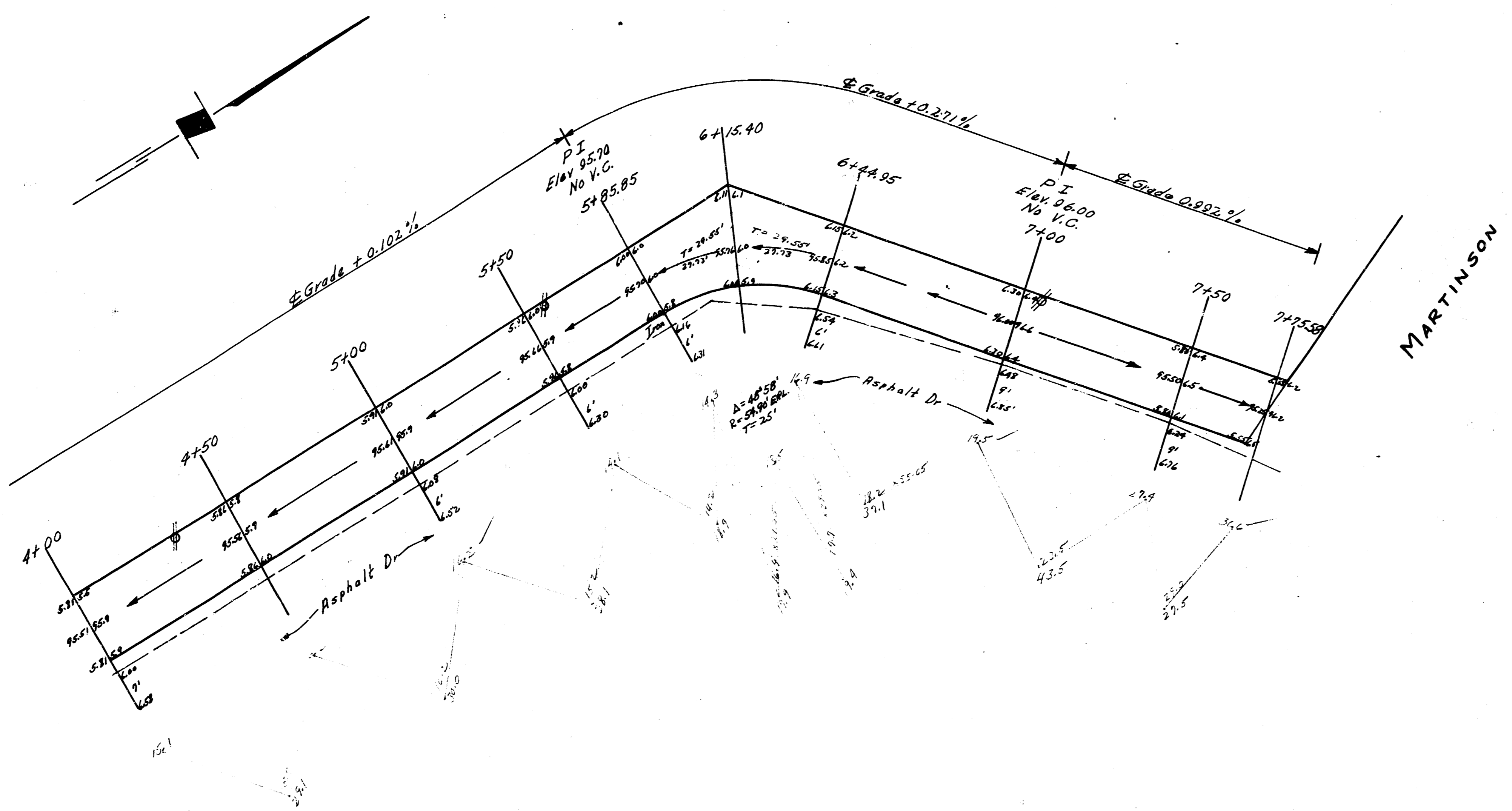

ALLEY WEST OF SENECA

N.L. 31<sup>ST</sup> TO W.L. SENECA

D.M. 95.76 Stand. S.E. Cor Seneca & 31st St. S.

Chaining & Sta on E Alley

Manson  
D.E.L.

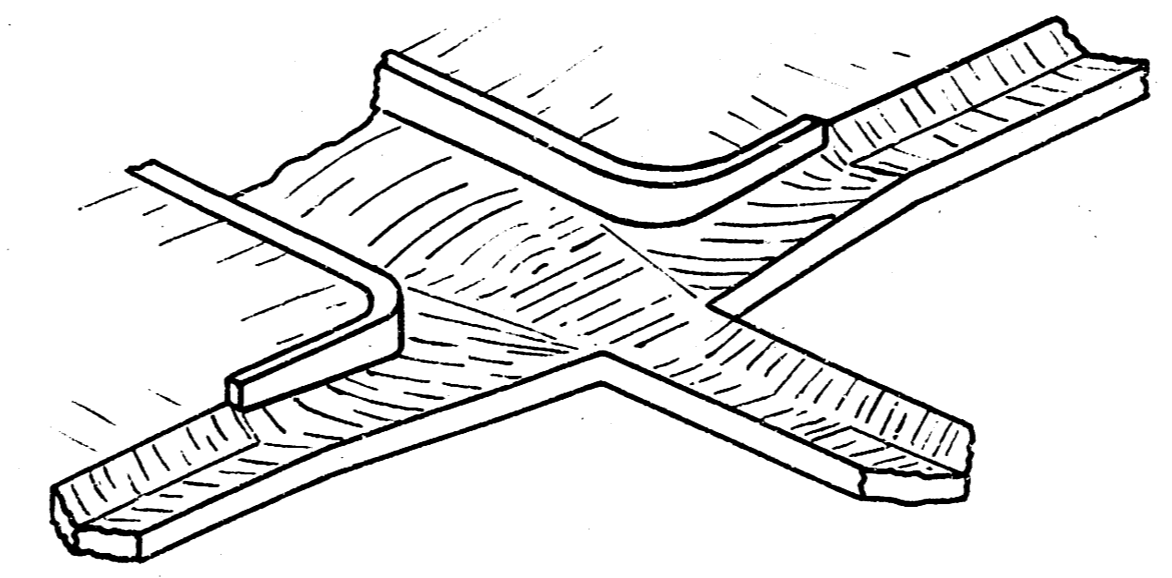
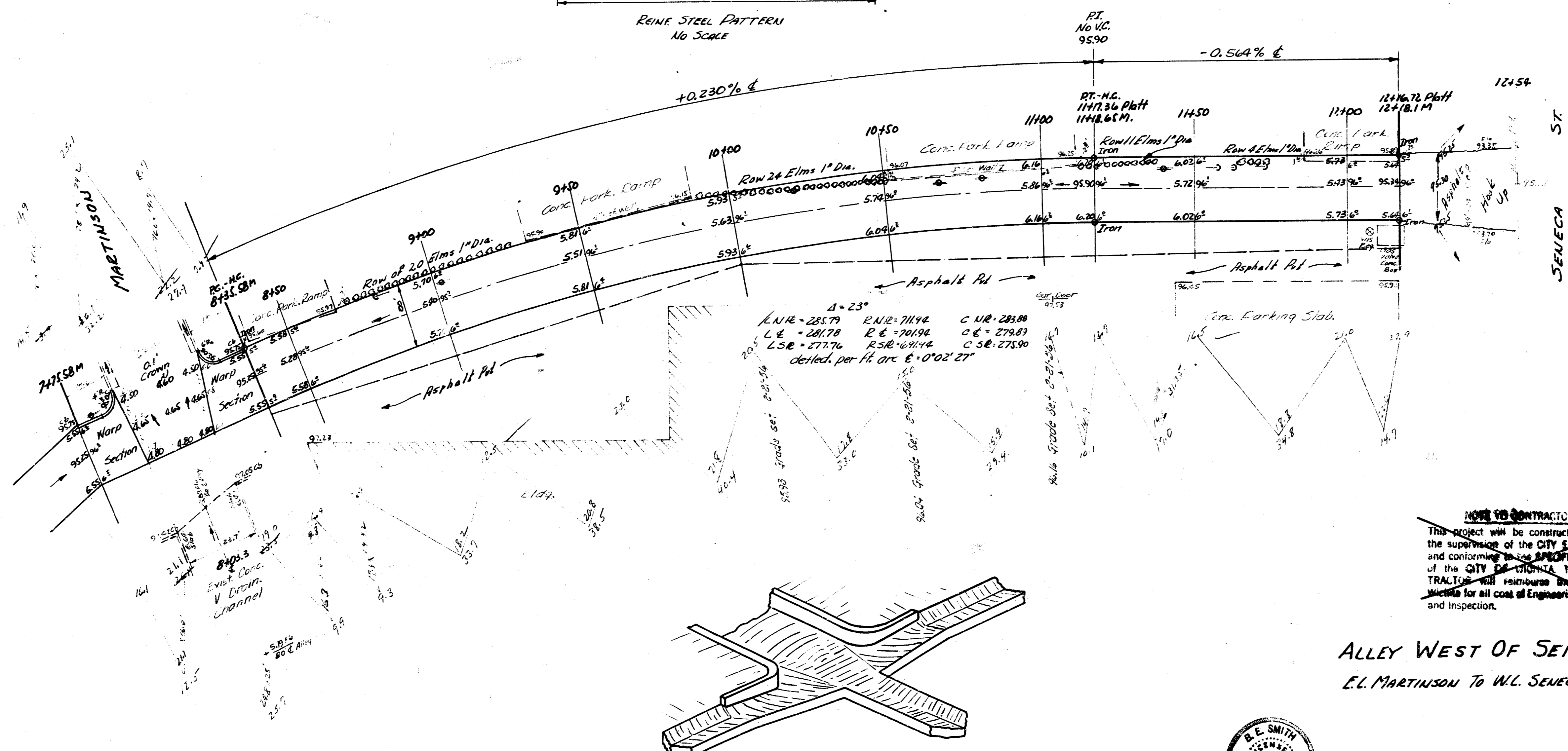
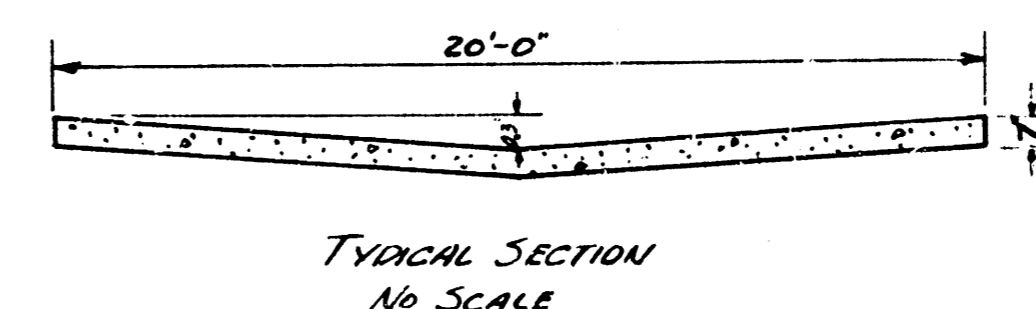
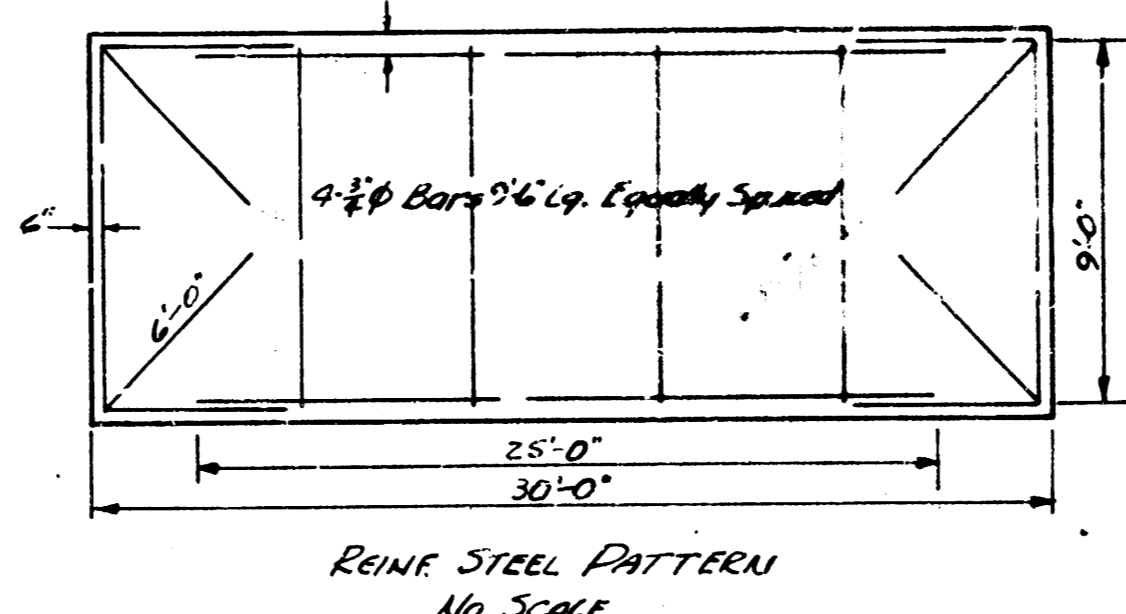

**NOTE TO CONTRACTOR:**  
This project will be constructed under the supervision of the CITY ENGINEER and conforming to the SPECIFICATIONS of the CITY ENGINEER. The CONTRACTOR will reimburse the City of Seneca for all cost of Engineering, Plans, and Inspection.

ALLEY WEST OF SENECA  
E.L. MARTINSON TO W.L. SENECA



3/3

DETAIL OF INTERSECTION  
ALLEY & MARTINSON