

B.M. = 103.45 City Standard on N.E. Cor. Seneca & Pawnee  
 B.M. = 103.22 "X" Top N. Cb. Alley Ret. 4' W. E.L. Seneca, Alley N. of Pawnee  
 B.M. = 100.20 "P" in P.K.S. Top N Cb. Pawnee, 20' W. W.L. Alley N. E. of Seneca  
 Base Line is on South and West Property Line

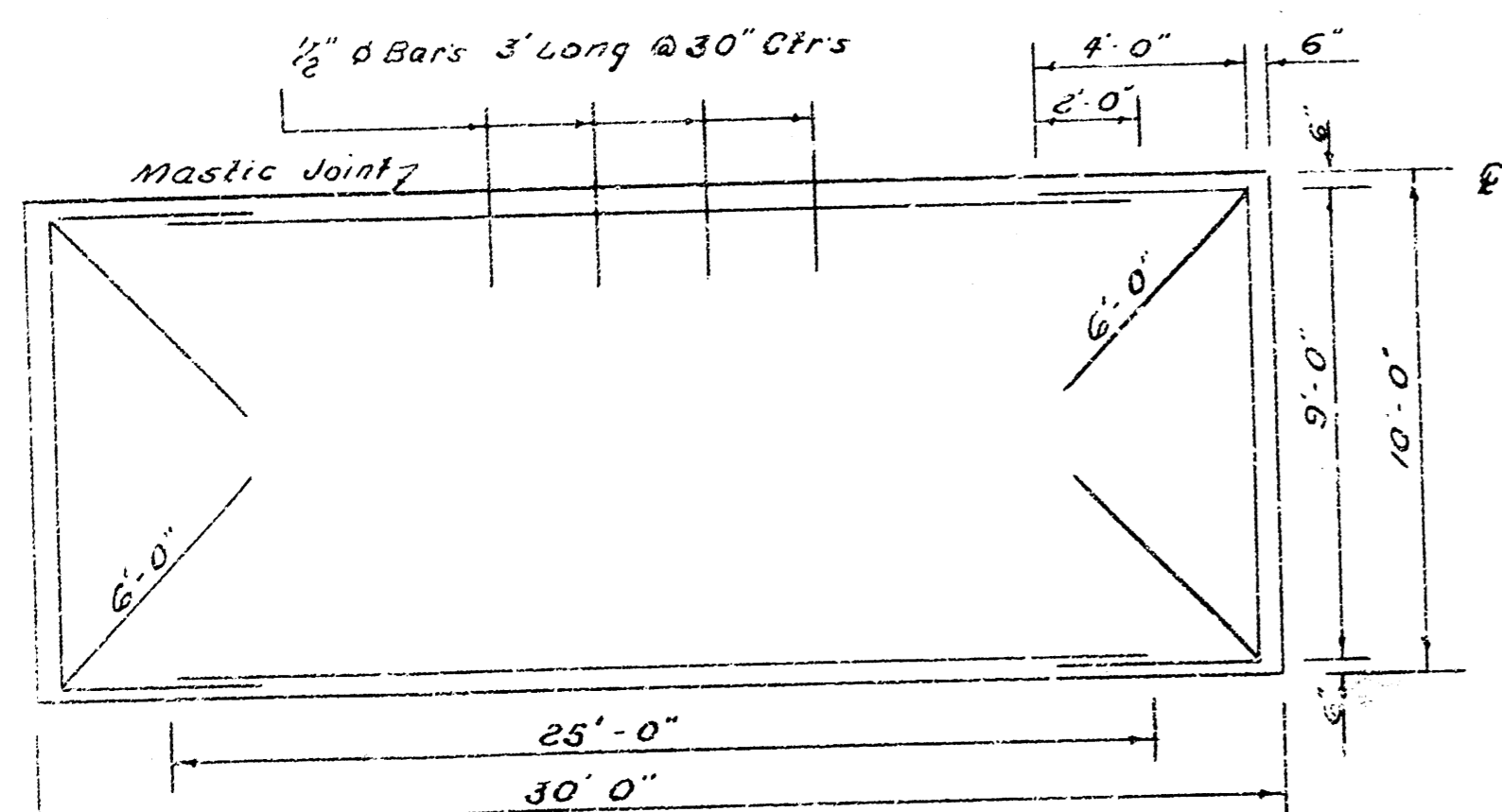

Steel Pattern  
 All Steel to be 3/4" φ Except where shown.

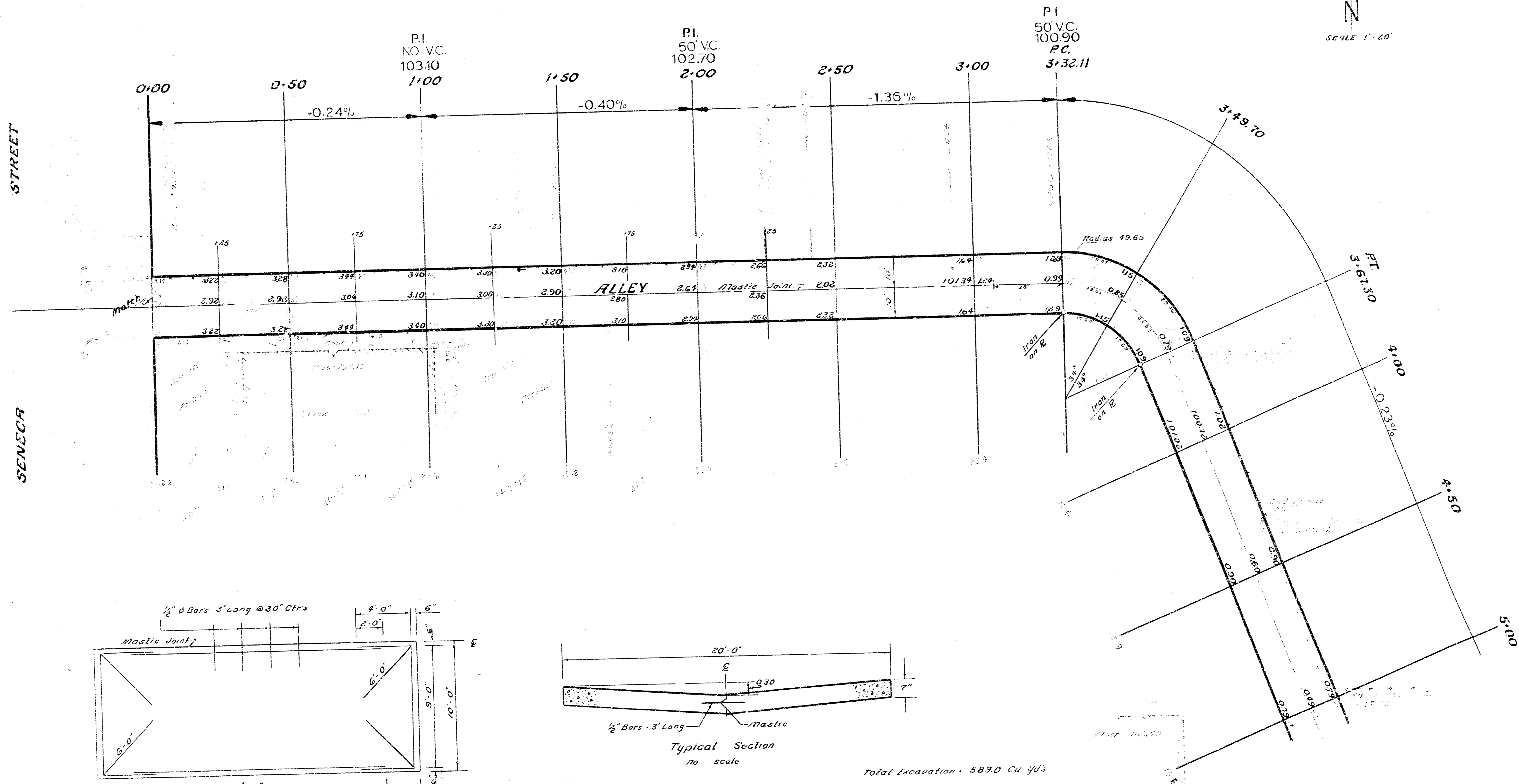
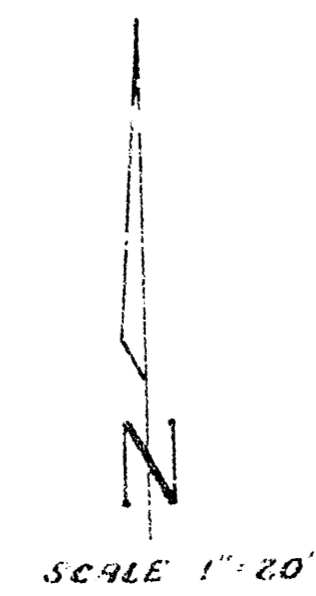
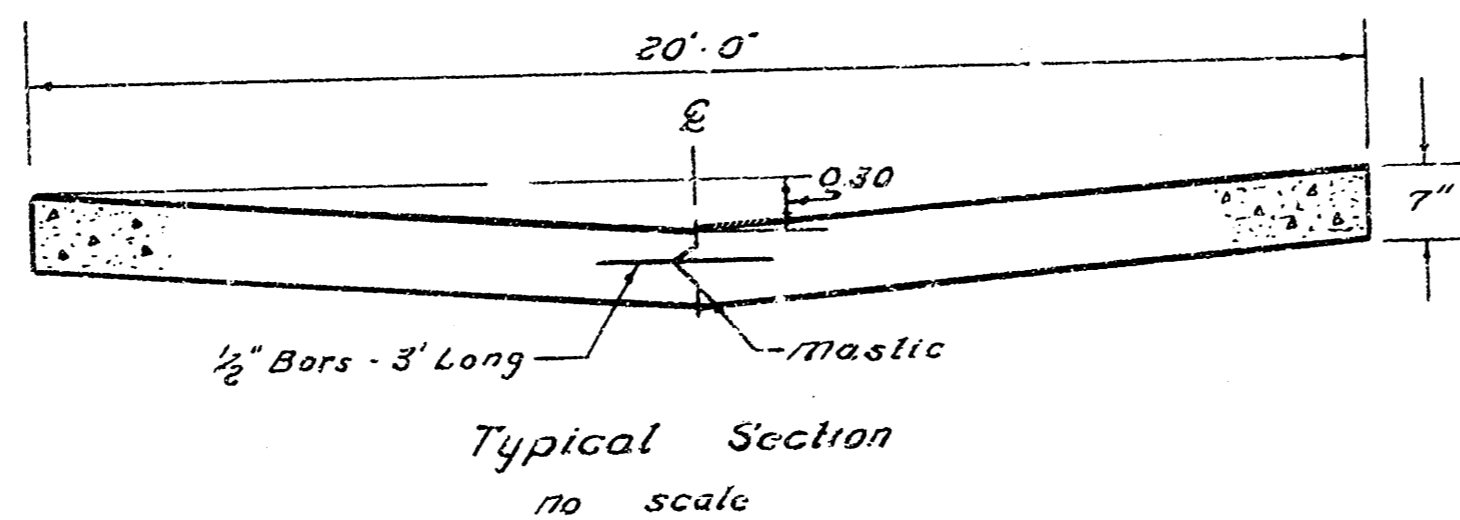

Typical Section  
 No scale

Total Excavation = 589.0 Cu Yd's

**"ALLEY"**  
 E.L. Seneca to N.L. Pawnee Ave  
**20' - 7" CONCRETE**  
 City of Wichita, Kansas  
 B.E. Smith City Engineer  
 Date: July 1928 Private Project

