

B.M. 103.45 City Standard on N.E. Cor. Seneca & Pawnee
 B.M. 103.22 "X" Top N. Cb. Alley Ret. & W.E.L. Seneca, Alley n. of Pawnee
 B.M. 100.20 "P" in P.K.S. Top N. Cb. Pawnee, 20 W. W.L. Alley N. E. of Seneca
 Base Line is on South and West Property Lines

NOTE TO CONTRACTOR
 This project will be constructed under the supervision of the CITY ENGINEER and conforming to the SPECIFICATIONS of the CITY OF WICHITA. The CONTRACTOR will reimburse the City of Wichita for all cost of Engineering, Plans and Inspection.

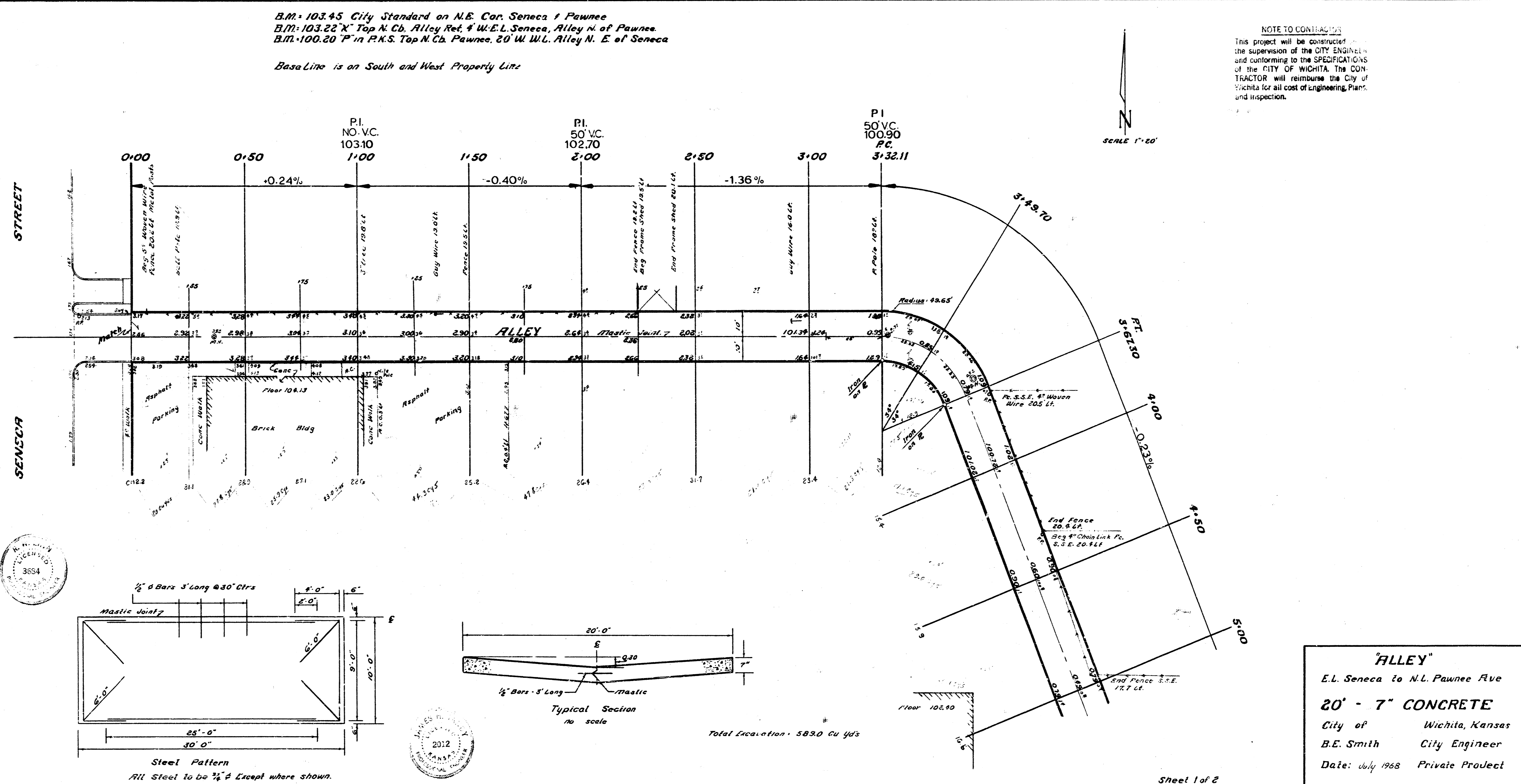

Survey done by B.W.C. 1/15/68
 Plans drawn by J.E. Smith
 Checked by J.E. Smith

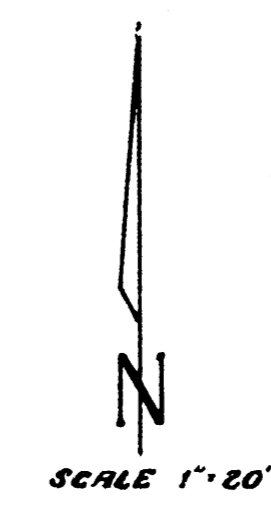
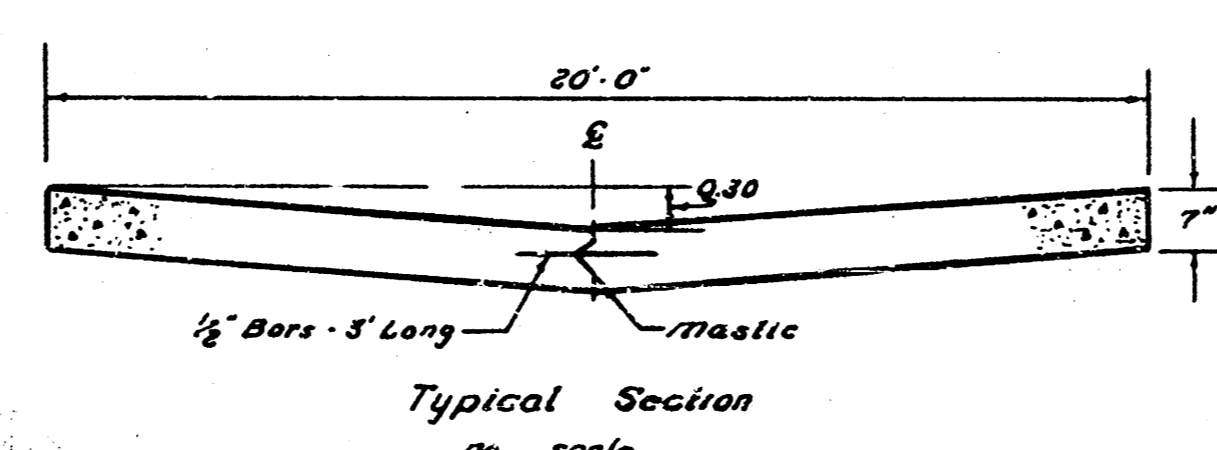
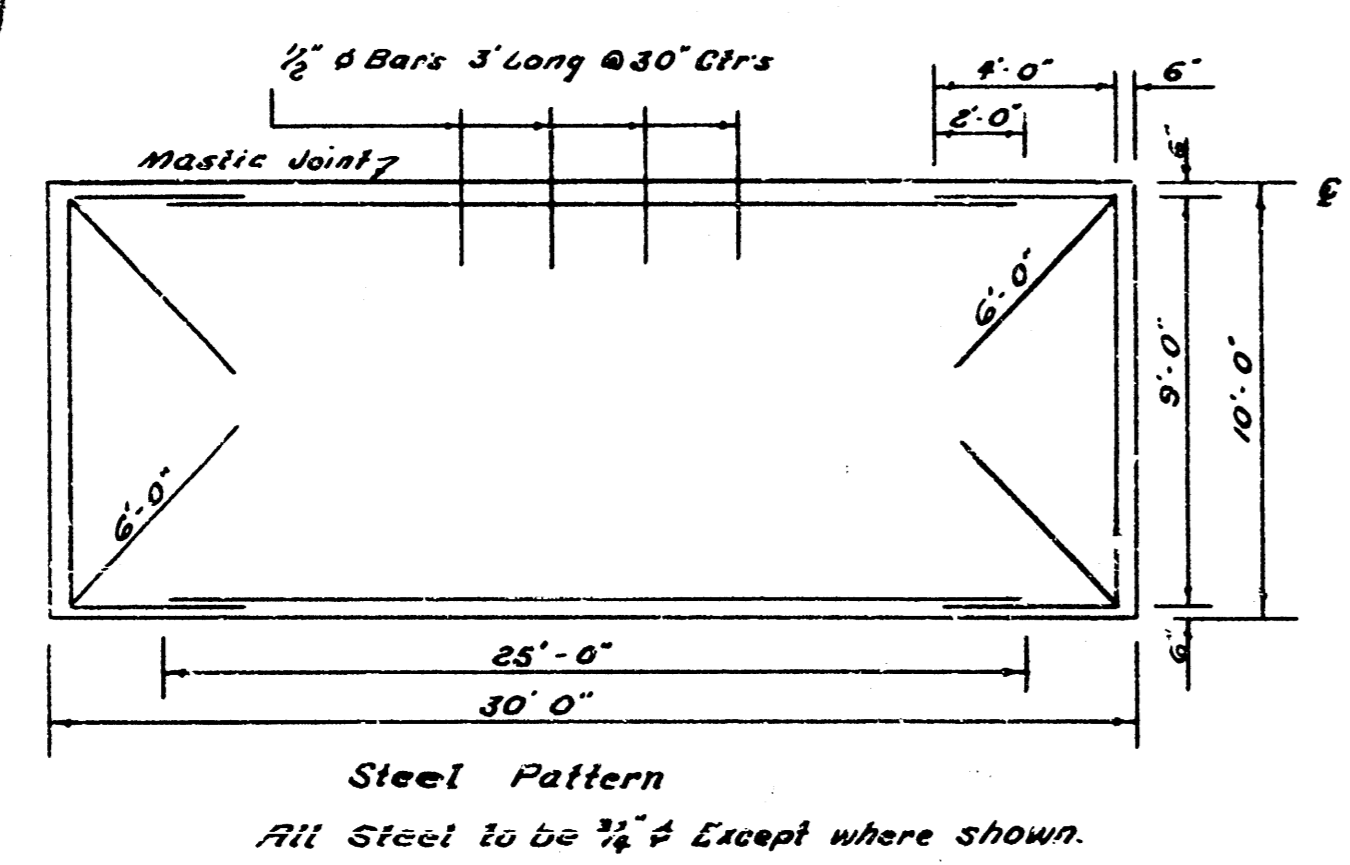

Total Excavation - 583.0 Cu Yds

"ALLEY"
 E.L. Seneca to N.L. Pawnee Ave
20' - 7" CONCRETE
 City of Wichita, Kansas
 B.E. Smith City Engineer
 Date: July 1968 Private Project

