

WICHITA, KANSAS

ALLEY IMPROVEMENTS

ALLEY - BETWEEN KANSAS AVE. AND I-135
N/L OF 1ST. STREET TO N/L OF LOT 39, BLOCK 3, MINNEAPOLIS ADDITION

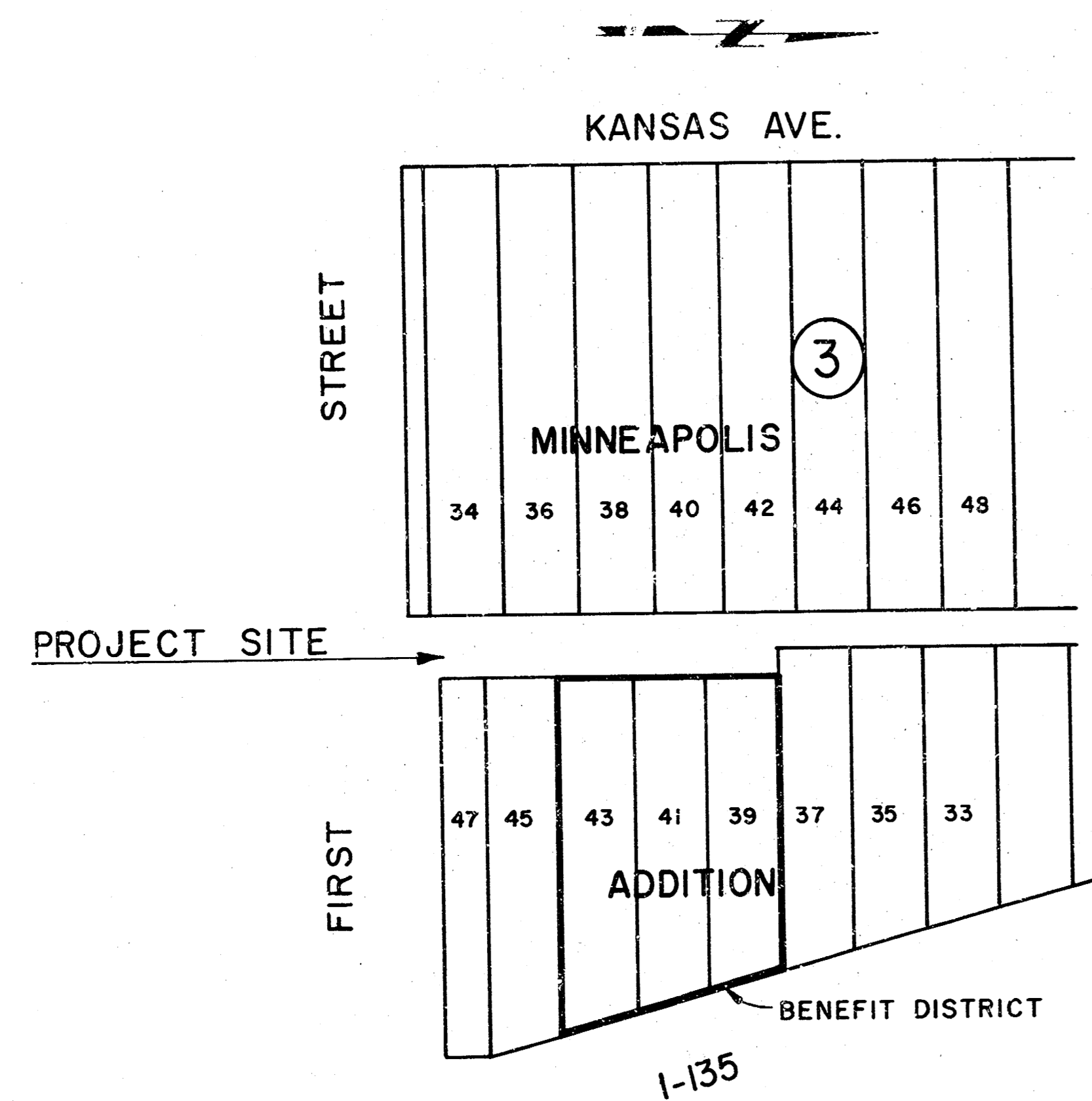

LOCATION MAP

NOTE:
BENEFIT DISTRICT = LOT 39-41 & 43
BLOCK 3, MINNEAPOLIS ADDITION EXCP'T
STREET & INTERSTATE R/W

CITY OF WICHITA, KANSAS
MICHAEL LINDEBAK - CITY ENGINEER
PROJECT NO. 472-76-245-81303000-000-001

BLACK & VEATCH ENGINEERS - ARCHITECTS

1984

FILMED FROM THE BEST
AVAILABLE COPY

BM #1

111.92 (City Datum)
Disk N/W Corner Bridge over canal on 1st. street.

GENERAL NOTES

- Contractor shall verify location of all underground utilities.
- All earthwork, including compaction, shall be incidental to "7 REINFORCED CONCRETE ALLEY PAVEMENT."

LEGEND

S. W.	Sidewalk
P. P. Ø	Utility Pole
M. H.	Manhole
---	Property Line (Lot Line)
⊗	Denotes Removal

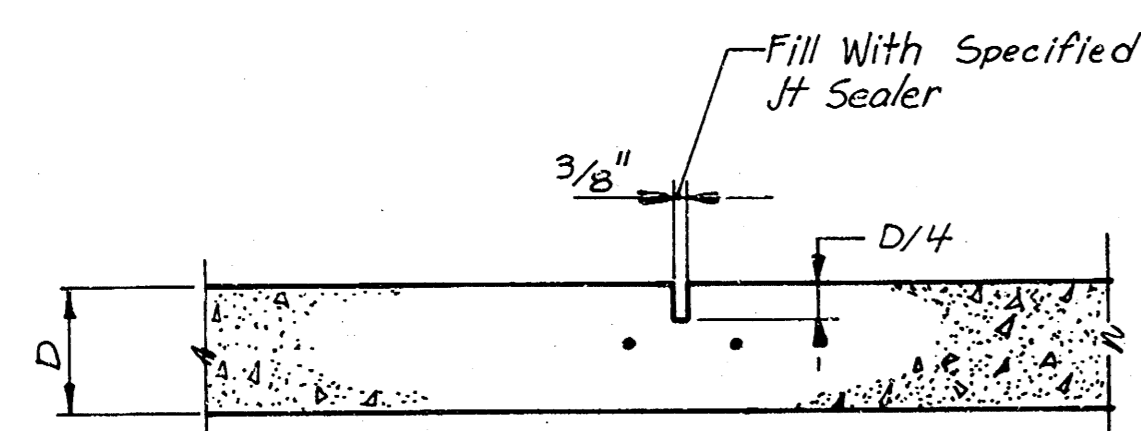

SAWED CONTRACTION JOINT DETAIL
No Scale

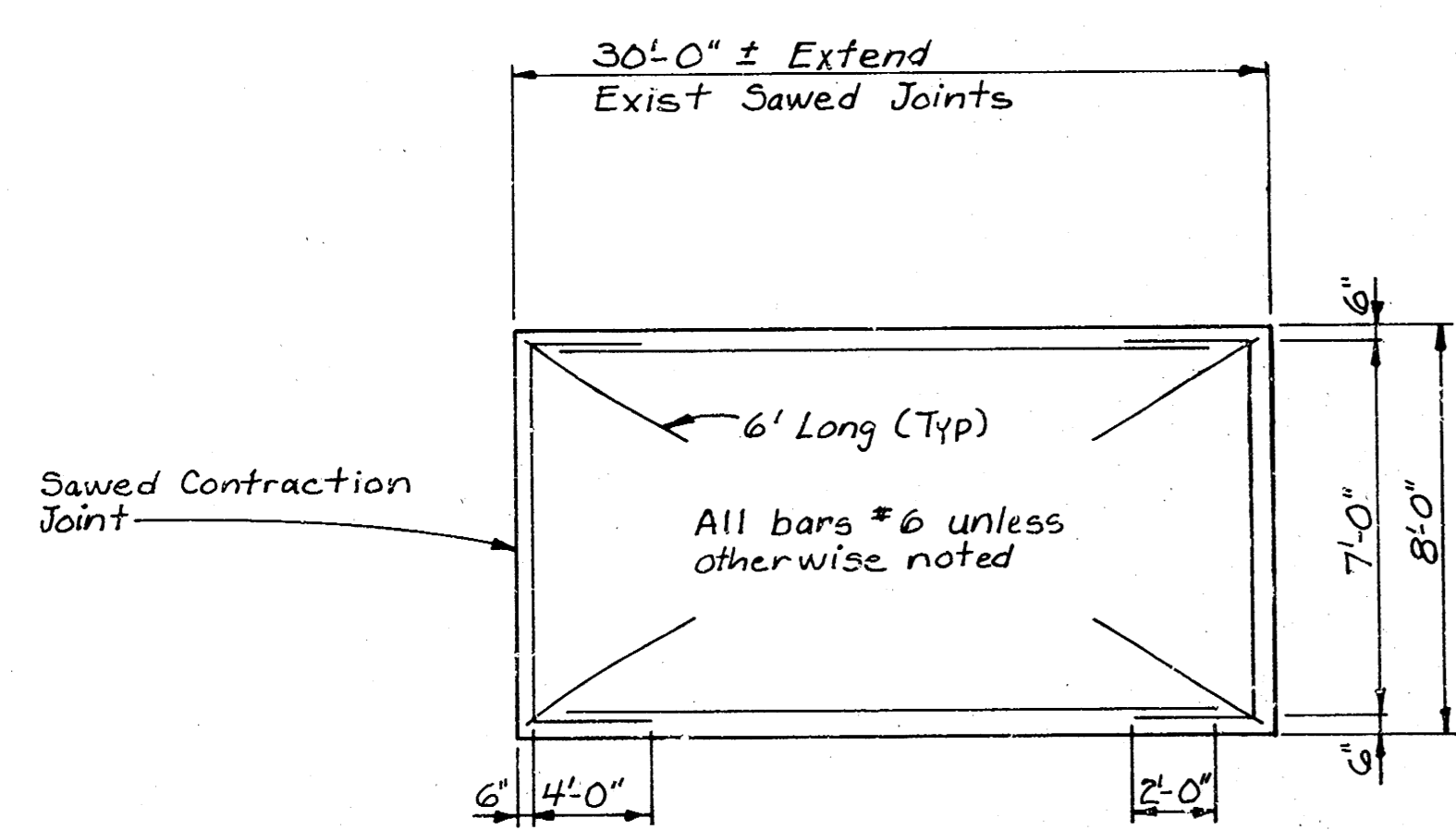

LAYOUT-REINFORCING STEEL
No Scale

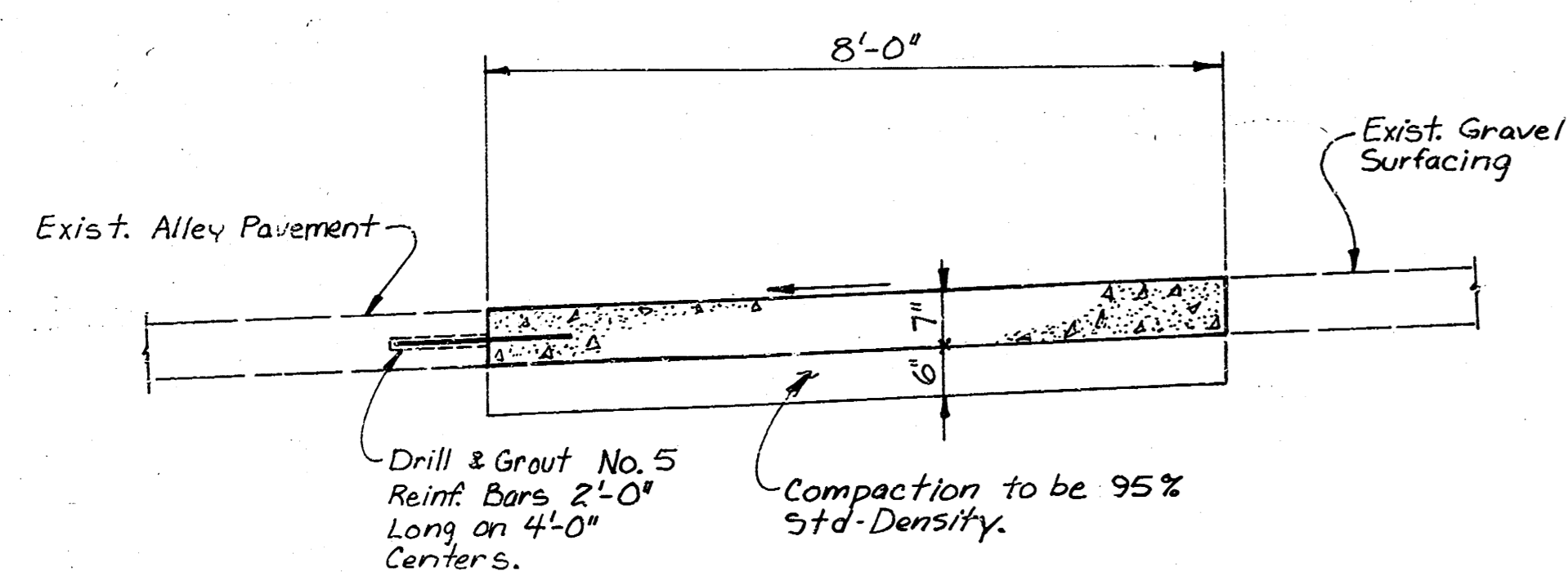

TYPICAL SECTION
Scale 1/2"=1'-0"

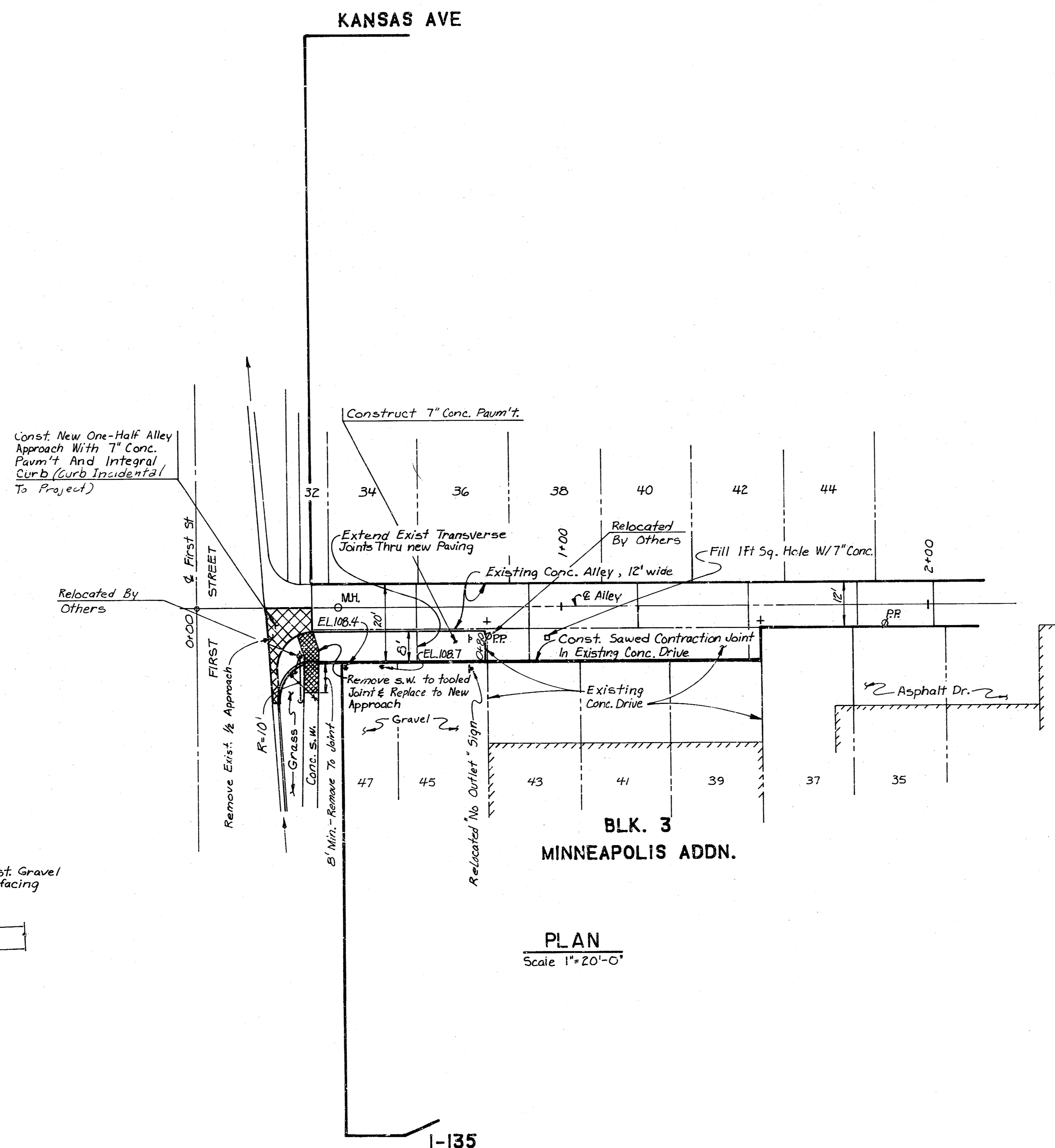

PLAN
Scale 1"=20'-0"

I-135

BAV-C-2438-A

NO.	DATE	REVISIONS AND RECORD OF ISSUE	NO.	BY	CK	APP

DESIGNED: WNL
 DETAILED: LT
 CHECKED: HML
 APPROVED: [Signature]
 DATE: 2/1/84

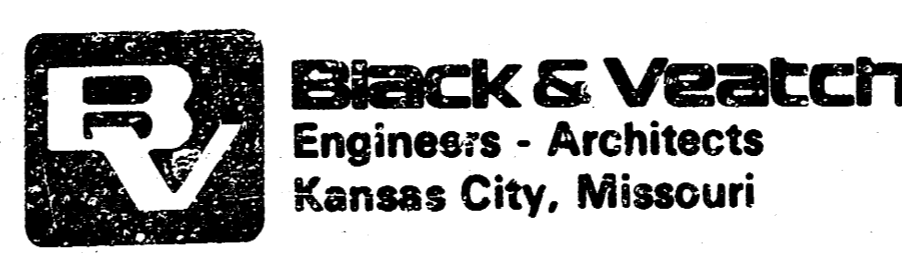

PROJECT NO.
11661

WICHITA, KANSAS
 ALLEY IMPROVEMENTS
 PLAN

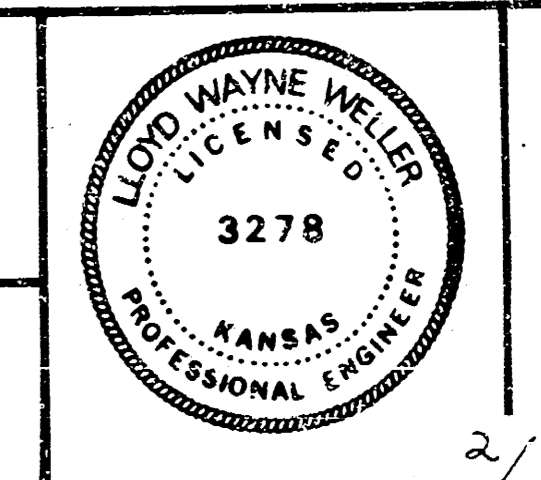

SHEET
1 OF 2

FILMED FROM THE BEST AVAILABLE COPY

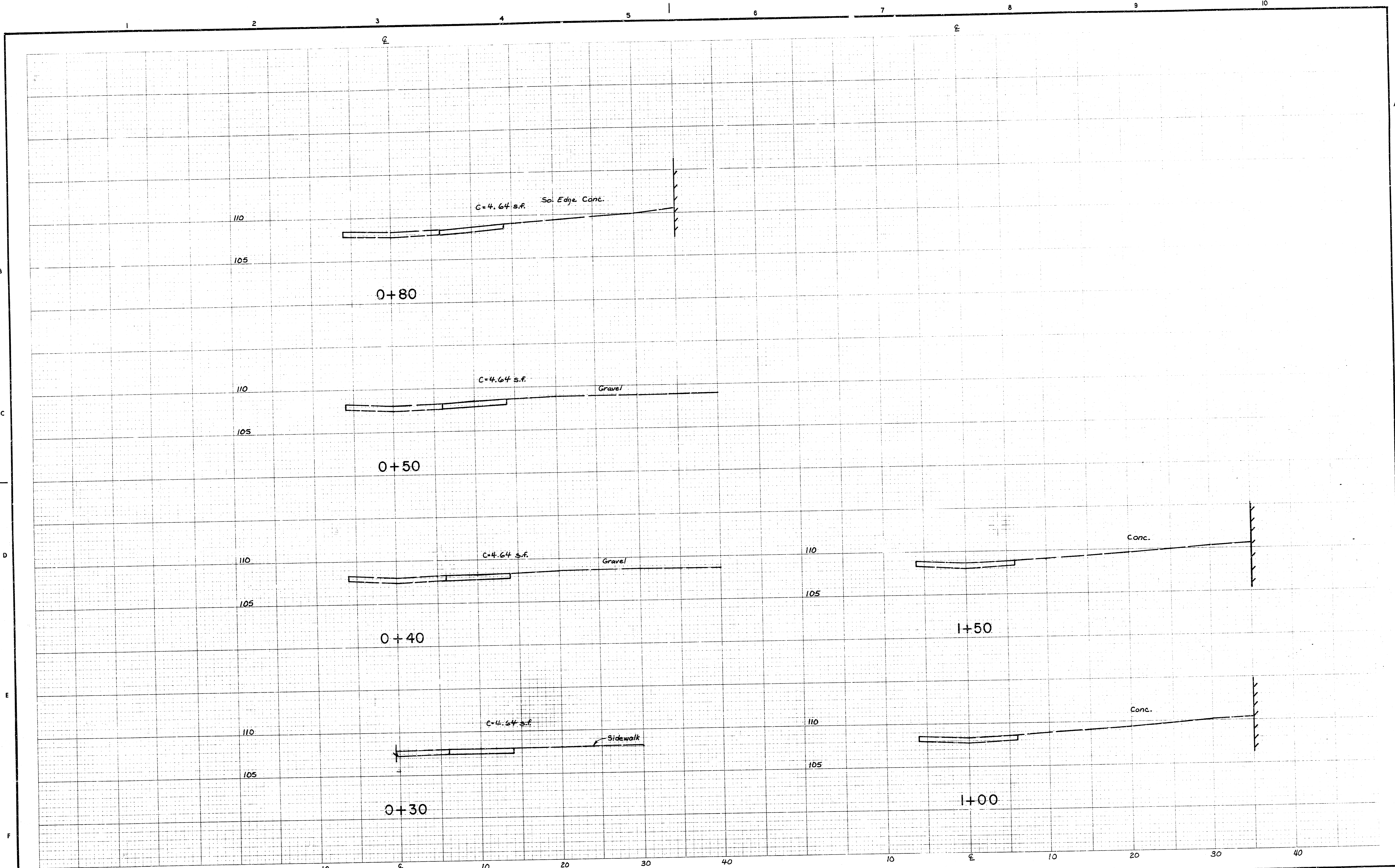

RAY-C-2456-A

NO.	DATE	REVISIONS / NO RECORD OF ISSUE	NO.	BY	CK	APP

DESIGNED WNL
 DETAILED LT
 CHECKED HML
 APPROVED [Signature]
 DATE 3 Jul 84



PROJECT NO.
11661

WICHITA, KANSAS
 ALLEY IMPROVMENTS
 CROSS SECTIONS

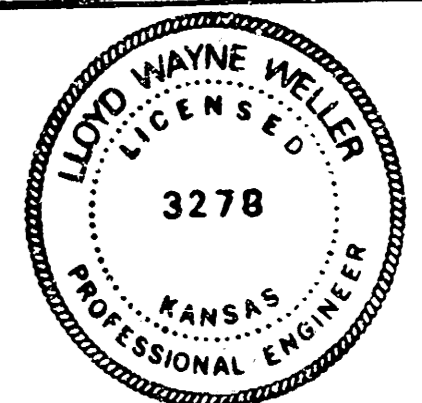

SHEET
2 OF 2

3/3

FILMED FROM THE BEST AVAILABLE COPY