

B.M. 110.58 N. Elm R.G.E. M.H. S.W. Cor. Broadway & Douglas, on Wk.
 B.M. 111.02 On Wk. W.L. Alley N.C. William, At Cor. of Bldg.
 B.M. 110.80 "C" in Const. on Wk. W.L. Alley 2' S. of N.C. English

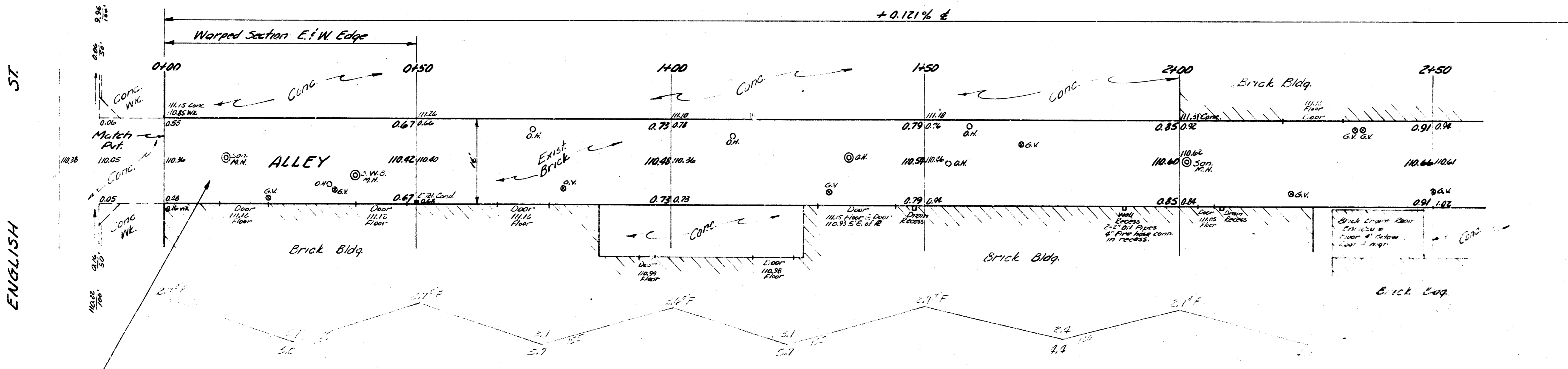

GRAND TOTAL FILL
 276
 71.1 40.7
 234.4



Remove exist. Pav. in alley as shown & replace with 8" Conc. Pav.

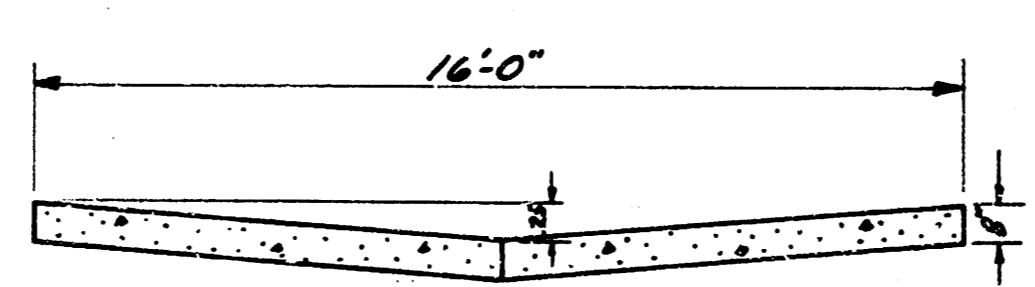
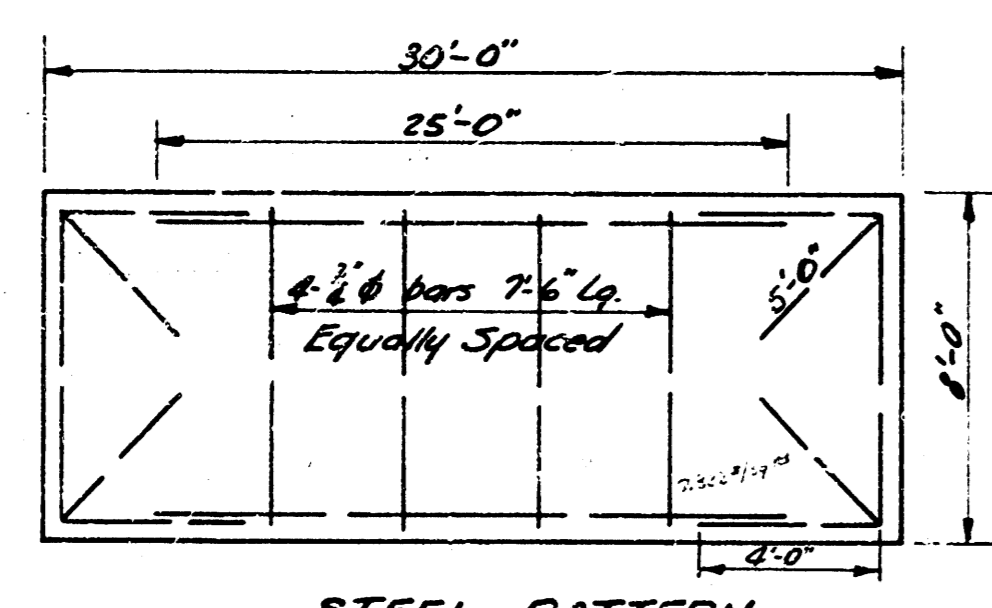

TYPICAL SECTION
 Sta. 0+50 to Sta. 4+02.8
 No SCALE

1/2

ALLEY BTWN BROADWAY & MARKET
 N.L. ENGLISH TO S.L. WILLIAM
 16' CONC.-8" REPAVE
 CITY OF WICHITA, KANSAS
 B.E. SMITH CITY ENGINEER
 Sept. 1954 PROJ. 146 C16-120

C.M.P. DEC. 1954

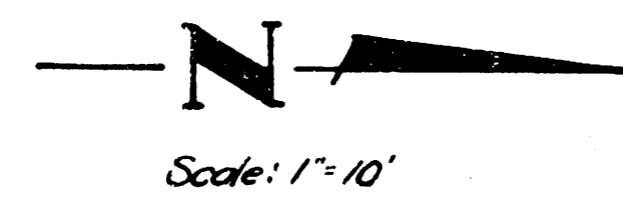

PLT
11/1/50
2/11
2

