

R.R. 140TH R.R. Spike Coal side Power pole. N.S. Ridge Road @ S.L. Newell Coal

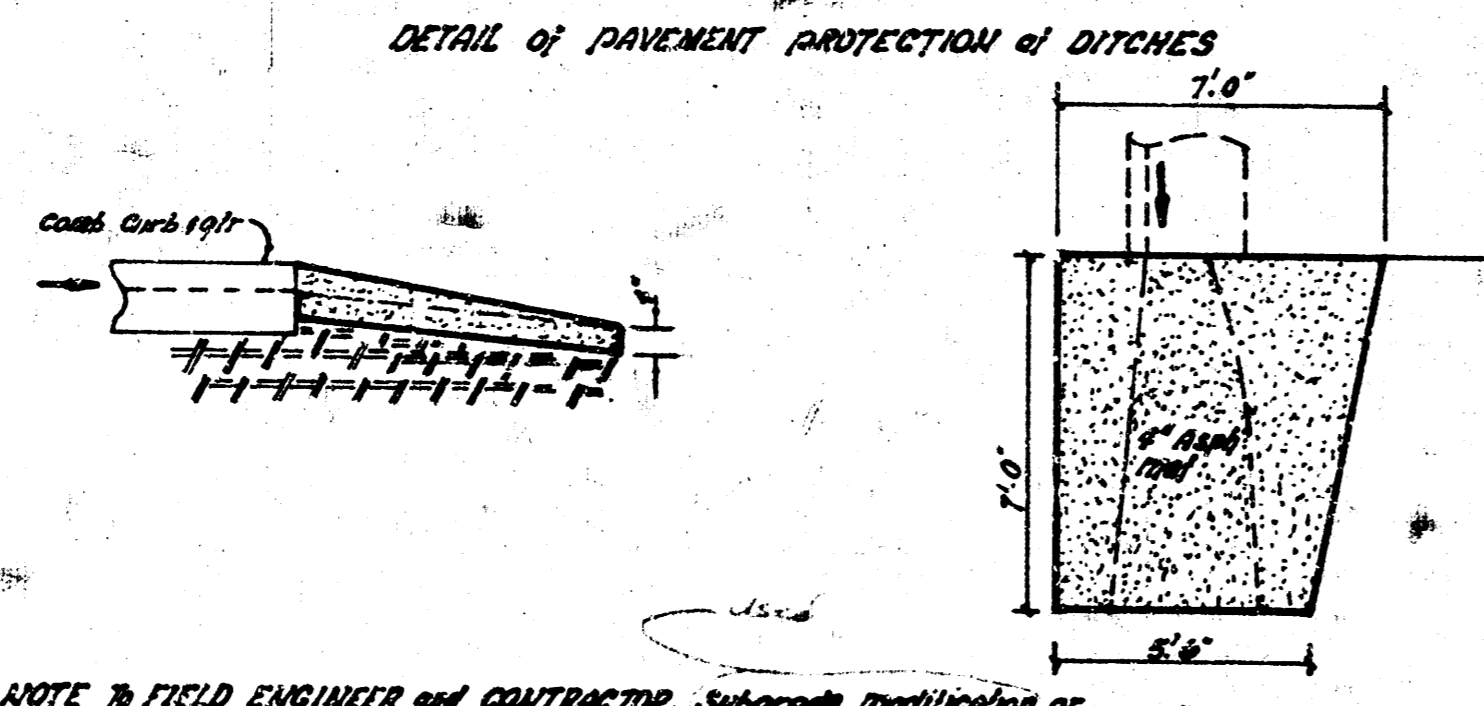
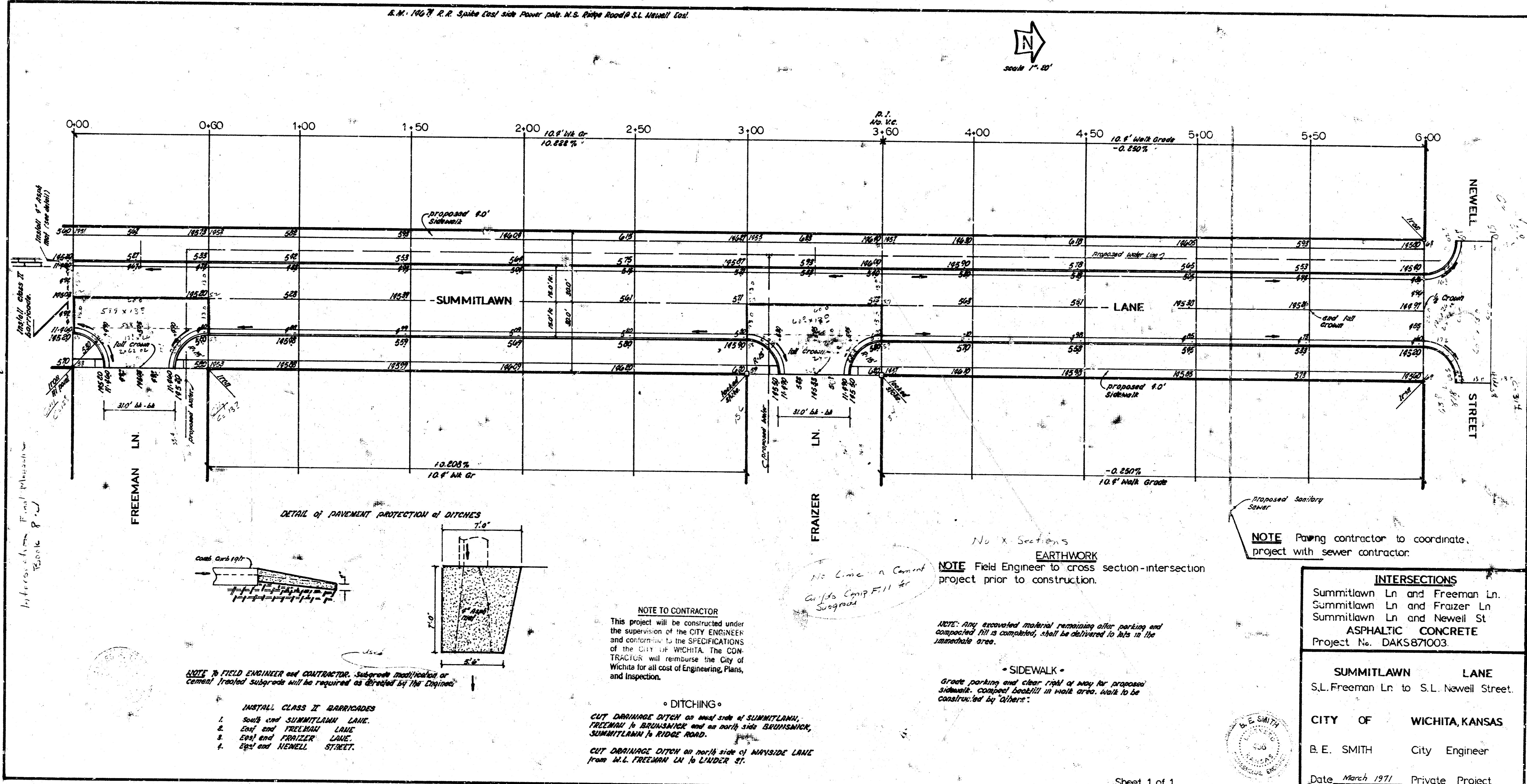

NOTE TO FIELD ENGINEER and CONTRACTOR. Subgrade modification or cement treated subgrade will be required as directed by the Engineer.

- INSTALL CLASS II BARRICADES
1. South end SUMMITLAWN LANE.
 2. East end FREEMAN LANE.
 3. East end FRAZIER ROAD.
 4. East end NEWELL STREET.

NOTE TO CONTRACTOR
This project will be constructed under the supervision of the CITY ENGINEER and conform to the SPECIFICATIONS of the CITY OF WICHITA. The CONTRACTOR will reimburse the City of Wichita for all cost of Engineering Plans, and Inspection.

- DITCHING
- CUT DRAINAGE DITCH on west side of SUMMITLAWN, FREEMAN & BRAUNSHAW and on north side BRAUNSHAW, SUMMITLAWN & RIDGE ROAD.
 - CUT DRAINAGE DITCH on north side of NAYSIDE LANE from N.L. FREEMAN LN to LAUDER ST.

NOTE Field Engineer to cross section-intersection project prior to construction.

NOTE: Any excavated material remaining after parking and compacted fill is completed, shall be delivered to site in the immediate area.

SIDEWALK
Grade parking and clear right of way for proposed sidewalk. Compact backfill in walk area. Work to be constructed by others.

NOTE Paving contractor to coordinate project with sewer contractor.

INTERSECTIONS	
Summitlawn Ln and Freeman Ln.	
Summitlawn Ln and Frazer Ln	
Summitlawn Ln and Newell St	
ASPHALTIC CONCRETE	
Project No. DAKS871003.	
SUMMITLAWN LANE	
S.L. Freeman Ln. to S.L. Newell Street.	
CITY OF	WICHITA, KANSAS
B. E. SMITH	City Engineer
Date	March 1971 Private Project

