

B.M. 15119 "G" In Globe W. Ck. Erie S. Of SL 12th St.  
 B.M. 15461 Iron In Thimble E 12th & Chautauque.

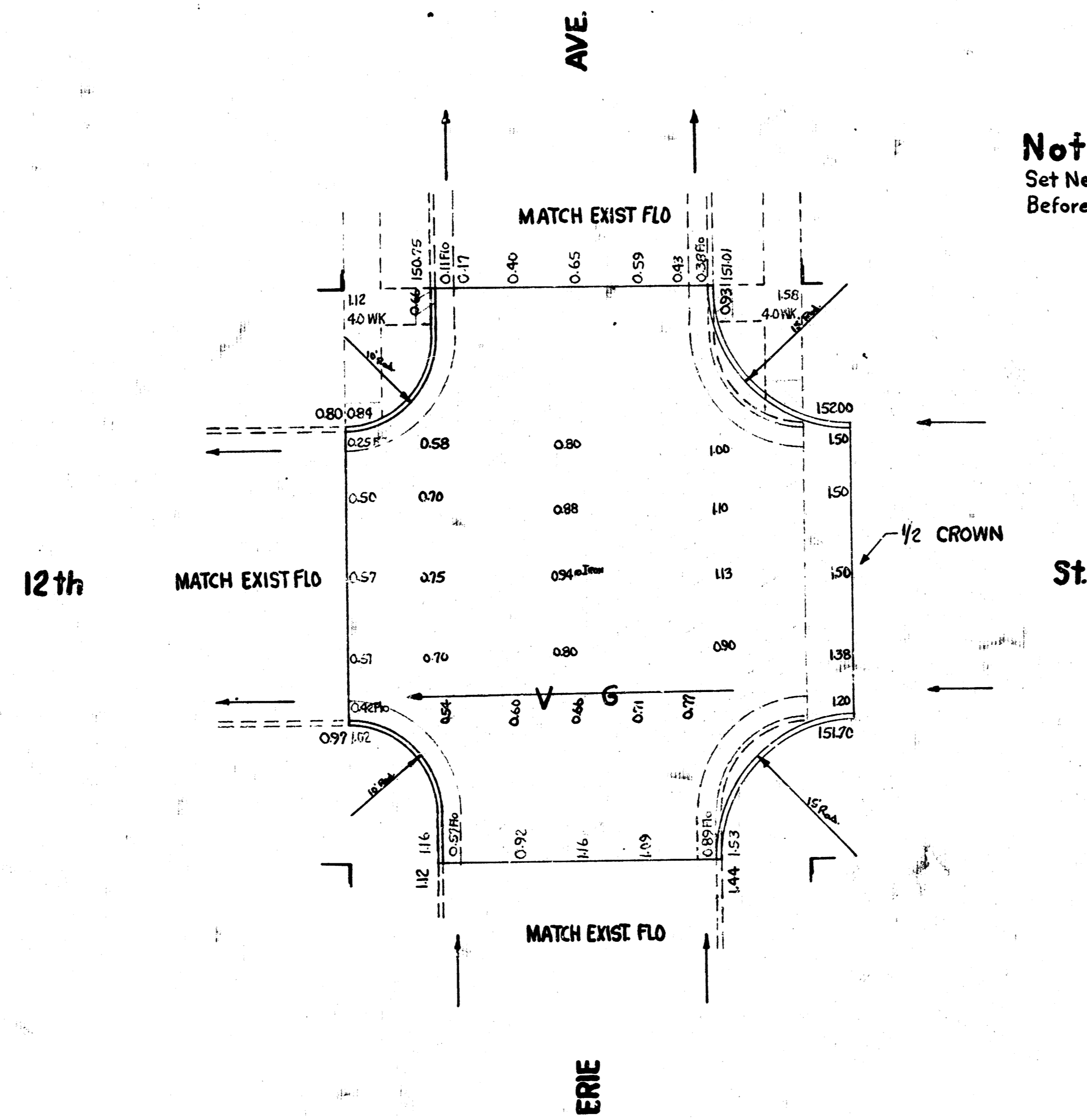

**Note To Field Engineer**  
 Set New Ties To Iron  
 Before Construction.

**Note To Contractor**  
 Remove Existing Asphaltic Concrete Pavement And  
 2.5' Curb And Gutter As Indicated On Plan.  
 Replace With CONCRETE PAVEMENT And Integral Cb.

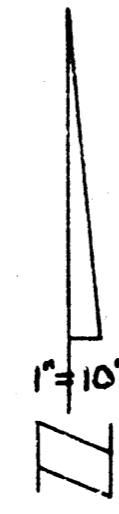

**INTERSECTION**  
 12th & Erie  
 6" Conc. & Integral Cb.  
 CITY OF WICHITA, KANSAS  
 B.E. SMITH CITY ENGINEER  
 July 1955 Proj. No. C15-55



1 15 1 18

Lithomson 1116  
 Robinson