

BM - 112.95 N. Rim K.G.E. M.H. IV of Alley of Main on N.W. 1st Street
 BM - 111.14 R. in Riche on E. 1st Alley E. of Main, N.S. of 2nd Street
 Base Line - 18.5' East of West Prop. Line

NOTE TO CONTRACTOR
 This project will be constructed under the supervision of the CITY ENGINEER and conforming to the SPECIFICATIONS of the CITY OF WICHITA. The CONTRACTOR will reimburse the City of Wichita for all cost of Engineering and Inspection.

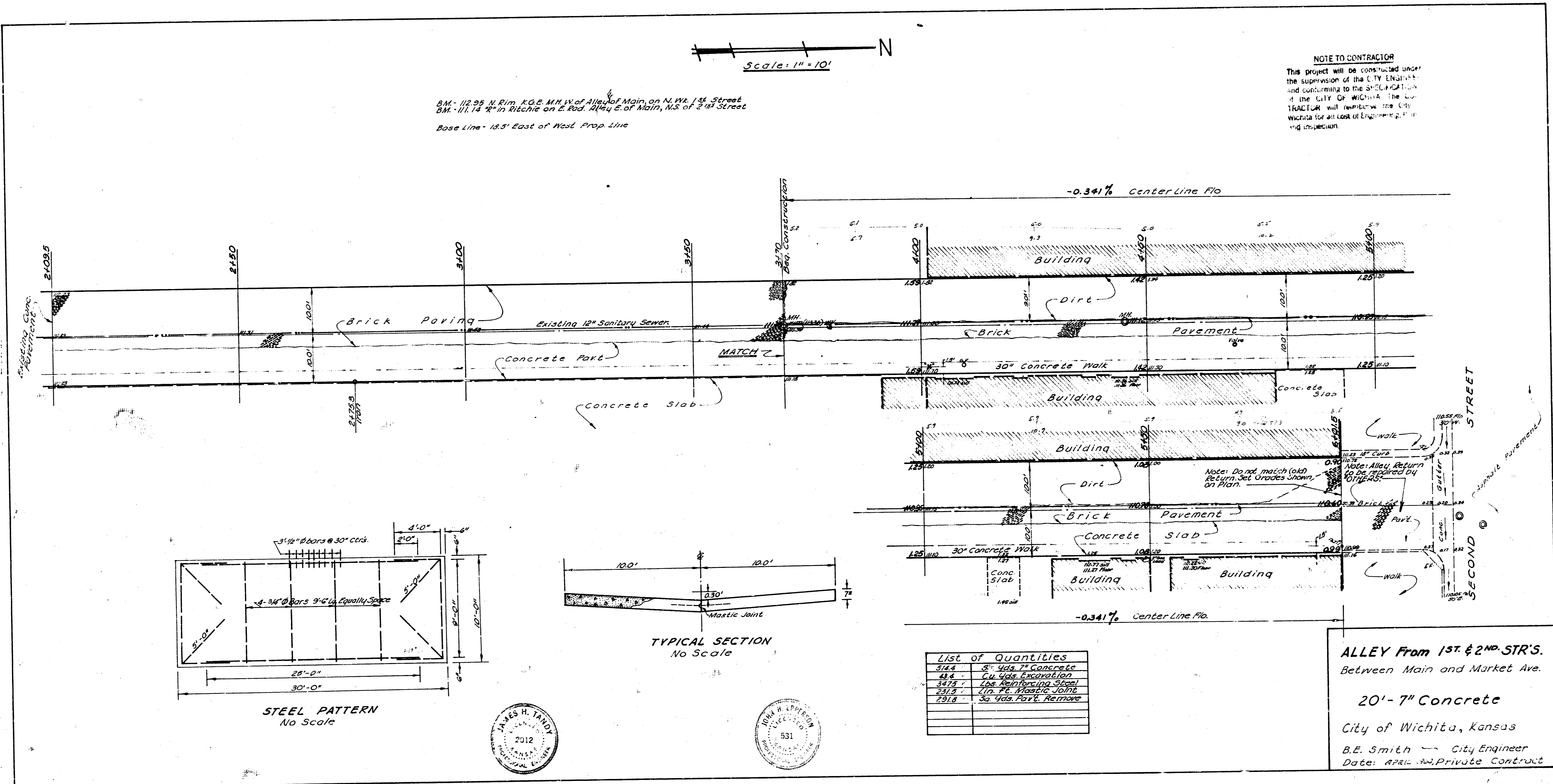

CAL. 11/15/17
 S. 3007
 S. 1001

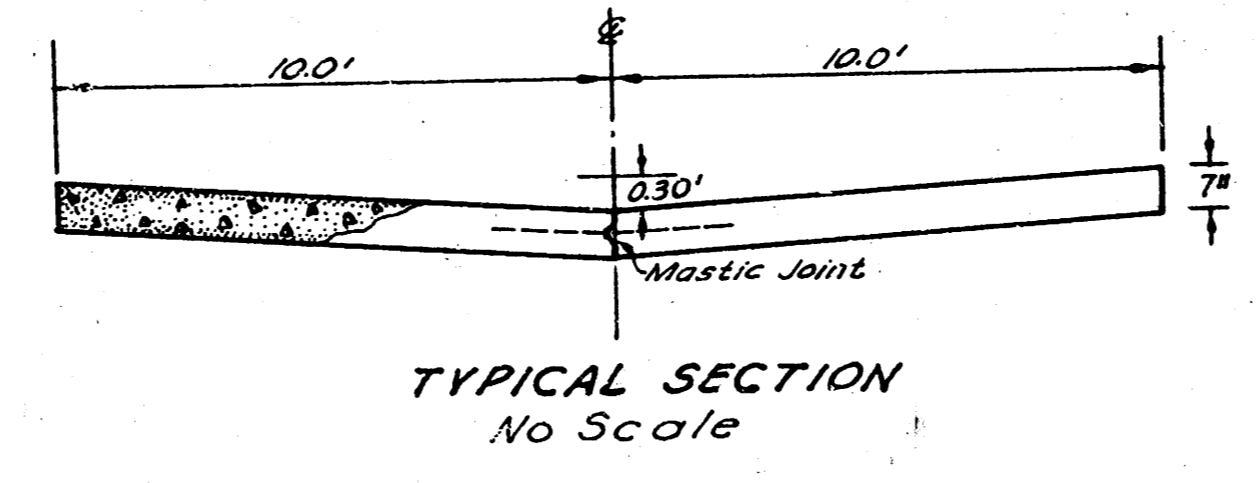
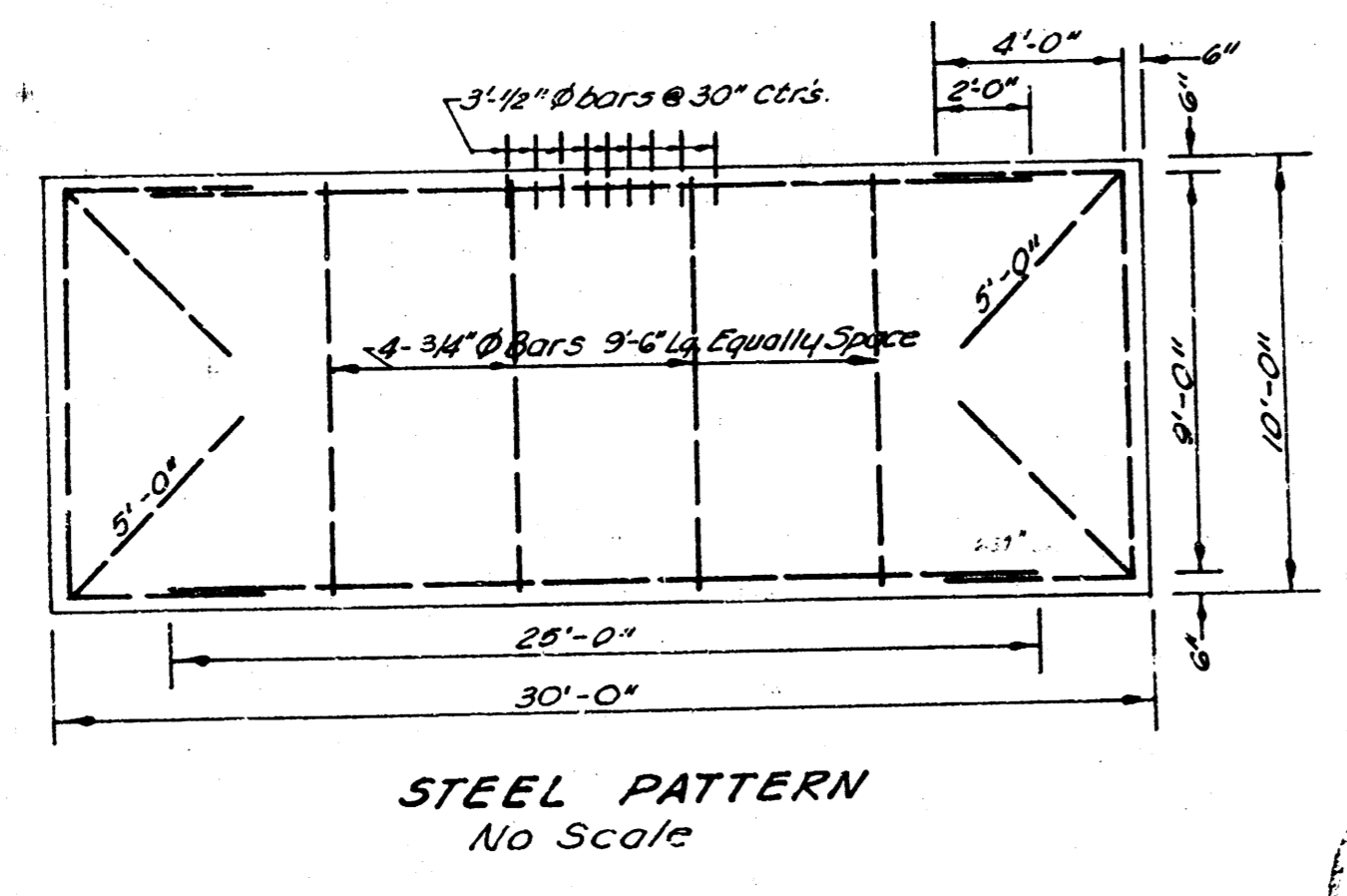

List of Quantities	
544	5 Yds. 7" Concrete
434	Cu. Yds. Excavation
3474	Lbs. Reinforcing Steel
2312	Lbs. 7" Plastic Joint
231.6	Sq. Yds. Pav. Remove

ALLEY From 1st & 2nd STR'S.
 Between Main and Market Ave.
 20'-7" Concrete
 City of Wichita, Kansas
 B.E. Smith - City Engineer
 Date: APRIL 24, Private Contract

