

B.M. 114.67 W.L. Water & Douglas - Top NW Cor. E. Part Safety Island
 B.M. 112.42 W. Elm M.H. in Alley S.S. 1st Between Main & Market

NOTE: Exist. pvt. in alley is 3" brick,
 asphalt filler; on 5" Conc. base in 15' of
 width. Other 5' is Conc. pvt.

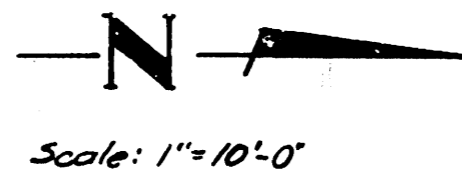

Surveyed by 659
 Plan 116-2
 Checked JF

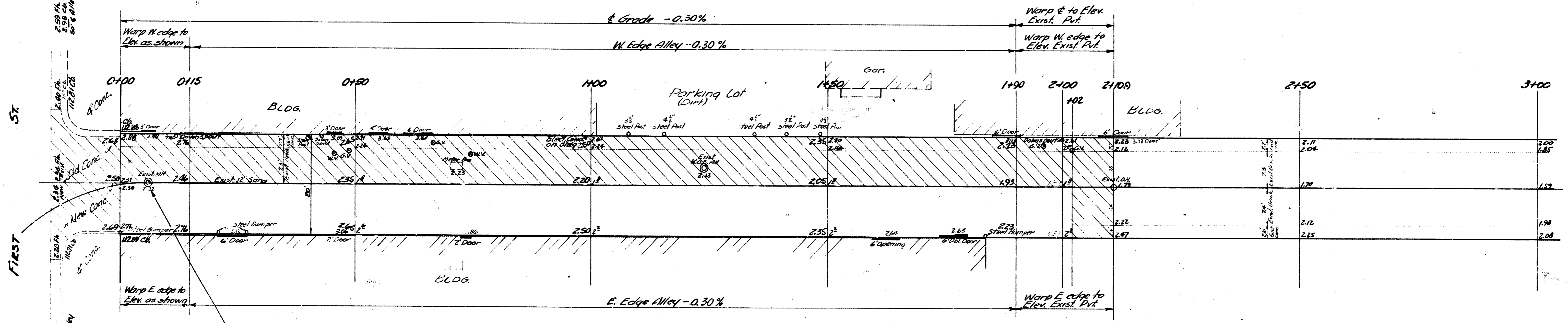

NOTE: Manhole to be rebuilt
 by City Sewer Maintenance

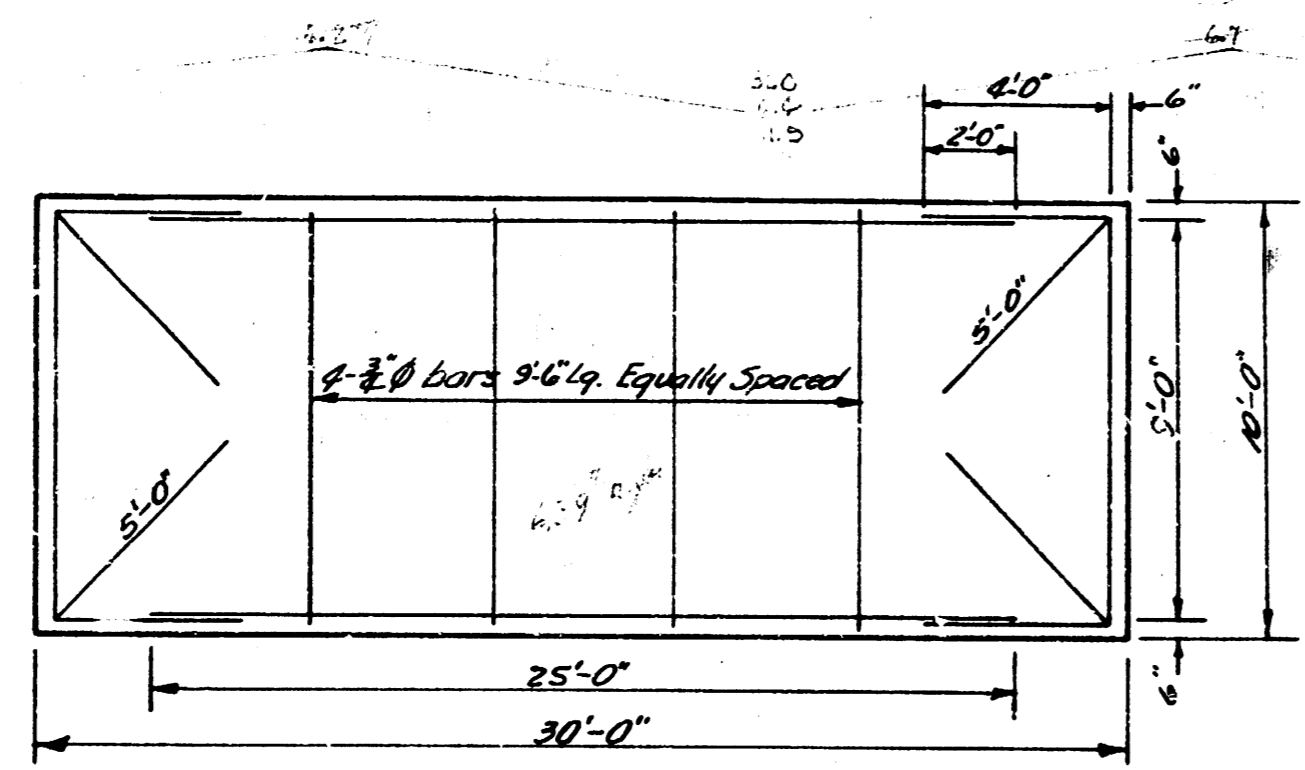

STEEL PATTERN
 No Scale

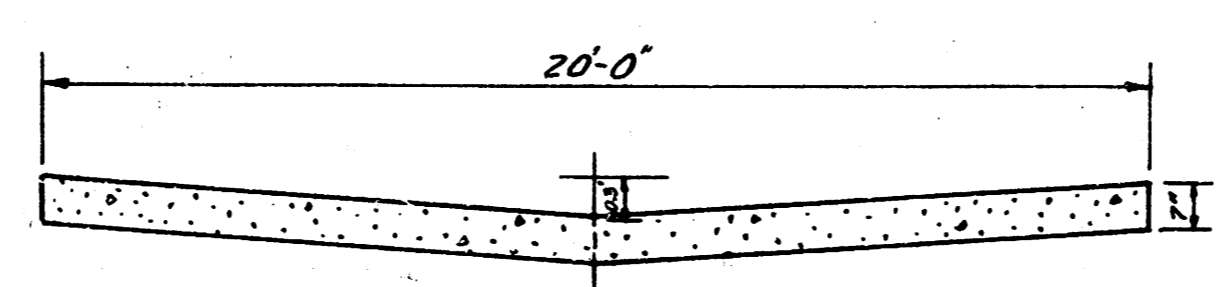

TYPICAL SECTION
 (Elevation at Warped Sections)
 No Scale

THESE PLANS AND SPECIFICATIONS ARE THE PROPERTY OF THE CITY OF WICHITA, KANSAS, AND ARE TO BE USED ONLY FOR THE PROJECT AND LOCATION SPECIFICALLY INDICATED THEREON. ANY REUSE OR REPRODUCTION OF THESE PLANS WITHOUT THE WRITTEN PERMISSION OF THE CITY ENGINEER IS STRICTLY PROHIBITED.



ALLEY BTWN MARKET & MAIN
 N.L. 1ST-N.L. LOT 63, MARKET ST RESURVEY OF GREIF-
 ENSTEIN'S ORIGINAL TOWN IN THE CITY OF WICHITA, KAN.
 20' CONC. - 7" THICK
 CITY OF WICHITA, KANSAS
 B.E. SMITH CITY ENGINEER
 APRIL 1954 PROJ. C16-55