

211. BACK WALK EXT. N.W. COR. FIRE STATION I.E. BROADWAY'S BRAYLEY 100.76
 BAYELINE = & ALLEY GOING NORTH

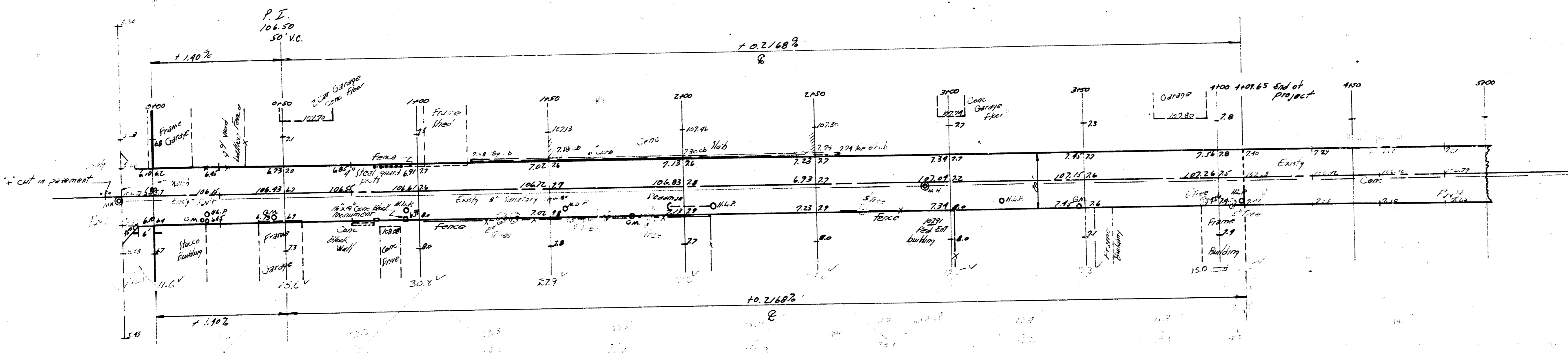

Survey done by BK. Wassy
 Plans drawn by P. H. W.
 Checked by C. H. W.

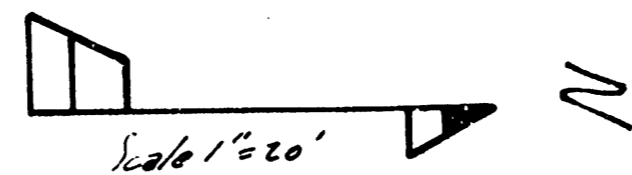
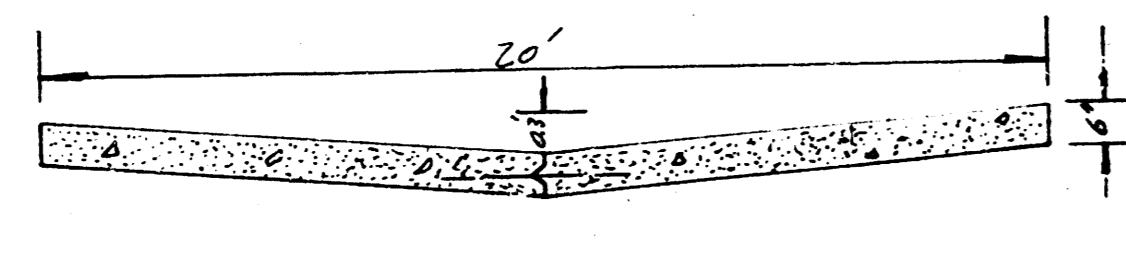

EXCAVATION
 CITY 25' PROP 25.5'
 + 10% 25' + 10% 25.5'
 TOTAL 50' TOTAL 51.0'

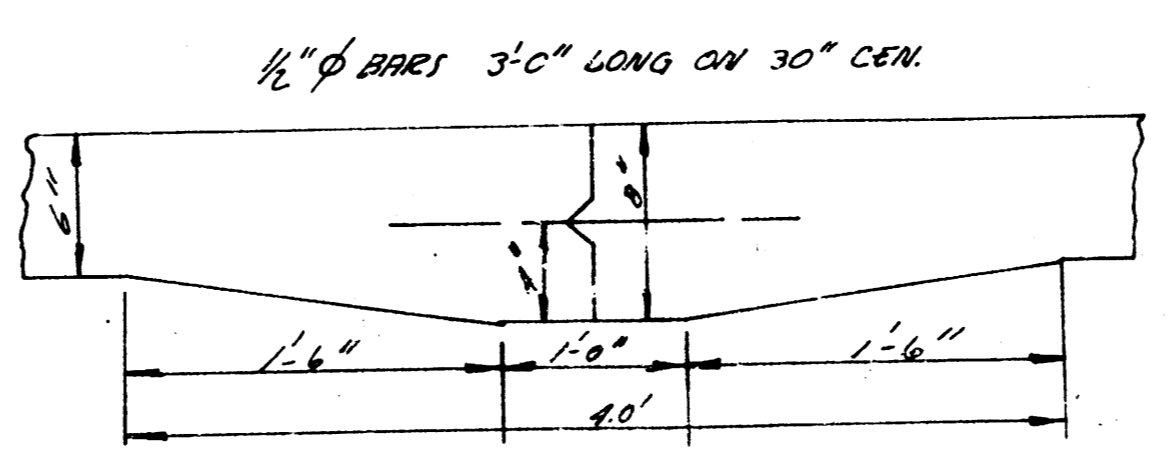

ALLEY
 BETWEEN BROADWAY'S MARKET
 N.W. BRAYLEY to 1705' 10\"/>

P. E. SMITH CITY ENGINEER
 DATE JULY, 1958, PROJ. NO. C-18-43